



Chipsmall Limited consists of a professional team with an average of over 10 year of expertise in the distribution of electronic components. Based in Hongkong, we have already established firm and mutual-benefit business relationships with customers from,Europe,America and south Asia,supplying obsolete and hard-to-find components to meet their specific needs.

With the principle of “Quality Parts,Customers Priority,Honest Operation,and Considerate Service”,our business mainly focus on the distribution of electronic components. Line cards we deal with include Microchip,ALPS,ROHM,Xilinx,Pulse,ON,Everlight and Freescale. Main products comprise IC,Modules,Potentiometer,IC Socket,Relay,Connector.Our parts cover such applications as commercial,industrial, and automotives areas.

We are looking forward to setting up business relationship with you and hope to provide you with the best service and solution. Let us make a better world for our industry!



Contact us

Tel: +86-755-8981 8866 Fax: +86-755-8427 6832

Email & Skype: info@chipsmall.com Web: www.chipsmall.com

Address: A1208, Overseas Decoration Building, #122 Zhenhua RD., Futian, Shenzhen, China



PRODUCT NUMBER
5 5 1 0 1 - X X X - X X - X X X X

PLATING
S=15μ[0.38μm]GOLD ON CONTACT AREA
100μ[2.54μm]TIN ON TAIL (NOTE 14)
G=30μ[0.76μm]GOLD ON CONTACT AREA
100μ[2.54μm]TIN ON TAIL (NOTE 14)
T=100-160μ[2.54-4.06μm]TIN ON CONTACT AREA AND ON TAIL(SEE NOTE 9)
F=2μ[0.05μm]GOLD ON CONTACT AREA AND ON TAIL

RETENTION R: RETENTIVE LEG NOTE 6
POLARIZATION NOTE 7
POSITIONS PER ROW 01 TO 36

PIN STYLE	POST	TAIL
11	0.230/5.84	0.090/2.29
17	0.230/5.84	0.120/3.05
12	0.230/5.84	0.190/4.82
34	0.318/8.08	0.100/2.54
35	0.318/8.08	0.120/3.05
36	0.318/8.08	0.200/5.08

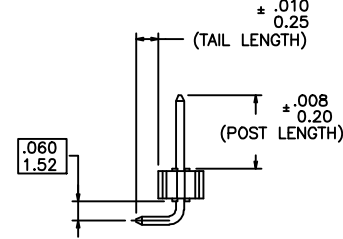
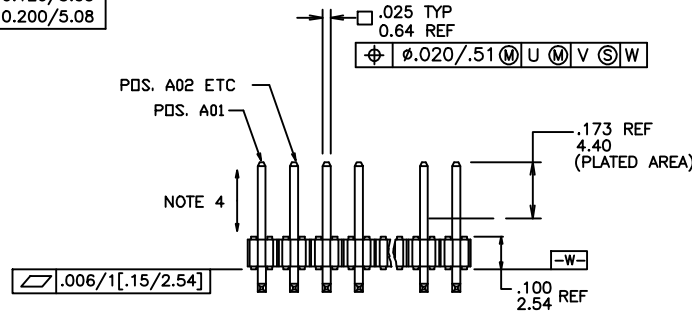
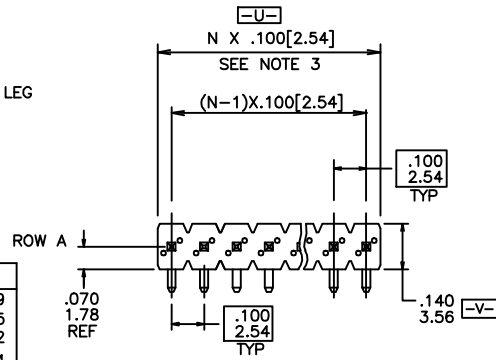

LEAD FREE PRODUCT NUMBER
5 5 1 0 1 - X X X X X X X X X LF

PLATING
S=15μ[0.38μm]GOLD ON CONTACT AREA
100μ[2.54μm]TIN ON TAIL (NOTE 14)
G=30μ[0.76μm]GOLD ON CONTACT AREA
100μ[2.54μm]TIN ON TAIL (NOTE 14)
T=100-160μ[2.54-4.06μm]TIN ON CONTACT AREA AND ON TAIL(SEE NOTE 13)
F=2μ[0.05μm]GOLD ON CONTACT AREA AND ON TAIL

LEAD FREE NOTE 10 & 11
RETENTION R: RETENTIVE LEG NOTE 6
POLARIZATION NOTE 7
POSITIONS PER ROW 01 TO 36

PIN STYLE	POST	TAIL
11	0.230/5.84	0.090/2.29
17	0.230/5.84	0.120/3.05
12	0.230/5.84	0.190/4.82
34	0.318/8.08	0.100/2.54
35	0.318/8.08	0.120/3.05
36	0.318/8.08	0.200/5.08

mat'l. code	surface ISO 1902	tolerance ISO 406	projection	product family	
litr	ecn no	dr	date	BERGSTIK	
B	V20751	GIP	07/09/02	title .100 UNSHROUDED HDR. S/R R/A THRU HOLE	
C	V21475	GIP	09/17/02		
D	M05-0118	MHT	6/03/05	scale 1:1	
E	M06-0268	MHT	7/17/06		
F	M06-0356	MHT	9/08/06		
G	M06-0237	MHT	8/25/08		
H	M06-0279	MHT	9/30/08		
sheet	revision	H	H	type	Product Customer Drawing
index	sheet	1	2		

NOTES:

- ① HOUSING MAT'L: HIGH TEMPERATURE THERMOPLASTIC. UL94V-0, COLOR: BLACK
OR
MINERAL FILLED LCP FLAME RETARDENT
PER UL-94V-0. COLOR: BLACK.
- ② PIN MATERIAL: PHOSPHOR-BRONZE
- ③ TO DETERMINE DIMENSION:
N = NUMBER OF POSITIONS PER ROW.
EXAMPLE: 10 POS., Nx100[2.54]=1.00[25.40].
- ④ 2LBS/0.9KG MIN. PIN RETENTION IN EITHER DIRECTION
- 5. PACKAGED IN POLY BAGS.
- ⑥ RETENTIVE LEG APPLICABLE TO TAIL LENGTH OF .120/3.05 ONLY.
FOUR PINS PER PART HAVE RETENTION.
5LB/2.3KG MAX INSERTION FORCE AND .25LB./1KG MIN RETENTION FORCE
PER RETENTIVE PIN USING .062/1.57 THICK CIRCUIT BOARD AND RECOMMENDED
HOLE PATTERN. RETENTIVE LOCATION AT THE DISCRETION OF THE MANUFACTURER.
OMIT FROM PRODUCT NUMBER IF THIS FEATURE IS NOT APPLICABLE.
- ⑦ FOR POLARIZATION, SPECIFY POSITION NUMBER(i.e., A03=ROW A PIN 3) TO OMIT PIN.
OMIT FROM PRODUCT NUMBER IF THIS FEATURE IS NOT APPLICABLE.
- 8. UNDEPLATING: 50 μ "/1.27 μ m Ni.
- 9. PIN TIPS ON TIN/LEAD PLATED PRODUCT MAY HAVE BARE METAL ON TWO SIDES,
BOTH ENDS.
- ⑩ PART NUMBERS WITH "LF" AT THE END ARE LEAD FREE.
- ⑪ THIS PRODUCT MEETS EUROPEAN UNION DIRECTIVES AND OTHER
COUNTRY REGULATION AS DESCRIBED IN GS-22-008.
- 12. THE HOUSING WILL WITHSTAND EXPOSURE TO 260°C PEAK TEMPERATURE
FOR 20 SECONDS IN A CONVECTION, INFRA-RED OR VAPOR PHASE REFLOW
OVEN. SEE APPLICATION NOTES/PROCEDURES IF THEY ARE AVAILABLE OR
FOR 15 SECONDS IN A WAVE SOLDER APPLICATION WITH A 1.5mm
MINIMUM THICK CIRCUIT BOARD.
- ⑬ "THIS PRODUCT HAS 100% PURE TIN PLATING IN THE INTERFACE AND
HAS NOT BEEN TESTED FOR WHISKER GROWTH IN ALL INTERCONNECT
ENVIRONMENTS."
- ⑭ PLATING OPTIONS:
MAY BE EITHER GOLD OR GXT PLATED AT MANUFACTURER'S OPTION.

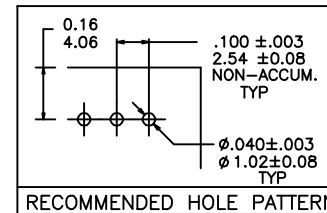

mat'l. code		surface		tolerance		projection		product family	
		ISO 902		ISO 406		ISO 1101		BERGSTIK	
ltr	ecn no	dr	date	tolerances unless otherwise specified					
H				angles	XXX±.01/XXX.3		INCH/MM		title
				linear	XXX±.006/XXX±0.13		scale 1:1		.100 UNSHROUDED HDR. S/R R/A THRU HOLE
				0'±2'	XXX±.0020/XXX±0.051		FCJ		dwg no
				dr	D.INFRAM	05/13/99			sheet 2 of 2 size
				engr	H.SUNDY	07/21/99			A3
				chr	H.SUNDY	07/21/99			
				appd	H.SUNDY	07/21/99			type
sheet	revision	Product Customer Drawing							
index	sheet								