



Chipsmall Limited consists of a professional team with an average of over 10 year of expertise in the distribution of electronic components. Based in Hongkong, we have already established firm and mutual-benefit business relationships with customers from,Europe,America and south Asia,supplying obsolete and hard-to-find components to meet their specific needs.

With the principle of “Quality Parts,Customers Priority,Honest Operation,and Considerate Service”,our business mainly focus on the distribution of electronic components. Line cards we deal with include Microchip,ALPS,ROHM,Xilinx,Pulse,ON,Everlight and Freescale. Main products comprise IC,Modules,Potentiometer,IC Socket,Relay,Connector.Our parts cover such applications as commercial,industrial, and automotives areas.

We are looking forward to setting up business relationship with you and hope to provide you with the best service and solution. Let us make a better world for our industry!



## Contact us

Tel: +86-755-8981 8866 Fax: +86-755-8427 6832

Email & Skype: [info@chipsmall.com](mailto:info@chipsmall.com) Web: [www.chipsmall.com](http://www.chipsmall.com)

Address: A1208, Overseas Decoration Building, #122 Zhenhua RD., Futian, Shenzhen, China



LOC	DIST	REVISIONS				
		REV	LTR	DESCRIPTION	DATE	DWN
GP	00	J		REVISED PER ECO-08-007327	22JUL08	BM

- 1

DIMENSIONS ARE MAXIMUM UNLESS OTHERWISE SPECIFIED.
- 2

THE CONTACT SURFACES OF THE TERMINALS ARE COATED WITH LUBRICANT.
- 3

MATERIAL:  
HOUSING — THERMOPLASTIC, BLACK.  
TERMINAL — PHOSPHOR BRONZE PLATED EITHER WITH .000030 MIN GOLD PLATE OR GOLD FLASH OVER PALLADIUM NICKEL PLATE, 0.76µm [.000030] MIN TOTAL MATING SURFACE. 3.05µm [.000120] MIN MATTE TIN-LEAD PLATE ON TAILS OVER 1.27µm [.000050] MIN NICKEL UNDERPLATE OVER ENTIRE TERMINAL.
- 4

THIS FEATURE IS A CORED AREA AND IS OPTIONAL ON PART.

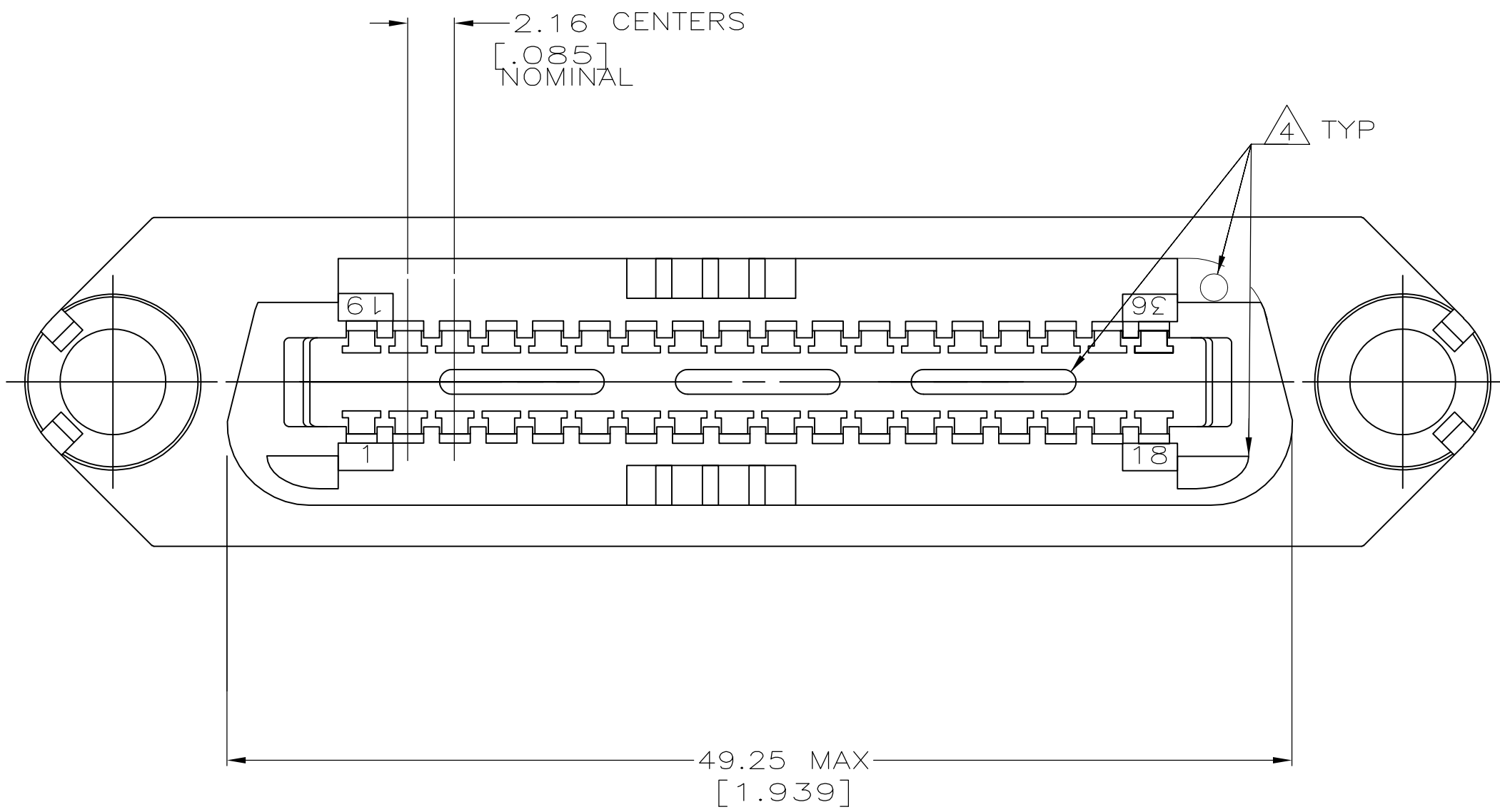
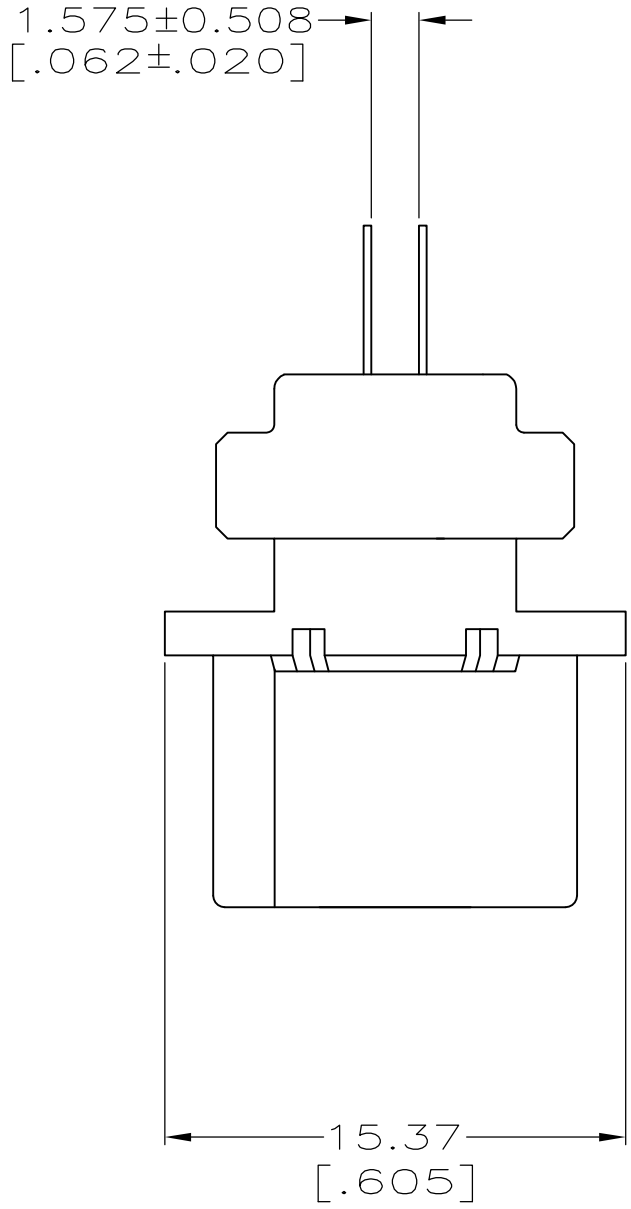
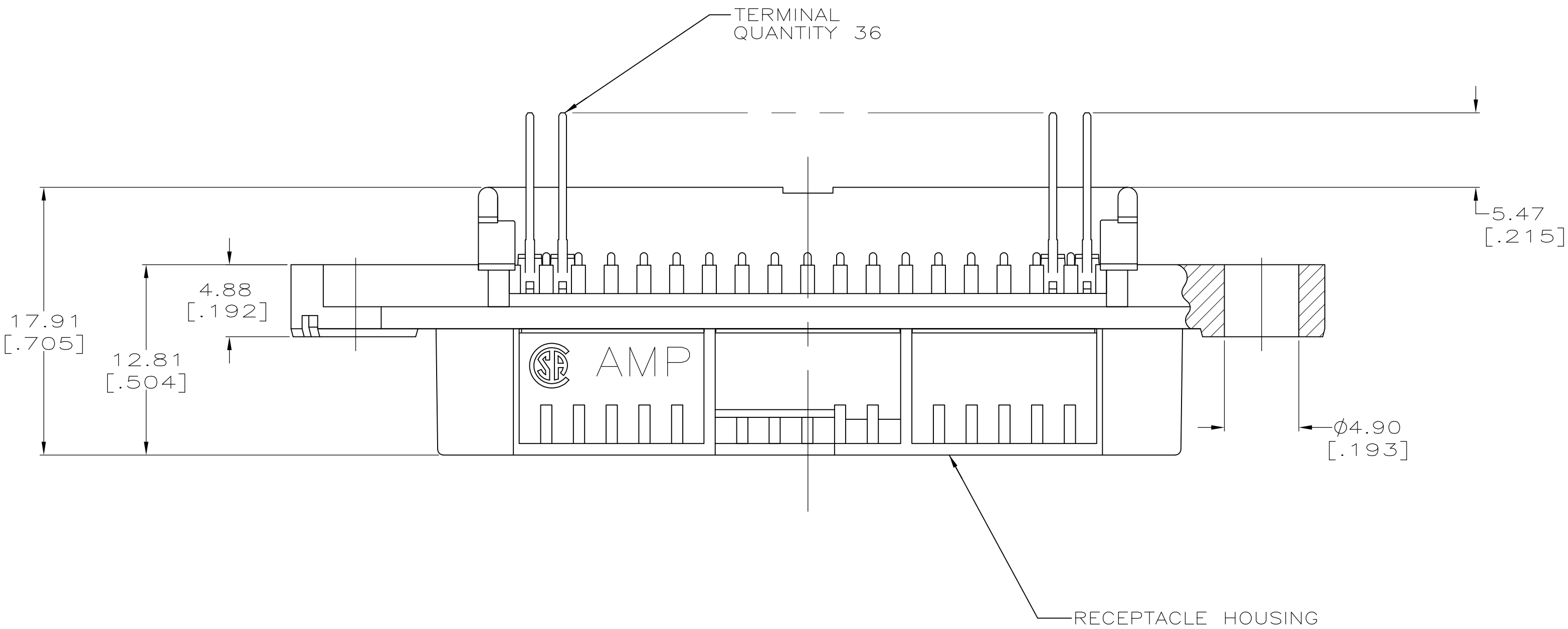
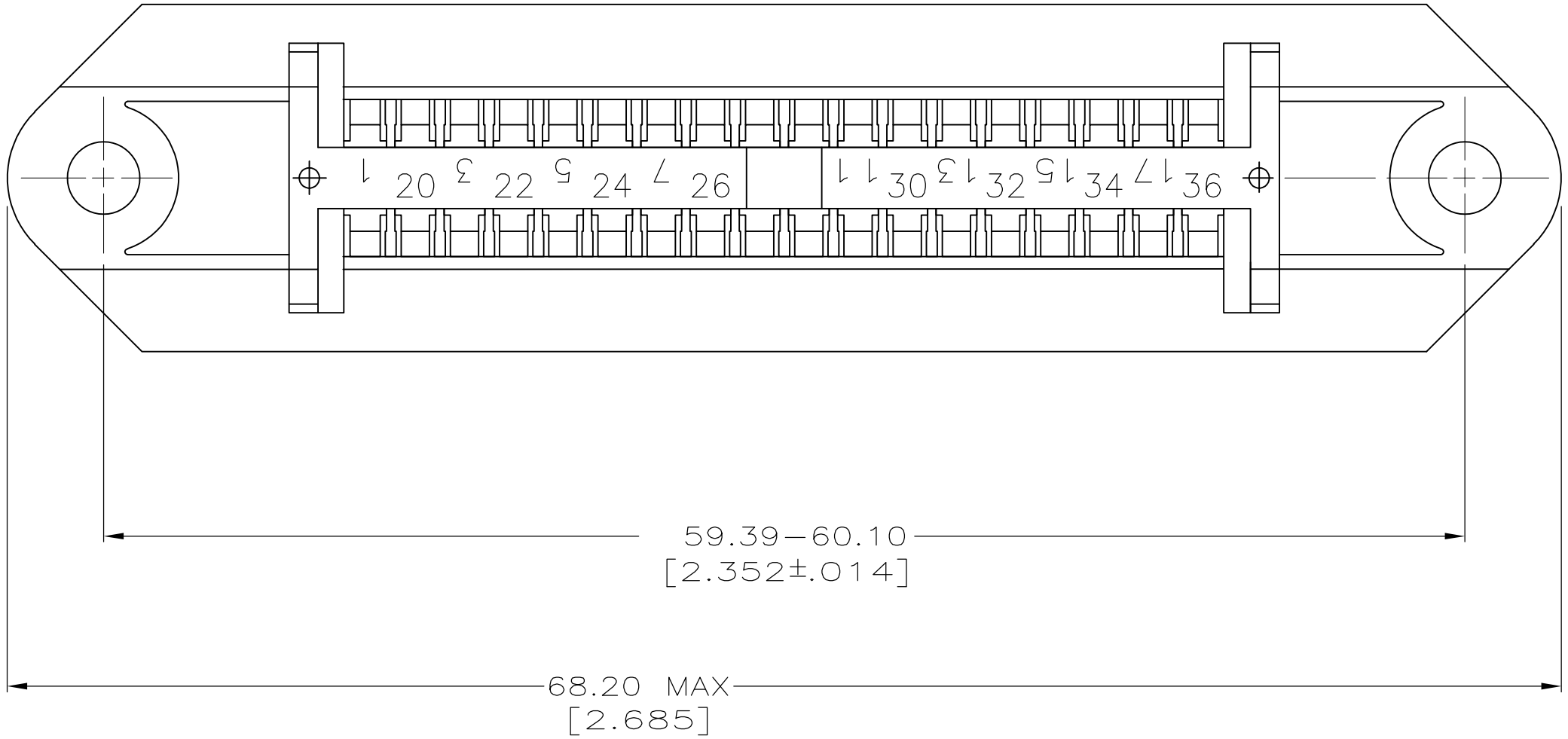

552241-1  
PART NUMBER

THIS DRAWING IS A CONTROLLED DOCUMENT.		DWN B. SIMPSON 7-26-94	Tyco Electronics Corporation Harriaburg, PA 17105-3608	
		CHK C. WHITT 10-26-94		
DIMENSIONS: mm [INCHES]	TOLERANCES UNLESS OTHERWISE SPECIFIED: 0. PLC ± .01 1. PLC ± .01 2. PLC ± .01 3. PLC ± .01 4. PLC ± .01 ANGLES ± .01	APVD J. HARRIS 11-2-94	NAME RECEPTACLE ASSEMBLY, 36 POSITION, EDGE MOUNTING, CHAMP-LOK®	
		APPLICATION SPEC	SIZE A1	
MATERIAL	FINISH	WEIGHT	CAGE CODE 00779	
CUSTOMER DRAWING		SCALE 4:1	SHEET 1 OF 1	