



Chipsmall Limited consists of a professional team with an average of over 10 year of expertise in the distribution of electronic components. Based in Hongkong, we have already established firm and mutual-benefit business relationships with customers from,Europe,America and south Asia,supplying obsolete and hard-to-find components to meet their specific needs.

With the principle of “Quality Parts,Customers Priority,Honest Operation,and Considerate Service”,our business mainly focus on the distribution of electronic components. Line cards we deal with include Microchip,ALPS,ROHM,Xilinx,Pulse,ON,Everlight and Freescale. Main products comprise IC,Modules,Potentiometer,IC Socket,Relay,Connector.Our parts cover such applications as commercial,industrial, and automotives areas.

We are looking forward to setting up business relationship with you and hope to provide you with the best service and solution. Let us make a better world for our industry!



## Contact us

Tel: +86-755-8981 8866 Fax: +86-755-8427 6832

Email & Skype: info@chipsmall.com Web: www.chipsmall.com

Address: A1208, Overseas Decoration Building, #122 Zhenhua RD., Futian, Shenzhen, China



MAGNETIC

Material: Alnico 5, Sintered or Cast, Anisotropic  
 Bhmax (MGOe) or (kJ/m<sup>3</sup>): 3.5-5.5 or 31.0-43.8  
 Br (kG) or (mT): 10.9-12.8 or 1090-1280  
 Hc (Oe) or (kA/m): 620-640 or 49-51  
 Number of Poles: 2  
 Saturation Level: Full  
 Gauss Level: 350 Gauss MIN. .077" from closed end

PHYSICAL

Capsule: Black UL94V-0 Polyester  
 Encapsulant: Black Epoxy  
 Magnet: Hamlin 420

IDENTIFICATION

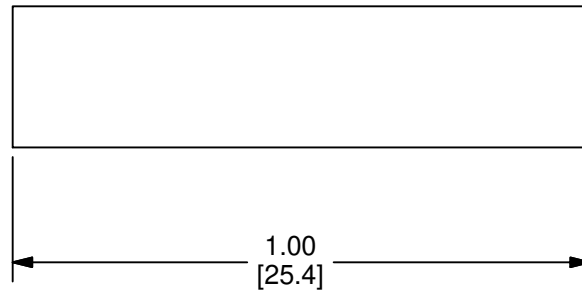
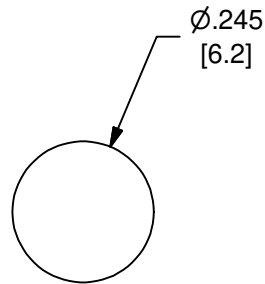

4 DIGIT DATE CODE →

Dimensions are in Inches [mm]  
 Tolerances unless otherwise noted:  
 .X: ± .1 , .XX: ± .01 , .XXX: ± .005 , Angular: ± 1/2°  
 \* Denotes Critical Dimensions

ORIGINAL DCR NO. 2038	
DRAWN BY: BB	DATE: 25-Apr-89
APP'D BY: BB	DATE: 5-May-89

<b>HAMLIN</b>	PROPRIETARY NOTE: THE INFORMATION ON THIS DRAWING IS THE CONFIDENTIAL PROPERTY OF HAMLIN. THIS DRAWING MUST NOT BE MADE PUBLIC OR COPIED UNLESS AUTHORIZED IN WRITING BY HAMLIN. THIS DRAWING IS SUBJECT TO RETURN UPON DEMAND.	
	DESCRIPTION OF REVISION: UPDTE -2 SHEET	

SHEET: 1 of 1	DCR NO. L3631	REV. AH
DRAWN BY: KCL	DATE: 27-Aug-08	
APP'D BY: MCP	DATE: 17-Sep-08	