



Chipsmall Limited consists of a professional team with an average of over 10 year of expertise in the distribution of electronic components. Based in Hongkong, we have already established firm and mutual-benefit business relationships with customers from,Europe,America and south Asia,supplying obsolete and hard-to-find components to meet their specific needs.

With the principle of “Quality Parts,Customers Priority,Honest Operation,and Considerate Service”,our business mainly focus on the distribution of electronic components. Line cards we deal with include Microchip,ALPS,ROHM,Xilinx,Pulse,ON,Everlight and Freescale. Main products comprise IC,Modules,Potentiometer,IC Socket,Relay,Connector.Our parts cover such applications as commercial,industrial, and automotives areas.

We are looking forward to setting up business relationship with you and hope to provide you with the best service and solution. Let us make a better world for our industry!



Contact us

Tel: +86-755-8981 8866 Fax: +86-755-8427 6832

Email & Skype: info@chipsmall.com Web: www.chipsmall.com

Address: A1208, Overseas Decoration Building, #122 Zhenhua RD., Futian, Shenzhen, China



THIS DRAWING IS UNPUBLISHED. RELEASED FOR PUBLICATION
 © COPYRIGHT 2005 By - ALL RIGHTS RESERVED.

LOC		DIST		REVISIONS			
P	LTR	DESCRIPTION	DATE	DWN	APVD		
GP	00						
	D	REVISED PER ECO-14-011808	11AUG2014	AP	SB		

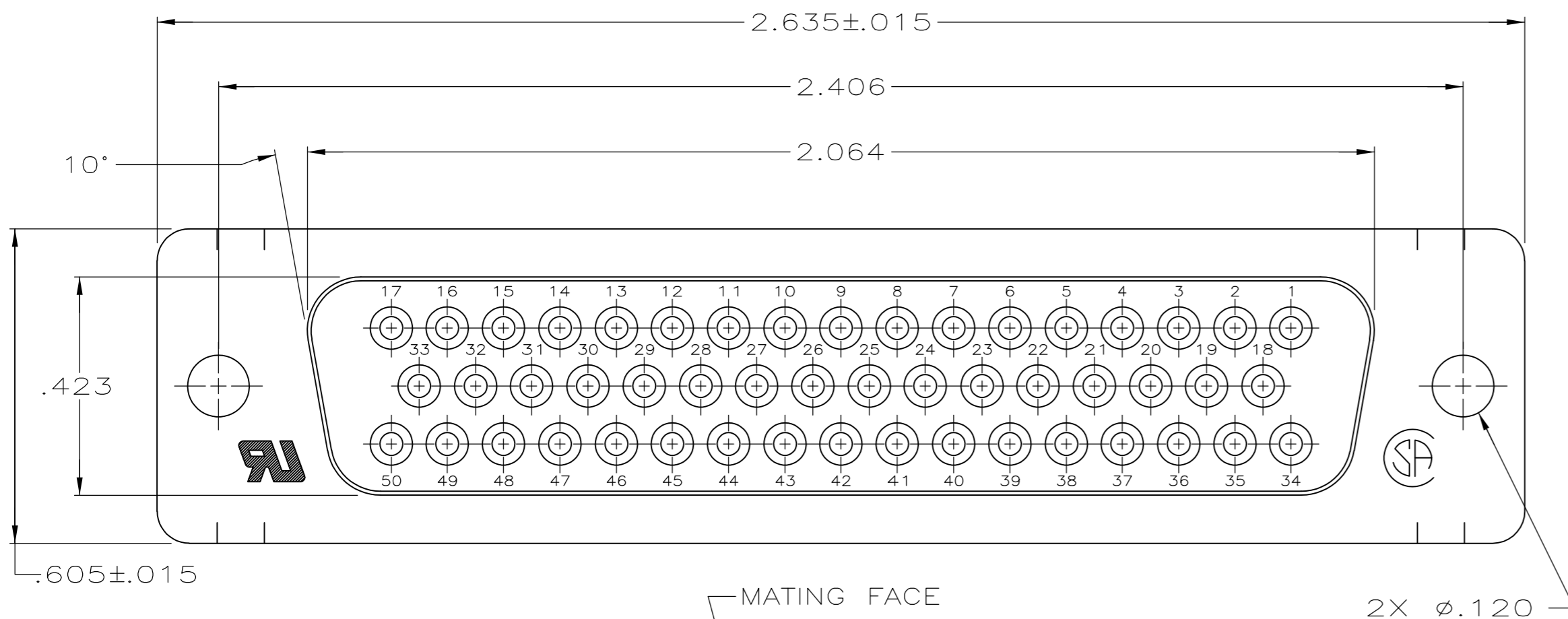

- 1 MOLDED PARTS: GLASS-FILLED PBT OR GLASS-FILLED NYLON, UL94V-0 RATED. COLOR: BLACK.
SHELLS: CARBON STEEL
CONTACTS: PHOS. BRONZE
- 2 SHELLS: .000200 MIN TIN OVER .000100 MIN COPPER.
CONTACTS: .000030 MIN GOLD ON MATING END, .000100 MIN TIN ON SOLDER END, BOTH OVER .000050 MIN NICKEL
-OR-
GOLD FLASH OVER PALLADIUM-NICKEL .000030 MIN TOTAL ON MATING END, .000100 MIN TIN ON SOLDER END, BOTH OVER .000050 MIN NICKEL.

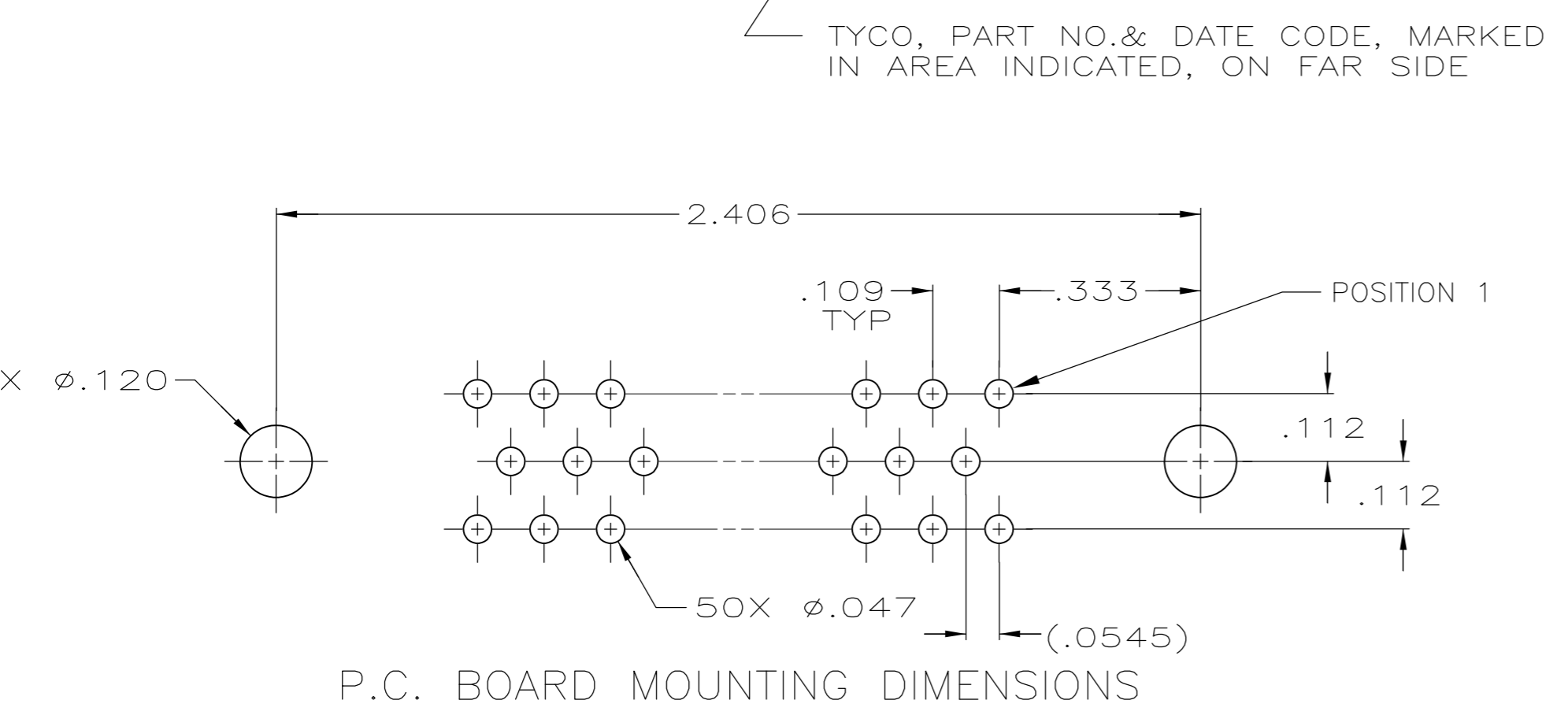
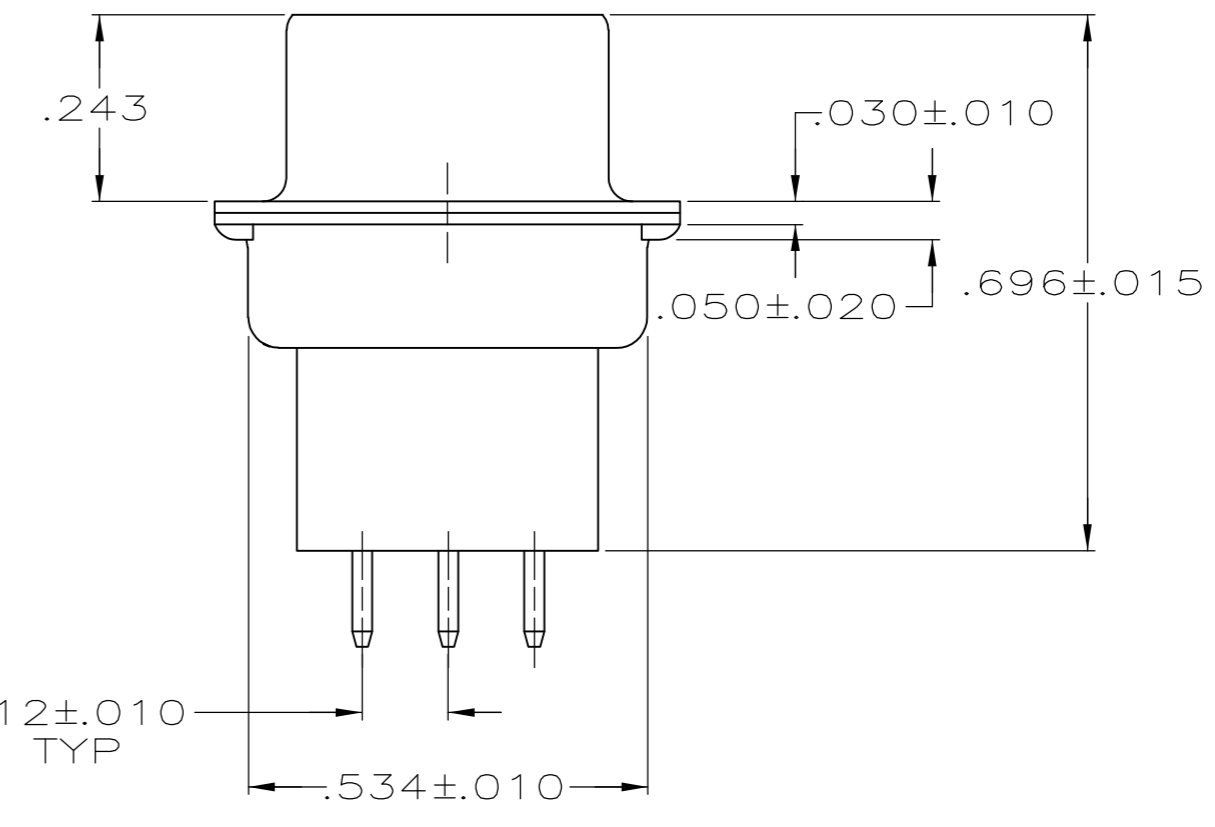
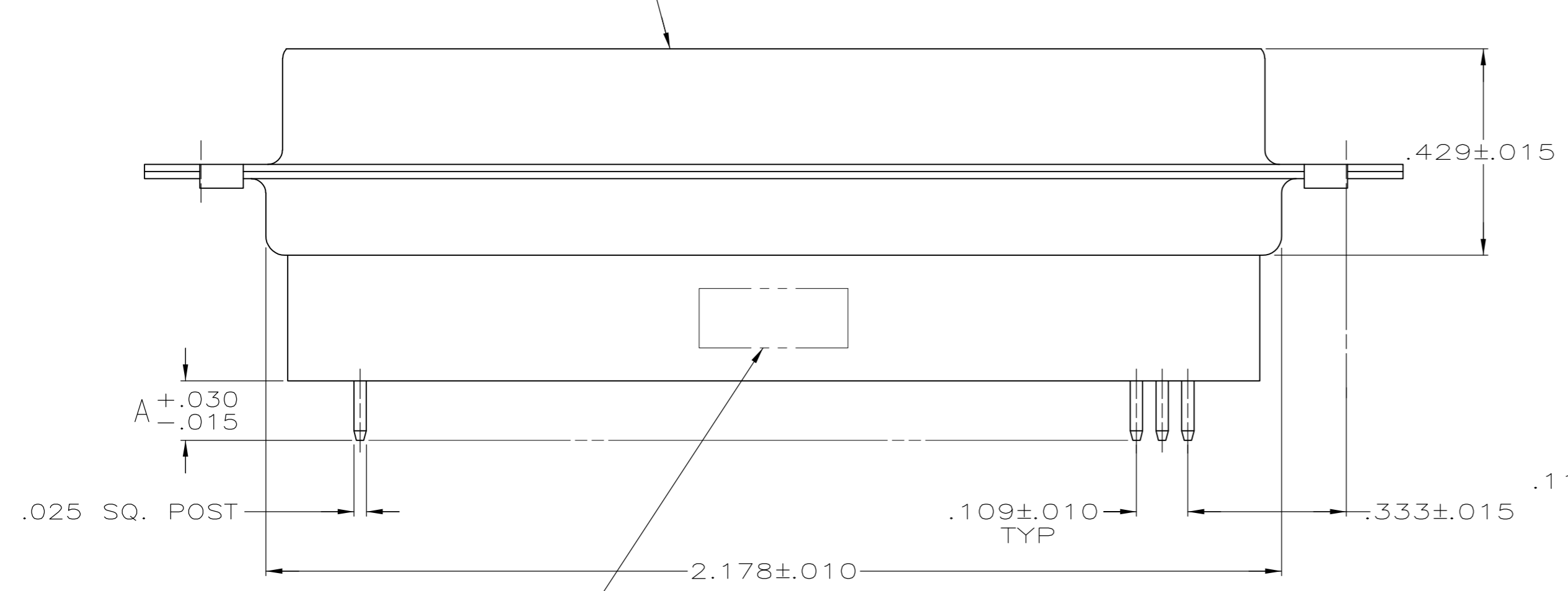

.188	5745191-7
.125	5745191-1
A	PART NO

THIS DRAWING IS A CONTROLLED DOCUMENT.		DWN	15SEPT05	 TE Connectivity	RECEPTACLE ASSEMBLY, SIZE 5, 50 POS., VERTICAL, AMPLIMITE HDP
DIMENSIONS: INCHES		CHK	15SEPT05		
TOLERANCES UNLESS OTHERWISE SPECIFIED:		APVD	15SEPT05		
0 PLC ± - 1 PLC ± - 2 PLC ± - 3 PLC ± .005 4 PLC ± - ANGLES ± - FINISH ± -		NAME			
MATERIAL		PRODUCT SPEC 108-40025 APPLICATION SPEC 114-40013		SIZE	A2
1 2		WEIGHT		CAGE CODE	00779
CUSTOMER DRAWING		SCALE		DRAWING NO	C=5745191
		SHEET		RESTRICTED TO	-
		1 of 1		REV	D