



Chipsmall Limited consists of a professional team with an average of over 10 year of expertise in the distribution of electronic components. Based in Hongkong, we have already established firm and mutual-benefit business relationships with customers from,Europe,America and south Asia,supplying obsolete and hard-to-find components to meet their specific needs.

With the principle of “Quality Parts,Customers Priority,Honest Operation,and Considerate Service”,our business mainly focus on the distribution of electronic components. Line cards we deal with include Microchip,ALPS,ROHM,Xilinx,Pulse,ON,Everlight and Freescale. Main products comprise IC,Modules,Potentiometer,IC Socket,Relay,Connector.Our parts cover such applications as commercial,industrial, and automotives areas.

We are looking forward to setting up business relationship with you and hope to provide you with the best service and solution. Let us make a better world for our industry!



Contact us

Tel: +86-755-8981 8866 Fax: +86-755-8427 6832

Email & Skype: info@chipsmall.com Web: www.chipsmall.com

Address: A1208, Overseas Decoration Building, #122 Zhenhua RD., Futian, Shenzhen, China



DESCRIPTION	MATERIAL	FINISH
GROMMET	FLUOROSILICONE 40/50 BLEND PER MIL-R-25988	COLOR: BLUE
SPLICE ASSEMBLY HOUSING	EPOXY	COLOR: BLACK
CONTACT FEMALE SOCKET	BERYLLIUM COPPER PER QQ-C-533	GOLD PLATE PER MIL-G-45204
CLIP CONTACT RETAINING	BERYLLIUM COPPER PER QQ-C-533 OR STAINLESS STEEL PER QQ-S-766	NONE
SHRINK TUBE	PER MIL-1-23053/8	COLOR TRANSPARENT
CONTACTS $\triangle 3$	PER M39029/1-102	GOLD PLATE PER MIL-G-45204

LOC	DIST	REV	DATE	BY	APP'D
DF	A5	A	5-01	CT	DM

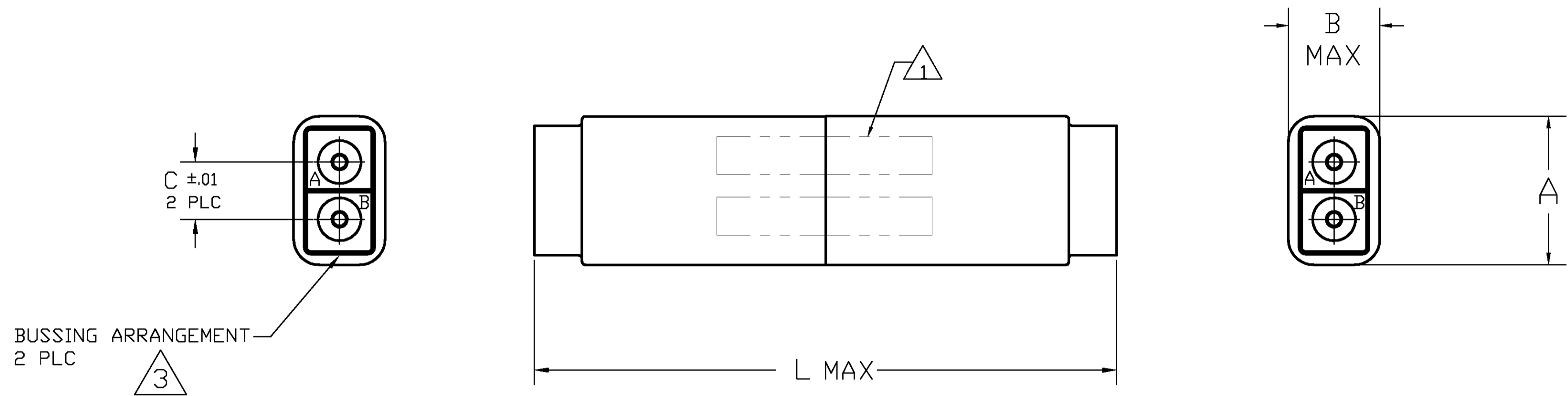

- $\triangle 1$ MARK WIRE SPLICE WITH *AMP*, AMP PART NO. AND DATE CODE .060 MINIMUM HIGH CHARACTERS AT APPROXIMATE AREA SHOWN.
- $\triangle 2$ A QUANTITY OF 4 CONTACTS ARE SUPPLIED WITH WIRE SPLICE.
- $\triangle 3$ MARK WIRE SPLICE BUSSING ARRANGEMENT BOTH ENDS AS SHOWN.

1.522	.13	.275	.400	$\triangle 3$	CLASS C	22	1-592582-5
1.522	.13	.275	.400	$\triangle 3$	CLASS A	20	1-592582-4
1.522	.13	.275	.400	$\triangle 3$	CLASS C	20	1-592582-3
1.922	.13	.300	.500	$\triangle 3$	CLASS B	16	1-592582-2
1.922	.13	.300	.500	$\triangle 3$	CLASS C	16	1-592582-1
1.552	.13	.275	.400	$\triangle 3$	CLASS C	20	1-592582-0
1.552	.13	.275	.400	$\triangle 3$	CLASS C	22	592582-9
1.552	.13	.275	.400	$\triangle 3$	CLASS B	22	592582-8
1.552	.18	.275	.400	$\triangle 3$	CLASS C	22	592582-7
1.992	.18	.300	.500	$\triangle 3$	CLASS B	16	592582-6
1.992	.18	.300	.500	$\triangle 3$	CLASS C	16	592582-5
1.992	.18	.300	.500	$\triangle 3$	CLASS A	16	592582-4
1.552	.13	.275	.400	$\triangle 3$	CLASS B	20	592582-3
1.552	.13	.275	.400	$\triangle 3$	CLASS C	20	592582-2
1.552	.13	.275	.400	$\triangle 3$	CLASS D	20	592582-1
L MAX	C	B MAX	A	REMARKS	MIL-T-8174 CLASS (A, B OR C)	SIZE	PART NO

THIS DRAWING IS A CONTROLLED DOCUMENT.

DWG: C. C. THOMAS 08MAY01
CHK: D. MILLER 11/99
APP'D: D. MILLER 11/99

AMP Incorporated
Harrisburg Pa. 17105

PRODUCT SPEC: WIRE SPLICE ASSY, T.J, SIZE 16, 20 & 22

APPLICATION SPEC: -

SIZE: A1 CAGE CODE: 00779 DRAWING NO: C-592582

RESTRICTED TO: -

CUSTOMER DRAWING SCALE: 1:1 SHEET: 1 OF 1 REV: A