



Chipsmall Limited consists of a professional team with an average of over 10 year of expertise in the distribution of electronic components. Based in Hongkong, we have already established firm and mutual-benefit business relationships with customers from,Europe,America and south Asia,supplying obsolete and hard-to-find components to meet their specific needs.

With the principle of "Quality Parts,Customers Priority,Honest Operation,and Considerate Service",our business mainly focus on the distribution of electronic components. Line cards we deal with include Microchip,ALPS,ROHM,Xilinx,Pulse,ON,Everlight and Freescale. Main products comprise IC,Modules,Potentiometer,IC Socket,Relay,Connector.Our parts cover such applications as commercial,industrial, and automotives areas.

We are looking forward to setting up business relationship with you and hope to provide you with the best service and solution. Let us make a better world for our industry!



## Contact us

Tel: +86-755-8981 8866 Fax: +86-755-8427 6832

Email & Skype: info@chipsmall.com Web: www.chipsmall.com

Address: A1208, Overseas Decoration Building, #122 Zhenhua RD., Futian, Shenzhen, China



REV	ECN NO	REVISIONS	DRN	CKD	APP	DATE
A		NEW RELEASE	TWC			

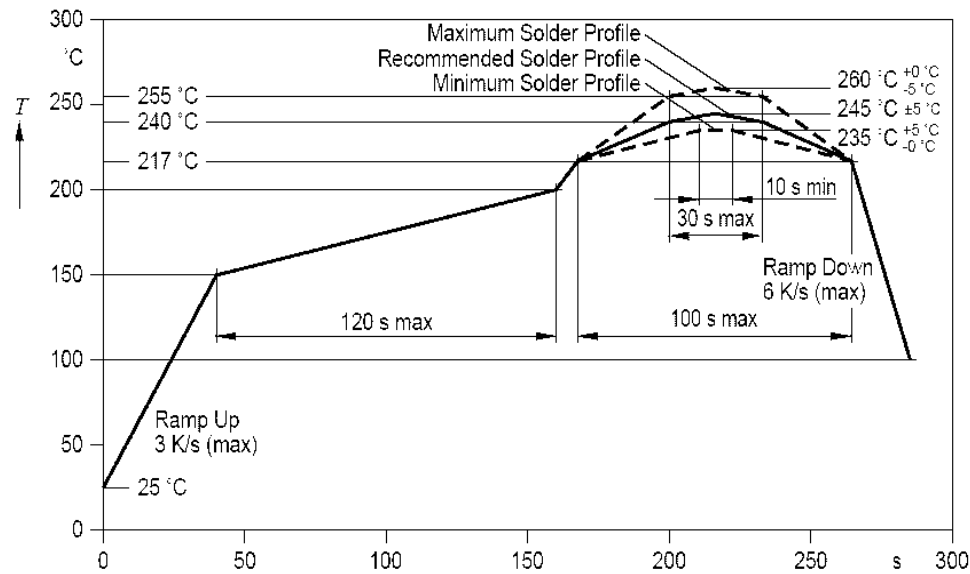

REFLOW PROFILE FOR Pb FREE PROCESS

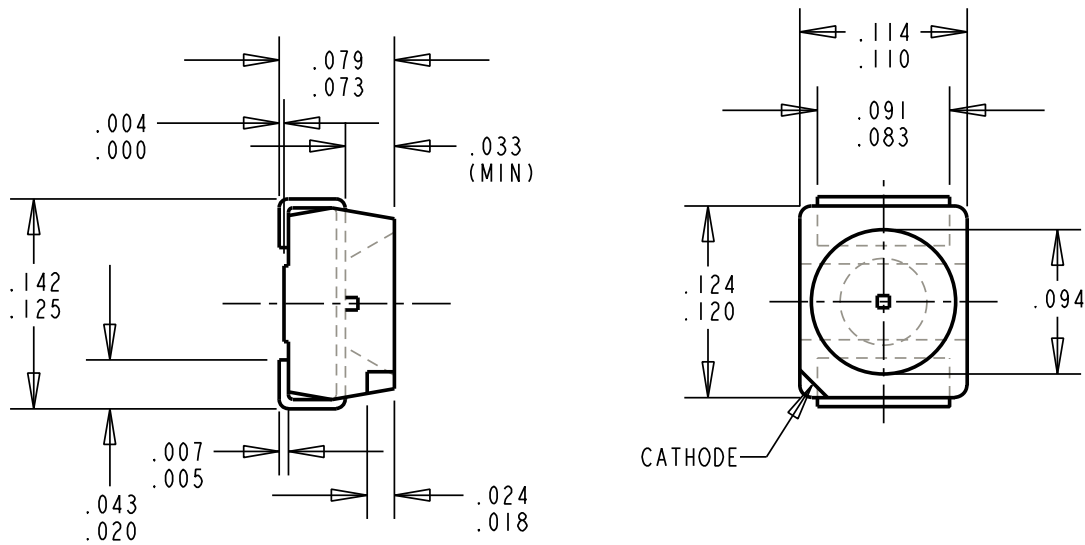

NOTES:

- EPOXY COLOR: WATER CLEAR.
- DIE: GaAsP/GaP GREEN LED.
- LEADS: TIN (Sn) OVER NICKEL (Ni)
- SOLDER ADHERANCE: BOTH LEADS PER MIL-STD-202E, METHOD 208C.
- SUFFIX -202F FOR 20-PCS ON A SAMPLE TAPE STRIP.
- SUFFIX -207F FOR 180 mm DIA. REEL, 8 mm WIDE TAPE, PACKAGED 2000 PCS PER REEL WITH A PITCH OF 4 mm.
- DEVICES POSITIONED ON REEL WITH CATHODE SIDE TOWARDS SPROCKET.
- DIALIGHT P/N: 597-3301-202F, 597-3301-207F.
- TAPE AND REEL LEDS MAY REQUIRE RE-TAPING AFTER TWELVE MONTHS.
- DEVICES HAVE A MOISTURE SENSITIVITY LEVEL OF "2" CAUTION LABEL APPLIED AS PER JEDEC STD. 033.
- THIS PRODUCT IS RoHS COMPLIANT (Pb FREE). EACH BAG AND REEL IS MARKED WITH RoHS COMPLIANT LABEL 9100-117-0852-99 OR EQUIVALENT MARKING.

OPERATING CHARACTERISTICS AT 25°C AMBIENT					
CHARACTERISTICS	MIN	TYP	MAX	UNITS	TEST CONDITIONS
LUMINOUS INTENSITY	11.2	19.6	28.0	mcd	$I_f = 10 \text{ mA}$
FORWARD VOLTAGE		2.0	2.5	V	$I_f = 10 \text{ mA}$
REVERSE CURRENT		.01	10.0	$\mu\text{A}$	$V_R = 12 \text{ V}$
PEAK WAVELENGTH		572		nm	$I_f = 10 \text{ mA}$
DOMINANT WAVELENGTH	564	570	576	nm	$I_f = 10 \text{ mA}$
VIEWING ANGLE (2 $\theta$ 1/2)		120		DEG.	

ABSOLUTE MAXIMUM RATING AT 25°C AMBIENT		UNITS
POWER CONSUMPTION	95	mW
REVERSE VOLTAGE	12	V
DERATE LINEARLY FROM 60 °C	.75	$\text{mA}/^\circ\text{C}$
CONTINUOUS FORWARD CURRENT	30	mA
SOLDERING TEMPERATURE FOR 10 SEC.	260	$^\circ\text{C}$
OPERATING TEMPERATURE	-40 TO 100	$^\circ\text{C}$
STORAGE TEMPERATURE	-40 TO 100	$^\circ\text{C}$

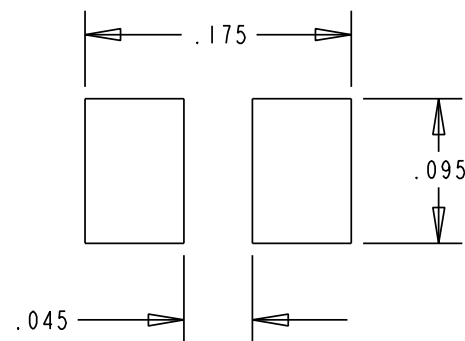

RECOMMENDED SOLDER PAD LAYOUT

THIS DRAWING AND THE CONTENTS HEREIN ARE CONFIDENTIAL AND THE SOLE PROPERTY OF DIALIGHT. REPRODUCTION OF THIS DRAWING OR CONSTRUCTION OF ANY PARTS WITHIN THIS DRAWING ARE FORBIDDEN WITHOUT THE WRITTEN CONSENT OF DIALIGHT.		
SCALE: DRAWING SCALE ALL DIM'S IN: INCHES (MM)	DRAWING NUMBER C-17258	REV A
TOLERANCES: UNLESS OTHERWISE SPECIFIED FRACTIONS: $\pm 1/64$ DECIMALS (.XX): $\pm .01$ DECIMALS (.XXX): $\pm .005$ DECIMALS (.XXXX): $\pm .0005$ ANGLES: $\pm 1^\circ$	TITLE GREEN PLCC-2 SMT LED, RoHS COMPLIANT	
FINISH:	MATERIAL	
FSCM 83330	1501 ROUTE 34 SOUTH FARMINGDALE, NJ 07727	
SHEET 1 OF 1 FAMILY TABLE:		