



Chipsmall Limited consists of a professional team with an average of over 10 year of expertise in the distribution of electronic components. Based in Hongkong, we have already established firm and mutual-benefit business relationships with customers from,Europe,America and south Asia,supplying obsolete and hard-to-find components to meet their specific needs.

With the principle of “Quality Parts,Customers Priority,Honest Operation,and Considerate Service”,our business mainly focus on the distribution of electronic components. Line cards we deal with include Microchip,ALPS,ROHM,Xilinx,Pulse,ON,Everlight and Freescale. Main products comprise IC,Modules,Potentiometer,IC Socket,Relay,Connector.Our parts cover such applications as commercial,industrial, and automotives areas.

We are looking forward to setting up business relationship with you and hope to provide you with the best service and solution. Let us make a better world for our industry!



Contact us

Tel: +86-755-8981 8866 Fax: +86-755-8427 6832

Email & Skype: info@chipsmall.com Web: www.chipsmall.com

Address: A1208, Overseas Decoration Building, #122 Zhenhua RD., Futian, Shenzhen, China



THIS DRAWING IS UNPUBLISHED. RELEASED FOR PUBLICATION
 © COPYRIGHT - By - ALL RIGHTS RESERVED.

LOC	DIST	REVISIONS					
FT	0	P	LTR	DESCRIPTION	DATE	DWN	APVD
		-	-	SEE SHEET 1	-	-	-

SELECT LOAD CHART

9,10	1-8	1-8	9,10	9,10	-	1-8	-	-	10	SSB7N2030	5-1546963-8
1-8	9,10	-	-	2,5,6,10	-	1,7	-	-	10	SSB7N2025	4-1546963-3
ALL	ALL	2,3,4	-	-	-	-	-	-	7	SSB7N2019	3-1546963-8
ALL	ALL	3,4	-	-	-	-	-	-	7	SSB7N2017	3-1546963-2
-	-	ALL	-	-	-	2,4	-	-	6	SSB7N2016	3-1546963-1
-	1,3,5,7	-	-	1	-	-	-	-	4	SSB7CG04032224	4-1546963-9
.250 QC TAB 90° BEND SGL SIDED ⑩	.250 QC TAB 90° BEND DBL SIDED ⑨	.250 QC TAB STRAIGHT DBL SIDED ⑧	.250 QC TAB STRAIGHT SGL SIDED ⑦	.250 QC TAB 45° BEND SGL SIDED ⑥	.187 QC TAB STRAIGHT SGL SIDED ⑤	.250 QC TAB 45° BEND DBL SIDED ④	.187 QC TAB 45° BEND SGL SIDED ③	.187 QC TAB 90° BEND SGL SIDED ②	NO. OF POS.	CATALOG NUMBER	PART NUMBER
POSITIONS LOADED											

11.375	11.937	-	-	-	-	-	-	-	-	-	-	YES	25	SSB70G250301	2-1546963-5
10.937	11.500	-	-	-	-	-	-	-	-	-	-	YES	24	SSB70G240301	2-1546963-4
10.500	11.062	-	-	-	-	-	-	-	-	-	-	YES	23	SSB70G230301	2-1546963-3
10.062	10.625	-	-	-	-	-	-	-	-	-	-	YES	22	SSB70G220304	6-1546963-1
10.062	10.625	-	-	-	-	-	-	-	-	-	-	YES	22	SSB70G220301	2-1546963-2
9.625	10.187	-	-	-	-	-	-	-	-	-	-	YES	21	SSB70G210301	2-1546963-1
④ 9.187	9.750	-	-	-	-	-	-	-	-	-	-	YES	20	SSB70G200301	2-1546963-0
8.750	9.312	-	-	-	-	-	-	-	-	-	-	YES	19	SSB7CG190301	1-1546963-9
8.313	8.875	-	-	-	-	-	-	-	-	-	-	YES	18	SSB7CG180301	1-1546963-8
7.875	8.437	-	-	-	-	-	-	-	-	-	-	YES	17	SSB7CG170301	1-1546963-7
7.437	8.000	-	-	-	-	-	-	-	-	-	-	YES	16	SSB7CG160301	1-1546963-6
7.000	7.562	-	-	-	-	-	-	-	-	-	-	YES	15	SSB7CG150301	1-1546963-5
① ③ ④ 6.562	7.125	-	-	14	-	-	-	-	14	-	-	YES	14	SSB7N2020	3-1546963-4
6.562	7.125	-	-	-	-	-	-	-	-	-	-	YES	14	SSB7CG140301	7-1437415-6
6.125	6.687	-	-	-	-	-	-	-	-	-	-	YES	13	SSB7CG130301	1-1546963-3
5.687	6.250	-	-	-	-	-	-	-	-	-	-	YES	12	SSB7CG120301	1-1546963-2
③ 5.250	5.812	-	-	-	11	11	-	-	-	-	-	YES	11	SSB7CG110329	1-1546963-6
5.250	5.812	-	-	-	-	-	-	-	-	-	-	YES	11	SSB7CG110301	1-1546963-1
③ ④ 4.812	5.375	-	2	8	8	2	2	-	8	-	-	YES	10	SSB7N2030	5-1546963-8
③ ④ 4.812	5.375	-	2	8	-	-	4	-	2	-	-	NO	10	SSB7N2025	4-1546963-3
4.812	5.375	-	-	-	-	-	-	-	-	-	-	YES	10	SSB7CG100301	1-1546963-0
DIM B	DIM A	JUMPER	.250 QC TAB 90° BEND SGL SIDED ⑩	.250 QC TAB 90° BEND DBL SIDED ⑨	.250 QC TAB STRAIGHT DBL SIDED ⑧	.250 QC TAB STRAIGHT SGL SIDED ⑦	.250 QC TAB 45° BEND SGL SIDED ⑥	.187 QC TAB STRAIGHT SGL SIDED ⑤	.250 QC TAB 45° BEND DBL SIDED ④	.187 QC TAB 45° BEND SGL SIDED ③	.187 QC TAB 90° BEND SGL SIDED ②	SSB7 BUSHING ①	NO. OF POS.	CATALOG NUMBER	PART NUMBER
QUANTITIES															

THIS DRAWING IS A CONTROLLED DOCUMENT.		DWN S SCHLGE	3/5/04	STE TE Connectivity	
DIMENSIONS: INCHES		CHK S YODER	3/5/04		
TOLERANCES UNLESS OTHERWISE SPECIFIED:		APVD S YODER	3/5/04	NAME	
0 PLC ± - 1 PLC ± - 2 PLC ± .02 3 PLC ± .010 4 PLC ± - ANGLES ± 1°		PRODUCT SPEC		SSB7CGXX0301	
MATERIAL		APPLICATION SPEC		SIZE	RESTRICTED TO
FINISH		WEIGHT		A2	-
		CUSTOMER DRAWING		CAGE CODE	DRAWING NO
				00779	8-796602-0
				SCALE	SHEET
				NTS	2 of 4
				REV	P

THIS DRAWING IS UNPUBLISHED. RELEASED FOR PUBLICATION
 © COPYRIGHT - By - ALL RIGHTS RESERVED.

LOC		DIST		REVISIONS			
P	LTR	DESCRIPTION	DATE	DWN	APVD		
FT	0	SEE SHEET 1	-	-	-		

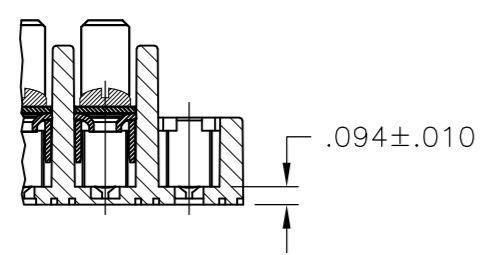
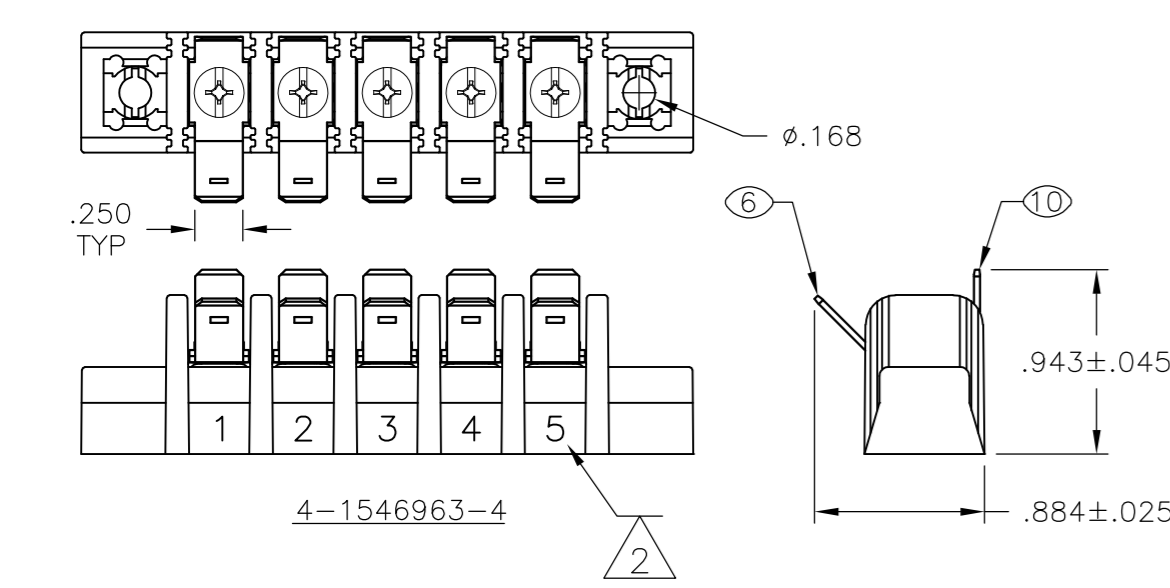
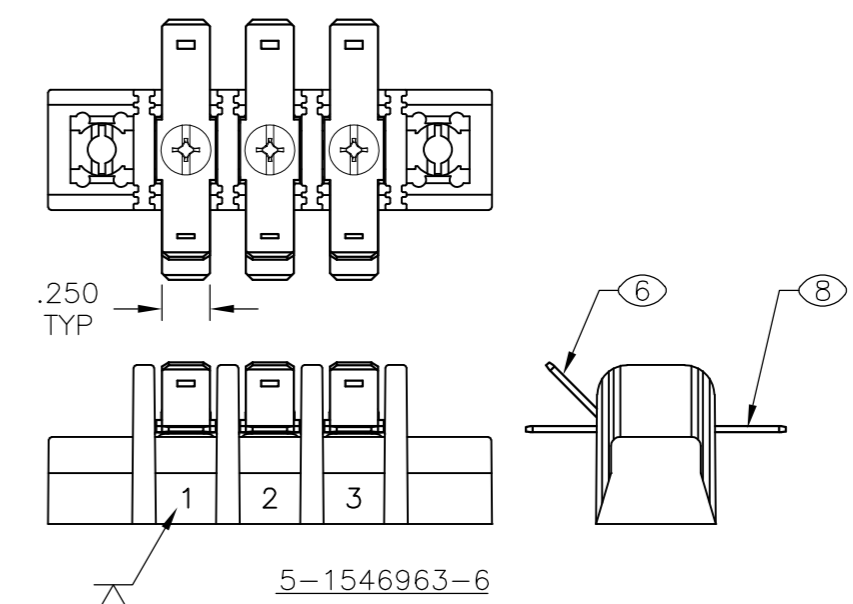
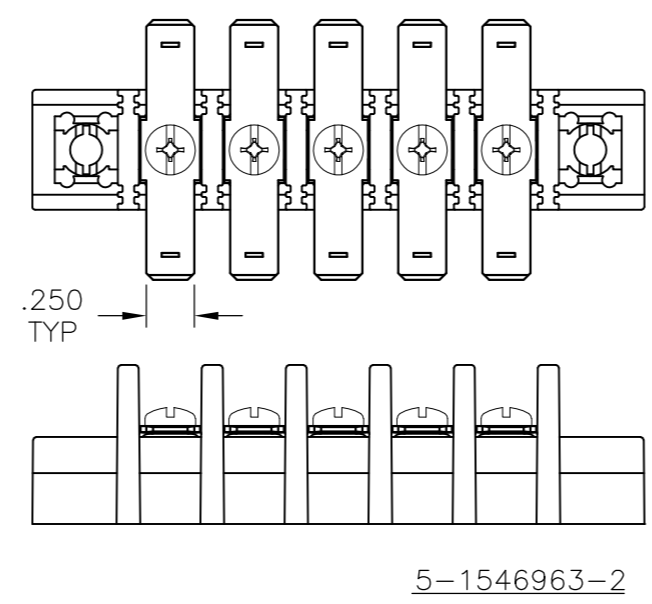
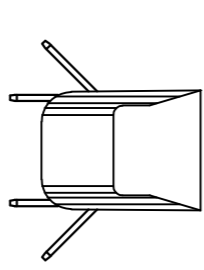
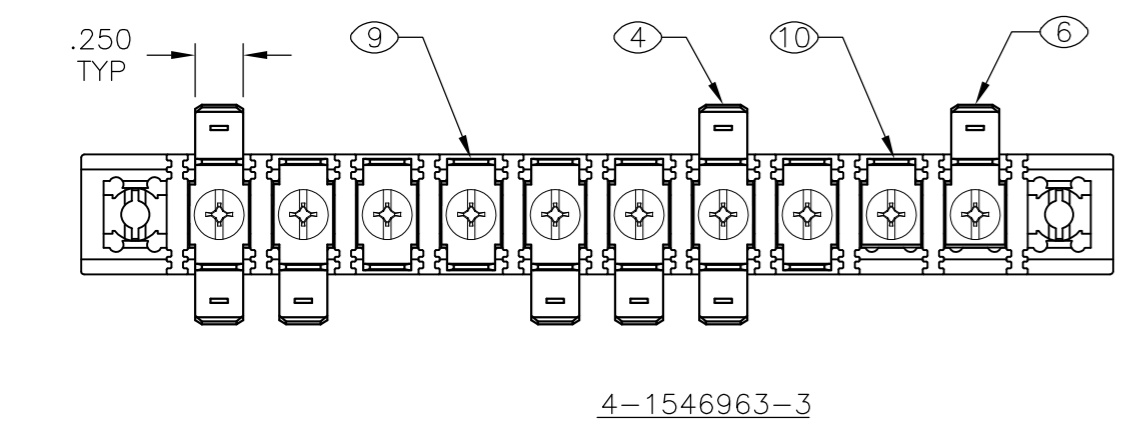
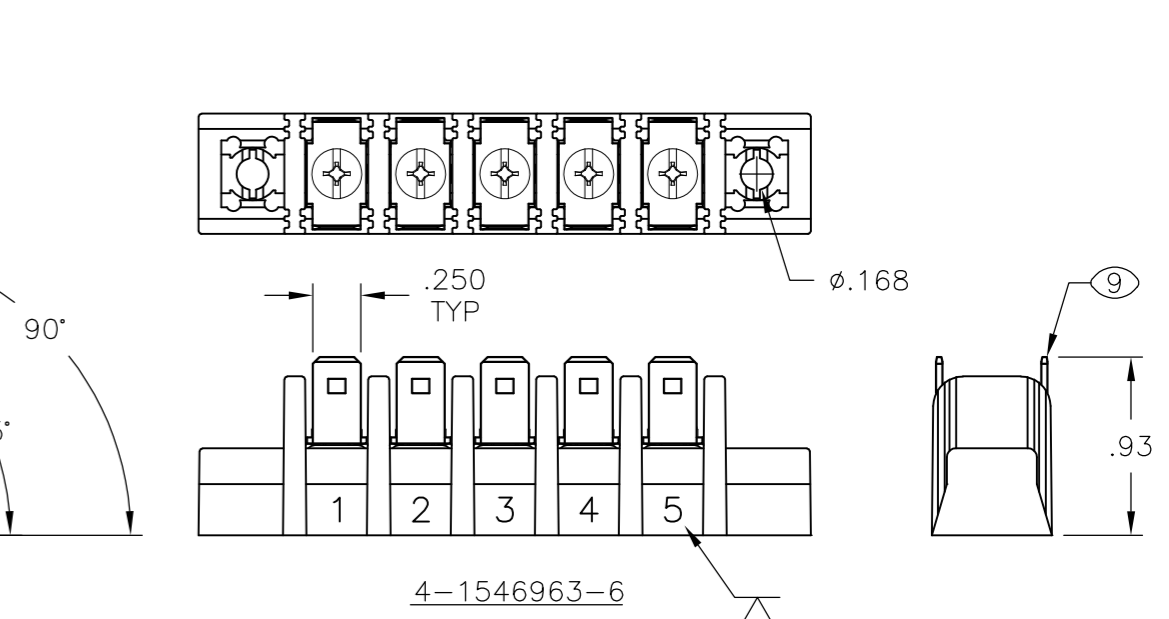
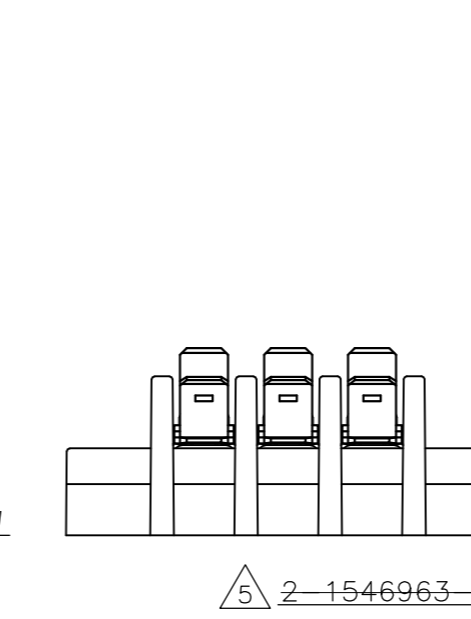
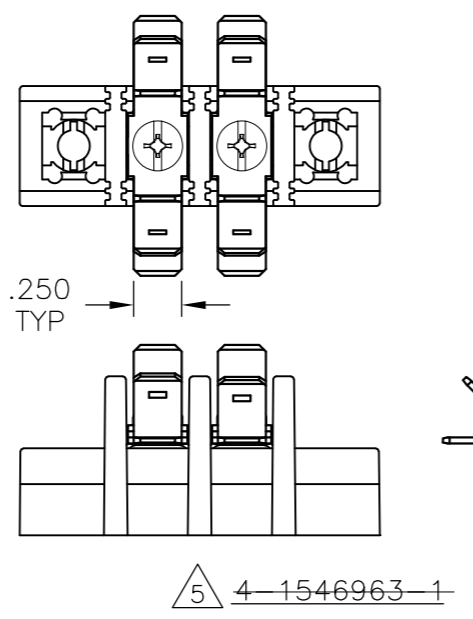
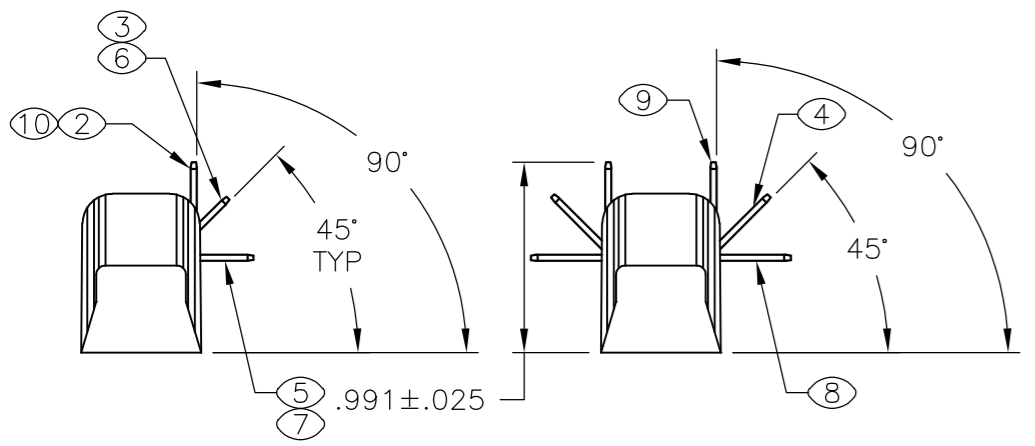
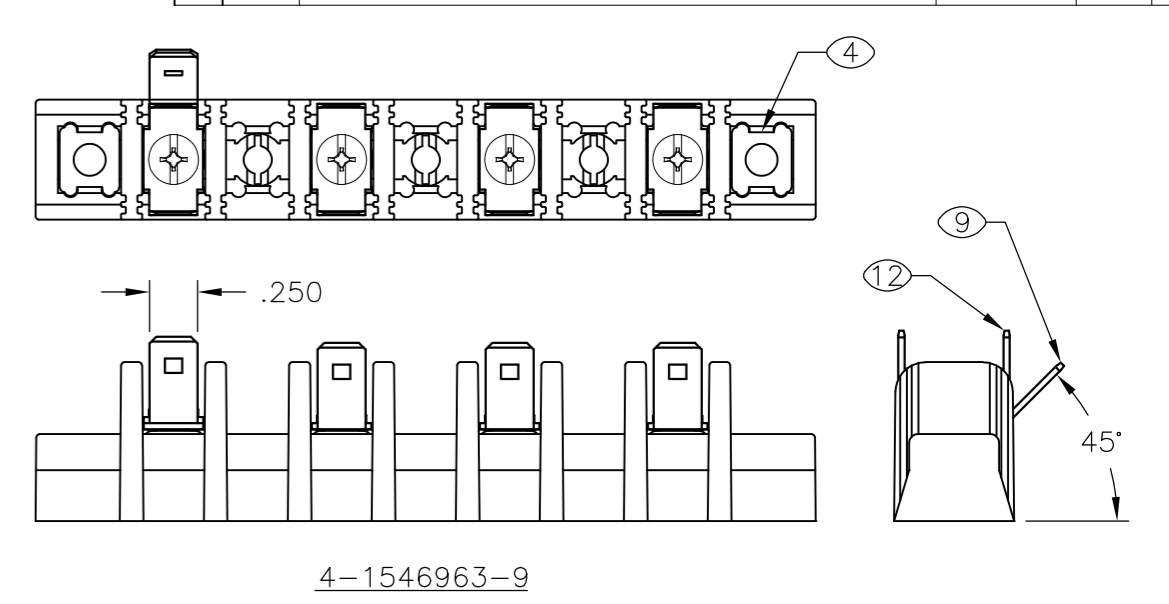
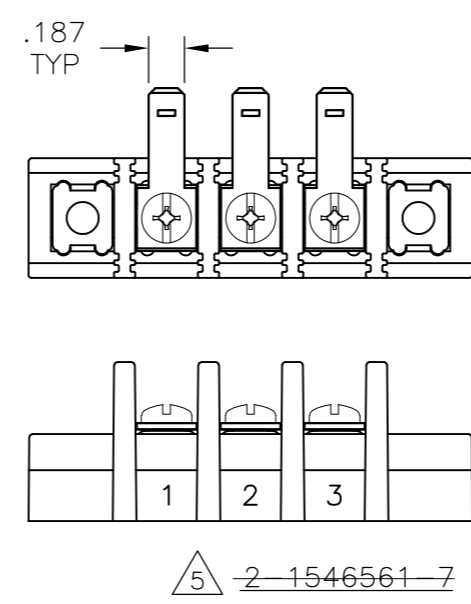
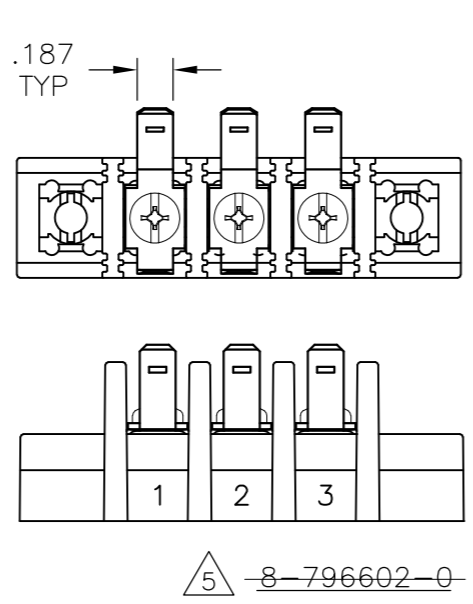
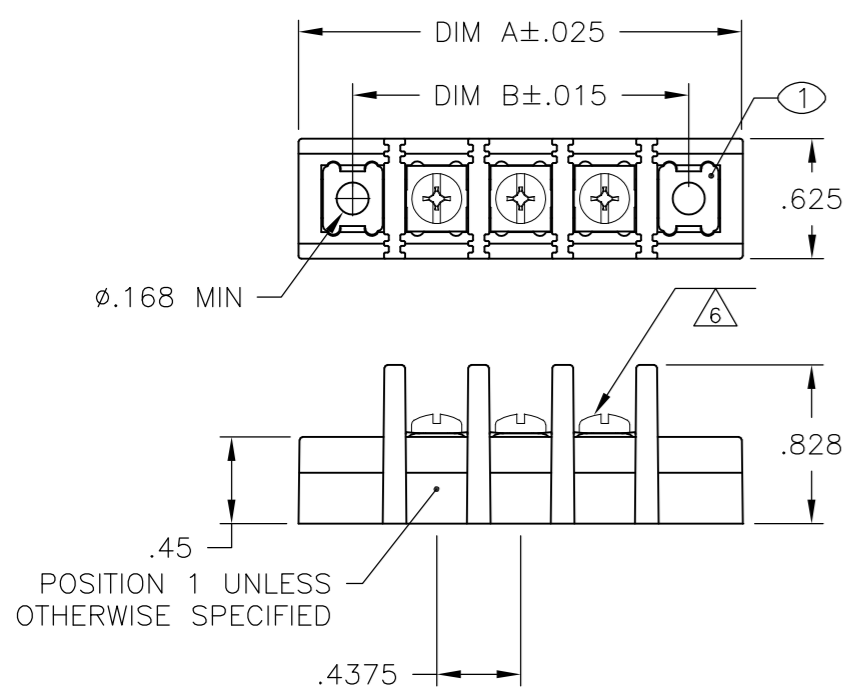

THIS DRAWING IS A CONTROLLED DOCUMENT.		DWN	S SCHLUGEL	3/5/04	 TE Connectivity SSB7CGXX0301
DIMENSIONS: INCHES		CHK	S YODER	3/5/04	
TOLERANCES UNLESS OTHERWISE SPECIFIED:		APVD	S YODER	3/5/04	
0 PLC ± - 1 PLC ± - 2 PLC ± .02 3 PLC ± .010 4 PLC ± - ANGLES ± 1° FINISH -		PRODUCT SPEC	-	NAME	
MATERIAL -		APPLICATION SPEC	-	WEIGHT -	SIZE A2
		WEIGHT -	CAGE CODE	00779	DRAWING NO
		CUSTOMER DRAWING	SCALE	NTS	SHEET
				3 of 4	REV
				P	

THIS DRAWING IS UNPUBLISHED. RELEASED FOR PUBLICATION
 © COPYRIGHT - By - ALL RIGHTS RESERVED.

LOC		DIST		REVISIONS			
P	LTR	DATE	DWN	APVD			
FT	0						
		SEE SHEET 1					

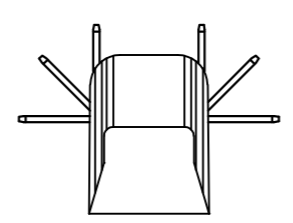
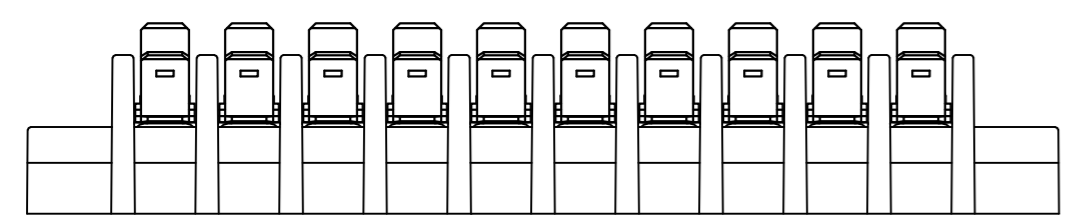
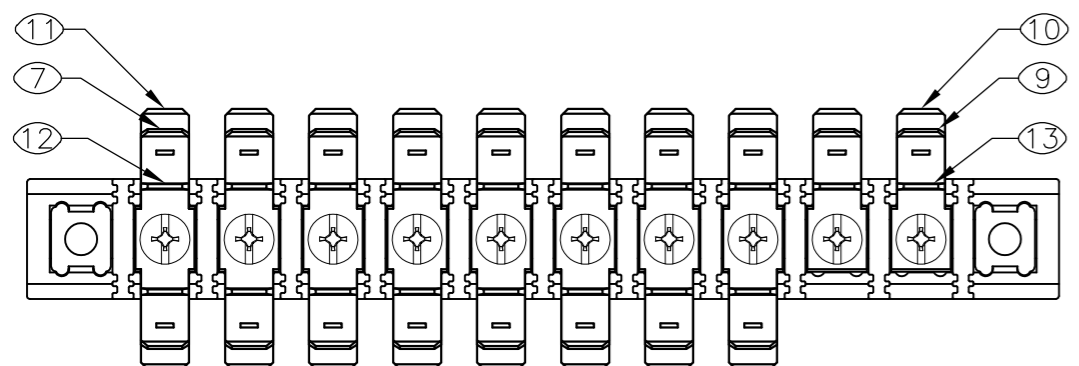

5-1546963-8

THIS DRAWING IS A CONTROLLED DOCUMENT.		DWN	S SCHL GEL	3/5/04		TE Connectivity						
DIMENSIONS: INCHES		CHK	S YODER	3/5/04		NAME						
TOLERANCES UNLESS OTHERWISE SPECIFIED:		APVD	S YODER	3/5/04								
0 PLC ± - 1 PLC ± - 2 PLC ± .02 3 PLC ± .010 4 PLC ± - ANGLES ± 1°		PRODUCT SPEC	SSB7CGXX0301									
MATERIAL		FINISH	WEIGHT	-	SIZE	A2	CAGE CODE	00779	DRAWING NO	C=8-796602-0	RESTRICTED TO	-
-		-	CUSTOMER DRAWING		SCALE	NTS	SHEET	4 of 4	REV	P		

8-796602-0