



Chipsmall Limited consists of a professional team with an average of over 10 year of expertise in the distribution of electronic components. Based in Hongkong, we have already established firm and mutual-benefit business relationships with customers from,Europe,America and south Asia,supplying obsolete and hard-to-find components to meet their specific needs.

With the principle of “Quality Parts,Customers Priority,Honest Operation,and Considerate Service”,our business mainly focus on the distribution of electronic components. Line cards we deal with include Microchip,ALPS,ROHM,Xilinx,Pulse,ON,Everlight and Freescale. Main products comprise IC,Modules,Potentiometer,IC Socket,Relay,Connector.Our parts cover such applications as commercial,industrial, and automotives areas.

We are looking forward to setting up business relationship with you and hope to provide you with the best service and solution. Let us make a better world for our industry!



Contact us

Tel: +86-755-8981 8866 Fax: +86-755-8427 6832

Email & Skype: info@chipsmall.com Web: www.chipsmall.com

Address: A1208, Overseas Decoration Building, #122 Zhenhua RD., Futian, Shenzhen, China



THIS DRAWING IS UNPUBLISHED. RELEASED FOR PUBLICATION
 © COPYRIGHT - By - ALL RIGHTS RESERVED.

LOC	DIST	REVISIONS					
AF	50	P	LTR	DESCRIPTION	DATE	DWN	APVD
		M3		REV PER ECO 11-005523	17MAR11	JR	PD

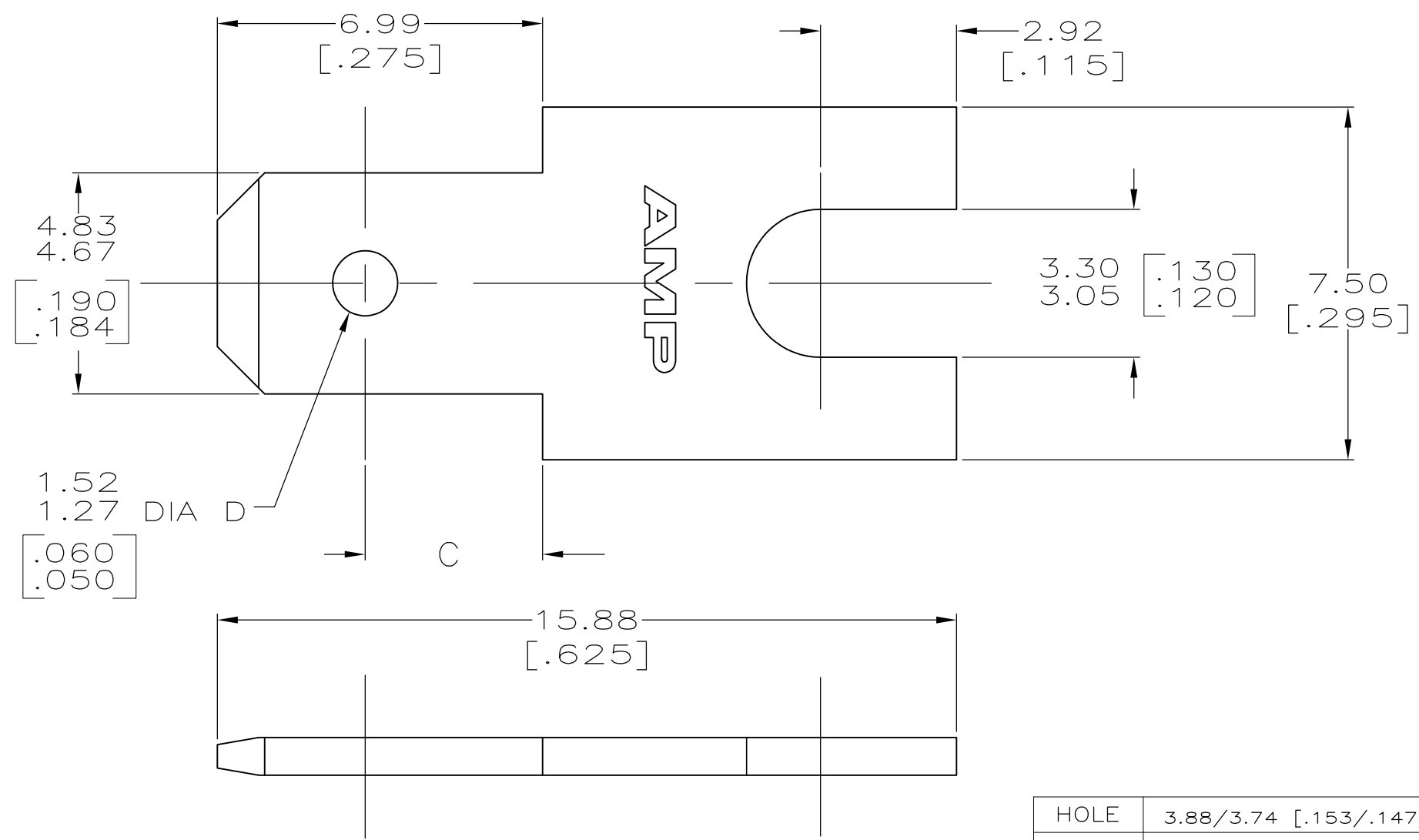

1 SUPPLIED IN LOOSE PIECE.

HOLE	3.88/3.74 [.153/.147]	—	0.813±0.013 [.0320±.0005]	T3 CRS	1-60443-0
HOLE	3.88/3.74 [.153/.147]	—	0.506±0.013 [.0200±.0005]	T3 CRS	60443-9
HOLE	4.52/4.37 [.178/.172]	—	0.813±0.007 [.0320±.0003]	082 BRASS	60443-8
HOLE	3.88/3.74 [.153/.147]	TIN	0.635±0.007 [.0250±.0003]	082 BRASS	60443-7
HOLE	3.88/3.74 [.153/.147]	TIN	0.813±0.007 [.0320±.0003]	082 BRASS	60443-6
HOLE	3.88/3.74 [.153/.147]	TIN	0.506±0.007 [.0200±.0003]	082 BRASS	60443-5
OBS DIMPLE	4.52/4.37 [.178/.172]	—	0.813±0.007 [.0320±.0003]	082 BRASS	60443-4
HOLE	3.88/3.74 [.153/.147]	—	0.635±0.007 [.0250±.0003]	082 BRASS	60443-3
HOLE	3.88/3.74 [.153/.147]	—	0.813±0.007 [.0320±.0003]	082 BRASS	60443-2
HOLE	3.88/3.74 [.153/.147]	—	0.506±0.007 [.0200±.0003]	082 BRASS	60443-1
DIM D	DIM C	FINISH	MATERIAL	PART NO.	

THIS DRAWING IS A CONTROLLED DOCUMENT.

DIMENSIONS: MM [INCHES]	TOLERANCES UNLESS OTHERWISE SPECIFIED:	DWN JR RUTH 1/2/96	STE TE Connectivity
	0 PLC ± - 1 PLC ± - 2 PLC ± 0.25 [.010] 3 PLC ± - 4 PLC ± - ANGLES ± -	CHK P FORTNEY 1/2/96	
MATERIAL SEE TABLE	FINISH SEE TABLE	APVD P DESANTIS 1/2/96	NAME TAB, FASTON, 4.75 [.187] SERIES
		PRODUCT SPEC —	SIZE A3
		APPLICATION SPEC —	CAGE CODE 00779
		WEIGHT —	DRAWING NO C-60443
		CUSTOMER DRAWING	RESTRICTED TO —
		SCALE 8:1	SHEET 1 OF 1
			REV M3