



Chipsmall Limited consists of a professional team with an average of over 10 year of expertise in the distribution of electronic components. Based in Hongkong, we have already established firm and mutual-benefit business relationships with customers from,Europe,America and south Asia,supplying obsolete and hard-to-find components to meet their specific needs.

With the principle of "Quality Parts,Customers Priority,Honest Operation,and Considerate Service",our business mainly focus on the distribution of electronic components. Line cards we deal with include Microchip,ALPS,ROHM,Xilinx,Pulse,ON,Everlight and Freescale. Main products comprise IC,Modules,Potentiometer,IC Socket,Relay,Connector.Our parts cover such applications as commercial,industrial, and automotives areas.

We are looking forward to setting up business relationship with you and hope to provide you with the best service and solution. Let us make a better world for our industry!



Contact us

Tel: +86-755-8981 8866 Fax: +86-755-8427 6832

Email & Skype: info@chipsmall.com Web: www.chipsmall.com

Address: A1208, Overseas Decoration Building, #122 Zhenhua RD., Futian, Shenzhen, China



BINDING POSTS

Designers' Choice



All Keystone binding posts are designed to prevent accidental contact with current carrying parts. They feature a "limited opening" captivated head to insure safety. Ideal for audio circuitry, R.F. Circuitry, oscilloscopes, power supplies and various other applications.

These multi-purpose binding posts feature high current rating, captivated heads and anti-rotation stud mounting.

NOTE: Binding Posts accept .175" Banana Plugs, .080" Tip Plugs, Spade Lugs, Alligator Clips, Wires and EZ hooks.

STANDARD BINDING POST

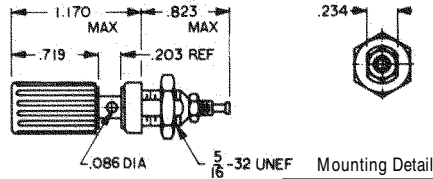
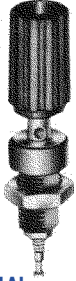

MATERIAL

Stud: Brass per QQ-B-626
Finish: Silver Plate
Insulation: Nylon

RATINGS

Current: 15 Amps
Breakdown voltage: 5700 VRMS
Stud to panel capacitance: 3.3 pF Nominal

FOR PANELS UP TO .281" THICK

CAT. NO.	COLOR
7004	RED
7005	BLACK

MINIATURE FLUTED HEAD

Rated 15 Amperes, 1000 VAC Working. Stud: Brass per ASTM B-16 Nylon Insulation. Choice of Gold or Tin Plate.

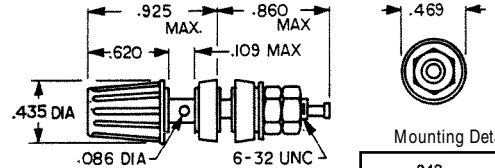

GOLD PLATE

CAT. NO.	COLOR
7012	RED
7013	BLACK

TIN PLATE

CAT. NO.	COLOR
7014	RED
7015	BLACK

ECONOMY BINDING POST

Rated 15 Amps, 1000 VAC working.

Stud: Brass per ASTM -B16

Finish: Nickel Plate

Insulation: Nylon

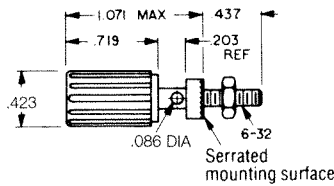
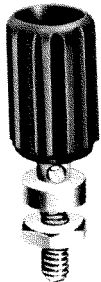

FOR PANELS UP TO .313 THICK

CAT. NO.	COLOR
7006	RED
7007	BLACK

STANDARD HEX HEAD

Rated 30 Amperes, 1000 VAC Working. Nylon Insulation. Stud: Brass per ASTM B-16. Choice of Gold or Tin Plate.

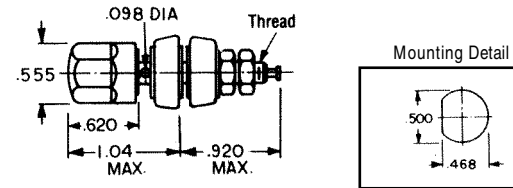

GOLD PLATE

CAT. NO.	TH'D	COLOR
4096	8-32	RED
4097	8-32	BLACK
7016	10-32	RED
7017	10-32	BLACK

TIN PLATE

CAT. NO.	TH'D	COLOR
4091	8-32	RED
4092	8-32	BLACK
4093	10-32	RED
4094	10-32	BLACK

STANDARD DUAL HEAD

Rated 30 Amperes, 1000 VAC working. Studs: Brass per ASTM B-16. Nylon Insulation. Mounts in .500 holes on .750 centers. Supplied with: 1 Red-1 Black head. Choice of Gold or Tin Plate.

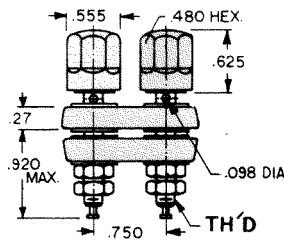
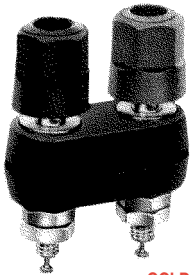

GOLD PLATE

CAT. NO.	THREAD
4108	8-32
4109	10-32

TIN PLATE

CAT. NO.	THREAD
7018	8-32
7019	10-32

DUAL BANANA PLUGS

Spring: Nickel Silver. Body: Brass per ASTM B-16. Finish: Nickel Plate. Insulation: Molded Nylon. .750 Mounting Centers. Breakdown: 3500 VRMS

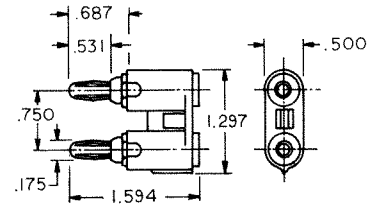
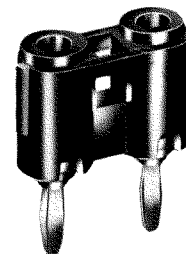

SOLDERLESS WITH SET SCREW

CAT. NO.	COLOR
6088	RED
6089	BLACK