



Chipsmall Limited consists of a professional team with an average of over 10 year of expertise in the distribution of electronic components. Based in Hongkong, we have already established firm and mutual-benefit business relationships with customers from,Europe,America and south Asia,supplying obsolete and hard-to-find components to meet their specific needs.

With the principle of “Quality Parts,Customers Priority,Honest Operation,and Considerate Service”,our business mainly focus on the distribution of electronic components. Line cards we deal with include Microchip,ALPS,ROHM,Xilinx,Pulse,ON,Everlight and Freescale. Main products comprise IC,Modules,Potentiometer,IC Socket,Relay,Connector.Our parts cover such applications as commercial,industrial, and automotives areas.

We are looking forward to setting up business relationship with you and hope to provide you with the best service and solution. Let us make a better world for our industry!



Contact us

Tel: +86-755-8981 8866 Fax: +86-755-8427 6832

Email & Skype: info@chipsmall.com Web: www.chipsmall.com

Address: A1208, Overseas Decoration Building, #122 Zhenhua RD., Futian, Shenzhen, China



LOC	DIST	REVISIONS					
CM	52	P	LTR	DESCRIPTION	DATE	DWN	APVD
			J	REV PER EC 0L30-0273-97	12-11-97	JH	RS

1. WIRE RANGE: 0.2 - 0.6 MM² (24 - 20 AWG)
2. INSULATION RANGE: 1.78 MAX

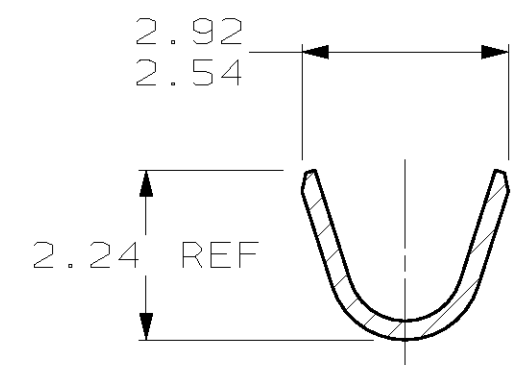
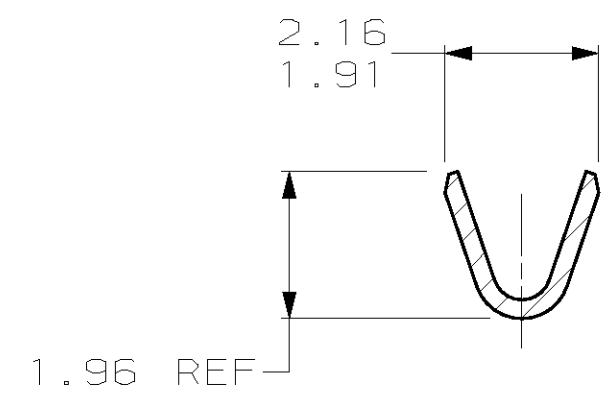
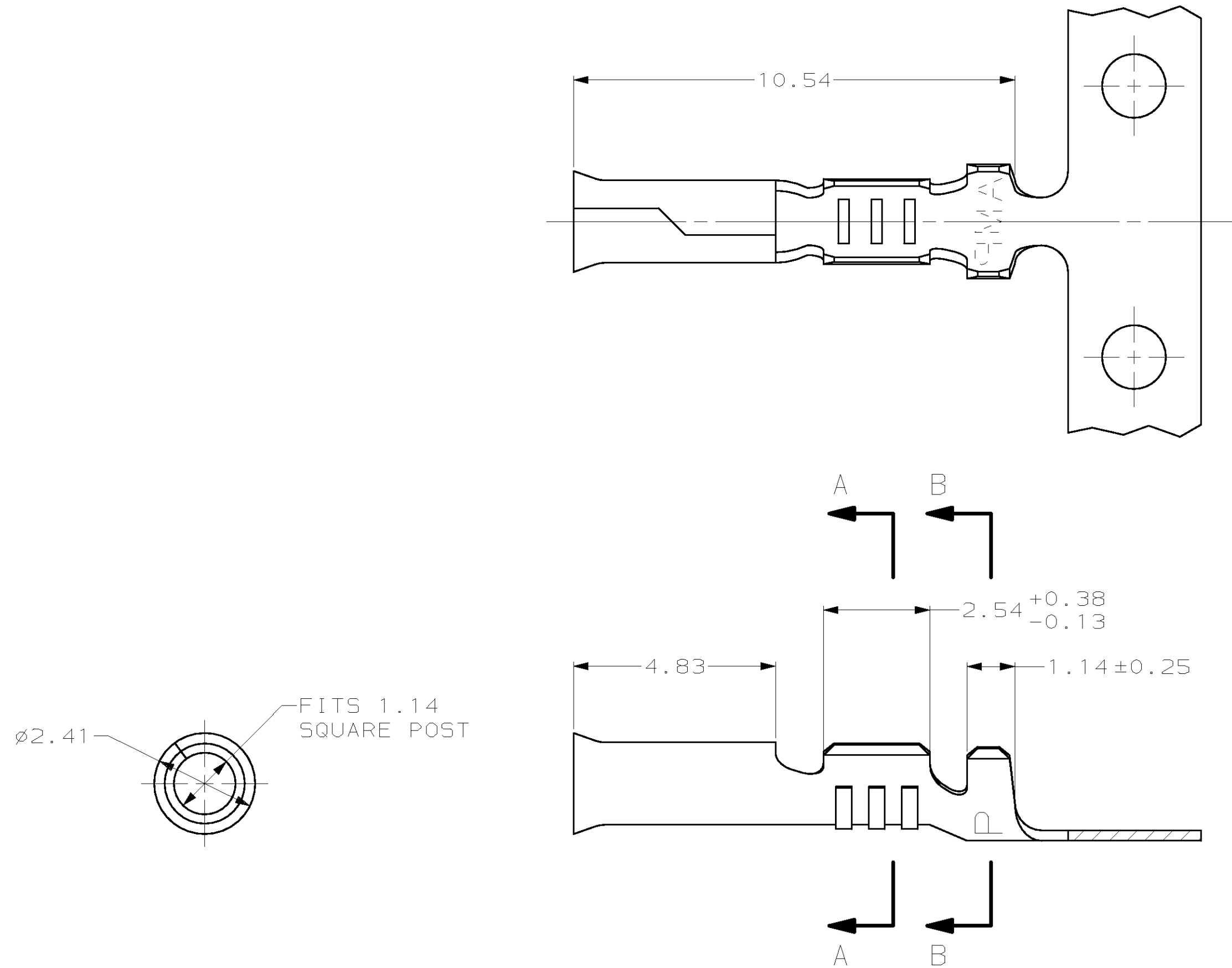

0	2.03	4.06	F	1.40	1.02	0.5 MM ² (20 AWG)
					0.94	0.3 MM ² (22 AWG)
					0.84	0.2 MM ² (24 AWG)
TYPE	WIDTH	STRIP LENGTH ±0.38	TYPE	WIDTH	HEIGHT ±0.05	WIRE
INSULATION BARREL CRIMP		WIRE BARREL CRIMP				

61622-1
PART NUMBER

0.84	.033	1.91	.075	2.54	.100	—	—
0.38	.015	1.78	.070	2.41	.095	—	—
0.25	.010	1.40	.055	2.24	.088	10.54	.415
0.13	.005	1.14	.045	2.16	.085	4.83	.190
0.05	.002	1.02	.040	2.03	.080	4.06	.160
0.0035	.00014	0.94	.037	1.96	.077	2.92	.115
MM	IN	MM	IN	MM	IN	MM	IN

CONVERSION TABLE

METRIC

THIS DRAWING IS A CONTROLLED DOCUMENT.

DIMENSIONS:
mm

MATERIAL

0.25 BRASS

TOLERANCES UNLESS OTHERWISE SPECIFIED:

0 PLC ±-

1 PLC ±-

2 PLC ±0.13

3 PLC ±-

4 PLC ±-

FINISH

0.0035 MAX PRE-TIN

DWN

T. BECK

6-30-97

CHK

R. SWING

6-30-97

APVD

A. BEDDICK

8-22-97

PRODUCT SPEC

108-1025

APPLICATION SPEC

114-1008

WEIGHT

—

CUSTOMER DRAWING

NAME

POST RECEPTACLE, .045 SQUARE, 24-20 AWG, .070 MAX INSULATION, P.C. CONTACT

SIZE

A2

CAGE CODE

00779

DRAWING NO

61622

RESTRICTED TO

—

SCALE

10:1

SHEET

1

OF

1

REV

J

AMP

AMP Incorporated

Harrisburg, PA 17105-3608