



Chipsmall Limited consists of a professional team with an average of over 10 year of expertise in the distribution of electronic components. Based in Hongkong, we have already established firm and mutual-benefit business relationships with customers from,Europe,America and south Asia,supplying obsolete and hard-to-find components to meet their specific needs.

With the principle of “Quality Parts,Customers Priority,Honest Operation,and Considerate Service”,our business mainly focus on the distribution of electronic components. Line cards we deal with include Microchip,ALPS,ROHM,Xilinx,Pulse,ON,Everlight and Freescale. Main products comprise IC,Modules,Potentiometer,IC Socket,Relay,Connector.Our parts cover such applications as commercial,industrial, and automotives areas.

We are looking forward to setting up business relationship with you and hope to provide you with the best service and solution. Let us make a better world for our industry!



Contact us

Tel: +86-755-8981 8866 Fax: +86-755-8427 6832

Email & Skype: info@chipsmall.com Web: www.chipsmall.com

Address: A1208, Overseas Decoration Building, #122 Zhenhua RD., Futian, Shenzhen, China



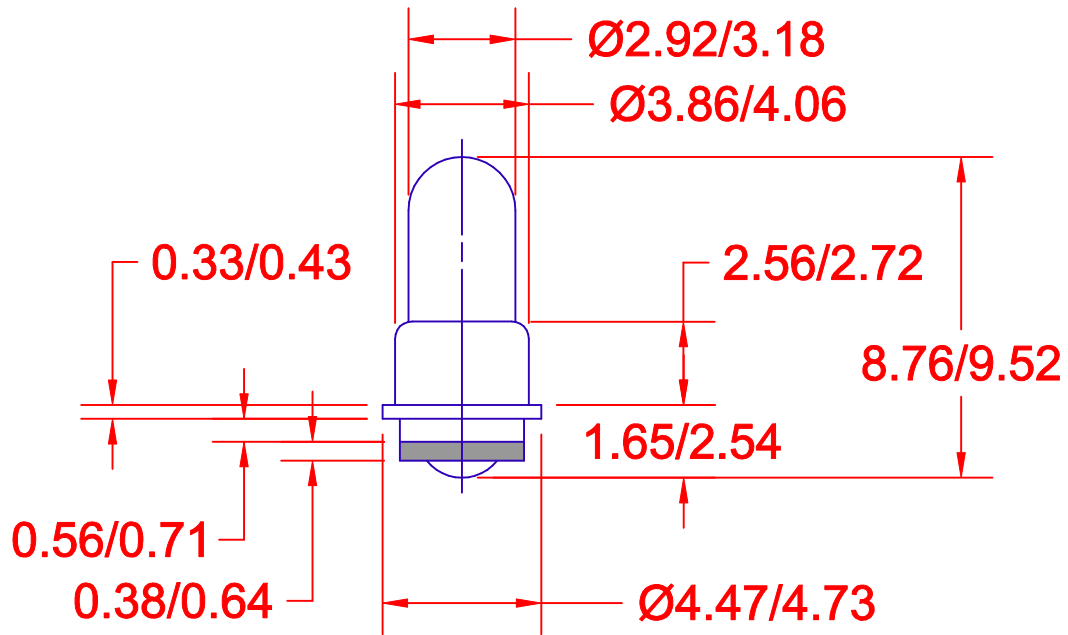

NOTES:

1. GLASS ENVELOPE TO BE TIPLESS AND SEAMLESS.
2. BASE MATERIAL: BRASS, NICKEL PLATED.
3. LAMPS TO BE 100% AGED FOR EQUIVALENT OF TEN HOURS AT RATED VOLTAGE.
4. LAMPS TO BE DIESUNK WITH "JKL" AND NUMBER (EX: JKL 8270).
5. FINAL INSPECTION PER MIL. STD. 105D TO AN AQL OF 2.5 (NOTE: AS15 AND AS10 LAMPS WILL BE 100% INSPECTED FOR MSCP AND AMPERAGE).

JKL LAMP NUMBER	VOLTS RATED	AMPS ±10%	MSCP ±25%	LUMENS ±25%	AVERAGE LIFE HRS.	FILAMENT TYPE
8102	1.5	.075	.030	0.38	16,000	C-2R
CF23	5.0	.020	.020	0.25	50,000	C-2R
8022	5.0	.021	.034	0.43	10,000	C-2R
7234	5.0	.030	.030	0.38	16,000	C-2R
682	5.0	.060	.030	0.38	100,000	C-2R
685	5.0	.060	.050	0.63	100,000	C-2R
6180	5.0	.060	.150	1.89	5,000	C-2R
714	5.0	.075	.090	1.13	25,000	C-2R
718	5.0	.115	.150	1.89	40,000	C-2R
7240	10.0	.027	.100	1.26	10,000	C-2F
32	12.0	.060	.150	1.89	16,000	C-2F
22	14.0	.040	.150	1.89	16,000	C-2F
8112	14.0	.065	.150	1.89	16,000	C-2F
7241	18.0	.026	.150	1.89	16,000	C-2F
CF16	28.0	.016	.025	0.31	16,000	C-2F
6839	28.0	.024	.150	1.89	16,000	CC-2F

<p>THIRD ANGLE PROJECTION</p>		<p>METRIC</p>		<p>DIMENSIONS ARE IN MILLIMETERS</p>		<p>JKL COMPONENTS CORPORATION</p>	
		<p>TOLERANCE UNLESS OTHERWISE SPECIFIED</p> <p>1 PL +/- 0.2</p> <p>2 PL +/- 0</p> <p>ANGLE +/- 0</p>		<p>TITLE</p> <p>T-1 STANDARD MIDGET FLANGE</p>			
<p>RELEASE & CANCEL 7247, 7231, 7232, CF43, 7250, CF30, CF44, CF45,</p>		<p>4/5/00</p>		<p>APPV'D BY DATE</p> <p>L. WENGSTROM BW 4/5/00</p>		<p>SIZE FSCM NO. DRAWING NO.</p> <p>A 55335</p>	
<p>DESCRIPTION/ECO NUMBER</p>		<p>APPV'D DATE</p>		<p>SCALE</p> <p>NONE</p>		<p>REVISION DATE</p> <p>4/5/00</p>	
<p>REV. NO.</p>		<p>DESCRIPTION/ECO NUMBER</p>		<p>MANUAL REVISIONS NOT PERMITTED</p>		<p>REV. NO. SHEET</p> <p>1 OF 1</p>	