



Chipsmall Limited consists of a professional team with an average of over 10 year of expertise in the distribution of electronic components. Based in Hongkong, we have already established firm and mutual-benefit business relationships with customers from,Europe,America and south Asia,supplying obsolete and hard-to-find components to meet their specific needs.

With the principle of "Quality Parts,Customers Priority,Honest Operation,and Considerate Service",our business mainly focus on the distribution of electronic components. Line cards we deal with include Microchip,ALPS,ROHM,Xilinx,Pulse,ON,Everlight and Freescale. Main products comprise IC,Modules,Potentiometer,IC Socket,Relay,Connector.Our parts cover such applications as commercial,industrial, and automotives areas.

We are looking forward to setting up business relationship with you and hope to provide you with the best service and solution. Let us make a better world for our industry!



## Contact us

Tel: +86-755-8981 8866 Fax: +86-755-8427 6832

Email & Skype: info@chipsmall.com Web: www.chipsmall.com

Address: A1208, Overseas Decoration Building, #122 Zhenhua RD., Futian, Shenzhen, China



THIS DRAWING IS UNPUBLISHED. RELEASED FOR PUBLICATION  
 © COPYRIGHT - BY TYCO ELECTRONICS CORPORATION. ALL RIGHTS RESERVED.

LOC	DIST	REVISIONS					
AF	50	P	LTR	DESCRIPTION	DATE	DWN	APVD
			H1	REV PER ECR-06-018933	11AUG06	HMR	KR

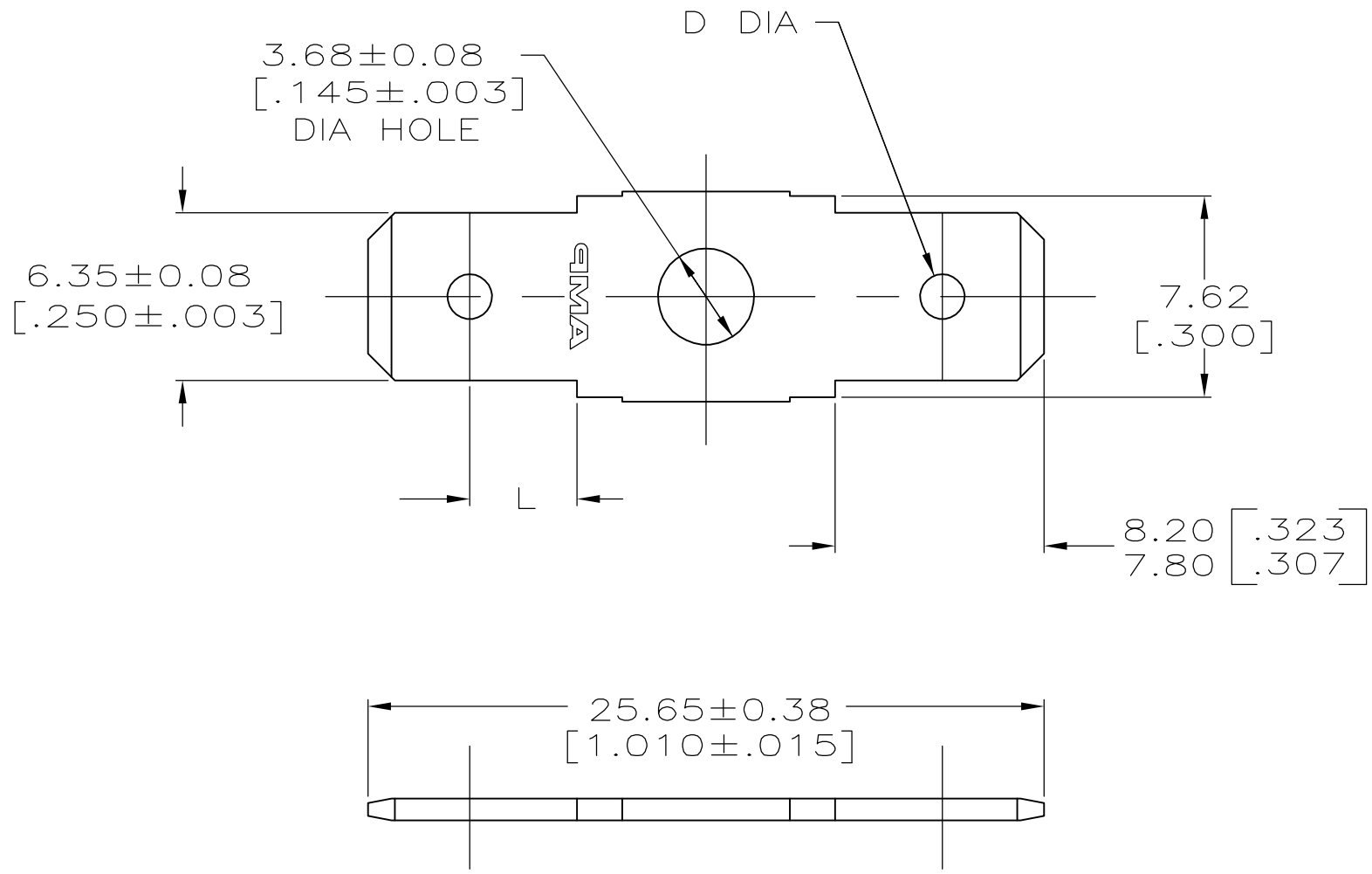

- 1 SUPPLIED IN LOOSE PIECE.
- 2 ELECTRICAL TEST TAB ONLY.
- 3 PRELIMINARY - NOT FOR PRODUCTION

2.03 [.080] 1.93 [.076] DIA HOLE	4.01±0.08 [.158±.003]	0.002032 [.000080] MIN TIN	0.813±0.012 [.032±.0005] CR STEEL	62627-4 <span style="border: 1px solid black; padding: 2px;">3</span>
2.03 [.080] 1.65 [.065] DIA HOLE	3.40±0.08 [.134±.003]	-	0.813±0.007 [.032±.0003] BRASS	62627-3
2.03 [.080] 1.65 [.065] DIA DIMPLE	4.06±0.08 [.160±.003]	-	0.813±0.007 [.032±.0003] BRASS	62627-2
		0.002032 [.000080] MIN TIN	0.813±0.012 [.032±.0005] CR STEEL	62627-1 <span style="border: 1px solid black; padding: 2px;">2</span>
DIM D	DIM L	FINISH	MATERIAL	PART NO.

THIS DRAWING IS A CONTROLLED DOCUMENT.		DWN	8/6/96	 Tyco Electronics Corporation Harrisburg, PA 17105-3608											
DIMENSIONS: mm [INCHES]		CHK	8/6/96												
TOLERANCES UNLESS OTHERWISE SPECIFIED:		APVD	8/6/96												
<table border="0"> <tr><td>0 PLC</td><td>± -</td></tr> <tr><td>1 PLC</td><td>± -</td></tr> <tr><td>2 PLC</td><td>± 0.25 [.010]</td></tr> <tr><td>3 PLC</td><td>± -</td></tr> <tr><td>4 PLC</td><td>± -</td></tr> <tr><td>ANGLES</td><td>± -</td></tr> </table>		0 PLC	± -		1 PLC	± -	2 PLC	± 0.25 [.010]	3 PLC	± -	4 PLC	± -	ANGLES	± -	PRODUCT SPEC
0 PLC	± -														
1 PLC	± -														
2 PLC	± 0.25 [.010]														
3 PLC	± -														
4 PLC	± -														
ANGLES	± -														
MATERIAL SEE TABLE		FINISH	SEE TABLE	NAME											
		APPLICATION SPEC		-											
		WEIGHT		-											
		CUSTOMER DRAWING		SCALE 4:1											
		SIZE A3 00779 C-62627		SHEET 1 OF 1											
				REV H1											