



Chipsmall Limited consists of a professional team with an average of over 10 year of expertise in the distribution of electronic components. Based in Hongkong, we have already established firm and mutual-benefit business relationships with customers from,Europe,America and south Asia,supplying obsolete and hard-to-find components to meet their specific needs.

With the principle of “Quality Parts,Customers Priority,Honest Operation,and Considerate Service”,our business mainly focus on the distribution of electronic components. Line cards we deal with include Microchip,ALPS,ROHM,Xilinx,Pulse,ON,Everlight and Freescale. Main products comprise IC,Modules,Potentiometer,IC Socket,Relay,Connector.Our parts cover such applications as commercial,industrial, and automotives areas.

We are looking forward to setting up business relationship with you and hope to provide you with the best service and solution. Let us make a better world for our industry!



Contact us

Tel: +86-755-8981 8866 Fax: +86-755-8427 6832

Email & Skype: info@chipsmall.com Web: www.chipsmall.com

Address: A1208, Overseas Decoration Building, #122 Zhenhua RD., Futian, Shenzhen, China



FEATURES:

- These screws are specifically designed for securing the covers on our phenolic, die cast aluminum and extruded aluminum boxes.
- Each screw is designed to fit a specific application.
- All are made of high quality carbon steel with zinc plating for the best corrosion resistance.

Figure 1: Model 4864, #2-32 Self-Tapping Phillips

Replaces cover screws used in all die cast aluminum size A, size B and Miniature boxes. Carbon steel with blue zinc plating.

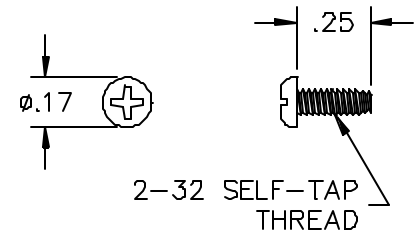

FIGURE 1 MODEL 4864

Figure 2: Model 4862, #4-40 UNC Flat Head Phillips

Replaces cover screws used in all extruded aluminum alloy size F, G & H boxes. Carbon steel with blue zinc plating.

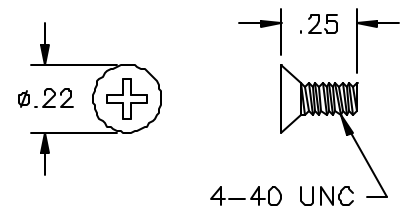

FIGURE 2 MODEL 4862

Figure 3: Model 6268, #4-40 UNC Binding Head Phillips

Replaces cover screws used in die cast aluminum alloy, size C Boxes. Carbon steel with blue zinc plating

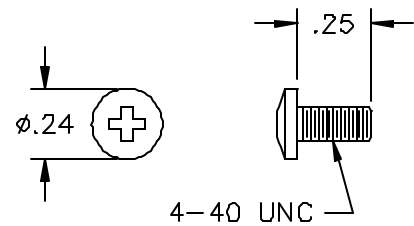

FIGURE 3 MODEL 6268

Figure 4: Model 6269, #2-56 UNC Pan Head Phillips

Replaces cover screws used in phenolic molded boxes. Carbon steel with blue zinc plating.

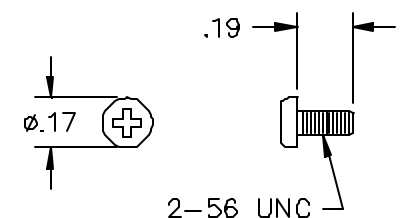

FIGURE 4 MODEL 6269

All dimensions are in inches. Tolerances (except noted): .xx = ±.02" (.51 mm), .xxx = ±.005" (.127 mm).
All specifications are to the latest revisions. Specifications are subject to change without notice.
Registered trademarks are the property of their respective companies. Made in USA