



Chipsmall Limited consists of a professional team with an average of over 10 year of expertise in the distribution of electronic components. Based in Hongkong, we have already established firm and mutual-benefit business relationships with customers from,Europe,America and south Asia,supplying obsolete and hard-to-find components to meet their specific needs.

With the principle of "Quality Parts,Customers Priority,Honest Operation,and Considerate Service",our business mainly focus on the distribution of electronic components. Line cards we deal with include Microchip,ALPS,ROHM,Xilinx,Pulse,ON,Everlight and Freescale. Main products comprise IC,Modules,Potentiometer,IC Socket,Relay,Connector.Our parts cover such applications as commercial,industrial, and automotives areas.

We are looking forward to setting up business relationship with you and hope to provide you with the best service and solution. Let us make a better world for our industry!



## Contact us

Tel: +86-755-8981 8866 Fax: +86-755-8427 6832

Email & Skype: info@chipsmall.com Web: www.chipsmall.com

Address: A1208, Overseas Decoration Building, #122 Zhenhua RD., Futian, Shenzhen, China



DRAWING MADE IN THIRD ANGLE PROJECTION

THIS DRAWING IS UNPUBLISHED. RELEASED FOR PUBLICATION, 19 .  
 © COPYRIGHT 19 BY AMP INCORPORATED, HARRISBURG, PA. ALL INTERNATIONAL RIGHTS RESERVED. AMP PRODUCTS MAY BE COVERED BY U.S. AND FOREIGN PATENTS AND/OR PATENTS PENDING.

LOC DIST  
 AF 50

P		F		ZONE		LTR		REVISIONS		
								DESCRIPTION	DATE	APPROVED
							B	REV & REDRAWN AF-5094	1/20/88	MSF

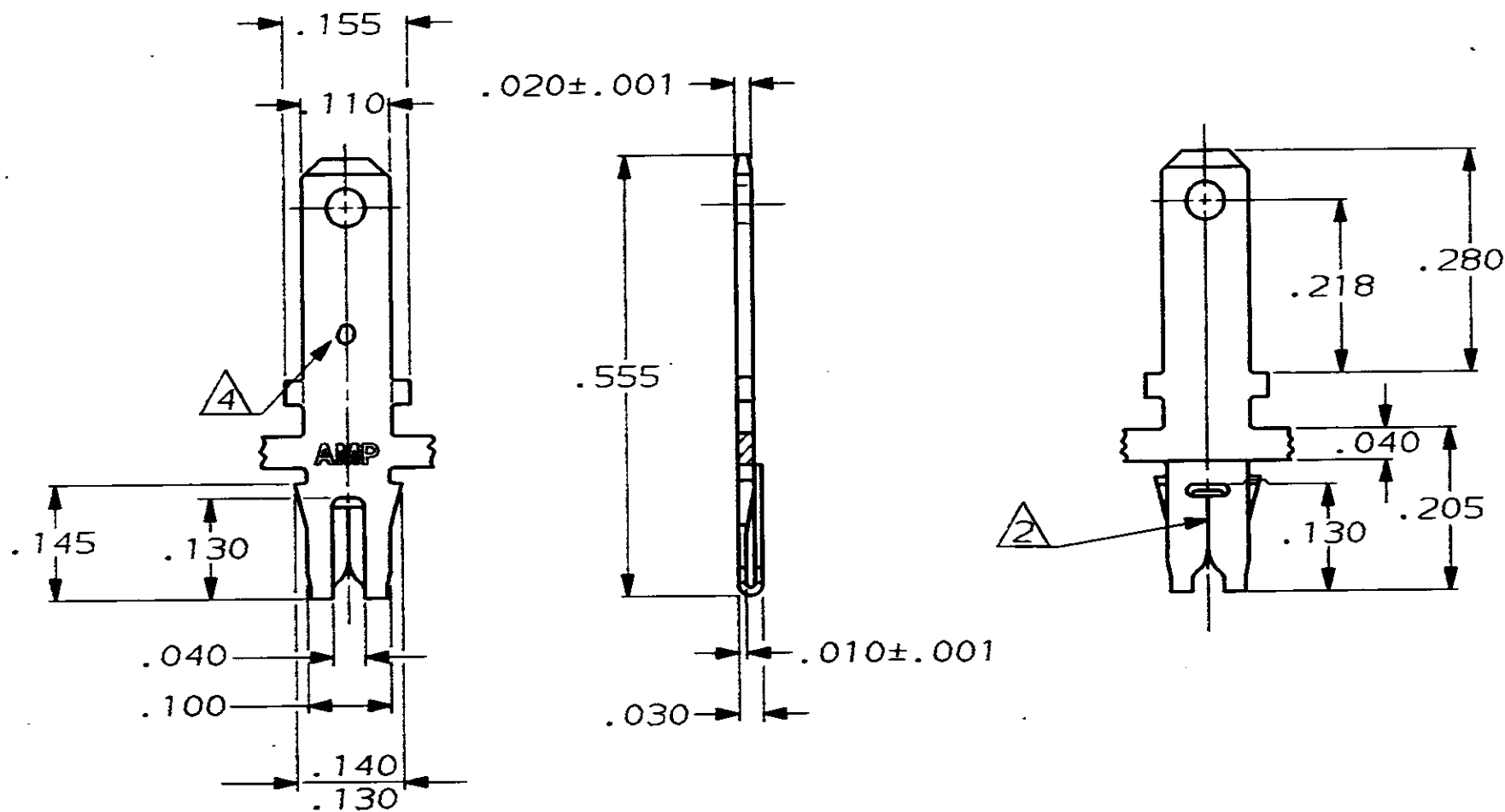

- CONTINUOUS STRIP ON REELS WITH TERMINALS LOCATED ON .220 CENTERS.
- SLOT TO ACCEPT A #34-#32 COPPER MAGNET WIRE ONLY.
- AFTER INSERTION INTO PLASTIC HOLDER, TAB PORTION MUST BE BENT OVER 45° TO 90° OR POTTED TO PREVENT PULL-OUT WHEN MATING RECEPTACLE IS DISCONNECTED.
- IDENTIFICATION NUMBER FOR MAGNET WIRE RANGE.
- MAG-MATE CAVITY SPECIFICATION.

63441-1

PART NO

UNLESS OTHERWISE SPECIFIED DIMENSIONS ARE IN INCHES  
 TOLERANCES ON:  
 2 PL DEC ± -  
 3 PL DEC ± .010  
 ANGLES ± -

MATERIAL  
 #4 HARD BRASS

FINISH  
 TIN

DR: MSF 1/20/88

CHK: G Yetton 1/22/88

APP'D: Nelson E. Toff 1/20/88

1/20/88

PRODUCT SPEC

APPLICATION SPEC  
 114-2099 5

WEIGHT -

**AMP**

AMP INCORPORATED  
 Harrisburg, Pa. 17105

NAME  
 TAB, .110 FASTON,  
 MAG-MATE™, MICRO

SIZE  
**B**

FSCM NO  
 00779

DRAWING NO  
 63441

SCALE  
 5:1

SHEET  
 1 OF 1