



Chipsmall Limited consists of a professional team with an average of over 10 year of expertise in the distribution of electronic components. Based in Hongkong, we have already established firm and mutual-benefit business relationships with customers from,Europe,America and south Asia,supplying obsolete and hard-to-find components to meet their specific needs.

With the principle of “Quality Parts,Customers Priority,Honest Operation,and Considerate Service”,our business mainly focus on the distribution of electronic components. Line cards we deal with include Microchip,ALPS,ROHM,Xilinx,Pulse,ON,Everlight and Freescale. Main products comprise IC,Modules,Potentiometer,IC Socket,Relay,Connector.Our parts cover such applications as commercial,industrial, and automotives areas.

We are looking forward to setting up business relationship with you and hope to provide you with the best service and solution. Let us make a better world for our industry!



Contact us

Tel: +86-755-8981 8866 Fax: +86-755-8427 6832

Email & Skype: info@chipsmall.com Web: www.chipsmall.com

Address: A1208, Overseas Decoration Building, #122 Zhenhua RD., Futian, Shenzhen, China



THIS DRAWING IS UNPUBLISHED. RELEASED FOR PUBLICATION, 19 .
© COPYRIGHT 19 BY AMP INCORPORATED. ALL INTERNATIONAL RIGHTS RESERVED.

LOC	DIST	P	F	REVISIONS				
AF	50			ZONE	LTR	DESCRIPTION	DATE	APPD
					B	REV ECN AF-8012	10-6-92	LAM MSF

IDENTIFICATION NUMBER 5 FOR MAGNET WIRE RANGE

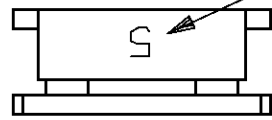

- 1 MAG-MATE CAVITY SPECIFICATION.
- 2 SLOT TERMINATES #31-#28 COPPER MAGNET WIRE EITHER SINGLE OR DOUBLE OF THE SAME SIZE.

.010 MAX CUT-OFF TABS 2 PLACES

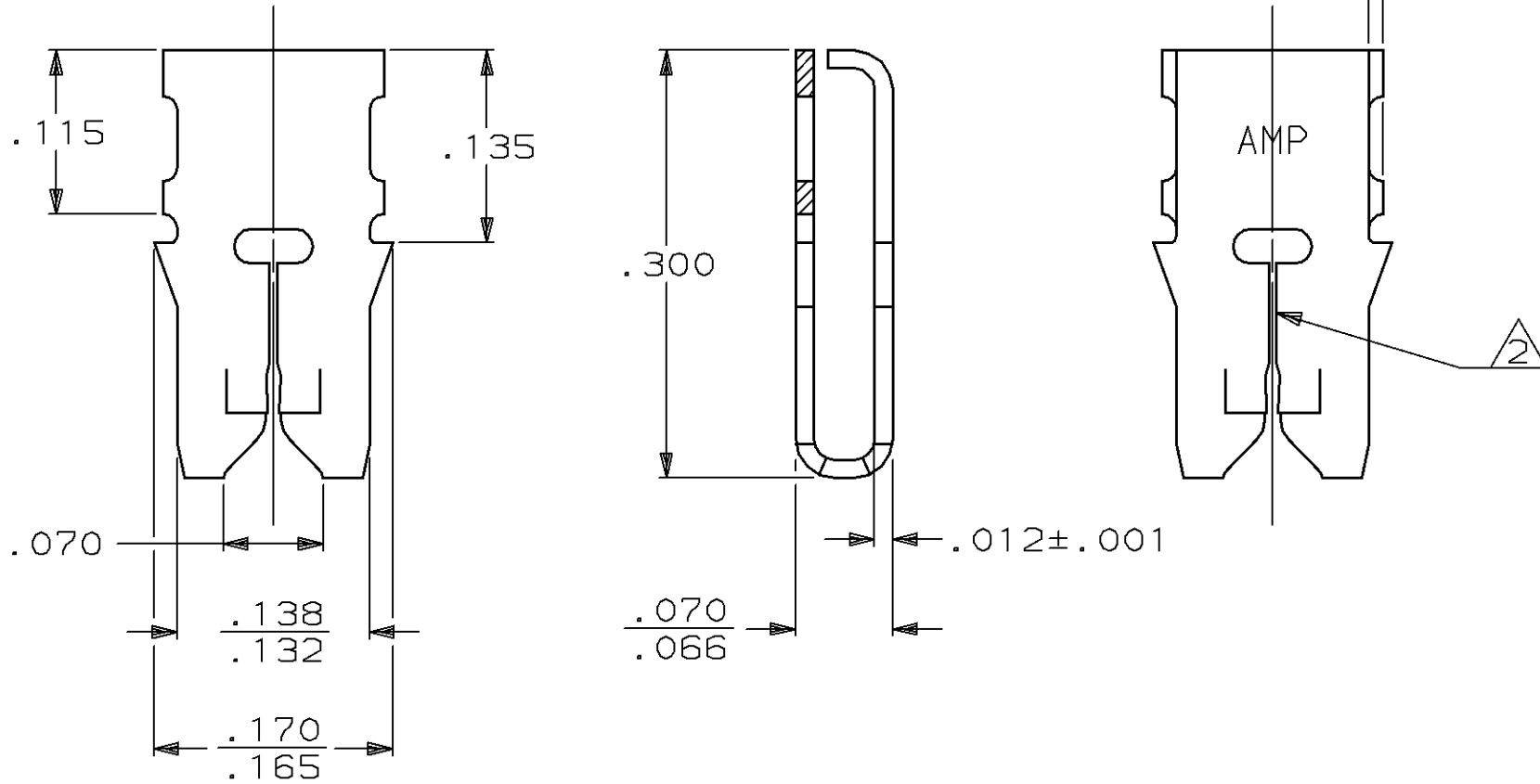

63532-1

PART NO

DO NOT SCALE PRINT. UNLESS SPECIFIED DIMENSIONS IN INCHES TOLERANCES ON:
 2 PLC DEC ± -
 3 PLC DEC ± .010
 ANGLES ± -

DR 3/30/89
MICHAEL S. FEHER
 CHK 4/3/89
JEFF R. RUTH
 APPD 4/4/89
NELSON E. NEFF
 APPD 4/4/89
CHARLES G. ATHERTON
 PRODUCT SPEC -

AMP

AMP INCORPORATED
Harrisburg, Pa. 17105

NAME
TERMINAL, SPLICE,
MAG-MATE™, LOOSE PIECE

MATERIAL
#4 HARD BRASS

FINISH
.000080 MIN TIN
PER MIL-T-10727

APPLICATION SPEC
CP77-7892 1

WEIGHT -

SIZE	FSCM NO	DRAWING NO
B	00779	63532
SCALE	8:1	SHEET
		1 OF 1