



Chipsmall Limited consists of a professional team with an average of over 10 year of expertise in the distribution of electronic components. Based in Hongkong, we have already established firm and mutual-benefit business relationships with customers from,Europe,America and south Asia,supplying obsolete and hard-to-find components to meet their specific needs.

With the principle of “Quality Parts,Customers Priority,Honest Operation,and Considerate Service”,our business mainly focus on the distribution of electronic components. Line cards we deal with include Microchip,ALPS,ROHM,Xilinx,Pulse,ON,Everlight and Freescale. Main products comprise IC,Modules,Potentiometer,IC Socket,Relay,Connector.Our parts cover such applications as commercial,industrial, and automotives areas.

We are looking forward to setting up business relationship with you and hope to provide you with the best service and solution. Let us make a better world for our industry!



Contact us

Tel: +86-755-8981 8866 Fax: +86-755-8427 6832

Email & Skype: info@chipsmall.com Web: www.chipsmall.com

Address: A1208, Overseas Decoration Building, #122 Zhenhua RD., Futian, Shenzhen, China



Model 1166 & 6357 Kit Alligator Clip To Multi-Stacking Banana Plug Patch Cord

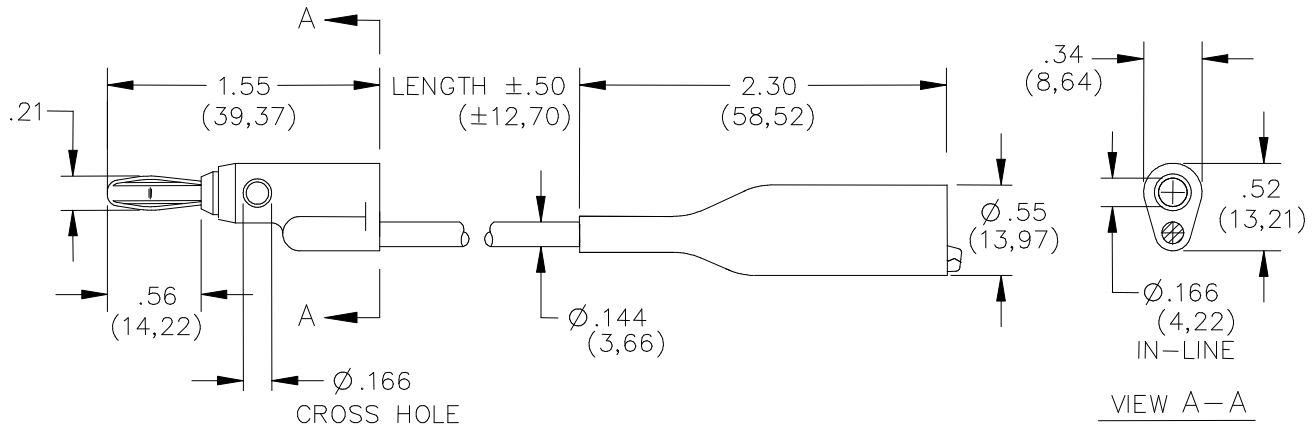

FEATURES:

- Pomona's Alligator Clip to Stacking Banana Plug Patch Cord offers quick attachment to terminals up to .300" O.D.
- The patch cord features a medium size alligator clip with a flex boot for insulation protection. The banana plug spring is Beryllium Copper for long insertion life.
- The banana plug has vertical and horizontal stacking capability.
- The wire conductor has a high number of strands for excellent wire flexibility.
- The banana plug is molded directly to the wire for added pull strength.

MATERIALS:

Insulated Alligator:

Body: Steel, Nickel Plated

Insulator Boot: Vinyl, Color matches wire color

Wire: 18 AWG, Stranding 65 x 36 t.c., PVC

Insulated, 0.144" (3.66 mm) O.D.

Marking: Pomona 1166-XX-*

Body - Brass, Nickel Plated

Color: Referenced by Part Number

Banana Plug:

Spring - Beryllium Copper, Nickel Plated

Insulation: Polypropylene Molded to the Plug Body and Wire. Color Matches Color of Wire.

RATINGS:

Operating Temperature: +50°C Max.

Operating Voltage: Hand-held testing: 30VAC/ .30 VAC Max.

Hands Free Testing in controlled voltage environments: 150 WVDC

Current: 5 Amperes

ORDERING INFORMATION: Model 1166-XX-*
XX = Wire Length, Standard Lengths: 12" (30.48cm), 24" (60.96cm), 36" (91.44cm), 48" (121.92cm) & 60" (152.4cm).

Additional lengths and colors can be quoted upon request.

* = Colors, -0 Black, -2 Red

Ordering Example: 1166-12-2, Patch cord is 12" (30.48cm), color is red.

6357-XX Kit contains 10 patch cords, one each of 10 colors.

All dimensions are in inches. Tolerances (except noted): .xx = ±.02" (.51 mm), .xxx = ±.005" (.127 mm).

All specifications are to the latest revisions. Specifications are subject to change without notice.

Registered trademarks are the property of their respective companies. Made in USA