



Chipsmall Limited consists of a professional team with an average of over 10 year of expertise in the distribution of electronic components. Based in Hongkong, we have already established firm and mutual-benefit business relationships with customers from,Europe,America and south Asia,supplying obsolete and hard-to-find components to meet their specific needs.

With the principle of “Quality Parts,Customers Priority,Honest Operation,and Considerate Service”,our business mainly focus on the distribution of electronic components. Line cards we deal with include Microchip,ALPS,ROHM,Xilinx,Pulse,ON,Everlight and Freescale. Main products comprise IC,Modules,Potentiometer,IC Socket,Relay,Connector.Our parts cover such applications as commercial,industrial, and automotives areas.

We are looking forward to setting up business relationship with you and hope to provide you with the best service and solution. Let us make a better world for our industry!



Contact us

Tel: +86-755-8981 8866 Fax: +86-755-8427 6832

Email & Skype: info@chipsmall.com Web: www.chipsmall.com

Address: A1208, Overseas Decoration Building, #122 Zhenhua RD., Futian, Shenzhen, China



LOC	DIST	REVISIONS					
		P	LTR	DESCRIPTION	DATE	DWN	APVD
AF	50		F	REVISED PER ECR-12-013518	23NOV2012	KH	PD

D

C

B

A

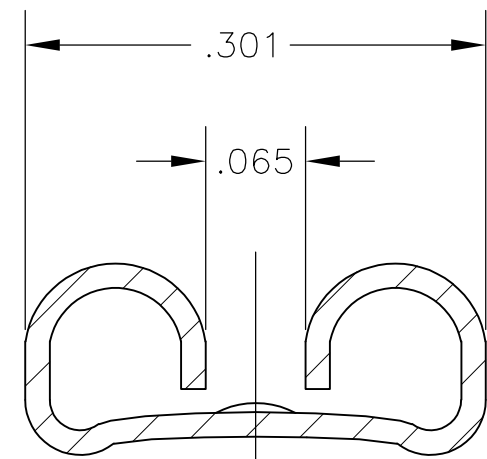
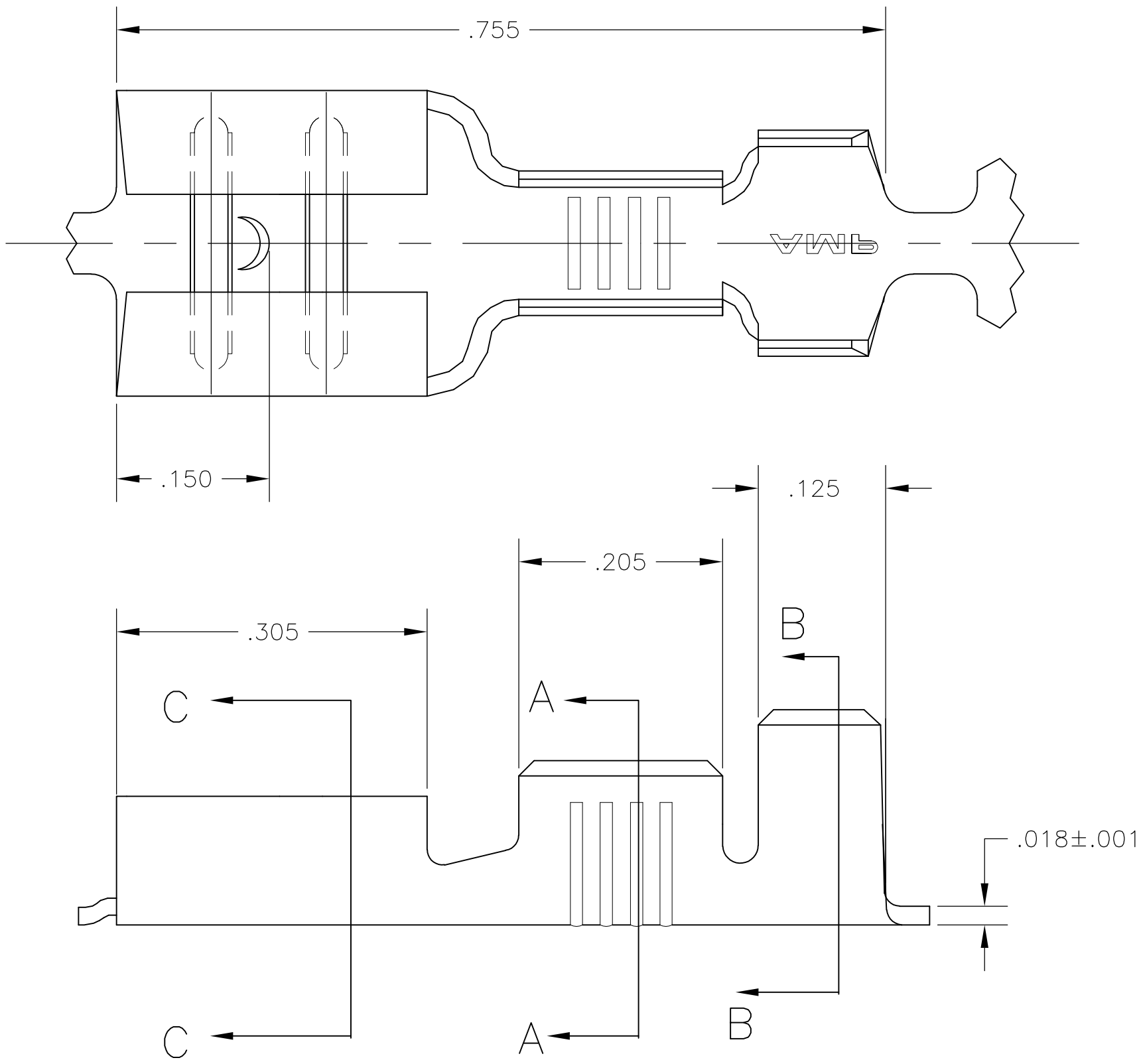

SECTION C-C

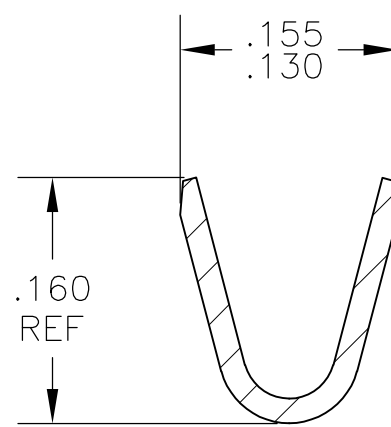

SECTION A-A

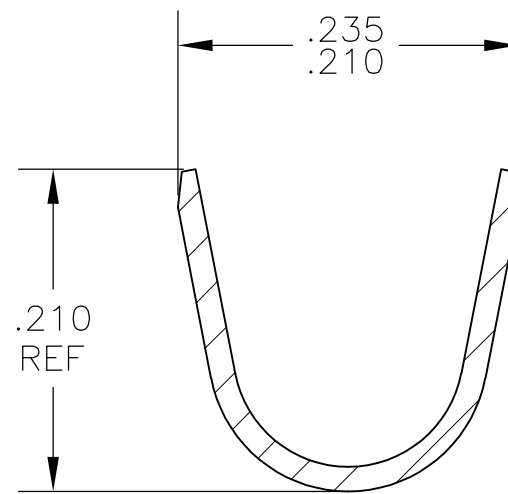

SECTION B-B

- 1 CONTINUOUS STRIP ON REELS
- 2 ACCEPTS #18-#14 AWG WIRE SIZE CRIMP WIDTH, .120, F TYPE
- 3 INSULATION RANGE IS .120-.170 DIA CRIMP WIDTH, .180, F OR O TYPE
- 4 MATING TAB THK IS .020±.001.

D

C

B

A

THIS DRAWING IS A CONTROLLED DOCUMENT.		DWN JR RUTH 25JUN02	<div></div> TE Connectivity				
DIMENSIONS: INCHES		CHK P DESANTIS 24JUN02					
		APVD P DESANTIS 24JUN02					
		PRODUCT SPEC					
TOLERANCES UNLESS OTHERWISE SPECIFIED:		APPLICATION SPEC		NAME		RECEPTACLE, FASTON, .250 SERIES	
0 PLC ± -		114-2036		SIZE	CAGE CODE	DRAWING NO	RESTRICTED TO
1 PLC ± -		WEIGHT -		A2	00779	C=63655	-
2 PLC ± -		CUSTOMER DRAWING					
3 PLC ± .010		SCALE 8:1		SHEET 1 of 1		REV F	
4 PLC ± -							
ANGLES ± -							
FINISH TIN							
MATERIAL BRASS							

63655

63655-1
PART NO