



Chipsmall Limited consists of a professional team with an average of over 10 year of expertise in the distribution of electronic components. Based in Hongkong, we have already established firm and mutual-benefit business relationships with customers from,Europe,America and south Asia,supplying obsolete and hard-to-find components to meet their specific needs.

With the principle of “Quality Parts,Customers Priority,Honest Operation,and Considerate Service”,our business mainly focus on the distribution of electronic components. Line cards we deal with include Microchip,ALPS,ROHM,Xilinx,Pulse,ON,Everlight and Freescale. Main products comprise IC,Modules,Potentiometer,IC Socket,Relay,Connector.Our parts cover such applications as commercial,industrial, and automotives areas.

We are looking forward to setting up business relationship with you and hope to provide you with the best service and solution. Let us make a better world for our industry!



Contact us

Tel: +86-755-8981 8866 Fax: +86-755-8427 6832

Email & Skype: info@chipsmall.com Web: www.chipsmall.com

Address: A1208, Overseas Decoration Building, #122 Zhenhua RD., Futian, Shenzhen, China



THIS IS A C.A.D. GENERATED DRAWING
DO NOT MAKE MANUAL REVISIONS TO MASTER.

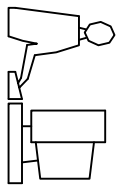

ISSUE NUMBER
ORIGINAL
①

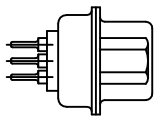
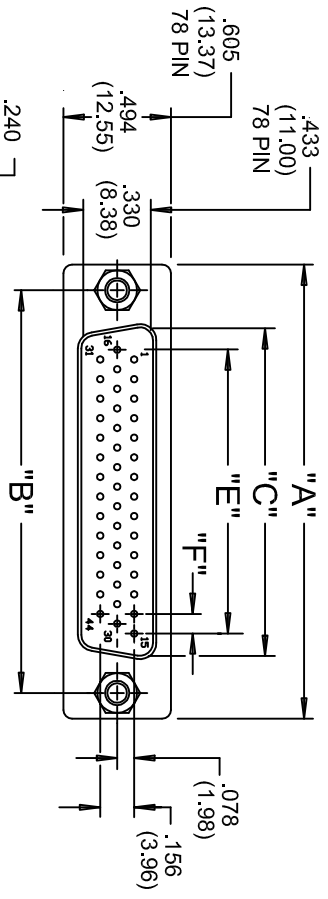

MATERIALS:

INSULATOR: THERMOPLASTIC POLYESTER, UL94V-O
CHEMICAL RESISTANCE, COLOR BLACK

SHEET: STEEL, NICKEL PLATED

CONTACT: BRASS

GOLD FLASH (CONTACT CODE 230)
10 MICRONS GOLD (CONTACT CODE 530)
30 MICRONS GOLD (CONTACT CODE 630)
TIN PLATING ON TAIL ENDS

ELECTRICAL:

CURRENT RATING: 5 AMPERES
DIELECTRIC WITHSTANDING VOLTAGE:
1000VAC rms AT SEA LEVEL
INSULATION RESISTANCE: 5000 MEGOHMS MIN.
CONTACT RESISTANCE: 10 MILLIOHMS MAX.
WORKING TEMPERATURE: -55° TO +125° C

**NOTE: ALL CONNECTORS WITH THREADED INSERTS MUST WITHSTAND
A MIN. TORQUE OF 3 Kgf-cm**

ORDERING CODE

SERIES _____
NUMBER OF CONTACTS _____
CONTACT FINISH CODE _____
CONNECTOR CODE _____
30- LOW PROFILE P.C.B. TAILS
GROUNDING FEATURE _____
4- METAL COVERED
MOUNTING OPTIONAL _____
1- .125(3.18) DIA. THROUGH HOLE
2- 4-40 UNC THREADED INSERT
3- 4-40 UNC THREADED STANDOFFS
6- 4-40 UNC THREADED INSERT WITH BOARDLOCKS
7- 4-40 UNC THREADED STANDOFF WITH BOARDLOCKS
8- 4-40 UNC THREADED FIXED STANDOFF

637-015-230-042

NUMBER OF CONTACTS	"A"		"B"		"C"		"E"		"F"	
	Inch	(mm)	Inch	(mm)	Inch	(mm)	Inch	(mm)	Inch	(mm)
15	1.214	(30.84)	.984	(24.99)	.667	(16.92)	.405	(10.29)	.090	(2.29)
26	1.545	(39.24)	1.312	(33.32)	.994	(25.25)	.765	(19.43)	.090	(2.29)
44	2.088	(53.04)	1.852	(47.04)	1.534	(38.96)	1.305	(33.15)	.090	(2.29)
62	2.730	(69.34)	2.500	(63.50)	2.182	(55.42)	1.948	(49.47)	.095	(2.41)
78	2.635	(66.93)	2.406	(61.11)	2.090	(53.08)	1.805	(45.85)	.095	(2.41)



THIS CONNECTOR FULLY CONFORMS
TO THE EUROPEAN UNION DIRECTIVES
2002/95/EC AND 2002/96/EC FOR
ROHS COMPLIANCY.

**637 SERIES HIGH DENSITY SUBMINIATURE D CONNECTOR
PLUG(PIN) VERTICAL MOUNT P.C.B
LOW PROFILE METAL BODY**

EDAC INC
TORONTO, ONTARIO
CANADA
YOUR CONNECTION TO QUALITY & SERVICE

THESE DRAWINGS AND SPECIFICATIONS
ARE THE PROPERTY OF EDAC INC. AND
SHALL NOT BE REPRODUCED OR COPIED
OR USED AS THE BASIS FOR THE
MANUFACTURE OR SALE OF APPARATUS
WITHOUT WRITTEN PERMISSION.

DRAWN: F. BRIONES	DATE: NOV. 26/97
CHECKED:	DATE:
PART NUMBER	
SEE ORDERING CODE	
DRAWING NUMBER	ISSUE
637-000-001	5