



Chipsmall Limited consists of a professional team with an average of over 10 year of expertise in the distribution of electronic components. Based in Hongkong, we have already established firm and mutual-benefit business relationships with customers from,Europe,America and south Asia,supplying obsolete and hard-to-find components to meet their specific needs.

With the principle of “Quality Parts,Customers Priority,Honest Operation,and Considerate Service”,our business mainly focus on the distribution of electronic components. Line cards we deal with include Microchip,ALPS,ROHM,Xilinx,Pulse,ON,Everlight and Freescale. Main products comprise IC,Modules,Potentiometer,IC Socket,Relay,Connector.Our parts cover such applications as commercial,industrial, and automotives areas.

We are looking forward to setting up business relationship with you and hope to provide you with the best service and solution. Let us make a better world for our industry!



Contact us

Tel: +86-755-8981 8866 Fax: +86-755-8427 6832

Email & Skype: info@chipsmall.com Web: www.chipsmall.com

Address: A1208, Overseas Decoration Building, #122 Zhenhua RD., Futian, Shenzhen, China



LOC	DIST	REVISIONS					
CE	16	P	LTR	DESCRIPTION	DATE	DWN	APVD
			A	DRAWN	16JAN06	EH	AP

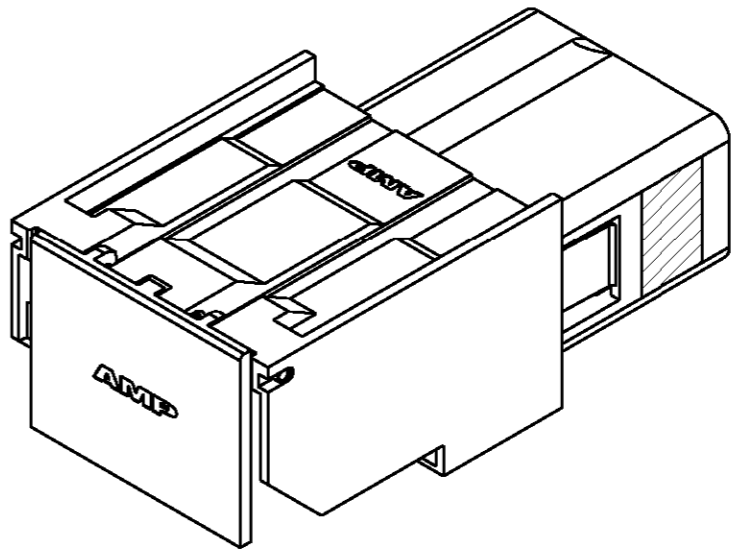
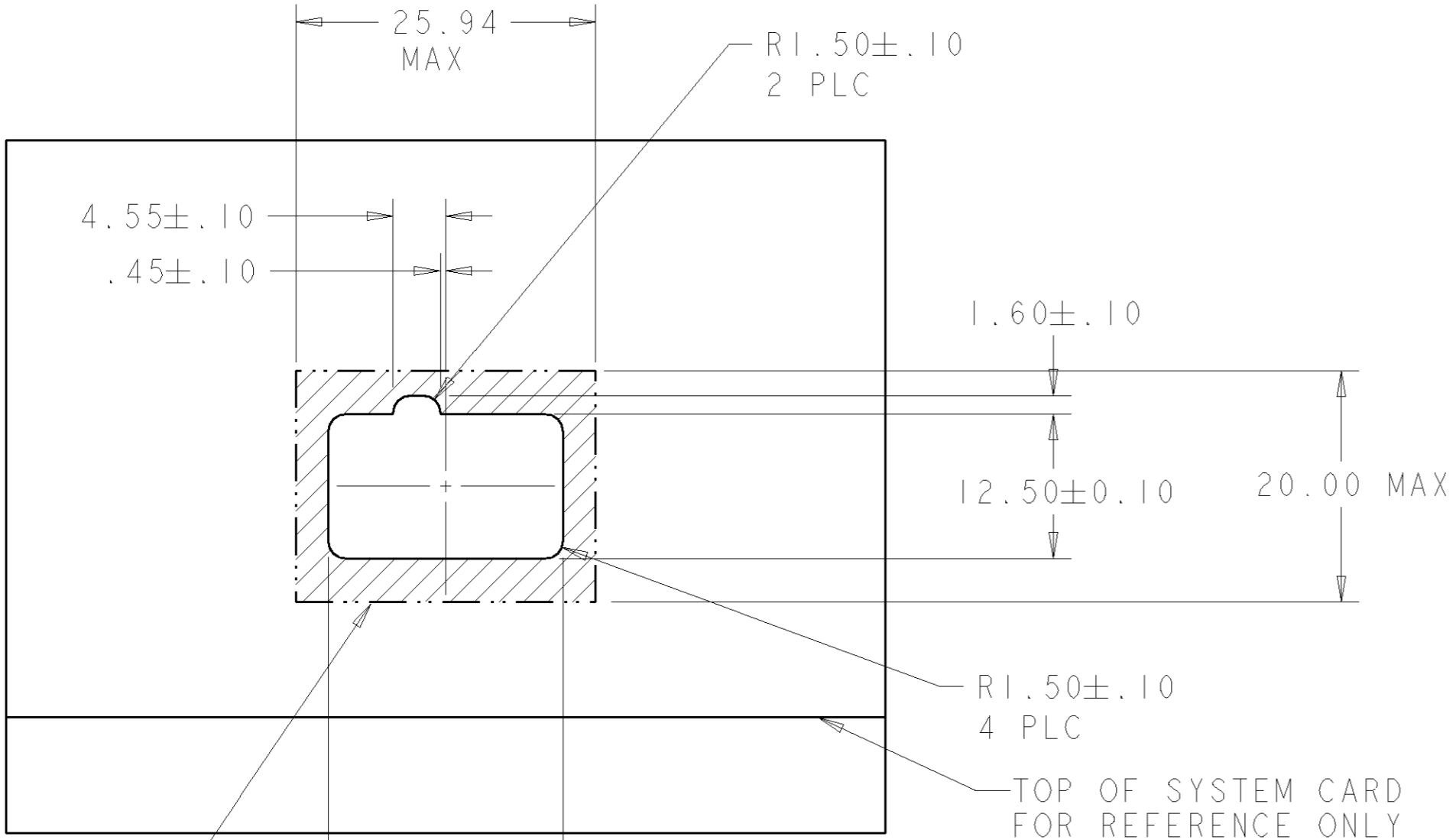

SCALE 2:1

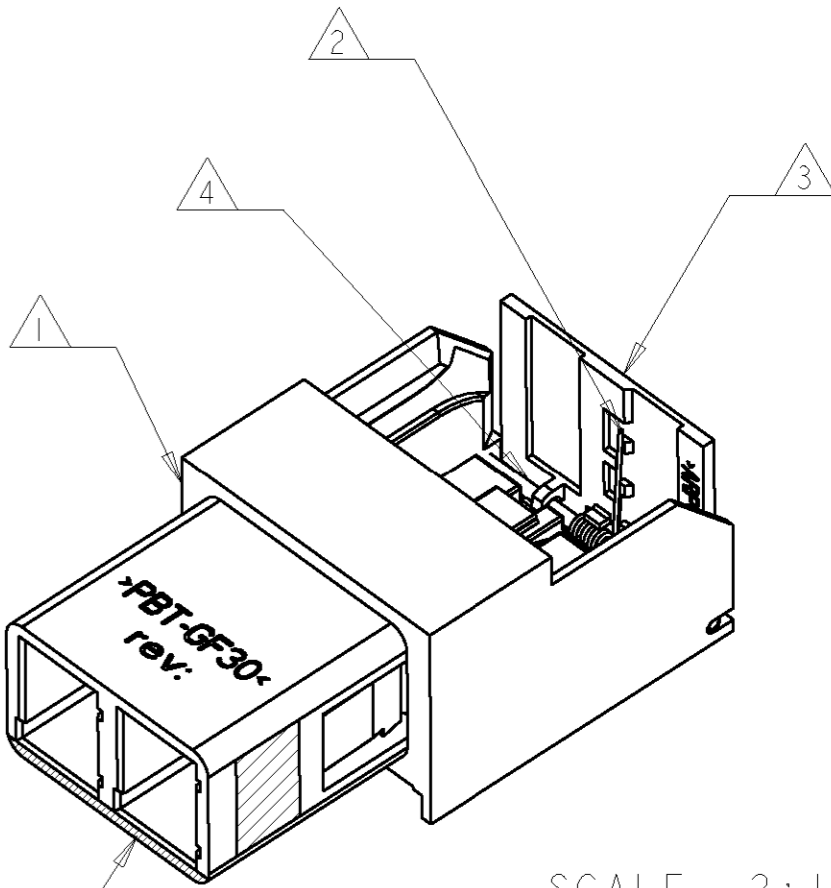
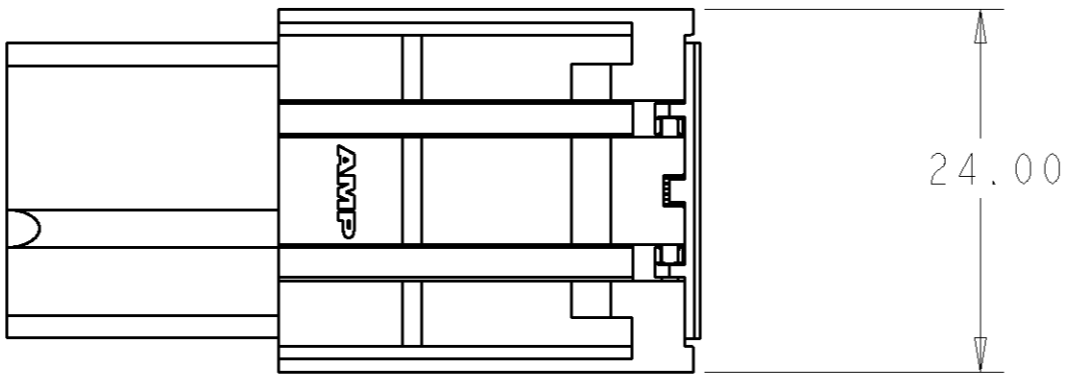

WHITE STRIPE FOR
CONNECTOR ORIENTATION

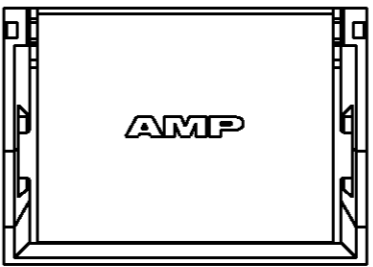
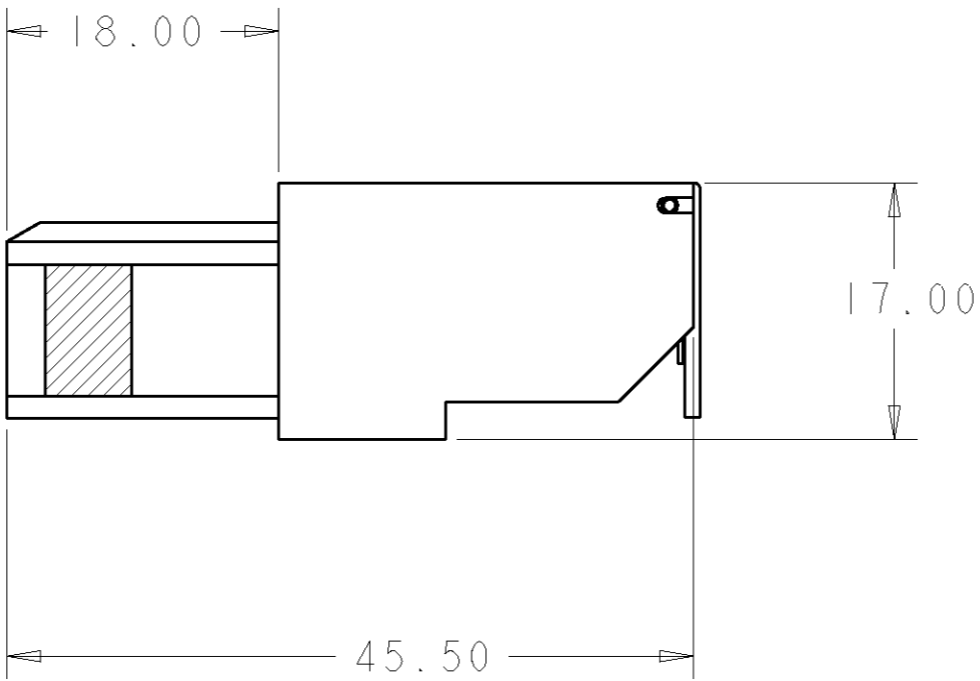
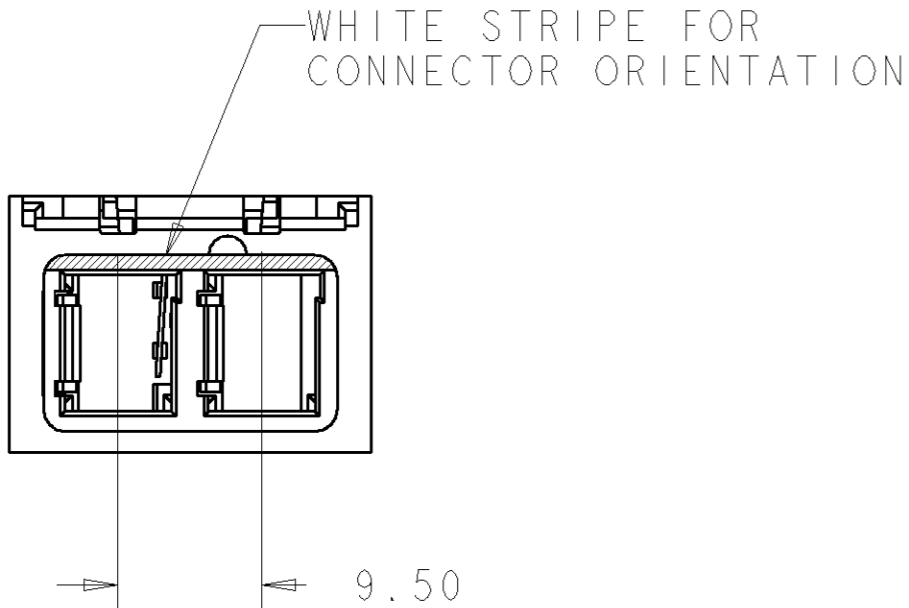

NOTES:

- 1 HOUSING MATERIAL: GLASS FILLED THERMOPLASTIC.
- 2 SHUTTER SPRING MATERIAL: STAINLESS STEEL.
- 3 SHUTTER MATERIAL: THERMOPLASTIC
- 4 PIN MATERIAL: SST
- 5 HOUSING DESIGNED TO BE INSTALLED WITH RETENTION CLIP P/N 1278530-2, USING SEATING TOOL, P/N 1278945-4, AND MOTHERBOARD SUPPORT, P/N 1278944-2. REFER TO INSTRUCTION SHEET 408-8332.

6374493-1

PART NUMBER

THIS DRAWING IS A CONTROLLED DOCUMENT FOR TYCO ELECTRONICS CORPORATION. IT IS SUBJECT TO CHANGE AND THE CONTROLLING ENGINEERING ORGANIZATION SHOULD BE CONTACTED FOR THE LATEST REVISION.		DWN E. HALEY	16JAN06	AMP Tyco Electronics Harrisburg, PA 17105-3608		
DIMENSIONS: mm		CHK A. PLOTTS	16JAN06			
TOLERANCES UNLESS OTHERWISE SPECIFIED:		APVD A. PLOTTS	16JAN06	NAME BACKPLANE HOUSING ASSEMBLY, LIGHTRAY MPX, 1X2 VERTICAL W/SHUTTER		
0 PLC ±		PRODUCT SPEC	-	SIZE A200779		
1 PLC ±		APPLICATION SPEC	-	CAGE CODE C-6374493		
2 PLC ±0.13		WEIGHT	-	DRAWING NO 6374493		
3 PLC ±		CUSTOMER DRAWING	-	RESTRICTED TO -		
4 PLC ±				SCALE 2:1		
ANGLES ±				SHEET 1 OF 1		
FINISH				REV A		