



Chipsmall Limited consists of a professional team with an average of over 10 year of expertise in the distribution of electronic components. Based in Hongkong, we have already established firm and mutual-benefit business relationships with customers from,Europe,America and south Asia,supplying obsolete and hard-to-find components to meet their specific needs.

With the principle of “Quality Parts,Customers Priority,Honest Operation,and Considerate Service”,our business mainly focus on the distribution of electronic components. Line cards we deal with include Microchip,ALPS,ROHM,Xilinx,Pulse,ON,Everlight and Freescale. Main products comprise IC,Modules,Potentiometer,IC Socket,Relay,Connector.Our parts cover such applications as commercial,industrial, and automotives areas.

We are looking forward to setting up business relationship with you and hope to provide you with the best service and solution. Let us make a better world for our industry!



## Contact us

Tel: +86-755-8981 8866 Fax: +86-755-8427 6832

Email & Skype: info@chipsmall.com Web: www.chipsmall.com

Address: A1208, Overseas Decoration Building, #122 Zhenhua RD., Futian, Shenzhen, China



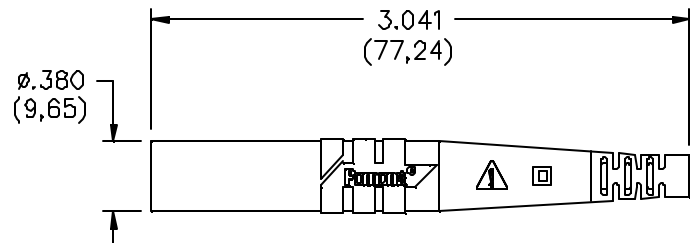
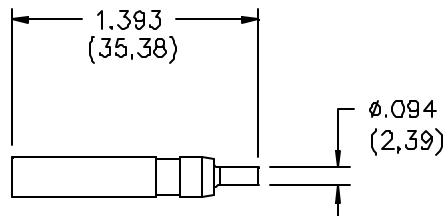

### FEATURES:

- Attaches to your wire with commonly available crimp tools or by soldering.
- Can be used on stranded wire from 18 to 22 AWG with an insulation diameter from 0.060" to 0.150".
- Provides safe and secure connections to 4mm shrouded banana plugs.
- Fits Pomona shrouded banana plugs and most other shrouded banana plugs, will also fit most banana plugs without shrouds.
- Will comply with IEC1010 CAT II, 300V when properly assembled.

### MATERIALS:

Banana Jack: Nickel Plated Brass.

Insulation: Santoprene® (Thermoplastic Elastomer).

### RATINGS:

Operating Voltage: 300V Max. (Hand Held); 1,500V Max. (Non-Hand Held)

Current: 5 Amperes 20-22 AWG, 15 Amperes 18 AWG

Operating Temperature: -20°F to 275°F (-29°C to 135°C)

Storage: -40°F to 302°F (-40°C to 150°C)

### ORDERING INFORMATION: Model 6384-(\*).

\* = Color, (-0) Black, (-2) Red, (10 per package). (-02) 1 of each color.

All dimensions are in inches. Tolerances (except noted): .xx = ±.02" (.51 mm), .xxx = ±.005" (.127 mm).

All specifications are to the latest revisions. Specifications are subject to change without notice.

Registered trademarks are the property of their respective companies. Made in USA

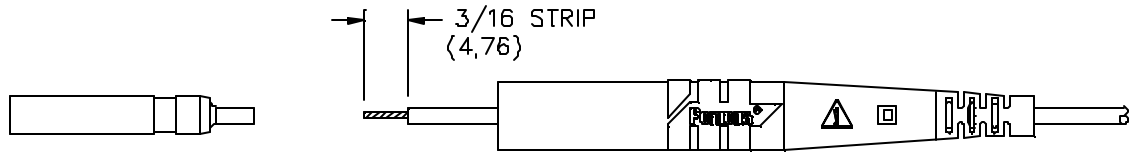

FIG. 1

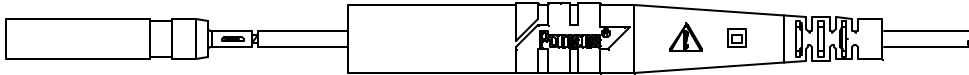

FIG. 2

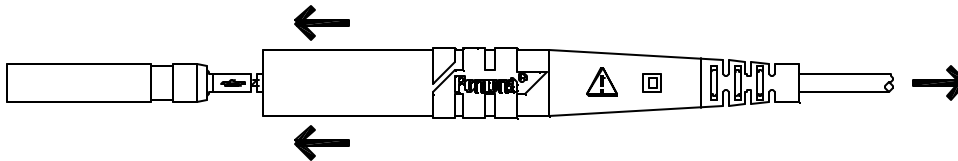

FIG. 3

### FIGURE #1

- A. Slide plastic housing over wire.
- B. Place stripped wire (18, 20, or 22 AWG) end into terminal hole.

### FIGURE #2

- C. Crimp terminal using a bare-terminal style crimper. Retention force of joint should exceed 12 pounds to assure no damage occurs to joint when housing is snapped into place.

All dimensions are in inches. Tolerances (except noted): .xx = ±.02" (.51 mm), .xxx = ±.005" (.127 mm).  
All specifications are to the latest revisions. Specifications are subject to change without notice.  
Registered trademarks are the property of their respective companies. Made in USA

### FIGURE #3

D. Slide housing over jack and pull on wire until snap engages.

All dimensions are in inches. Tolerances (except noted): .xx = ±.02" (.51 mm), .xxx = ± .005" (.127 mm).  
All specifications are to the latest revisions. Specifications are subject to change without notice.  
Registered trademarks are the property of their respective companies. Made in USA