



Chipsmall Limited consists of a professional team with an average of over 10 year of expertise in the distribution of electronic components. Based in Hongkong, we have already established firm and mutual-benefit business relationships with customers from,Europe,America and south Asia,supplying obsolete and hard-to-find components to meet their specific needs.

With the principle of “Quality Parts,Customers Priority,Honest Operation,and Considerate Service”,our business mainly focus on the distribution of electronic components. Line cards we deal with include Microchip,ALPS,ROHM,Xilinx,Pulse,ON,Everlight and Freescale. Main products comprise IC,Modules,Potentiometer,IC Socket,Relay,Connector.Our parts cover such applications as commercial,industrial, and automotives areas.

We are looking forward to setting up business relationship with you and hope to provide you with the best service and solution. Let us make a better world for our industry!



## Contact us

Tel: +86-755-8981 8866 Fax: +86-755-8427 6832

Email & Skype: info@chipsmall.com Web: www.chipsmall.com

Address: A1208, Overseas Decoration Building, #122 Zhenhua RD., Futian, Shenzhen, China



LOC	DIST	REVISIONS				
		REV	DESCRIPTION	DATE	BY	APPV
CM	00	N	ECR-13-008537	16SEP13	M.T	D.Z
		N1	ECO-14-010907	09SEP2014	KR	OC

- 1 MATERIAL: CONNECTOR-NYLON UL94V-2 (RED).  
CONTACTS-0.30 [.012] THICK COPPER ALLOY  
0.00038 [.000015] GOLD OR 0.00038 [.000015]  
TOTAL GOLD FLASH OVER PALLADIUM NICKEL,  
PER TE CONNECTIVITY'S DISCRETION, IN CONTACT  
AREA WITH MATTE TIN FOR 641190-2 THRU  
2-641190-8, MATTE WHISKER MITIGATED TIN  
FOR 3-641190-2 THRU 5-641190-8 OVER  
NICKEL UNDERPLATE.
- 2 CONTACTS ACCEPT 22 AWG WIRE WITH 1.52 [.060] MAX INSULATION DIAMETER.
- 3 CONTACTS MUST ACCEPT 0.64±0.03 [.025±.001] SQUARE POST AND REMAIN LOCKED IN POSITION.
- 4 IDENTIFICATION NUMBER FOR LAST CIRCUIT MAY NOT APPEAR ON ALL ASSEMBLIES.
- 5 DIMENSIONS IN BRACKETS ARE IN INCHES.
- 6 HOUSING FEATURES ARE: CLOSED END WITH LOCKING RAMP.
- 7 OBSOLETE PARTS: OBSOLETE CIS STREAMLINING PER D.RENAUD/D.SINISI

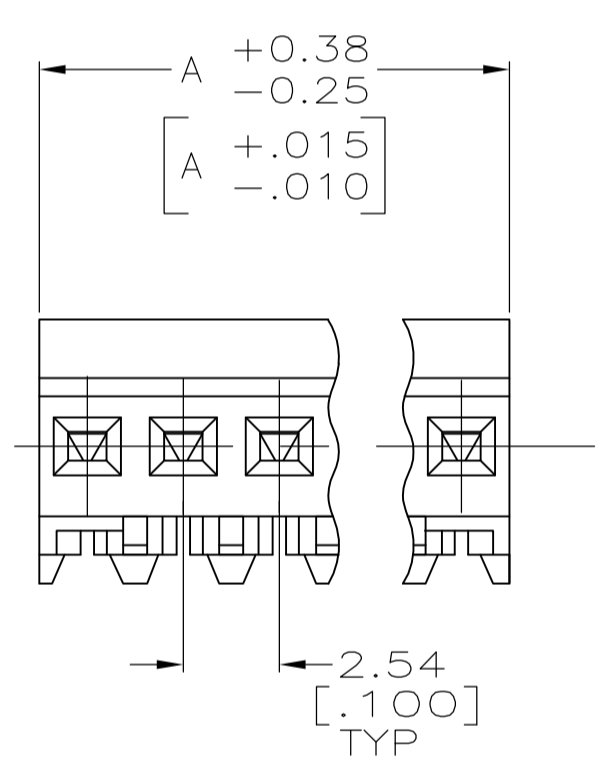
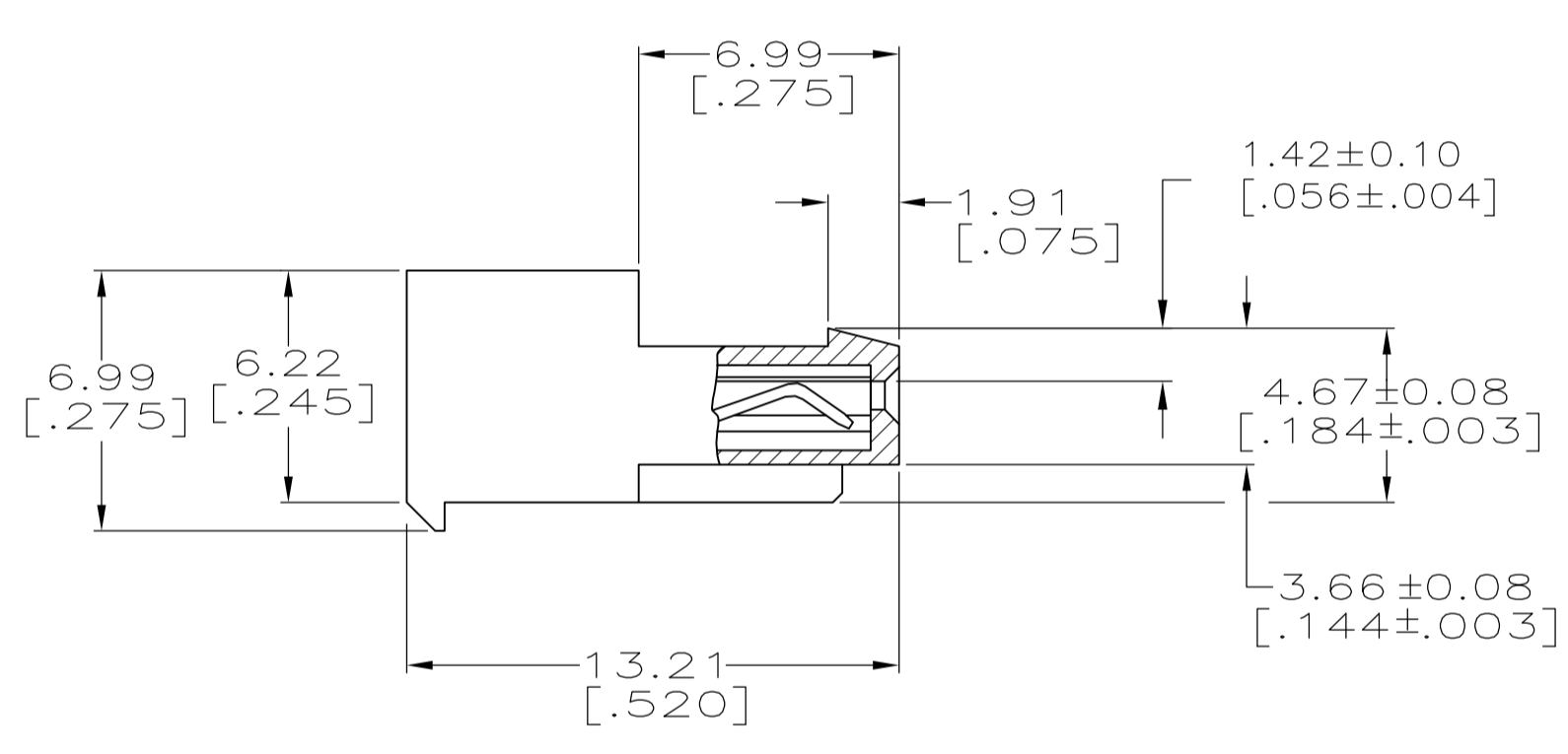
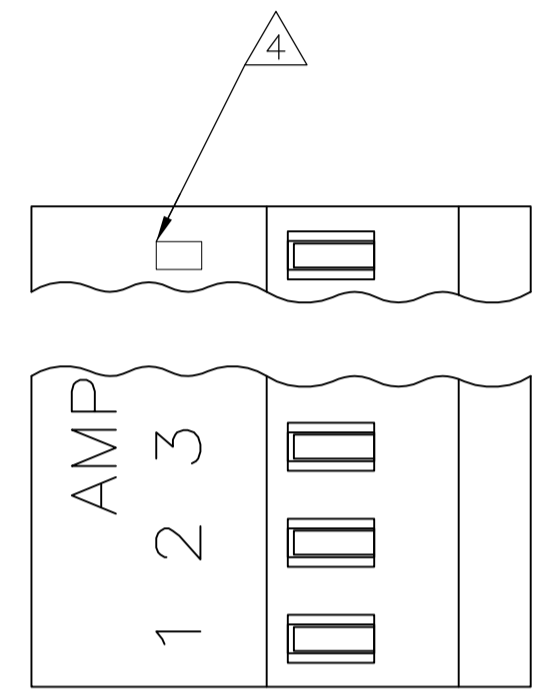

DIM A	NO.OF POSN	ASSEMBLY	
		DIM A	NO.OF POSN
71.12 [2.800]	28	5-641190-8	
66.04 [2.600]	27	5-641190-7	
63.50 [2.500]	26	5-641190-6	
63.50 [2.500]	25	5-641190-5	
60.96 [2.400]	24	5-641190-4	
58.42 [2.300]	23	5-641190-3	
55.88 [2.200]	22	5-641190-2	
53.34 [2.100]	21	5-641190-1	
50.80 [2.000]	20	5-641190-0	
48.26 [1.900]	19	4-641190-9	
45.72 [1.800]	18	4-641190-8	
43.18 [1.700]	17	4-641190-7	
40.64 [1.600]	16	4-641190-6	
38.10 [1.500]	15	4-641190-5	
35.56 [1.400]	14	4-641190-4	
33.02 [1.300]	13	4-641190-3	
30.48 [1.200]	12	4-641190-2	
27.94 [1.100]	11	4-641190-1	
25.40 [1.000]	10	4-641190-0	
22.86 [.900]	9	3-641190-9	
20.32 [.800]	8	3-641190-8	
17.78 [.700]	7	3-641190-7	
15.24 [.600]	6	3-641190-6	
12.70 [.500]	5	3-641190-5	
10.16 [.400]	4	3-641190-4	
7.62 [.300]	3	3-641190-3	
5.08 [.200]	2	3-641190-2	

DIM A	NO.OF POSN	ASSEMBLY	
		DIM A	NO.OF POSN
71.12 [2.800]	28	2-641190-8	
66.04 [2.600]	27	2-641190-7	7
63.50 [2.500]	26	2-641190-6	7
63.50 [2.500]	25	2-641190-5	7
60.96 [2.400]	24	2-641190-4	7
58.42 [2.300]	23	2-641190-3	
55.88 [2.200]	22	2-641190-2	7
53.34 [2.100]	21	2-641190-1	7
50.80 [2.000]	20	2-641190-0	
48.26 [1.900]	19	1-641190-9	7
45.72 [1.800]	18	1-641190-8	
43.18 [1.700]	17	1-641190-7	7
40.64 [1.600]	16	1-641190-6	
38.10 [1.500]	15	1-641190-5	
35.56 [1.400]	14	1-641190-4	
33.02 [1.300]	13	1-641190-3	
30.48 [1.200]	12	1-641190-2	
27.94 [1.100]	11	1-641190-1	
25.40 [1.000]	10	1-641190-0	
22.86 [.900]	9	641190-9	
20.32 [.800]	8	641190-8	
17.78 [.700]	7	641190-7	
15.24 [.600]	6	641190-6	
12.70 [.500]	5	641190-5	
10.16 [.400]	4	641190-4	
7.62 [.300]	3	641190-3	
5.08 [.200]	2	641190-2	



THIS DRAWING IS A CONTROLLED DOCUMENT.

DIMENSIONS: mm [INCHES]

TOLERANCES UNLESS OTHERWISE SPECIFIED:

0. PLC	±
1. PLC	±
2. PLC	± 0.13 [.005]
3. PLC	±
4. PLC	±
ANGLES	±

MATERIAL: FINISH:

THIS DRAWING IS A CONTROLLED DOCUMENT.

DIN S. HOOVER 20-DEC-2004

CHK: D. ROSSI 20-DEC-2004

APVD: D. ROSSI 20-DEC-2004

NAME: MTA .100 CONNECTOR ASSEMBLY 22 AWG, STANDARD

PRODUCT SPEC: 108-1050

APPLICATION SPEC: 114-1019

SIZE: A1

CAGE CODE: 00779

DRAWING NO: 641190

RESTRICTED TO: CUSTOMER DRAWING

SCALE: 5:1

SHEET: 1 OF 1

REV: N1