



Chipsmall Limited consists of a professional team with an average of over 10 year of expertise in the distribution of electronic components. Based in Hongkong, we have already established firm and mutual-benefit business relationships with customers from,Europe,America and south Asia,supplying obsolete and hard-to-find components to meet their specific needs.

With the principle of “Quality Parts,Customers Priority,Honest Operation,and Considerate Service”,our business mainly focus on the distribution of electronic components. Line cards we deal with include Microchip,ALPS,ROHM,Xilinx,Pulse,ON,Everlight and Freescale. Main products comprise IC,Modules,Potentiometer,IC Socket,Relay,Connector.Our parts cover such applications as commercial,industrial, and automotives areas.

We are looking forward to setting up business relationship with you and hope to provide you with the best service and solution. Let us make a better world for our industry!



Contact us

Tel: +86-755-8981 8866 Fax: +86-755-8427 6832

Email & Skype: info@chipsmall.com Web: www.chipsmall.com

Address: A1208, Overseas Decoration Building, #122 Zhenhua RD., Futian, Shenzhen, China



THIS DRAWING IS UNPUBLISHED. RELEASED FOR PUBLICATION
 © COPYRIGHT - By - ALL RIGHTS RESERVED.

LOC	DIST	REVISIONS					
		P	LTR	DESCRIPTION	DATE	DWN	APVD
CM	54		D	REVISED PER ECO-12-007609	03AUG12	KH	SM

- 1 MATERIAL: CONNECTOR - NYLON UL94V-2.
CONTACTS - 0.30 [.012] THICK COPPER ALLOY (BRIGHT-TIN LEAD 0.00203 [.000080] MIN THK FOR CONTACTS 644461-2 THRU 1-644461-4, MATTE WHISKER MITIGATED TIN 0.00203 [.000080] MIN THICK FOR CONTACTS 3-644461-2 THRU 4-644461-4)
- 2 CONTACTS ACCEPT 18 AWG WIRE WITH 2.41 [.095] MAX INSULATION DIAMETER.
- 3 CONTACTS MUST ACCEPT 1.14±0.03 [.045±.001] SQUARE POST AND REMAIN LOCKED IN POSITION.
- 4 IDENTIFICATION NUMBER FOR LAST CIRCUIT MAY NOT APPEAR ON ALL ASSEMBLIES.
- 5 DIMENSIONS IN BRACKETS ARE IN INCHES.
- 6 HOUSING FEATURES ARE: CLOSED END WITHOUT LOCKING RAMP AND WITH POLARIZING TAB.3
- 7 OBSOLETE PARTS: OBSOLETE CIS STREAMLINING PER D.RENAUD/D.SINISI
- 8 ORANGE COLOR STRIPE ON HOUSING (NOT SHOWN) MAY RUN DOWN BETWEEN RIBS.

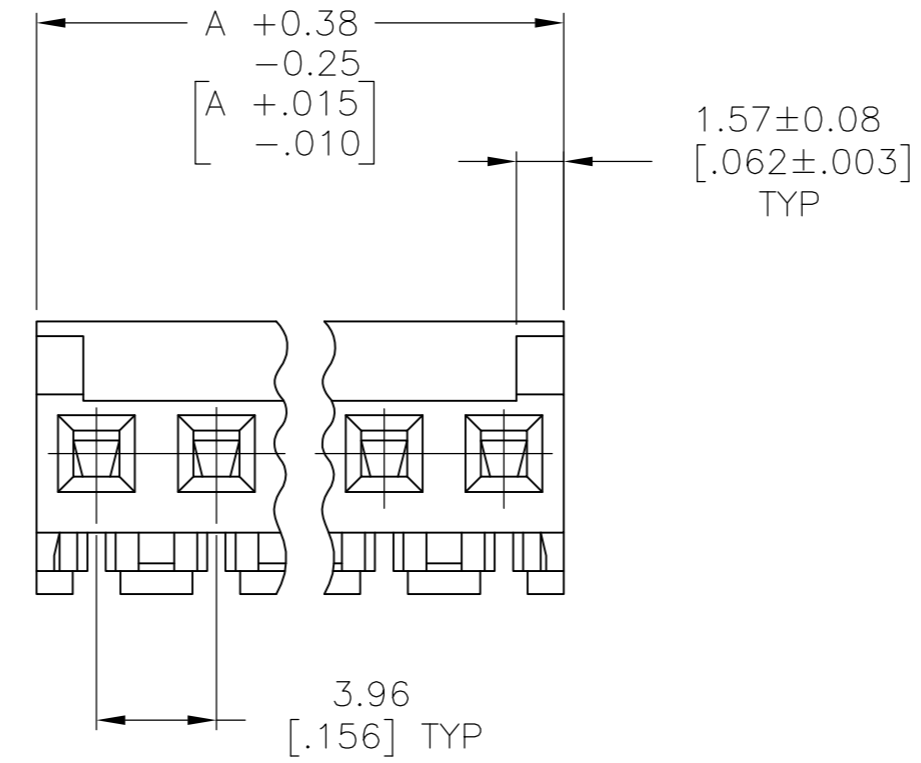
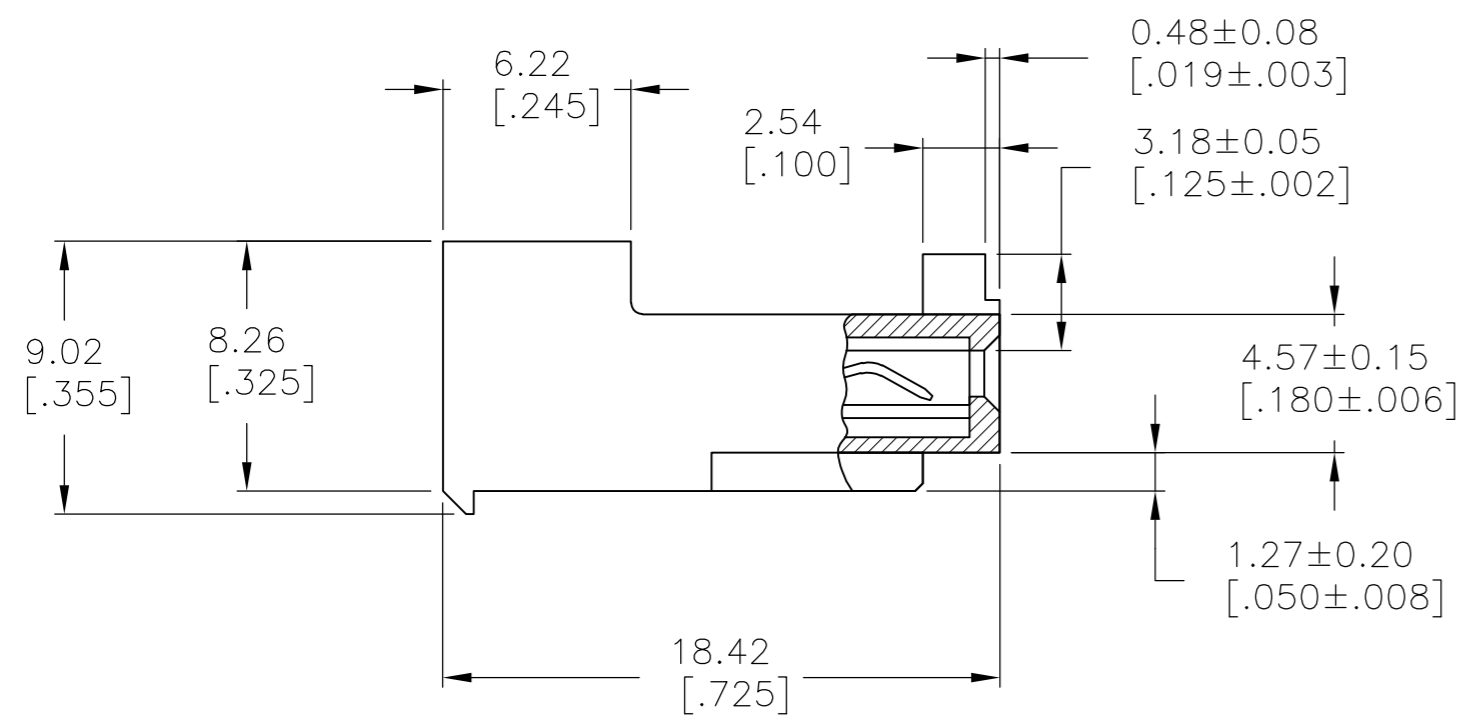
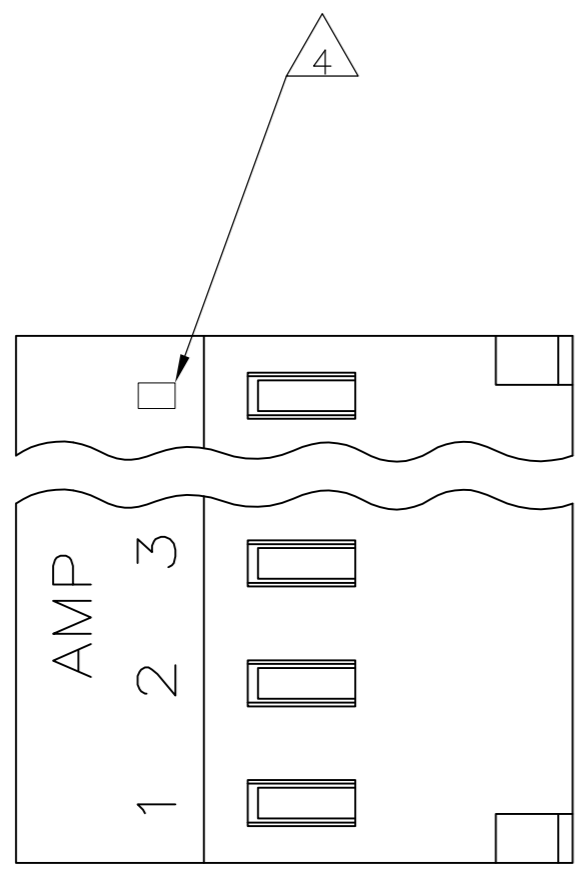

	DIM A	NO. OF CIRCUITS	PART NO.
	55.47 [2.184]	14	4-644461-4
	51.51 [2.028]	13	4-644461-3
	47.55 [1.872]	12	4-644461-2
	43.59 [1.716]	11	4-644461-1
	39.62 [1.560]	10	4-644461-0
	35.66 [1.404]	9	3-644461-9
	31.70 [1.248]	8	3-644461-8
	27.74 [1.092]	7	3-644461-7
	23.77 [.936]	6	3-644461-6
	19.81 [.780]	5	3-644461-5
	15.85 [.624]	4	3-644461-4
	11.89 [.468]	3	3-644461-3
	7.92 [.312]	2	3-644461-2
7 SUPERCEDED	55.47 [2.184]	14	1-644461-4
7 OBSOLETE	51.51 [2.028]	13	1-644461-3
7 SUPERCEDED	47.55 [1.872]	12	1-644461-2
7 SUPERCEDED	43.59 [1.716]	11	1-644461-1
	39.62 [1.560]	10	1-644461-0
7 SUPERCEDED	35.66 [1.404]	9	644461-9
	31.70 [1.248]	8	644461-8
7 SUPERCEDED	27.74 [1.092]	7	644461-7
	23.77 [.936]	6	644461-6
	19.81 [.780]	5	644461-5
	15.85 [.624]	4	644461-4
	11.89 [.468]	3	644461-3
7 SUPERCEDED	7.92 [.312]	2	644461-2

METRIC

THIS DRAWING IS A CONTROLLED DOCUMENT.

DWN B. LEWIS 12FEB91		TE Connectivity	
CHK R. SWING 12FEB91		NAME	
APVD D.R. CLARK 20FEB91		PRODUCT SPEC	
PRODUCT SPEC		APPLICATION SPEC	
MATERIAL	108-1051	SIZE	A2
FINISH	114-1020	CAGE CODE	00779
	WEIGHT	DRAWING NO	C=644461
	CUSTOMER DRAWING	SCALE	4:1
		SHEET	1 OF 1
		REV	D