



Chipsmall Limited consists of a professional team with an average of over 10 year of expertise in the distribution of electronic components. Based in Hongkong, we have already established firm and mutual-benefit business relationships with customers from,Europe,America and south Asia,supplying obsolete and hard-to-find components to meet their specific needs.

With the principle of “Quality Parts,Customers Priority,Honest Operation,and Considerate Service”,our business mainly focus on the distribution of electronic components. Line cards we deal with include Microchip,ALPS,ROHM,Xilinx,Pulse,ON,Everlight and Freescale. Main products comprise IC,Modules,Potentiometer,IC Socket,Relay,Connector.Our parts cover such applications as commercial,industrial, and automotives areas.

We are looking forward to setting up business relationship with you and hope to provide you with the best service and solution. Let us make a better world for our industry!



Contact us

Tel: +86-755-8981 8866 Fax: +86-755-8427 6832

Email & Skype: info@chipsmall.com Web: www.chipsmall.com

Address: A1208, Overseas Decoration Building, #122 Zhenhua RD., Futian, Shenzhen, China



LOC	DIST	REVISIONS					
		P	LTN	DESCRIPTION	DATE	DWN	APVD
ES	00	F		REVISED 2-2 BY CUSTOMER	09MAR2015	CZ	SZ

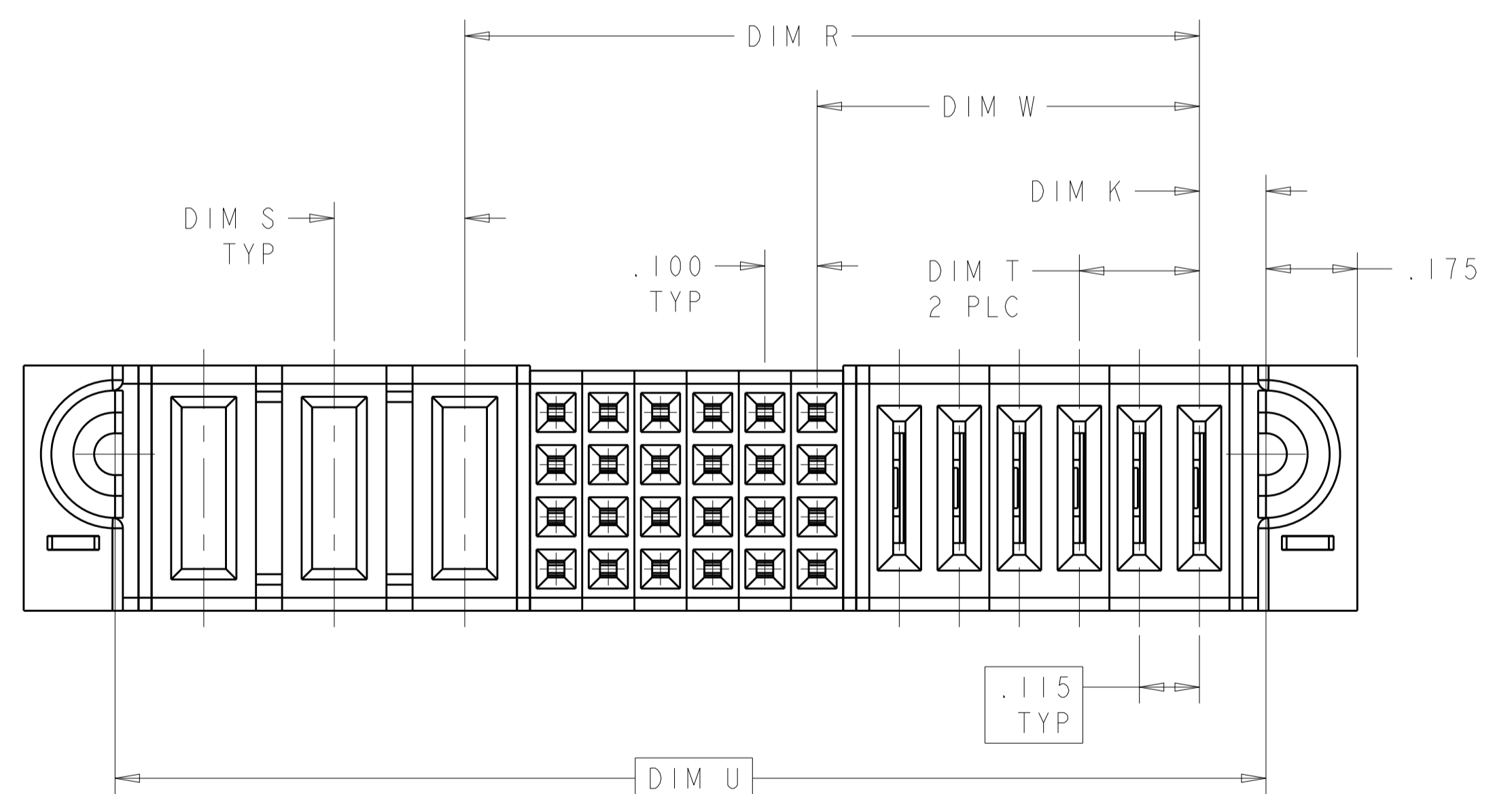
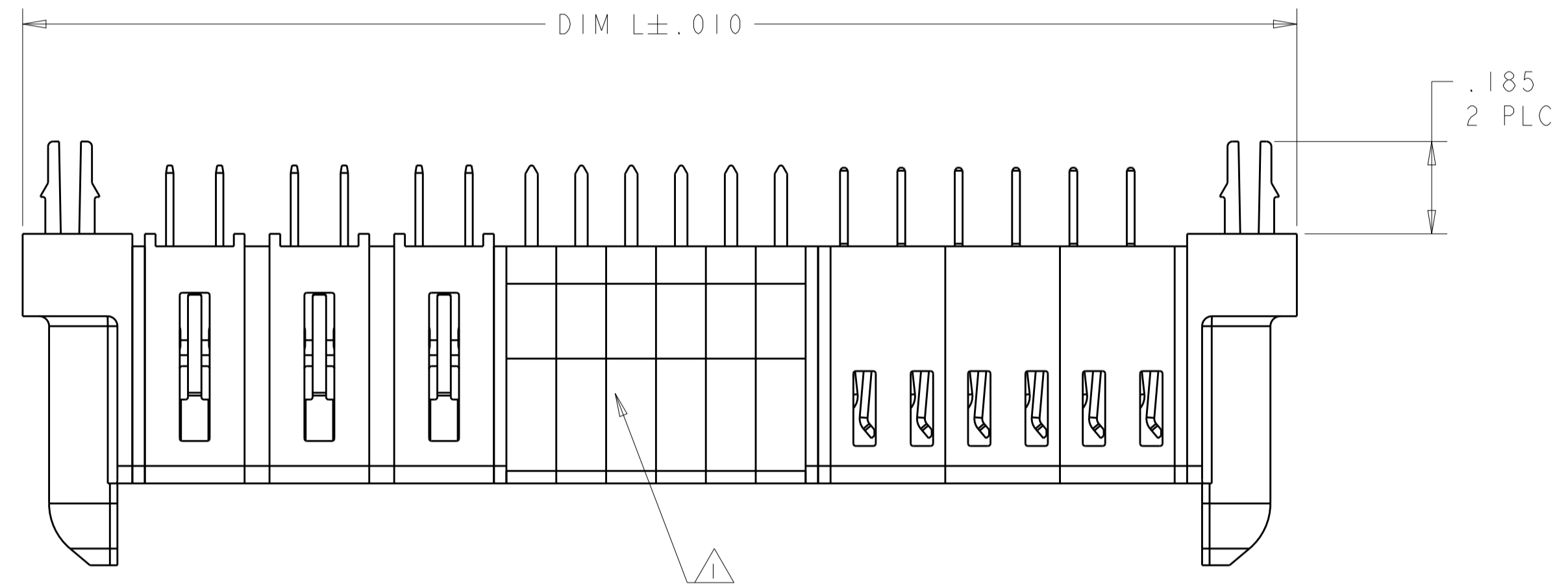
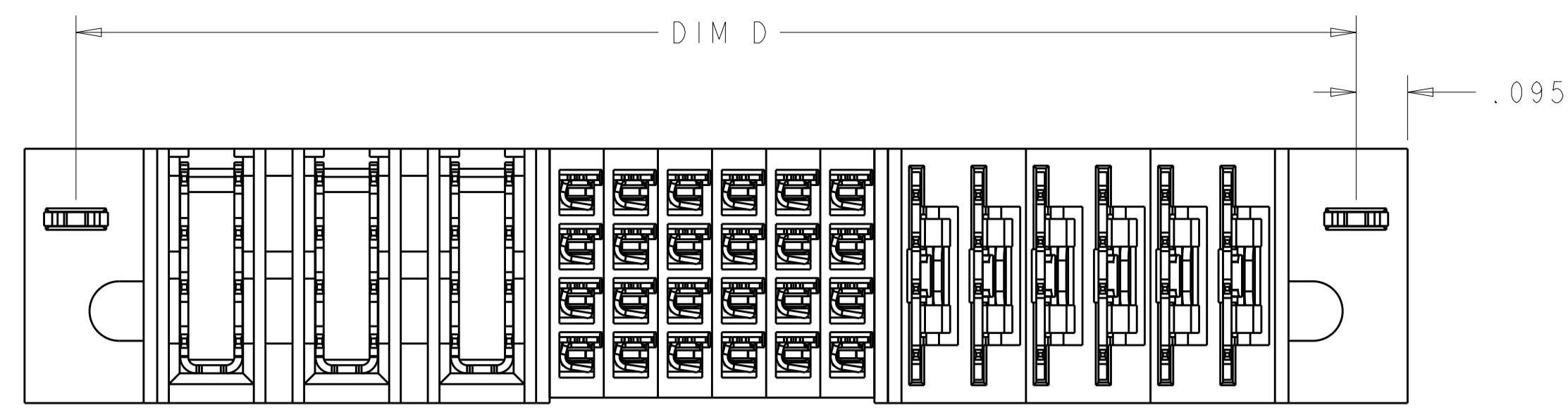

- ① "AMP", TRADEMARK, PART NUMBER AND DATE CODE TO BE MARKED IN AREA SHOWN
- ② MATERIAL: HOUSING - GLASS FILLED HIGH TEMP THERMO PLASTIC, UL94 V-0, BLACK
SIGNAL CONTACT - HIGH CONDUCTIVITY COPPER ALLOY
POWER CONTACT - HIGH CONDUCTIVITY COPPER ALLOY
- ③ CONTACT PLATING: NOBLE METAL PLATING ON CONTACT FUNCTIONAL AREA OF POWER AND SIGNAL CONTACTS
- ④ MECHANICAL CONNECTOR KEEP OUT ZONE
- ⑤ DATUM AND BASIC DIMENSIONS ESTABLISHED BY CUSTOMER
- ⑥ PCB - ALL HOLE DIAMETERS ARE FINISHED HOLE SIZES
- ⑦ PCB - .0453 ± .0010 DRILLED HOLES PLATED WITH .0003 MIN Sn OVER .001 TO .003 CU PLATING TO ACHIEVE A .040 ± .003 DIA HOLE
- ⑧ DIM W & DIM R ARE APPLICABLE TO P+S+P CONFIGURATION.
- ⑨ FOR P/N 6450850-3, -11, THE VARIABLE DIMENSIONS PLEASE SEE SHEET 2.
- ⑩ VARIABLE DIMENSIONS SHOW ON TABLE OR PART VIEW

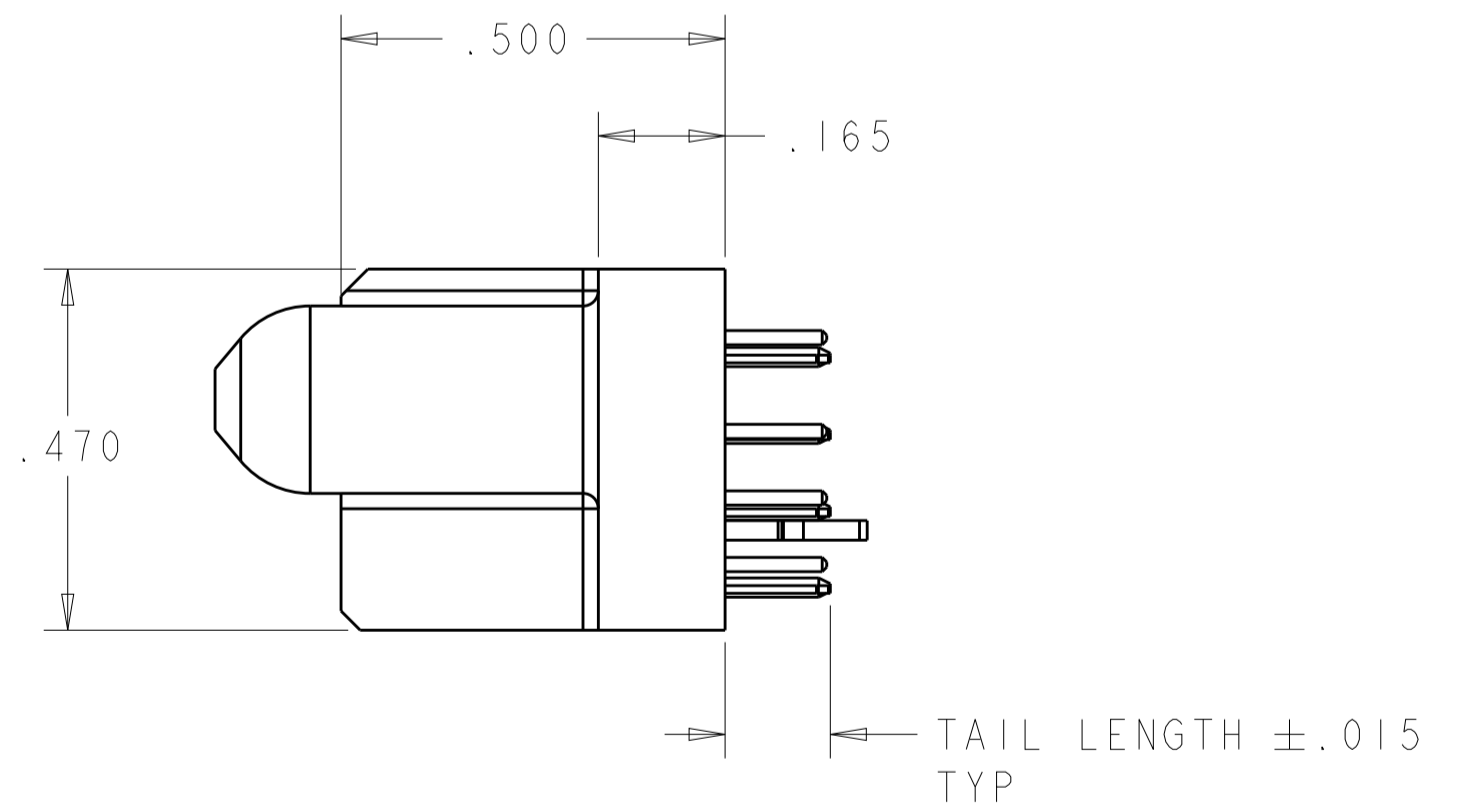

THIS DRAWING IS A CONTROLLED DOCUMENT.		DWN S. ZHAO 20SEP2007	TE Connectivity												
DIMENSIONS: INCHES		CHK S. ZHAO 20SEP2007													
		TOLERANCES UNLESS OTHERWISE SPECIFIED:	NAME VERTICAL RECEPTACLE ASSEMBLY, WITH GUIDES MULTI-BEAM XLE												
<table border="1"> <tr><td>0 PLC</td><td>±</td></tr> <tr><td>1 PLC</td><td>±.01</td></tr> <tr><td>2 PLC</td><td>±.01</td></tr> <tr><td>3 PLC</td><td>±.005</td></tr> <tr><td>4 PLC</td><td>±.0020</td></tr> <tr><td>ANGLES</td><td>±.7°</td></tr> </table>		0 PLC	±	1 PLC	±.01	2 PLC	±.01	3 PLC	±.005	4 PLC	±.0020	ANGLES	±.7°	APVD S. YAO	PRODUCT SPEC 108-1973
0 PLC	±														
1 PLC	±.01														
2 PLC	±.01														
3 PLC	±.005														
4 PLC	±.0020														
ANGLES	±.7°														
MATERIAL		FINISH	APPLICATION SPEC 114-13038												
			SIZE A100779												
			CAGE CODE 6450850												
			RESTRICTED TO												
			SCALE 4:1												
			SHEET 1 OF 8												
			REV F												

LOC		DIST		REVISIONS				
ES	00	P	LTN	DESCRIPTION	DATE	DMN	APVD	
-	-	-	-	SEE SHEET 1	-	-	-	

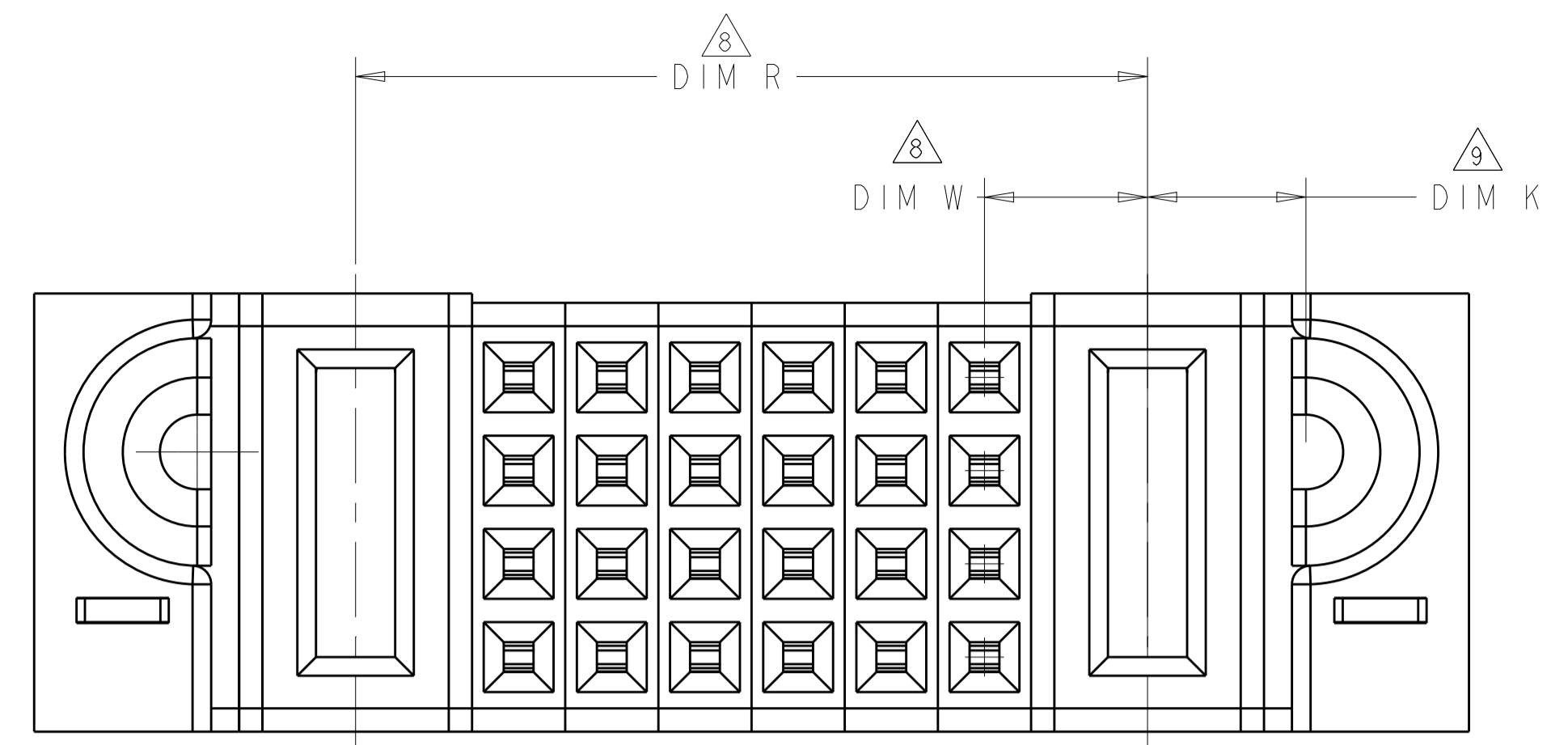

FOR P/N 6450850-3, -11, THE OTHER DIMENSIONS PLEASE SEE THE TABLE OF SHEET 1.

Δ	Δ	2.1275	1.1025	4.590	4.240	4.400	.1025	9LP + 36S + IP + 16LP	2-6450850-2
.300	.250	1.275	.800	2.490	2.140	2.300	.195	3ACP + 16S + 3P	2-6450850-1
.230	.230	1.090	.7825	1.990	1.640	1.800	.1025	3LP + 12S + 4LP	2-6450850-0
.250	.250	1.150	.675	2.340	1.990	2.150	.170	3P + 16S + 3P	1-6450850-9
Δ	Δ	Δ	Δ	3.270	2.920	3.080	.170	5HDP + 24S + IP + 7LP	1-6450850-8
-	-	.500	.200	1.140	.790	.950	.145	IP + 8S + IP	1-6450850-7
.300	.250	1.250	.775	2.940	2.590	2.750	.170	3ACP + 16S + 5P	1-6450850-6
.200	.200	.800	.350	1.840	1.490	1.650	.145	2P + 16S + 3P	1-6450850-4
.250	.250	1.300	.925	2.740	2.390	2.550	.170	4P + 12S + 4P	1-6450850-3
-	-	.850	.175	1.540	1.190	1.350	.170 Δ	IP + 24S + IP	1-6450850-1
-	-	.850	.175	1.540	1.190	1.350	.170 Δ	IP + 24S + IP	6450850-3
.230	.250	1.4075	.7325	2.555	2.205	2.365	.1275	6LP + 24S + 3P	6450850-2
DIM T	DIM S	DIM R Δ	DIM W Δ	DIM L	DIM U	DIM D	DIM K	DESCRIPTION	PART NUMBER

THIS DRAWING IS A CONTROLLED DOCUMENT. DMN S.ZHAO 20SEP2007
 CHK S.ZHAO 20SEP2007

DIMENSIONS: INCHES. TOLERANCES UNLESS OTHERWISE SPECIFIED:
 0 PLC ±.01
 1 PLC ±.01
 2 PLC ±.01
 3 PLC ±.005
 4 PLC ±.0020
 ANGLES ±.7°
 FINISH

MATERIAL: -

APVD: S.YAO

PRODUCT SPEC: 108-1973
 APPLICATION SPEC: 114-13038

WEIGHT: -

CUSTOMER DRAWING

STE TE Connectivity

NAME: VERTICAL RECEPTACLE ASSEMBLY, WITH GUIDES MULTI-BEAM XLE

SIZE: A1 | CAGE CODE: 100779 | DRAWING NO: 6450850

RESTRICTED TO: -

SCALE: 4:1 | SHEET: 2 OF 8 | REV: F

LOC		DIST		REVISIONS			
ES	00	P	LTN	DESCRIPTION	DATE	DWN	APVD
		-		SEE SHEET 1			

PART NUMBER	ROWS	POWER			SIGNAL					POWER						
		P3	P2	P1	6	5	4	3	2	1	LP6	LP5	LP4	LP3	LP2	LP1
6450850-2	D C B A	VM	VM	VM	E	E	E	E	E	E	E	LM	LM	LM	LM	LM
6LP + 24S + 3P																

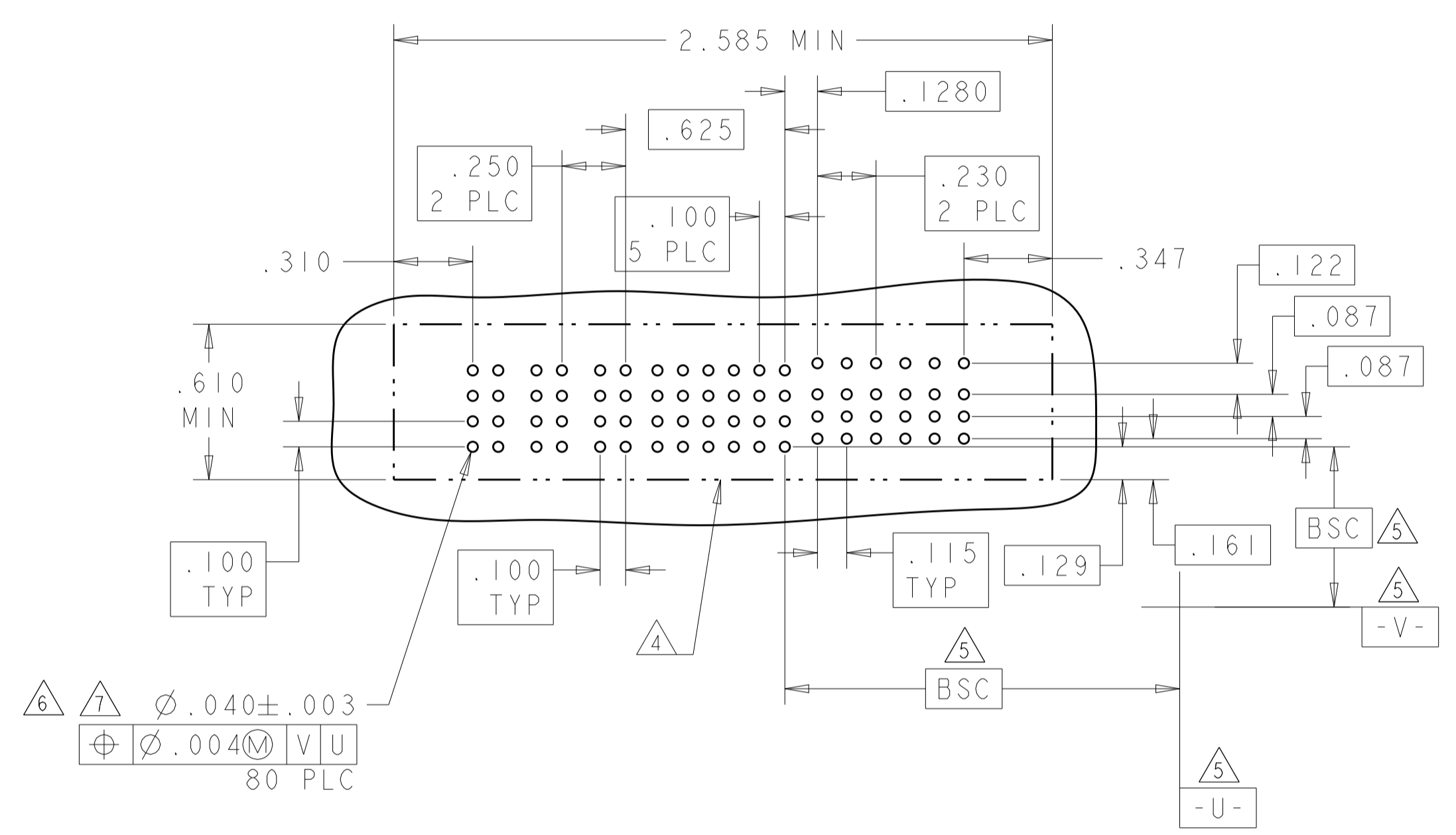

PART NUMBER	ROWS	POWER		SIGNAL					POWER			
		P2	P1	6	5	4	3	2	1	P1	P2	
6450850-3	D C B A	VM	VM	E	E	E	E	E	E	E	VM	VM
IP + 24S + IP												

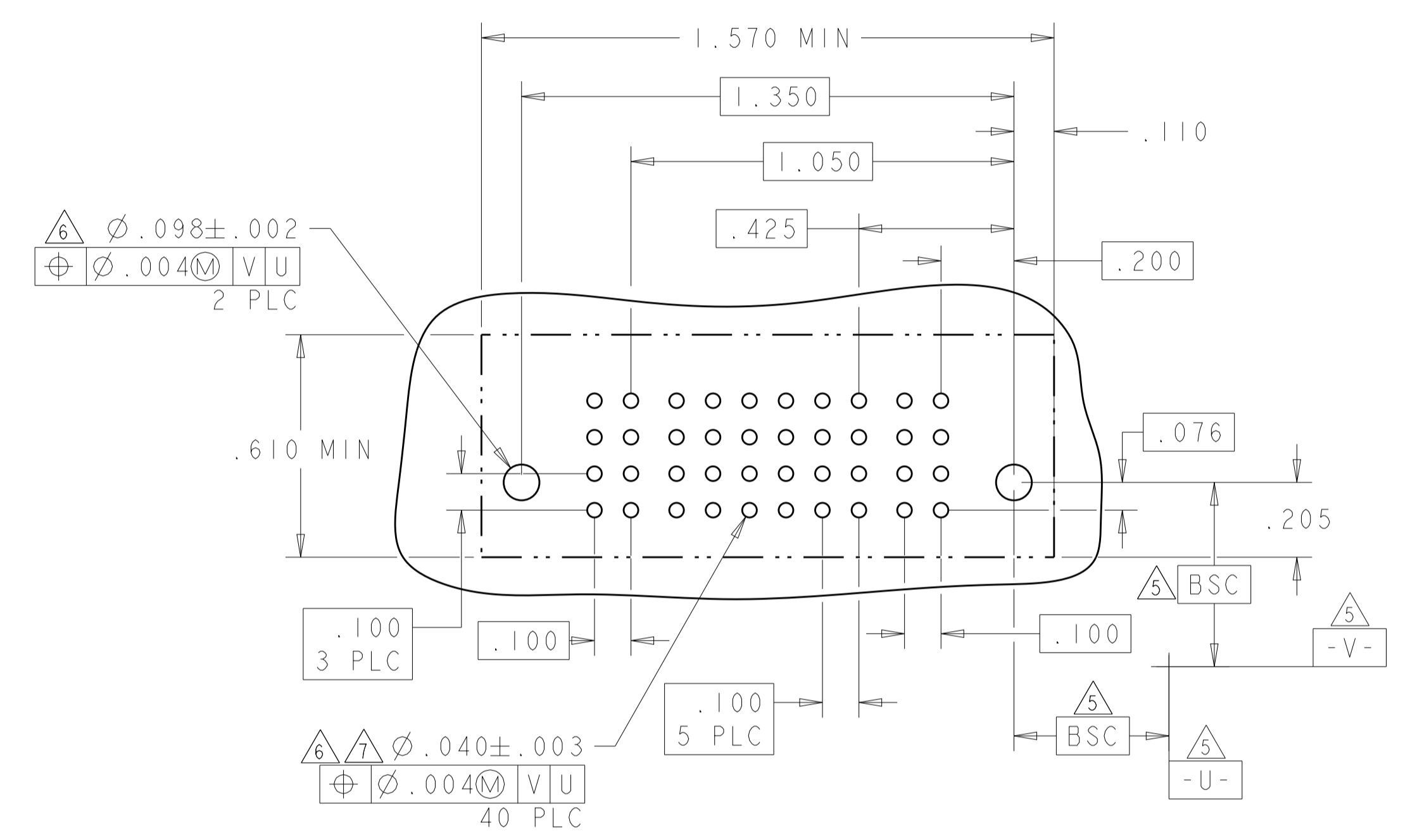

PART NUMBER	ROWS	POWER		SIGNAL					POWER			
		P2	P1	6	5	4	3	2	1	P1	P2	
1-6450850-1	D C B A	VM	VA	E	E	E	E	E	E	E	VA	VA
IP + 24S + IP												

LAYOUT OF 1-6450850-1 IS SAME AS 6450850-3.

LM	LOW POWER CONTACT .135" TAIL LENGTH
M	SIGNAL CONTACT .165" TAIL LENGTH
E	SIGNAL CONTACT .135" TAIL LENGTH
VO	POWER CONTACT, STD.165" TAIL LENGTH
VA	POWER CONTACT, MFBL.135" TAIL LENGTH
VM	POWER CONTACT, STD.135" TAIL LENGTH
CODE	DESCRIPTION
CONTACTS	

THIS DRAWING IS A CONTROLLED DOCUMENT.		DWN	S. ZHAO	20SEP2007	STE TE Connectivity
DIMENSIONS: INCHES		CHK	S. ZHAO	20SEP2007	
TOLERANCES UNLESS OTHERWISE SPECIFIED:		APVD	S. YAO		NAME VERTICAL RECEPTACLE ASSEMBLY, WITH GUIDES MULTI-BEAM XLE
0 PLC ±.01		PRODUCT SPEC			
1 PLC ±.01		APPLICATION SPEC			SIZE
2 PLC ±.01		RESTRICTED TO			A100779
3 PLC ±.005		SCALE	4:1	SHEET	3 OF 8
4 PLC ±.0020		REV	F		
ANGLES ±.020					
FINISH					
MATERIAL					
CUSTOMER DRAWING					

LOC	DIST	REV	DATE	BY	APPD
ES	00				

REVISIONS		DATE	BY	APPD
-	SEE SHEET 1	-	-	-

PART NUMBER	ROWS	POWER				SIGNAL			POWER			
		P8	P7	P6	P5	3	2	1	P4	P3	P2	P1
I-6450850-3	D					E	E	E				
	C					E	E	E				
	B	VM	VM	VM	VM	E	E	E	VM	VM	VM	VM
	A	HD				E	E	E				HD

4P + 12S + 4P

PART NUMBER	ROWS	POWER			SIGNAL				POWER	
		P5	P4	P3	4	3	2	1	P2	P1
I-6450850-4	D				E	E	E	E		
	C				E	E	E	E		
	B	VM	VM	VM	E	E	E	E	VM	VM
	A	HD			E	E	E	E		HD

2HDP + 16S + 3HDP

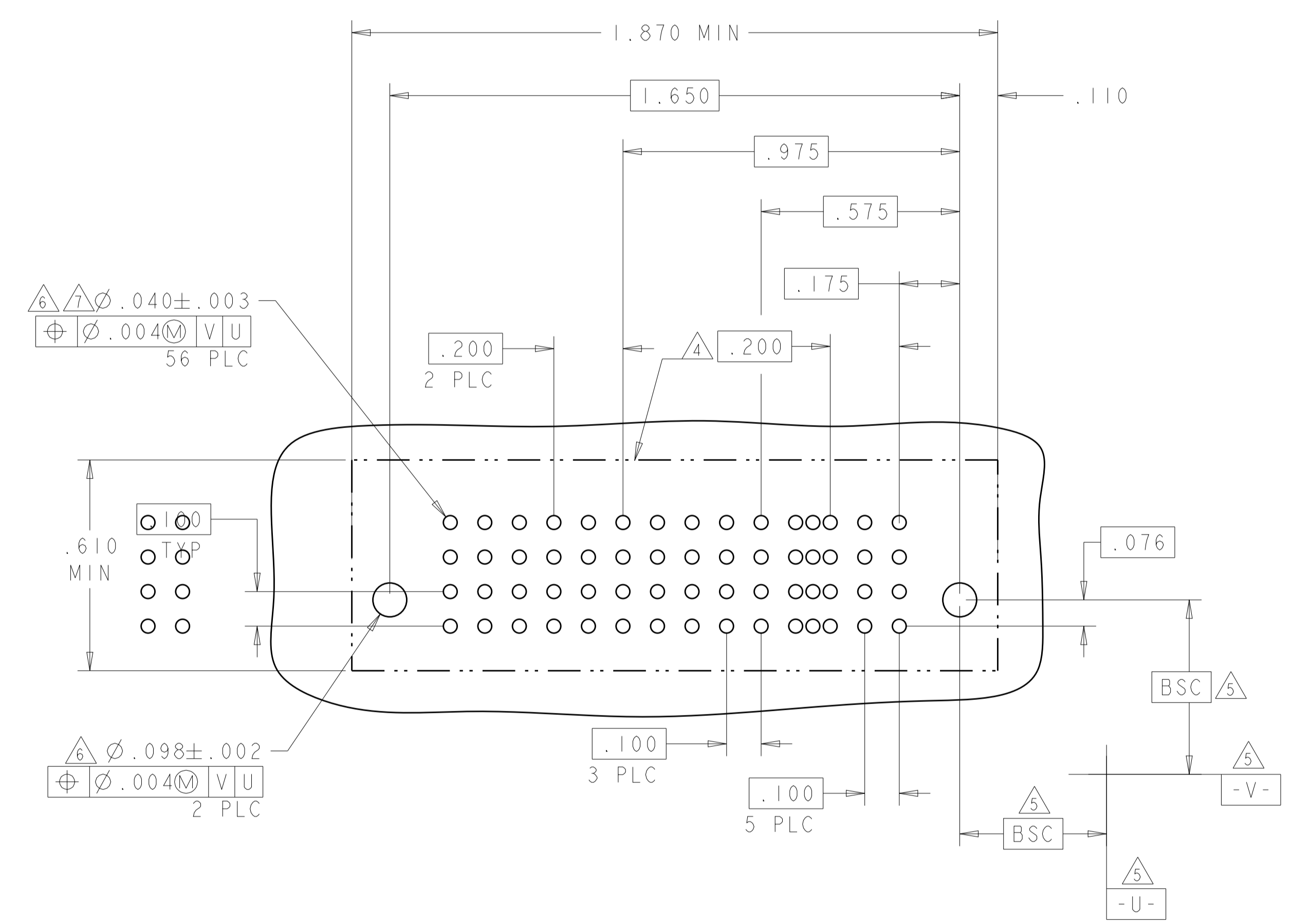
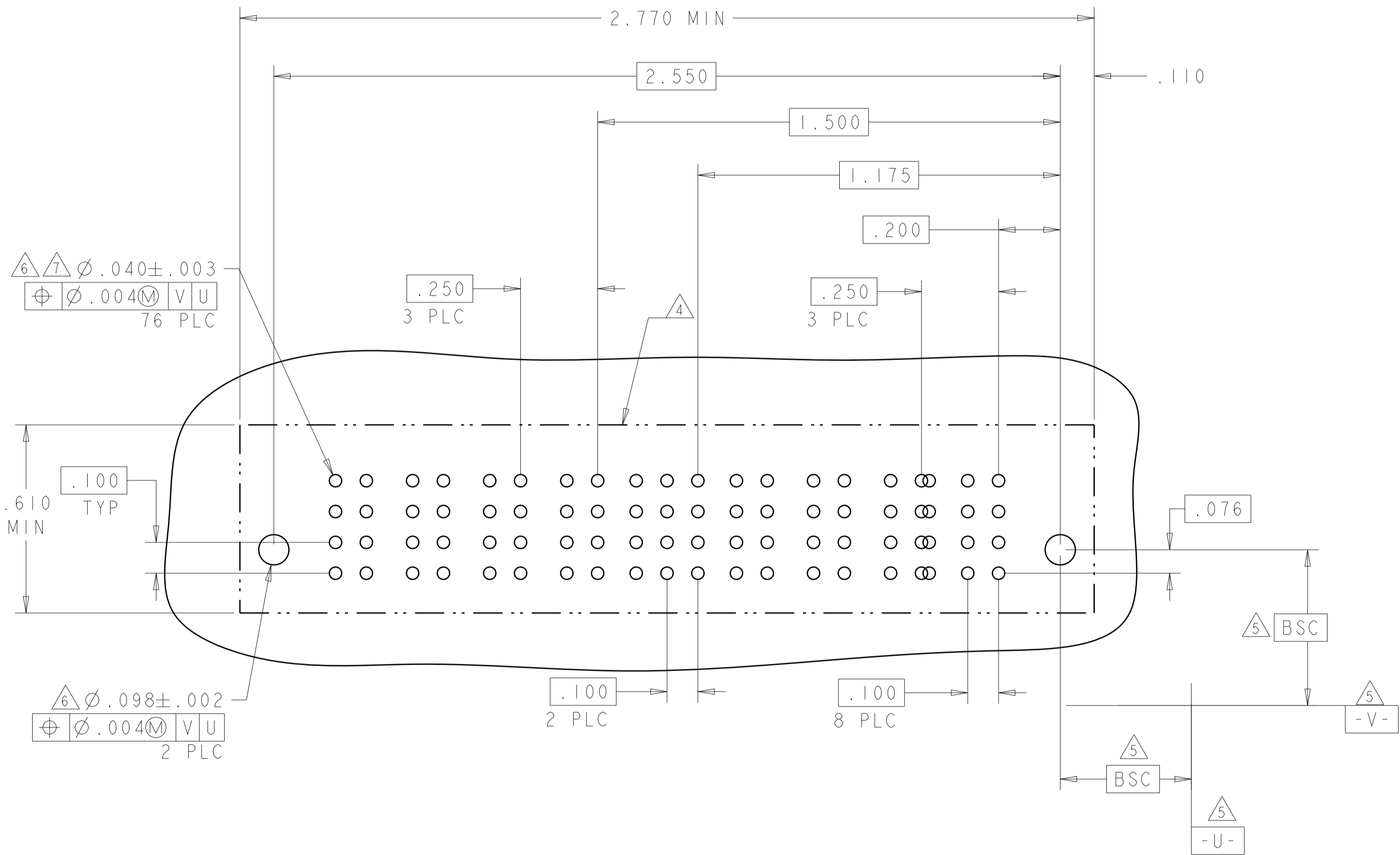

THIS DRAWING IS A CONTROLLED DOCUMENT.		OWN: S. ZHAO 20SEP2007	TE Connectivity
DIMENSIONS: INCHES		CHK: S. ZHAO 20SEP2007	
TOLERANCES UNLESS OTHERWISE SPECIFIED:		APVD: S. YAO	NAME: VERTICAL RECEPTACLE ASSEMBLY, WITH GUIDES MULTI-BEAM XLE
0 PLC	±	PRODUCT SPEC	SIZE: CAGE CODE DRAWING NO
1 PLC	±.01	APPLICATION SPEC	RESTRICTED TO
2 PLC	±.005	114-13038	A100779C=6450850
3 PLC	±.0020	WEIGHT	SCALE: 4:1 SHEET 4 OF 8 REV F
4 PLC	±.0020	CUSTOMER DRAWING	
ANGLES	±.2°		
FINISH			

LOC	DIST	REV	DATE	BY	APPD
ES	00				

REVISIONS			
REV	DATE	BY	APPD
-	-	-	-
-	-	-	-

PART NUMBER	ROWS	POWER					SIGNAL				POWER		
		P8	P7	P6	P5	P4	4	3	2	1	P3	P2	P1
1-6450850-6	D						E	E	E	E			
	C	VA	VM	VM	VM	VA	E	E	E	E	VM	VM	VA
	B						E	E	E	E			
	A	HD					E	E	E	E			HD

3ACP + 16S + 5P

PART NUMBER	ROWS	POWER		SIGNAL		POWER	
		P2	2	1	P1		
1-6450850-7	D						
	C	VM	E	E	VM		
	B		E	E			
	A	HD	E	E	HD		

IP + 8S + IP

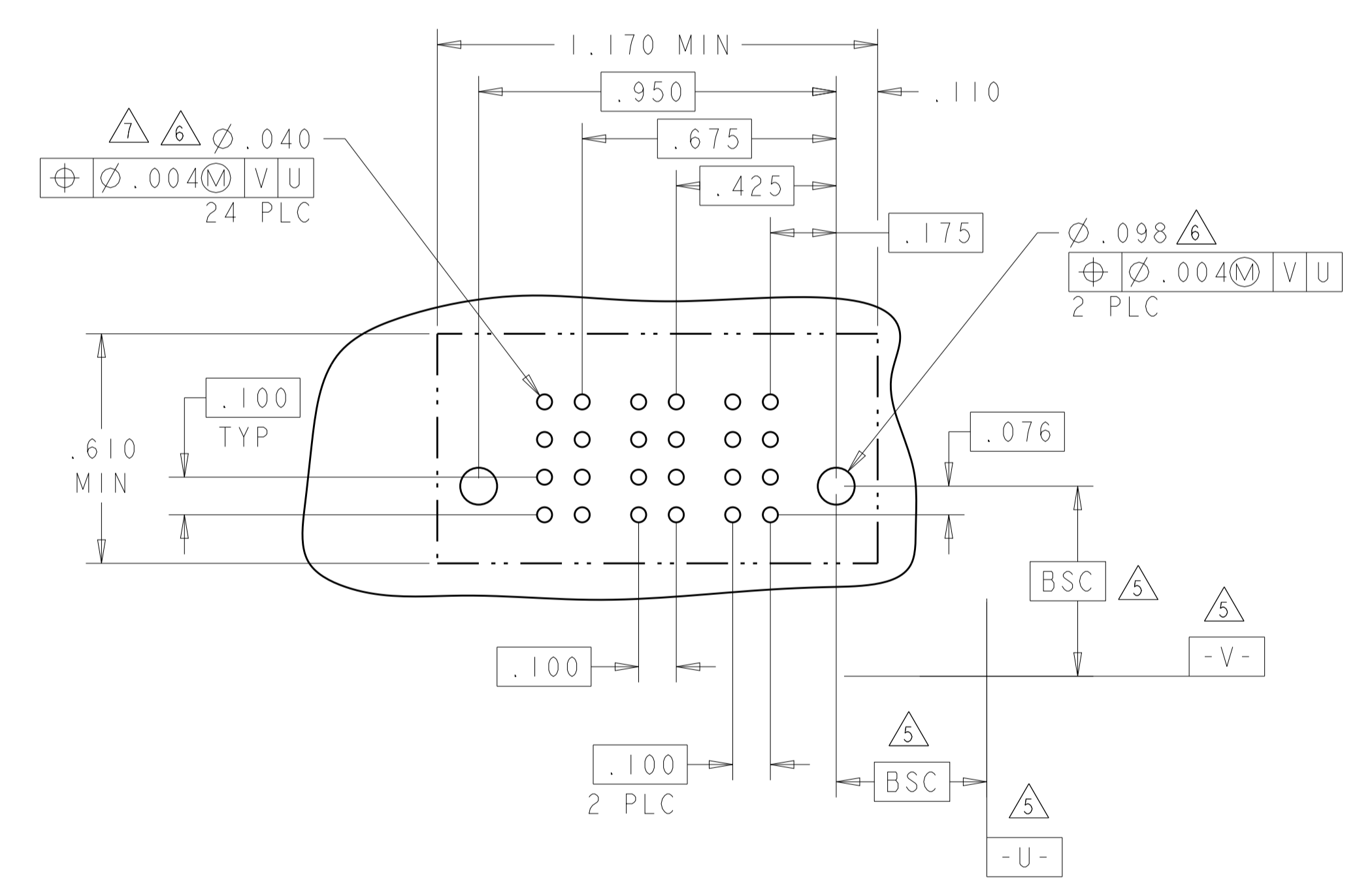
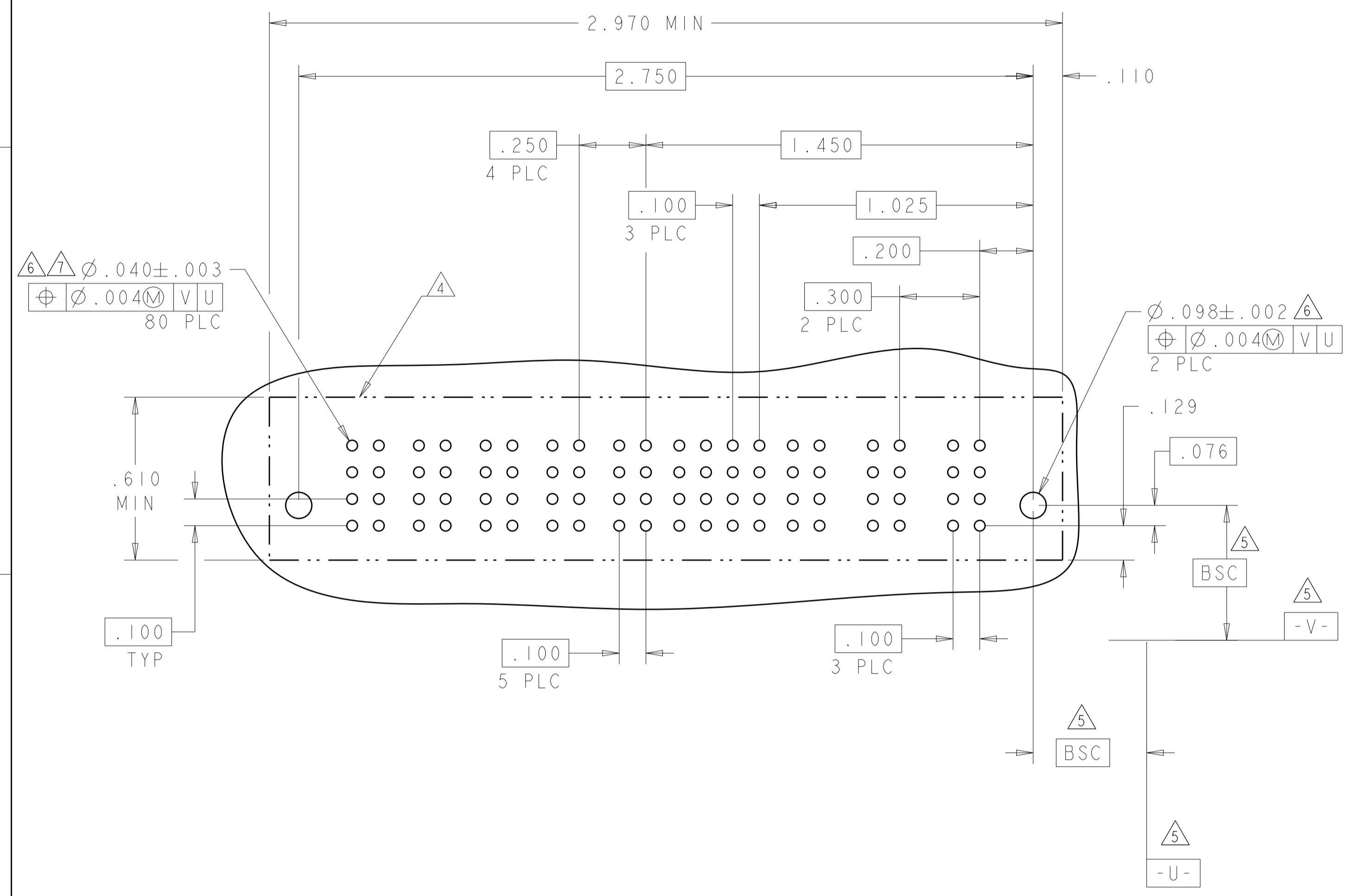

THIS DRAWING IS A CONTROLLED DOCUMENT.		DWN: S. ZHAO 20SEP2007 CHK: S. ZHAO 20SEP2007 APVD: S. YAO	TE Connectivity
DIMENSIONS: INCHES	TOLERANCES UNLESS OTHERWISE SPECIFIED: 0 PLC ±. 1 PLC ±.01 2 PLC ±.01 3 PLC ±.005 4 PLC ±.0020 ANGLES ±.2° FINISH	NAME: VERTICAL RECEPTACLE ASSEMBLY, WITH GUIDES MULTI-BEAM XLE PRODUCT SPEC: 108-1973 APPLICATION SPEC: 114-13038 WEIGHT: - CUSTOMER DRAWING	

LOC		DIST		REVISIONS			
ES	00	P	LTN	DESCRIPTION	DATE	DMN	APVD
				SEE SHEET 1			

PART NUMBER	ROWS	LOW POWER						POWER	SIGNAL						POWER				
		LP7	LP6	LP5	LP4	LP3	LP2	LP1	P6	6	5	4	3	2	1	P5	P4	P3	P2
I-6450850-8	D								E	E	E	E	E	E					
	C	LM	LM	LM				VA	E	E	E	E	E	E	VM	VM			
	B								E	E	E	E	E	E					
	A	HD							E	E	E	E	E	E					HD

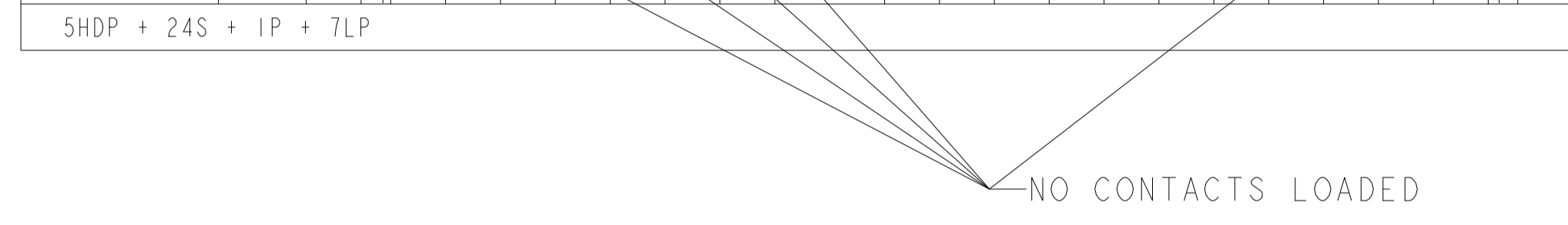

NO CONTACTS LOADED

PART NUMBER	ROWS	POWER			SIGNAL				POWER		
		P6	P5	P4	4	3	2	1	P3	P2	P1
I-6450850-9	D	VM	VM	VM	E	E	E	E	VM	VM	VM
	C				E	E	E	E			
	B				E	E	E	E			
	A	HD			E	E	E	E			

3P + 16S + 3P

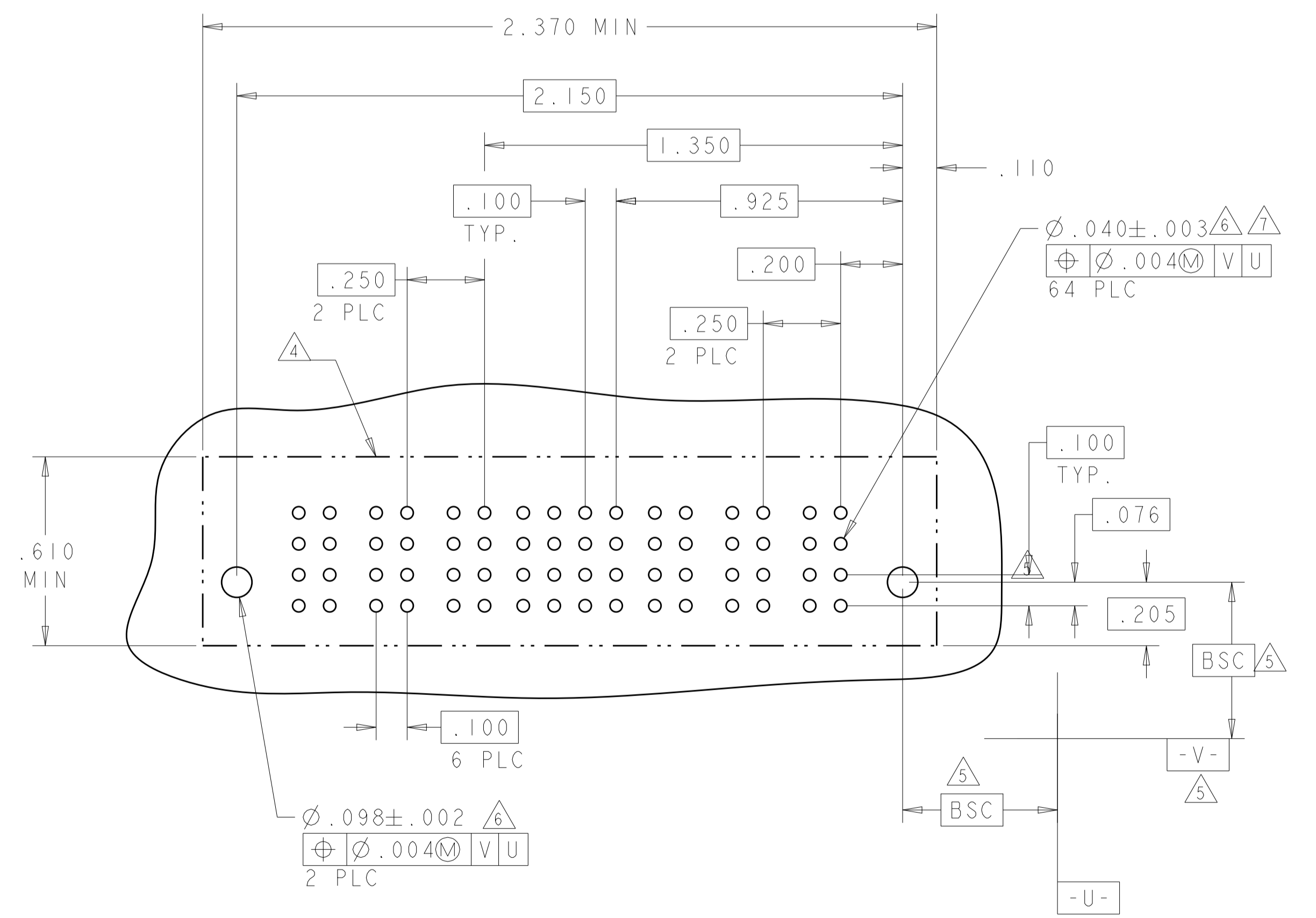
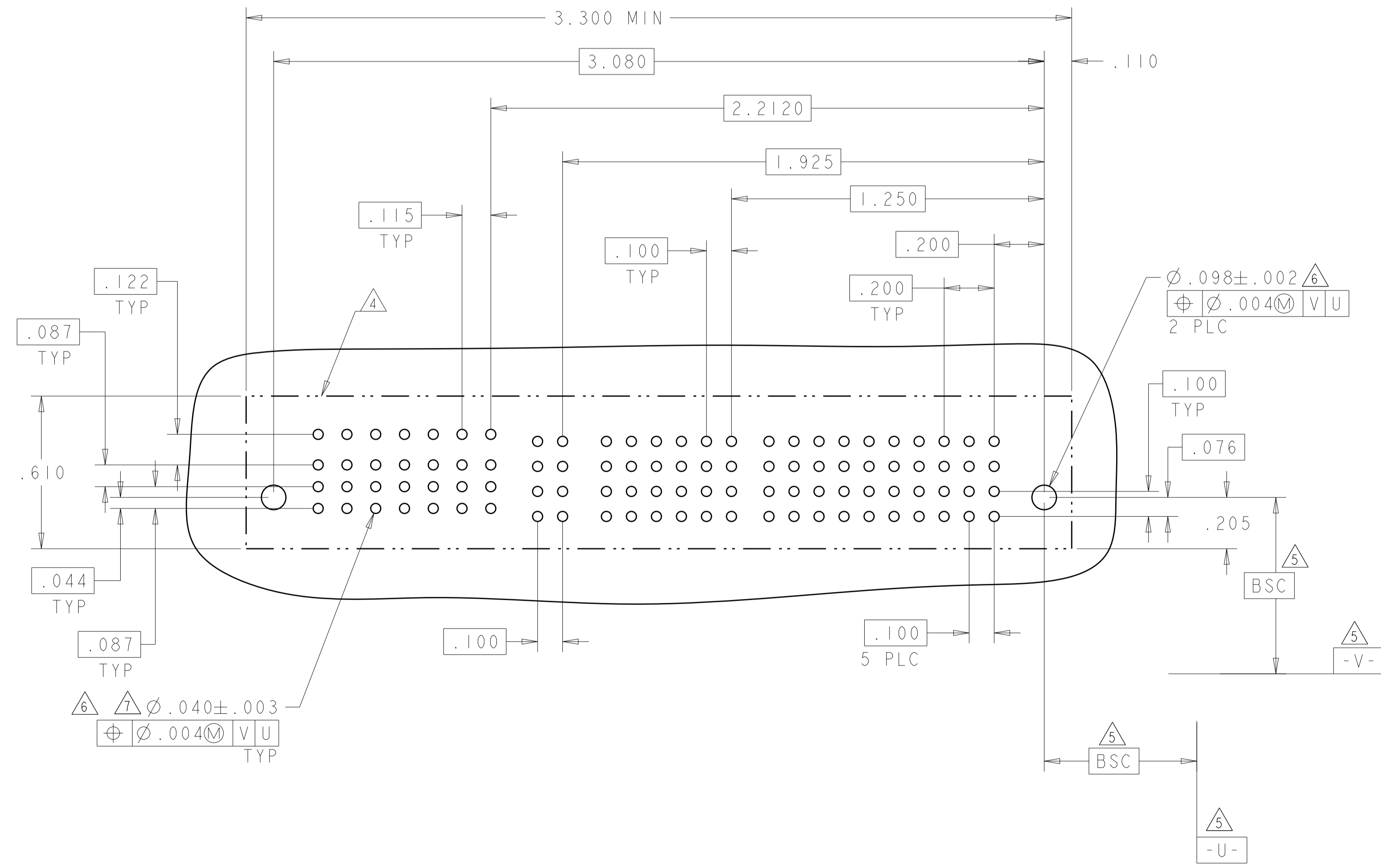
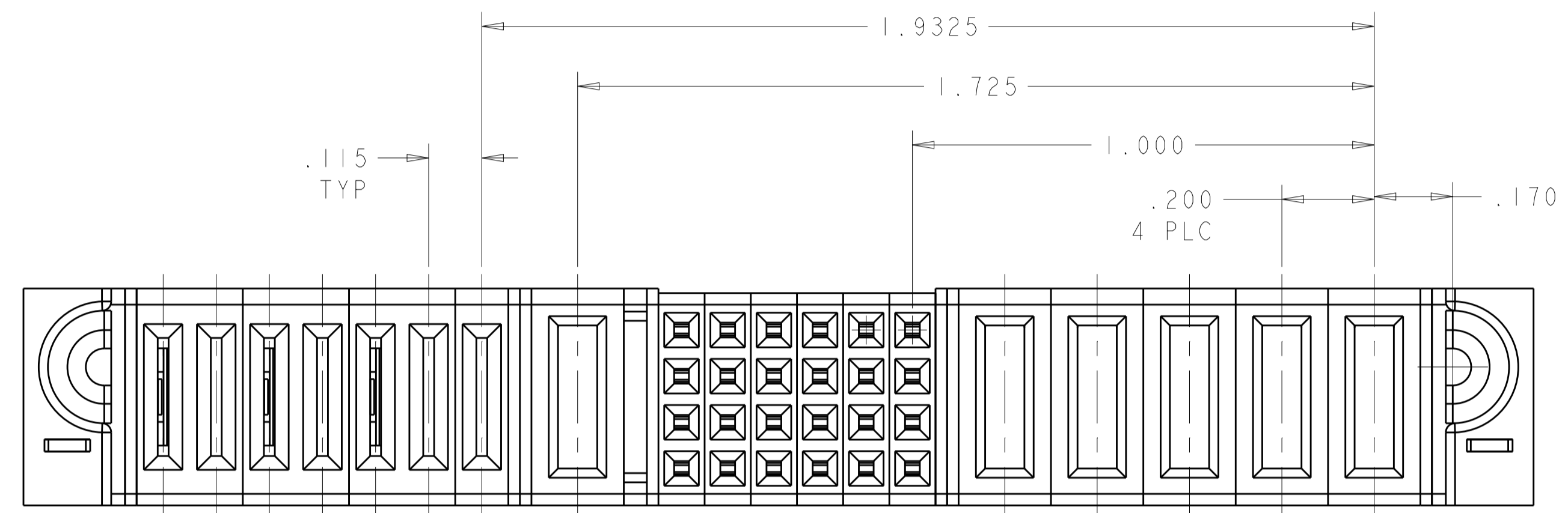

THIS DRAWING IS A CONTROLLED DOCUMENT.		DMN S. ZHAO 20SEP2007	TE Connectivity
DIMENSIONS: INCHES		CHK S. ZHAO 20SEP2007	
TOLERANCES UNLESS OTHERWISE SPECIFIED:		APVD S. YAO	NAME
0 PLC ±.01	1 PLC ±.01	PRODUCT SPEC	VERTICAL RECEPTACLE ASSEMBLY, WITH GUIDES
2 PLC ±.01	3 PLC ±.005	APPLICATION SPEC	MULTI-BEAM XLE
4 PLC ±.002	ANGLES ±.020	114-13038	SIZE CAGE CODE DRAWING NO
MATERIAL	FINISH	WEIGHT	A100779C=6450850
CUSTOMER DRAWING		SCALE 4:1	SHEET 6 OF 8 REV F

LOC	DIST	REVISIONS			
P	LTN	DESCRIPTION	DATE	DMN	APVD
ES	00	SEE SHEET 1			

PART NUMBER	ROWS	LOW POWER				SIGNAL			LOW POWER		
		LP7	LP6	LP5	LP4	3	2	1	LP3	LP2	LP1
2-6450850-0	D					E	E	E			
	C					E	E	E			
	B					E	E	E			
	A	LM	LM	LM	LM	E	E	E	LM	LM	LM
		HD									HD
3LP + 12S + 4LP											

PART NUMBER	ROWS	POWER			SIGNAL				POWER		
		P6	P5	P4	4	3	2	1	P3	P2	P1
2-6450850-1	D				E	E	E	E			
	C				E	E	E	E			
	B				E	E	E	E			
	A	VA	VM	VA	E	E	E	E	VM	VM	VA
		HD									HD
3ACP + 16S + 3P											

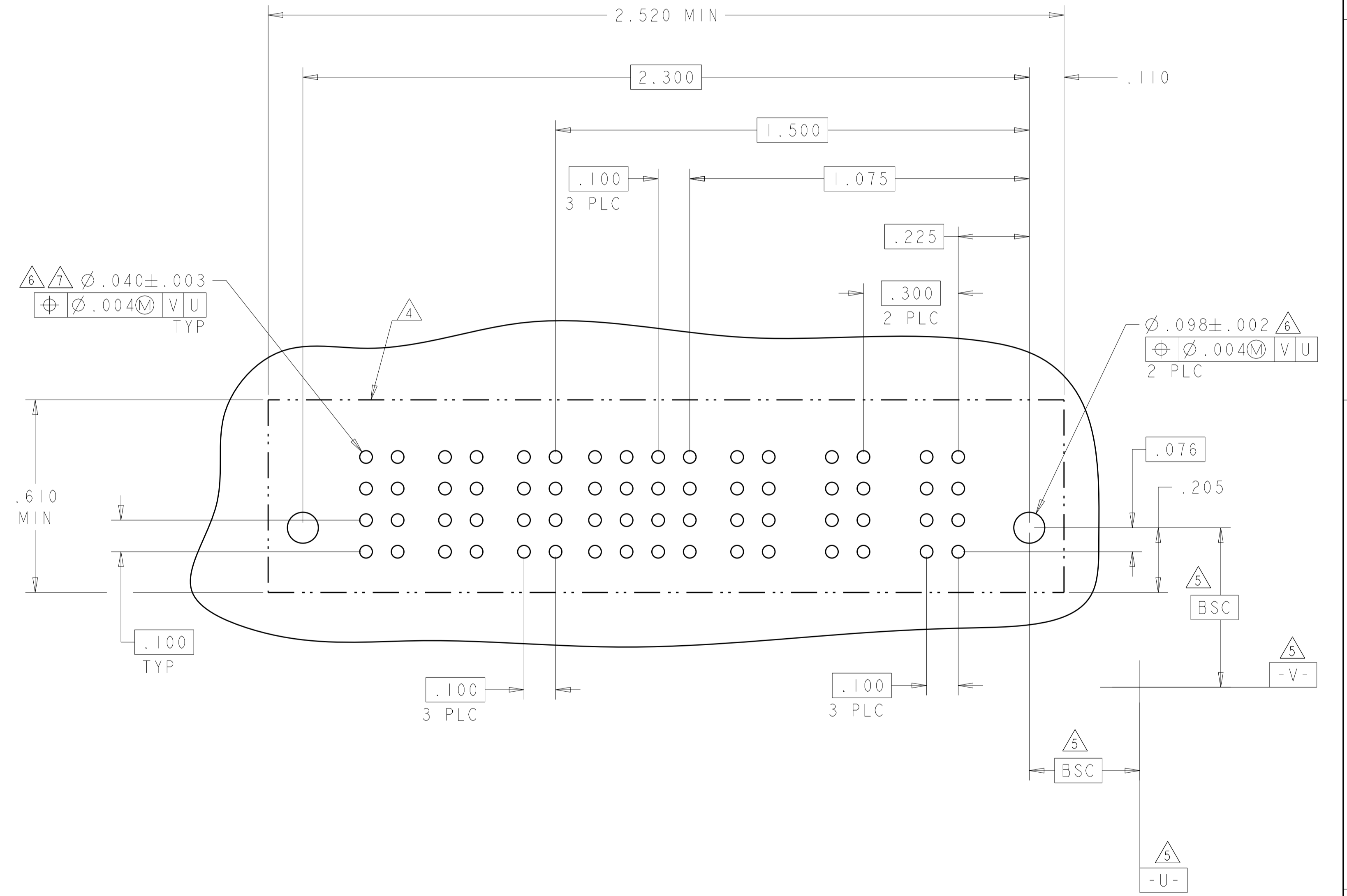
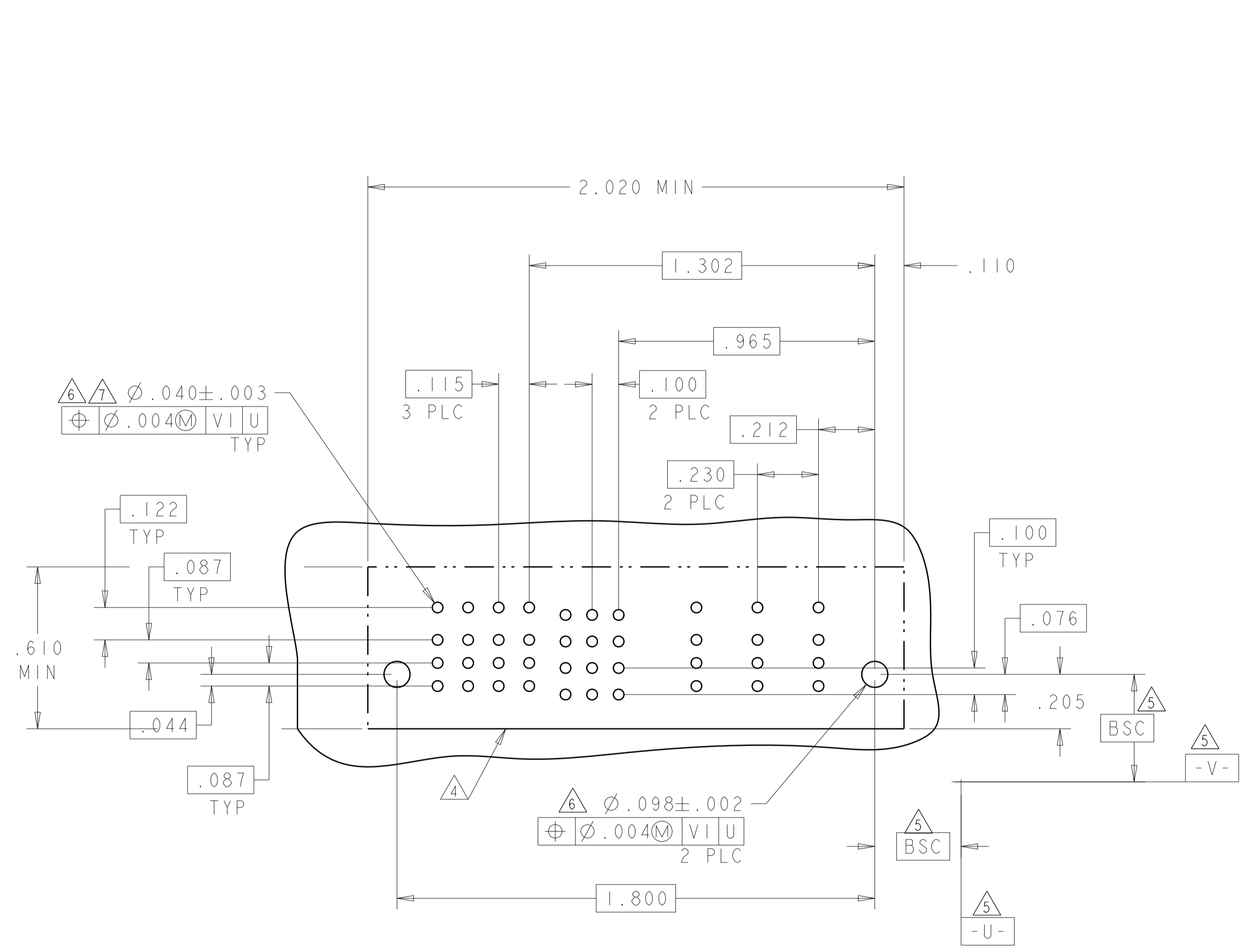

THIS DRAWING IS A CONTROLLED DOCUMENT.

DIMENSIONS: INCHES	TOLERANCES UNLESS OTHERWISE SPECIFIED: 0 PLC ±. 1 PLC ±.01 2 PLC ±.01 3 PLC ±.005 4 PLC ±.0020 ANGLES ±.7°	FINISH	DMN S. ZHAO 20SEP2007 CHK S. ZHAO 20SEP2007 APVD S. YAO	NAME PRODUCT SPEC 108-1973 APPLICATION SPEC SIZE 114-13038 WEIGHT	RESTRICTED TO
MATERIAL			CUSTOMER DRAWING	A100779C=6450850	SCALE 4:1 SHEET 7 OF 8 REV F

STE TE Connectivity
 VERTICAL RECEPTACLE ASSEMBLY, WITH GUIDES MULTI-BEAM XLE

LOC	DIST	REVISIONS			
P	LTN	DESCRIPTION	DATE	DMN	APVD
ES	00	SEE SHEET 1	-	-	-

PART NUMBER	ROWS	LOW POWER															POWER	SIGNAL								LOW POWER								
		LP25	LP24	LP23	LP22	LP21	LP20	LP19	LP18	LP17	LP16	LP15	LP14	LP13	LP12	LP11	LP10	PI	9	8	7	6	5	4	3	2	1	LP9	LP8	LP7	LP6	LP5	LP4	LP3
2-6450850-2	D																	E E E E E E E E E E E E E E E E																
	C	LM	LM	LM	LM	LM	LM	LM	LM	LM	LM	LM	LM	LM	LM	LM	VA	E E E E E E E E E E E E E E E E								LM LM LM LM LM LM LM LM LM LM LM LM LM LM LM LM								
	B																	E E E E E E E E E E E E E E E E																
	A																	E E E E E E E E E E E E E E E E																

NO CONTACTS LOADED NO CONTACTS LOADED NO CONTACT LOADED

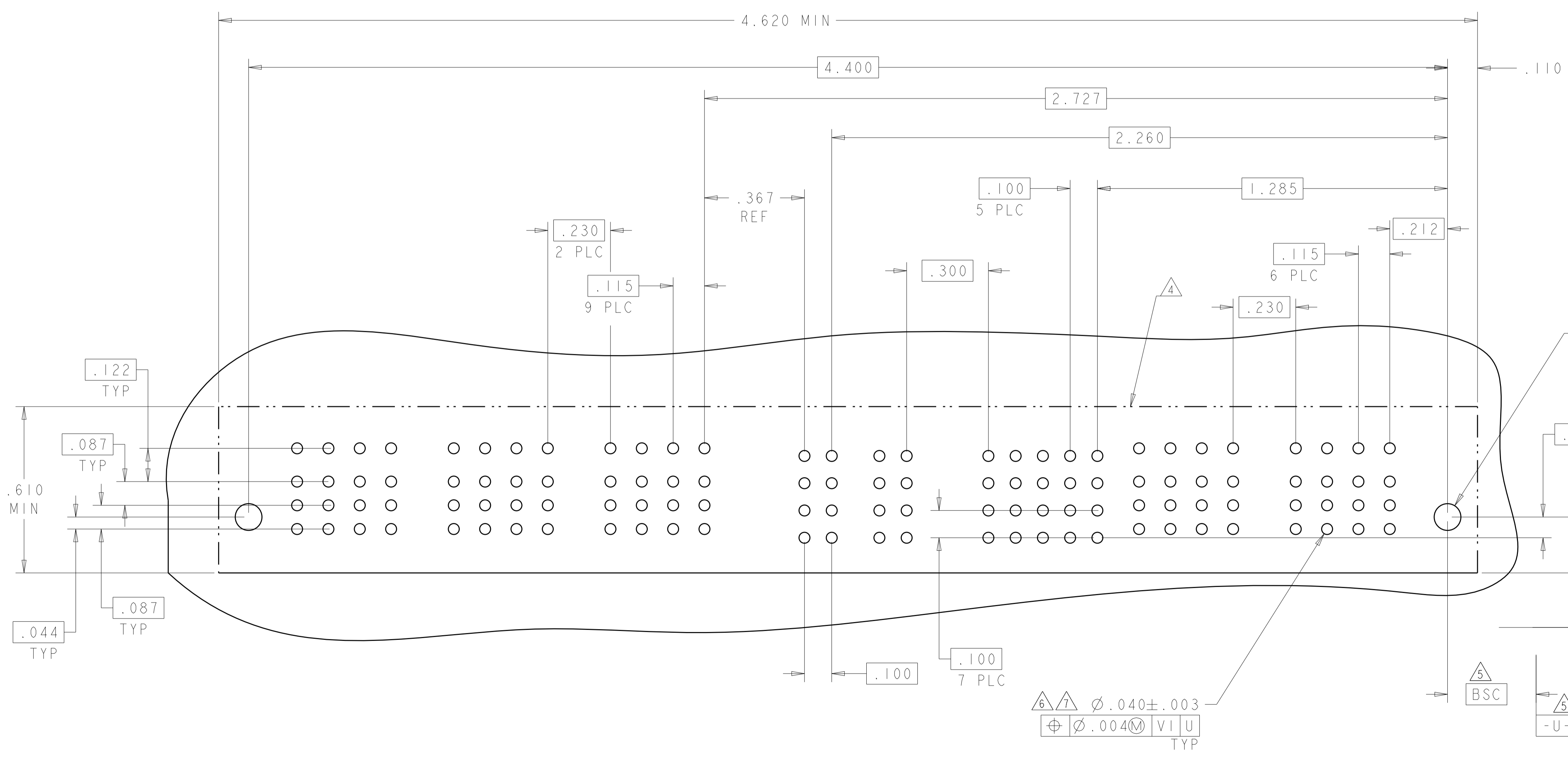
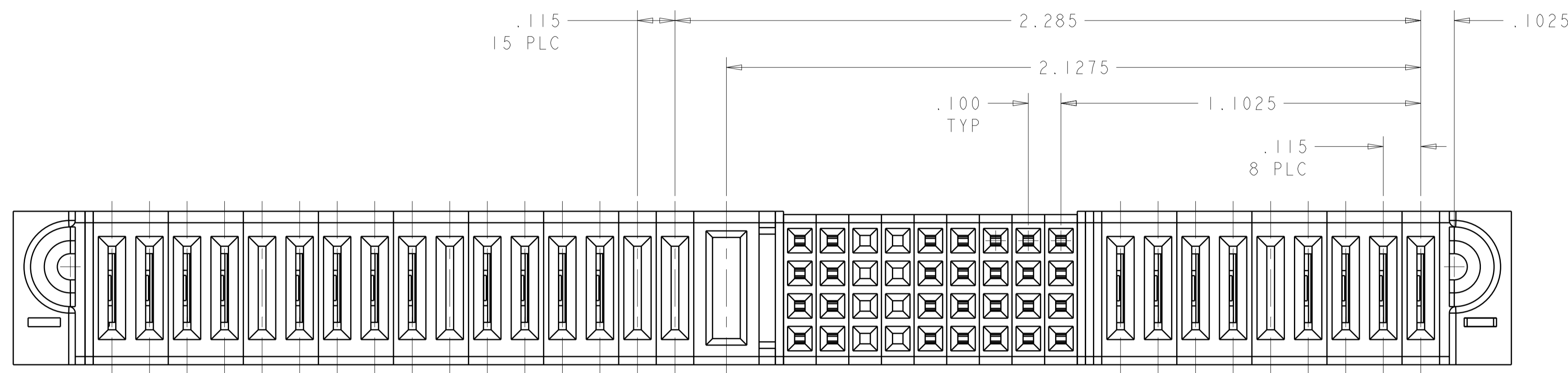

THIS DRAWING IS A CONTROLLED DOCUMENT.

DMN S. ZHAO	20SEP2007	TE Connectivity
CHK S. ZHAO	20SEP2007	
APVD S. YAO		

PRODUCT SPEC
108-1973
APPLICATION SPEC
114-13038

NAME
VERTICAL RECEPTACLE ASSEMBLY,
WITH GUIDES
MULTI-BEAM XLE

SIZE
A100779

CAGE CODE
C=6450850

RESTRICTED TO

CUSTOMER DRAWING

SCALE 4:1 SHEET 8 OF 8 REV F