



Chipsmall Limited consists of a professional team with an average of over 10 year of expertise in the distribution of electronic components. Based in Hongkong, we have already established firm and mutual-benefit business relationships with customers from,Europe,America and south Asia,supplying obsolete and hard-to-find components to meet their specific needs.

With the principle of “Quality Parts,Customers Priority,Honest Operation,and Considerate Service”,our business mainly focus on the distribution of electronic components. Line cards we deal with include Microchip,ALPS,ROHM,Xilinx,Pulse,ON,Everlight and Freescale. Main products comprise IC,Modules,Potentiometer,IC Socket,Relay,Connector.Our parts cover such applications as commercial,industrial, and automotives areas.

We are looking forward to setting up business relationship with you and hope to provide you with the best service and solution. Let us make a better world for our industry!



## Contact us

Tel: +86-755-8981 8866 Fax: +86-755-8427 6832

Email & Skype: [info@chipsmall.com](mailto:info@chipsmall.com) Web: [www.chipsmall.com](http://www.chipsmall.com)

Address: A1208, Overseas Decoration Building, #122 Zhenhua RD., Futian, Shenzhen, China



PRODUCT NUMBER  
65166-001(LF)

WHEN NEEDED, SUFFIX LETTER "LF"  
INDICATES THE PRODUCT IS RoHS  
COMPLIANT, SEE NOTE 2

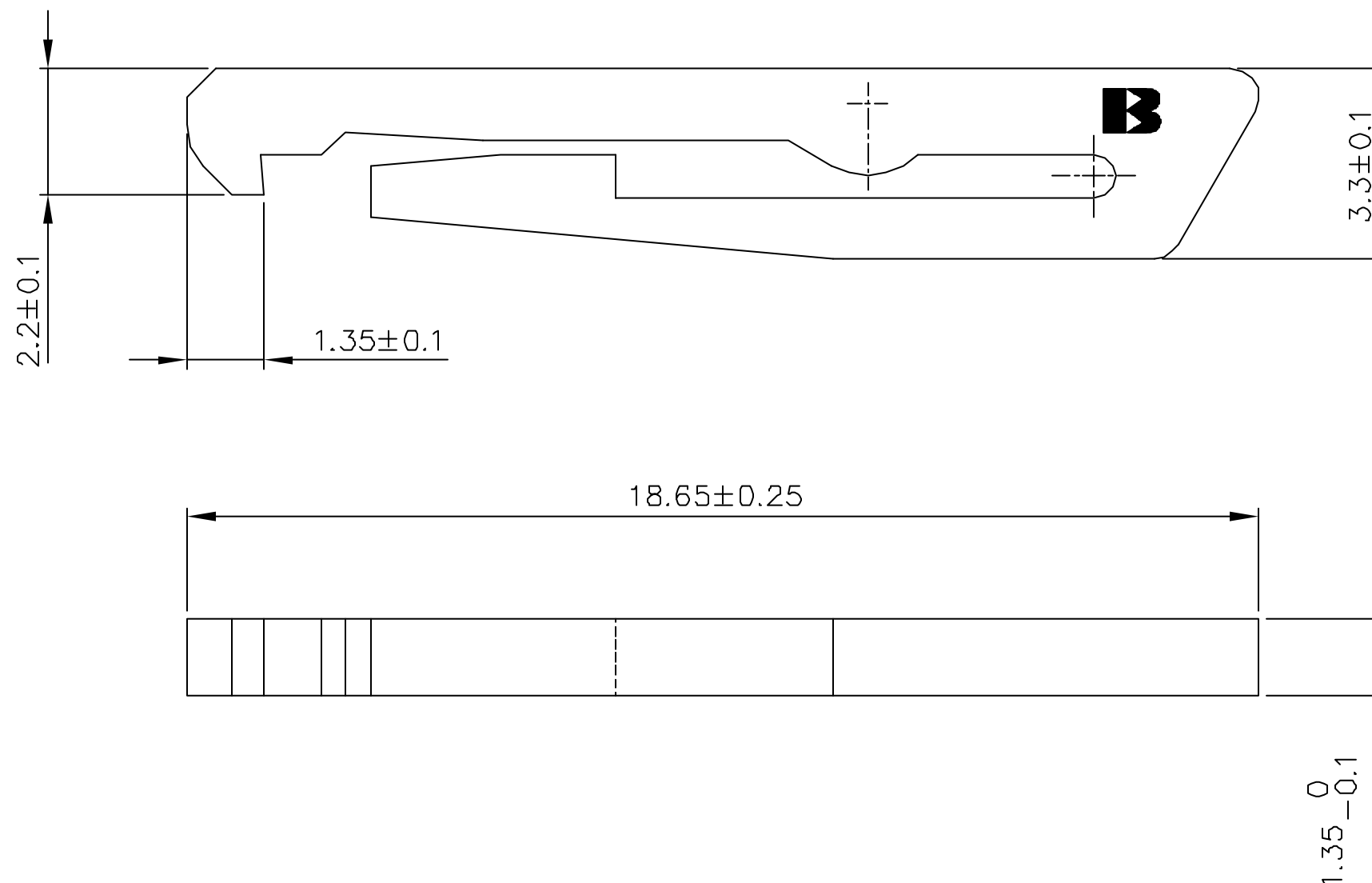
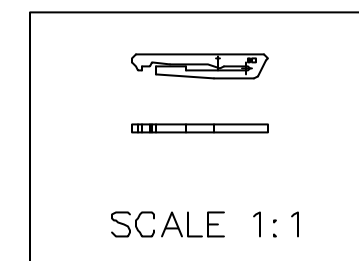

NOTES:

1. MAT'L: THERMOPLASTIC POLYESTER 30% GLASSFILLED  
UL-94-V0, COLOUR; BLEU.

2. - RoHS COMPATIBLE PRODUCT SPECIFICATIONS

a - LABELING:

- MEETS PACKAGING SPECS AS PER GS-14-920

b - LEGAL STATEMENT: SEE GS-22-008

THE PRODUCT IS NOT INTENDED TO BE EXPOSED TO A  
MANUFACTURING SOLDER PROCESS.

mat'l. code				surface		tolerance		projection	product family		
--				ISO 1302	✓	ISO 406	ISO 101	101	BERGCON		
Ltr	ecn no	dr	date	tolerances unless otherwise specified			mm		title		
A	7851	LNA	880801	angles	Linear		scale 10:1		KEY STRAIGHT		
B	V51229	DDB	950927						FOR POL. AND LATCH.		
C	H80467	LGI	980723								
D	F00406	LLA	000522	dr	D. de Bil	950927					
E	F05-0235	DLE	05.08.24	enrg	M. Loman	950927					
F	F05-0286	DLE	05.11.07	chr	M. Loman	950927					
G	F06-0218	DLE	06.07.11	appd	M. Loman	950927					
sheet	revision										
index	sheet										