



Chipsmall Limited consists of a professional team with an average of over 10 year of expertise in the distribution of electronic components. Based in Hongkong, we have already established firm and mutual-benefit business relationships with customers from,Europe,America and south Asia,supplying obsolete and hard-to-find components to meet their specific needs.

With the principle of “Quality Parts,Customers Priority,Honest Operation,and Considerate Service”,our business mainly focus on the distribution of electronic components. Line cards we deal with include Microchip,ALPS,ROHM,Xilinx,Pulse,ON,Everlight and Freescale. Main products comprise IC,Modules,Potentiometer,IC Socket,Relay,Connector.Our parts cover such applications as commercial,industrial, and automotives areas.

We are looking forward to setting up business relationship with you and hope to provide you with the best service and solution. Let us make a better world for our industry!



## Contact us

Tel: +86-755-8981 8866 Fax: +86-755-8427 6832

Email & Skype: [info@chipsmall.com](mailto:info@chipsmall.com) Web: [www.chipsmall.com](http://www.chipsmall.com)

Address: A1208, Overseas Decoration Building, #122 Zhenhua RD., Futian, Shenzhen, China



1 2 3 4 5 6

PRODUCT NUMBER  
SEE TABLE

NOTES 7 & 8

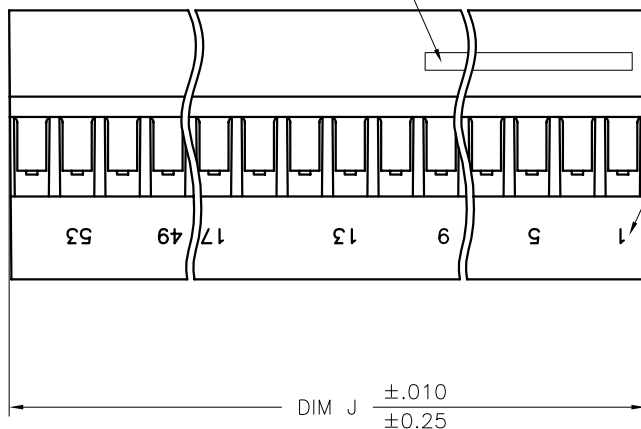

CAVITIES WILL BE MARKED STARTING WITH THE FIRST POSITION AND CONTINUING EVERY FOURTH POSITION AS SHOWN. NO PRINTING WILL OCCUR ON A HOUSING WITH LESS THAN 8 POSITIONS.

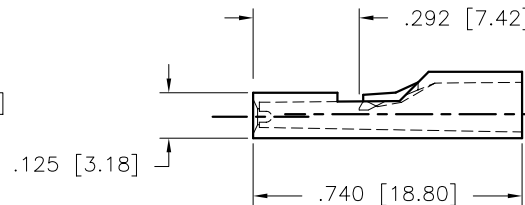
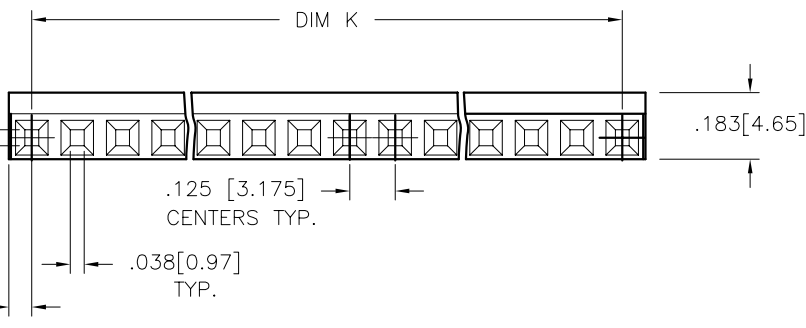

mat'l. code SEE NOTE 1				surface	tolerance	projection	product family
ltr	ec'n no	dr	date	tolerances unless otherwise specified			PV HOUSINGS
M	v07-0510	HTB	2007-08-03	angles	linear		title
-	-	-	-			INCH/MM	MAXI LATCH HOUSING 18 AWG
G	v70715	SAR	1997-06-26	0°±2°		scale 2:1	SINGLE ROW .125 [3.18]CC
H	v90981	RGD	1999-06-21	dr	E. KROPIEWNICKI	1996-04-16	dwg no
J	v03-1333	PJ	2004-01-14	engr	T. HANNA	1996-04-16	sheet 1 of 3
K	v05-0714	TAB	2005-07-29	chr	T. BREWBAKER	1996-04-16	size
L	v06-0454	HTB	2006-05-25	appd	T. BREWBAKER	1996-04-16	A3
sheet	revision	M	M	M			type
index	sheet	1	2	3			Product Customer Drawing

FCI  
FCIconnect.com

Copyright FCI

form A3

1 2 3 4 5 6

PRODUCT NUMBER  
SEE TABLE

NOTES:

1. MOLDING MATERIAL—MODIFIED POLYPHENYLENE ETHER, FLAME RETARDANT PER UL-94V-0, COLOR: BLACK.
2. PIN LENGTH TO BE .250/6.35 MIN. RECOMMENDED PIN LENGTH IS .265 ±.015 [6.720 ±.380].
3. TO LATCH TERMINAL, PUSH AS SHOWN IN FIGURE #1, BE SURE THAT LATCH SNAPS DOWN. MINIMUM PULL-OUT FORCE OF TERMINAL WILL BE 6.5 LBS[2.9Kg]. (WHEN PULLED AS SHOWN).
4. TO REMOVE TERMINAL, PUSH TERMINAL FORWARD. LIFT LATCH WITH HANDTOOL. AS SHOWN IN FIG. #2 & 3. DAMAGE TO LATCH CAN OCCUR IF LIFTED MORE THAN 25° ANGLE TO TOP OF HOUSING.
5. MAX. WIRE CRIMP AND WIRE STRANDS ARE SHOWN IN FIGURE #4. IF THIS IS EXCEEDED, LATCHING WILL NOT BE SATISFACTORY. SEE MAXI PVT™ TERMINAL SPECIFICATION TA-213 FOR CORRECT CRIMP HEIGHT FOR EACH DIFFERENT WIRE SIZE.
6. THIS HOUSING IS INTENDED FOR USE WITH MAXI PVT™ TERMINAL WITH 18-20 GAGE WIRE MEETING SPECIFICATION SHOWN IN FIGURE #4.
7. ALL MARKINGS ARE "6 POINT TYPE SET" (APPROX. AREA PER NUMERAL/LETTER IS .056/1.42 WIDE X .070/1.78 HIGH.)
8. COMPANY LOGO WILL APPEAR IN THIS AREA IF SPACE PERMITS (AT ALL TIMES) UNLESS OTHERWISE NOTED PER SPECIAL MARKING.
9. PRODUCT MEETS EUROPEAN UNION DIRECTIVES AND OTHER COUNTRY REGULATIONS AS DESCRIBED IN GS-22-008.
10. THE PRODUCT IS NOT INTENDED TO BE EXPOSED TO MANUFACTURING SOLDER PROCESS.

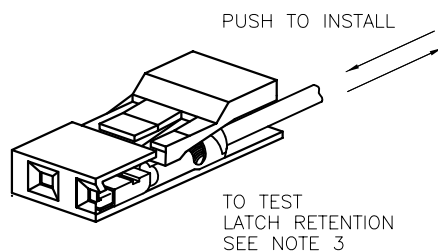

FIG. 1

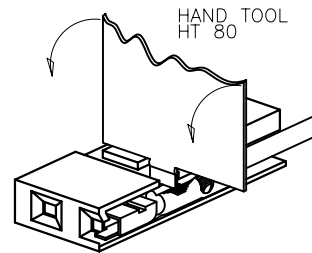

FIG. 2

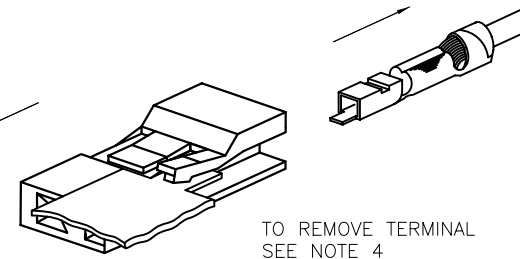

FIG. 3

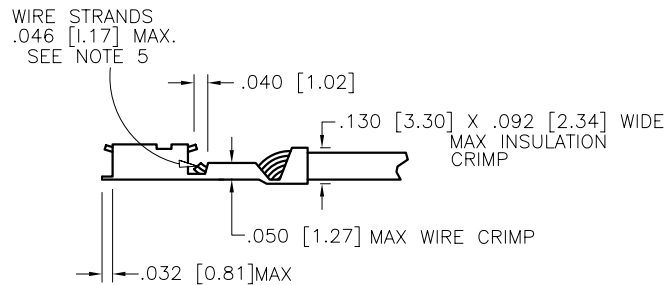

FIG. 4

mat'l. code SEE NOTE 1				surface	tolerance	projection	product family PV HOUSINGS		
ltr	ecm no	dr	date	tolerances unless otherwise specified		INCH/MM	title		
M				angles	linear		MAXI LATCH HOUSING 18 AWG		
				0° ± 2°			SINGLE ROW .125 [3.18] CC		
				dr	E. KROPIEWNICKI	1996-04-16	FCJ	dwg no	sheet 2 of 3
				engr	T. HANNA	1996-04-16		65753	size
				chr	T. BREWBAKER	1996-04-16			A3
				appd	T. BREWBAKER	1996-04-16	type Product Customer Drawing		
sheet index	revision			sheet					

FCJ  
FCconnect.com  
Copyright FCJ

PRODUCT NUMBER	NO. OF POSITIONS	DIM J	DIM K	STYLE
65753-001LF	UNAVAILABLE			
65753-002LF	2	.251/6.38	.125/3.18	—
65753-003LF	3	.376/9.55	.250/6.35	—
65753-004LF	4	.501/12.73	.375/9.53	A
65753-005LF	5	.626/15.90	.500/12.70	A
65753-006LF	6	.751/19.08	.625/15.88	A
65753-007LF	7	.876/22.25	.750/19.05	A
65753-008LF	8	1.001/25.43	.875/22.23	B
65753-009LF	9	1.126/28.60	1.000/25.40	B
65753-010LF	10	1.251/31.78	1.125/28.58	B
65753-011LF	11	1.376/34.95	1.250/31.75	B
65753-012LF	12	1.501/38.13	1.375/34.93	B
65753-013LF	13	1.626/41.30	1.500/38.10	B
65753-014LF	14	1.751/44.48	1.625/41.28	B
65753-015LF	15	1.876/47.65	1.750/44.45	B
65753-016LF	16	2.001/50.83	1.875/47.63	B
65753-017LF	17	2.126/54.00	2.000/50.80	B
65753-018LF	18	2.251/57.18	2.125/53.98	B
65753-019LF	19	2.376/60.35	2.250/57.15	B
65753-020LF	20	2.501/63.53	2.375/60.33	B
65753-021LF	21	2.626/66.70	2.500/63.50	B
65753-022LF	22	2.751/69.88	2.625/66.68	B
65753-023LF	23	2.876/73.05	2.750/69.85	B
65753-024LF	24	3.001/76.23	2.875/73.03	B
65753-025LF	25	3.126/79.40	3.000/76.20	B
65753-026LF	26	3.251/82.58	3.125/79.38	B
65753-027LF	27	3.376/85.75	3.250/82.55	B
65753-028LF	28	3.501/88.93	3.375/85.73	B

mat'l. code SEE NOTE 1				surface <input checked="" type="checkbox"/>		tolerance		projection		product family PV HOUSINGS	
ltr	ec'n no	dr	date	tolerances unless otherwise specified						title	
M				angles	linear	.XX+.01/.X+.3		INCH/MM		MAXI LATCH HOUSING 18 AWG	
						.XXX+.005/.XXX+.13				SINGLE ROW .125 [3.18]CC	
				0'±2"		XXXX+.0020/.XXX+.051		scale 2:1		dwg no	
				dr	E. KROPIEWNICKI	1996-04-16				sheet 3 of 3	
				engr	T. HANNA	1996-04-16				size	
				chr	T. BREWBAKER	1996-04-16				A3	
				appd	T. BREWBAKER	1996-04-16				type	
sheet index		revision sheet								Product Customer Drawing	