



Chipsmall Limited consists of a professional team with an average of over 10 year of expertise in the distribution of electronic components. Based in Hongkong, we have already established firm and mutual-benefit business relationships with customers from,Europe,America and south Asia,supplying obsolete and hard-to-find components to meet their specific needs.

With the principle of “Quality Parts,Customers Priority,Honest Operation,and Considerate Service”,our business mainly focus on the distribution of electronic components. Line cards we deal with include Microchip,ALPS,ROHM,Xilinx,Pulse,ON,Everlight and Freescale. Main products comprise IC,Modules,Potentiometer,IC Socket,Relay,Connector.Our parts cover such applications as commercial,industrial, and automotives areas.

We are looking forward to setting up business relationship with you and hope to provide you with the best service and solution. Let us make a better world for our industry!



Contact us

Tel: +86-755-8981 8866 Fax: +86-755-8427 6832

Email & Skype: info@chipsmall.com Web: www.chipsmall.com

Address: A1208, Overseas Decoration Building, #122 Zhenhua RD., Futian, Shenzhen, China



This drawing involves proprietary design rights of Tyco Electronics Corporation, and all design, manufacture, reproduction, use and sale rights regarding the same are expressly reserved. It is submitted for a specific purpose and the recipient by accepting this drawing, assumes custody and control and agrees to take reasonable precautions: (a) that this drawing will not be copied and reproduced, in whole or in part, or its contents revealed in any manner, or to any person except to meet the purpose for which it was delivered and (b) that any special features peculiar to this design will not be incorporated in other projects without the expressed written permission of Tyco Electronics Corporation.

REVISIONS			
EC	REV	DESCRIPTION	DATE
CPR	A	NEW RELEASE	02/16/06

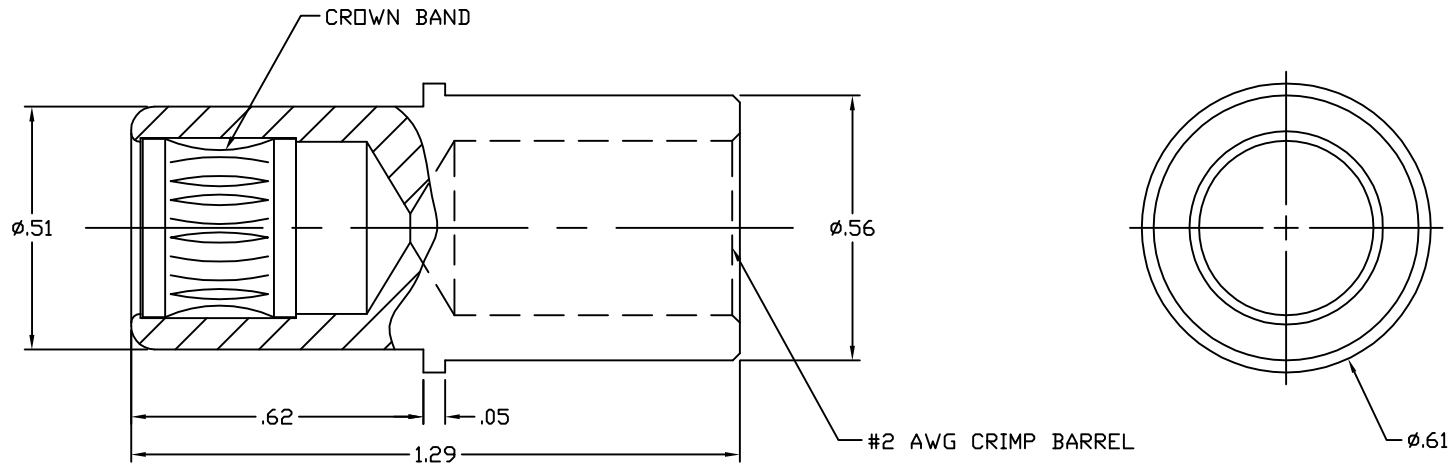

4. FOR TERMINATION, USE FOLLOWING EQUIPMENT:

INDENTOR DIE SET: 84C-E011
 CRIMP TOOL: 84C-E031
 LOCATOR: PIC0# 4066

3. FINISHES:

SOCKET BODY: SILVER PLATED, .000200 MIN THICK
 OVER NICKEL PLATED, .000040 MIN THICK
 CROWN BAND: GOLD PLATED, .000030 MIN THICK
 OVER NICKEL PLATED, .000040 MIN THICK

2. MATERIAL:

SOCKET BODY: TELLURIUM COPPER ALLOY,
 CROWN BAND: BERYLLIUM COPPER ALLOY.

1. PART NUMBER CHANGES AND OR DESIGN CHANGES AFFECTING ITEM INTERCHANGEABILITY REQUIRE PRIOR ELCON APPROVAL AND AUTHORIZATION BY REVISION TO THIS DRAWING.

NOTES: UNLESS OTHERWISE SPECIFIED

INCH OR INCH (MM) THIRD ANGLE PROJECTION UNLESS OTHERWISE SPECIFIED DIMENSIONS ARE IN INCHES (METRIC) TOLERANCES ANGLES ± .5° DECIMALS .XXX ± .010 (.25) .XX ± .02 (.3)	DRAWN	DATE	6648407-1		AS SHOWN	
	HA NGUYEN	02/16/06	PART NUMBER	DESCRIPTION		
	CHECKED		Tyco Electronics Corporation Menlo Park, Ca 94025			
	APPROVED		TITLE			
	APPROVED		CONTACT, SOCKET, SIZE #0 WITH #2 AWG CRIMP BARREL SINGLE CROWN			
	S. FLICKINGER	02/16/06	SIZE	DWG NUMBER	REV.	
	DCA APPROVED		B	C = 6648407	A	
	HA NGUYEN	02/16/06	ACAD FILE NUMBER C6648407A.DWG			DWG SCALE 4=1 SH 1 OF 1