



Chipsmall Limited consists of a professional team with an average of over 10 year of expertise in the distribution of electronic components. Based in Hongkong, we have already established firm and mutual-benefit business relationships with customers from,Europe,America and south Asia,supplying obsolete and hard-to-find components to meet their specific needs.

With the principle of “Quality Parts,Customers Priority,Honest Operation,and Considerate Service”,our business mainly focus on the distribution of electronic components. Line cards we deal with include Microchip,ALPS,ROHM,Xilinx,Pulse,ON,Everlight and Freescale. Main products comprise IC,Modules,Potentiometer,IC Socket,Relay,Connector.Our parts cover such applications as commercial,industrial, and automotives areas.

We are looking forward to setting up business relationship with you and hope to provide you with the best service and solution. Let us make a better world for our industry!



## Contact us

Tel: +86-755-8981 8866 Fax: +86-755-8427 6832

Email & Skype: info@chipsmall.com Web: www.chipsmall.com

Address: A1208, Overseas Decoration Building, #122 Zhenhua RD., Futian, Shenzhen, China



THIS IS A C.A.D. GENERATED DRAWING  
DO NOT MAKE MANUAL REVISIONS TO MASTER.

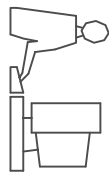

TOLERANCE:  
IN MM  
.XX ±0.01  
.XXX ±0.006  
.XXXX ±0.002  
:X ±0.25  
:XX ±0.15  
:XXX ±0.05

ISSUE NUMBER	
DIM: 0.612(15.55) WAS 0.63(16.0)	⑥
0.439(11.15) WAS 0.445(11.30)	
0.153(3.90) WAS 0.146(3.70)	
ADD DIM: 0.238(6.04), 0.207(5.25)	
0.177(4.5), 0.078(2.0), 0.024(0.60)	
R.STA.MONICA JUN.10/2010	
0.333(8.45) AND 0.306(7.78) WAS 0.372(9.45) AND 0.331(8.40)	⑦
F.BRIONES OCT.08/10	
ADD OPERATING TEMPERATURE R.STA.MONICA APR.10/2014	⑧

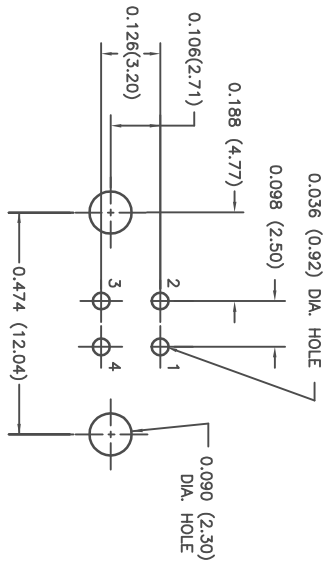

PC BOARD MOUNTING DIMENSIONS

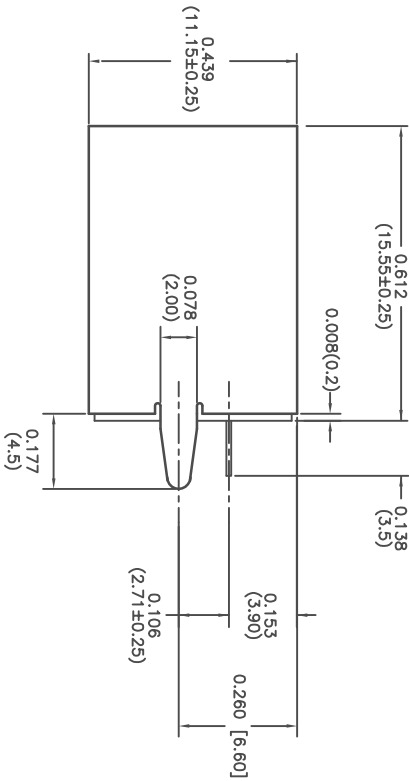
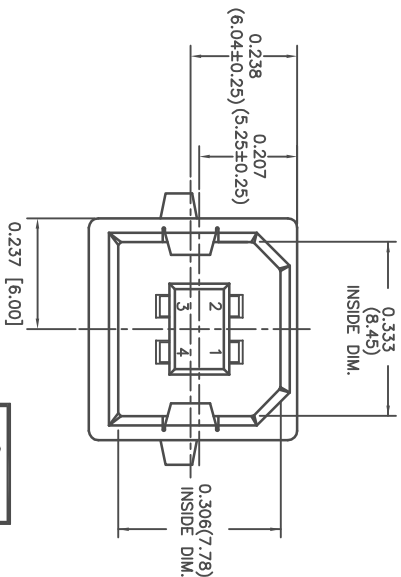
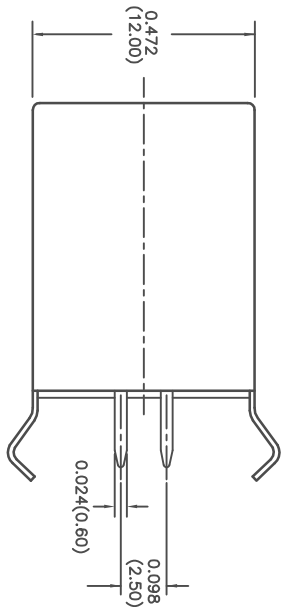

THIS SERIES FULLY CONFORMS TO THE  
EUROPEAN UNION DIRECTIVES  
2011/65/EU FOR ROHS COMPLIANCY.

- CONTACT CODE \_\_\_\_\_
- SPECIFICATIONS:
1. CONTACT RESISTANCE:  
30 MOHM MAX
  2. INSULATION RESISTANCE:  
1000OHM MIN AT 500VDC
  3. RATED VOLTAGE AND CURRENT:  
1.5A @ 250VAC MIN.
  4. DIELECTRIC WITHSTANDING VOLTAGE:  
500VAC (RMS) FOR 1MIN
  5. INSERTION FORCE: 35N MIN
  6. EXTRACTION FORCE: 10N MIN
- OPERATING TEMPERATURE: -55°C TO +85°C

USB CONNECTOR B TYPE, VERTICAL, SINGLE DECK

**EDAC INC**  
TORONTO, ONTARIO  
CANADA

THESE DRAWINGS AND SPECIFICATIONS  
ARE THE PROPERTY OF EDAC INC. AND  
SHALL NOT BE REPRODUCED, OR COPIED  
OR USED AS THE BASIS FOR THE  
MANUFACTURE OR SALE OF APPARATUS  
WITHOUT WRITTEN PERMISSION.

ACAD REFERENCE NO.	690-004-260-023
DRAWN:	J. CHOW
CHECKED:	DATE:
SCALE: (IN C.A.D. 1:1)	SHEET 1 OF 1
DRAWING NUMBER	ISSUE
690-004-260-023	8