



Chipsmall Limited consists of a professional team with an average of over 10 year of expertise in the distribution of electronic components. Based in Hongkong, we have already established firm and mutual-benefit business relationships with customers from,Europe,America and south Asia,supplying obsolete and hard-to-find components to meet their specific needs.

With the principle of "Quality Parts,Customers Priority,Honest Operation,and Considerate Service",our business mainly focus on the distribution of electronic components. Line cards we deal with include Microchip,ALPS,ROHM,Xilinx,Pulse,ON,Everlight and Freescale. Main products comprise IC,Modules,Potentiometer,IC Socket,Relay,Connector.Our parts cover such applications as commercial,industrial, and automotives areas.

We are looking forward to setting up business relationship with you and hope to provide you with the best service and solution. Let us make a better world for our industry!



## Contact us

Tel: +86-755-8981 8866 Fax: +86-755-8427 6832

Email & Skype: [info@chipsmall.com](mailto:info@chipsmall.com) Web: [www.chipsmall.com](http://www.chipsmall.com)

Address: A1208, Overseas Decoration Building, #122 Zhenhua RD., Futian, Shenzhen, China



LOC	DIST	P	F	REVISIONS			DATE	APPD
				ZONE	LTR	DESCRIPTION		
G	86				A	REL PER 063A-0649-02	280CT02	MS

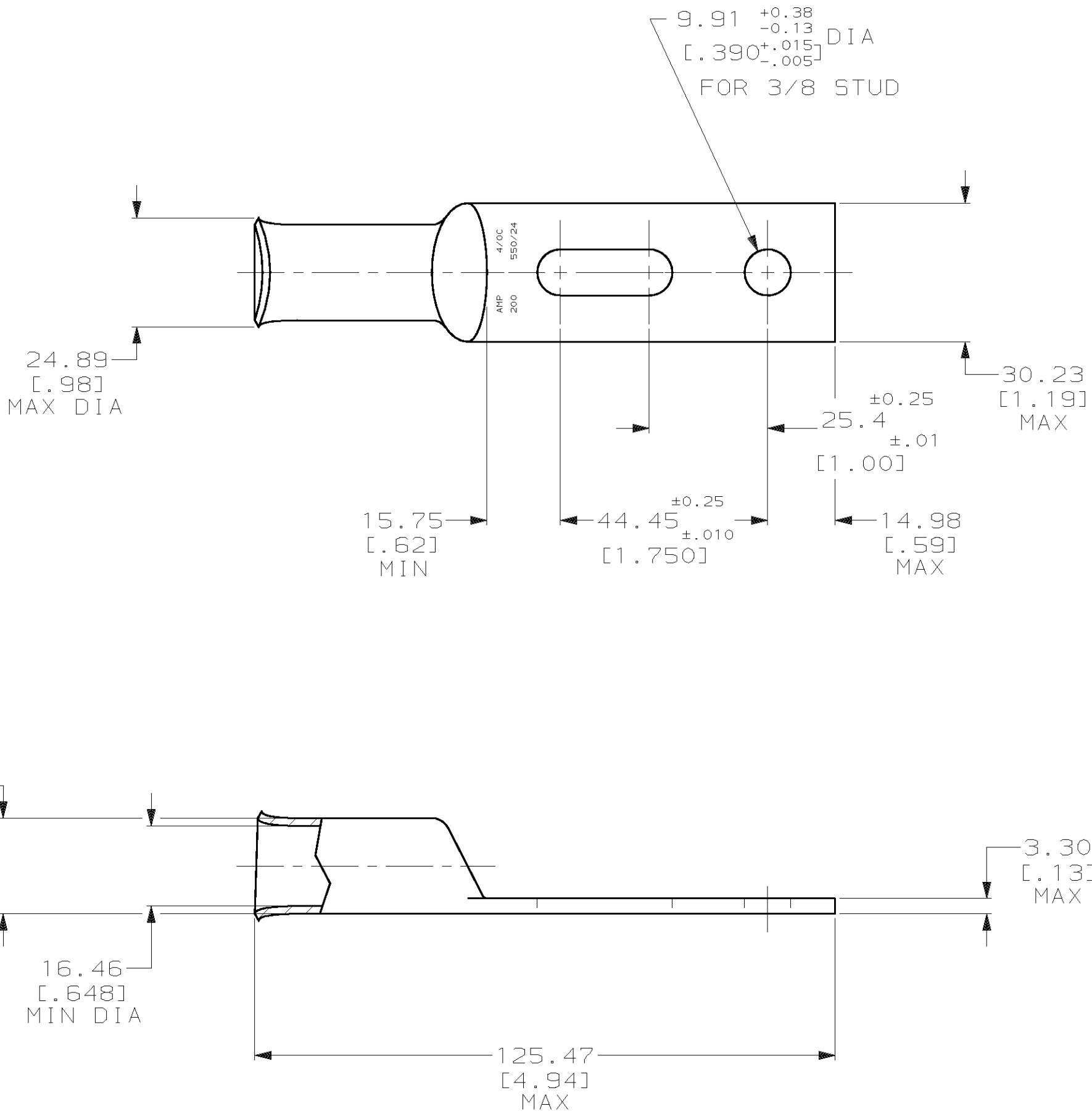

1 CIRCULAR MIL RANGE: 190,000-231,000 CM

696460-1			
PART NO			
DO NOT SCALE PRINT. UNLESS SPECIFIED DIMENSIONS IN mm [INCHES] TOLERANCES ON : 2 PLC DEC ± 0.51[.020] 3 PLC DEC ± - ANGLES ± -		DR 07JUL02 JR RUTH CHK 07JUL02 MS FEHER APPD 07JUL02 MJ SPICER APPD 07JUL02 MJ SPICER PRODUCT SPEC -	
MATERIAL COPPER ASTM B-188 ANNEALED		NAME TERMINAL, RECTANGULAR TONGUE, AMPOWER™ WIRE SIZE: 4/0 AWG	
FINISH TIN PLATE 0.00381[.000150] MIN THK PER MIL-T-10727		APPLICATION SPEC -	SIZE C
WEIGHT -		SCALE 1:1	CAGE CODE 00779
		SHEET 1 OF 1	DRAWING NO C-696460

THIS DRAWING IS A CONTROLLED DOCUMENT FOR AMP INCORPORATED. IT IS SUBJECT TO CHANGE AND THE CONTROLLING ENGINEERING ORGANIZATION SHOULD BE CONTACTED FOR THE LATEST REVISION.