



Chipsmall Limited consists of a professional team with an average of over 10 year of expertise in the distribution of electronic components. Based in Hongkong, we have already established firm and mutual-benefit business relationships with customers from,Europe,America and south Asia,supplying obsolete and hard-to-find components to meet their specific needs.

With the principle of “Quality Parts,Customers Priority,Honest Operation,and Considerate Service”,our business mainly focus on the distribution of electronic components. Line cards we deal with include Microchip,ALPS,ROHM,Xilinx,Pulse,ON,Everlight and Freescale. Main products comprise IC,Modules,Potentiometer,IC Socket,Relay,Connector.Our parts cover such applications as commercial,industrial, and automotives areas.

We are looking forward to setting up business relationship with you and hope to provide you with the best service and solution. Let us make a better world for our industry!



## Contact us

Tel: +86-755-8981 8866 Fax: +86-755-8427 6832

Email & Skype: [info@chipsmall.com](mailto:info@chipsmall.com) Web: [www.chipsmall.com](http://www.chipsmall.com)

Address: A1208, Overseas Decoration Building, #122 Zhenhua RD., Futian, Shenzhen, China



4

3

2

1

THIS DRAWING IS UNPUBLISHED.

RELEASED FOR PUBLICATION

© COPYRIGHT - BY TYCO ELECTRONICS CORPORATION. ALL RIGHTS RESERVED.

LOC

DIST

REVISIONS

P

LTR

DESCRIPTION

DATE

DWN

APVD

G

86

A

REL PER ECR 05-004064

06JUN05

JR

MS

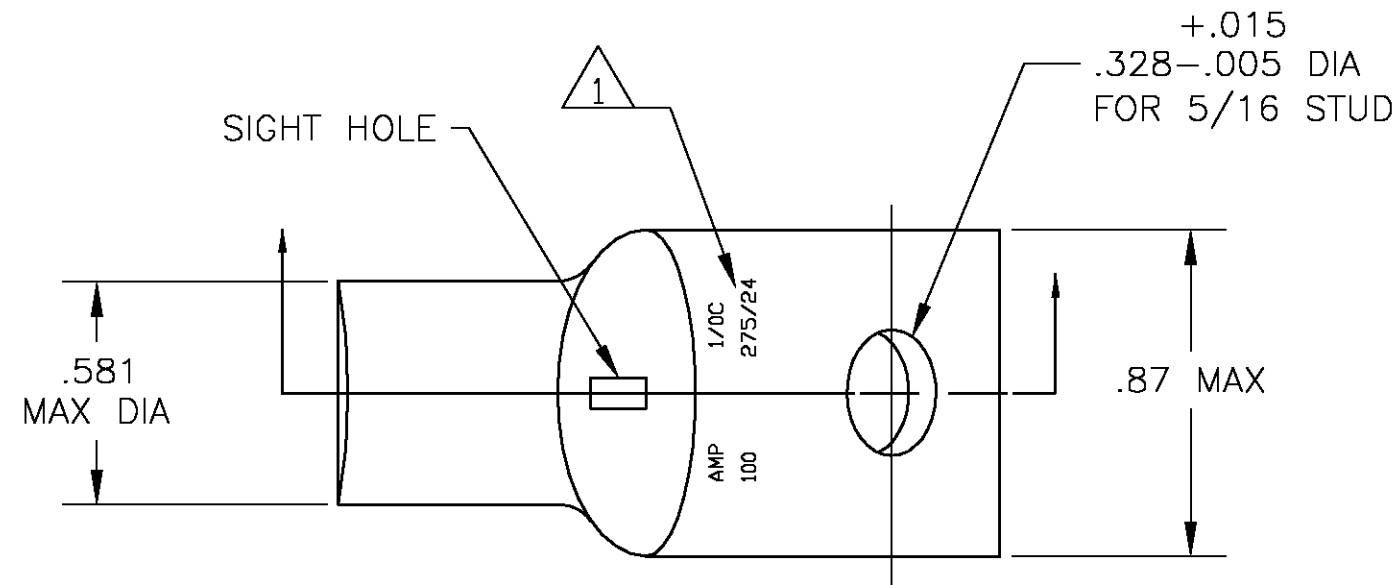

- 1 STAMP "AMP 1/0C 100 275/24" APPROX AS SHOWN.
- 2 MATERIAL: COPPER PER ASTM B-75, ANNEALED
- 3 FINISH: TIN PLATE .000150 MIN THK PER ASTM B-545
- 4 PREPRODUCTION - FASR REQ

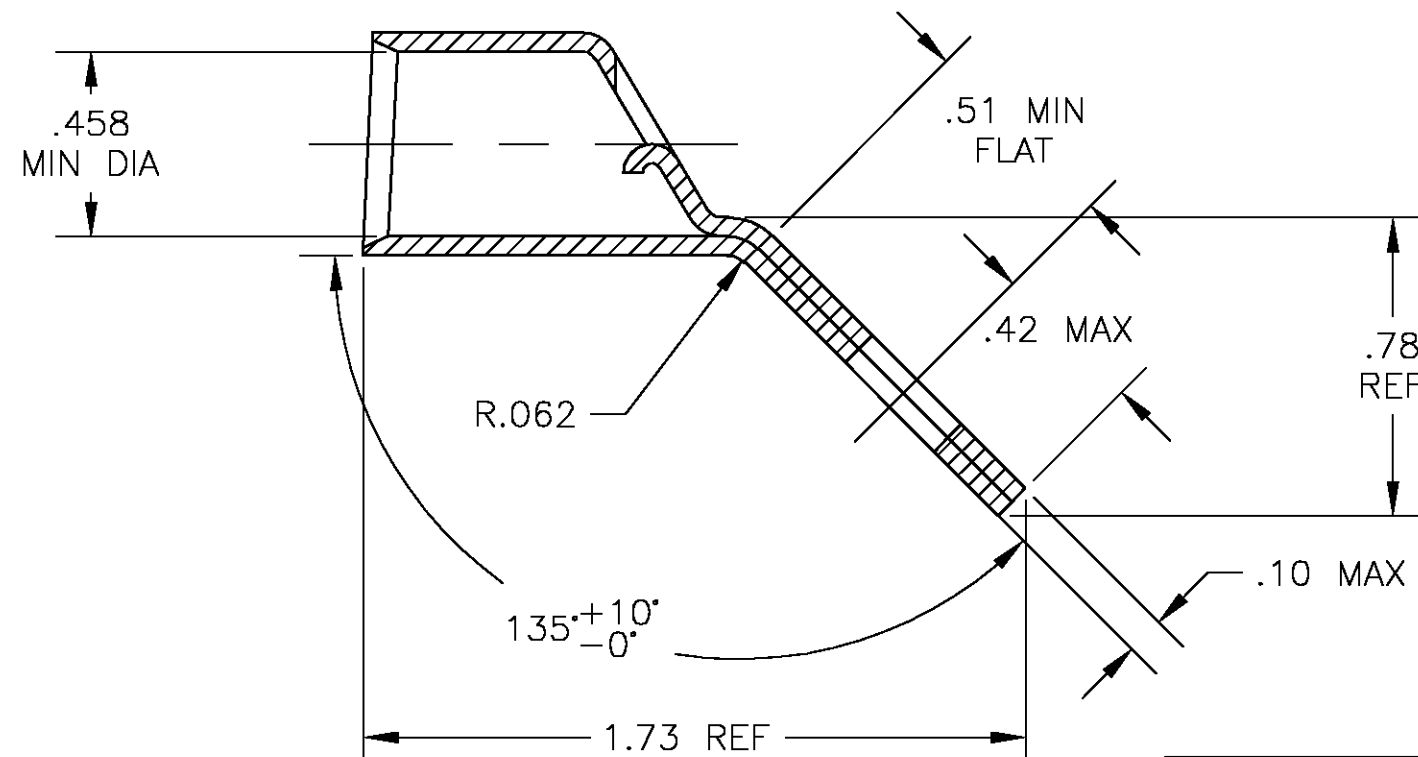

696762-1

PART NO.

AMP INCORPORATED  
CUSTOMER SERVICE SYSTEMSMAX RECOMMENDED OPERATING  
TEMPERATURE:  
170°C MAXFOR ADDITIONAL  
PRODUCT INFORMATION OR  
COPIES OF DRAWINGS  
AND TECHNICAL DOCUMENTSPRODUCT INFORMATION CENTER  
1-800-522-6752FOR APPLICATION  
TOOLING INFORMATIONTOOLING ASSISTANCE CENTER  
1-800-722-1111

FOR ORDER ENTRY

1-800-526-5142

THIS DRAWING IS A CONTROLLED DOCUMENT FOR  
AMP INCORPORATED. IT IS SUBJECT TO CHANGE  
AND THE CONTROLLING ENGINEERING ORGANIZATION  
SHOULD BE CONTACTED FOR THE LATEST REVISION.VOLTAGE RATING:  
N/ACIRCULAR MIL AREA:  
42.41-60.55mm<sup>2</sup>[83,700-119,500]  
STRANDED

THIS DRAWING IS A CONTROLLED DOCUMENT.

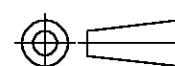
DIMENSIONS:  
INCHES

MATERIAL

2

TOLERANCES UNLESS  
OTHERWISE SPECIFIED:0 PLC ± -  
1 PLC ± -  
2 PLC ± -  
3 PLC ± .008  
4 PLC ± -  
ANGLES ± -  
FINISH

3

DWN jr\_ruth 14FEB05

CHK MJ SPICER 14FEB05

APVD MJ SPICER 14FEB05

PRODUCT SPEC

APPLICATION SPEC

WEIGHT -

CUSTOMER DRAWING

tyco  
ElectronicsTyco Electronics Corporation  
Harrisburg, Pa 17105-3608

NAME

TERMINAL, AMPPOWER

SIZE

CAGE CODE

DRAWING NO

RESTRICTED TO

A3

00779

C-696762

SCALE 1:1

SHEET 1 OF 1

REV A