



Chipsmall Limited consists of a professional team with an average of over 10 year of expertise in the distribution of electronic components. Based in Hongkong, we have already established firm and mutual-benefit business relationships with customers from,Europe,America and south Asia,supplying obsolete and hard-to-find components to meet their specific needs.

With the principle of "Quality Parts,Customers Priority,Honest Operation,and Considerate Service",our business mainly focus on the distribution of electronic components. Line cards we deal with include Microchip,ALPS,ROHM,Xilinx,Pulse,ON,Everlight and Freescale. Main products comprise IC,Modules,Potentiometer,IC Socket,Relay,Connector.Our parts cover such applications as commercial,industrial, and automotives areas.

We are looking forward to setting up business relationship with you and hope to provide you with the best service and solution. Let us make a better world for our industry!



Contact us

Tel: +86-755-8981 8866 Fax: +86-755-8427 6832

Email & Skype: info@chipsmall.com Web: www.chipsmall.com

Address: A1208, Overseas Decoration Building, #122 Zhenhua RD., Futian, Shenzhen, China



4

3

2

1

THIS DRAWING IS UNPUBLISHED.

RELEASED FOR PUBLICATION

- . - .

©

COPYRIGHT - By -

ALL RIGHTS RESERVED.

LOC

DIST

REVISIONS

G

86

P

LTR

DESCRIPTION

DATE

DWN

APVD

B

ECR-13-007581

08MAY2013

PK

HS

1 STAMP " AMP 400C 1100/24"
APPROX AS SHOWN.

2 MATERIAL: COPPER PER ASTM B-75,
ANNEALED

3 FINISH: TIN PLATE .000150 MIN THK
PER ASTM B-545

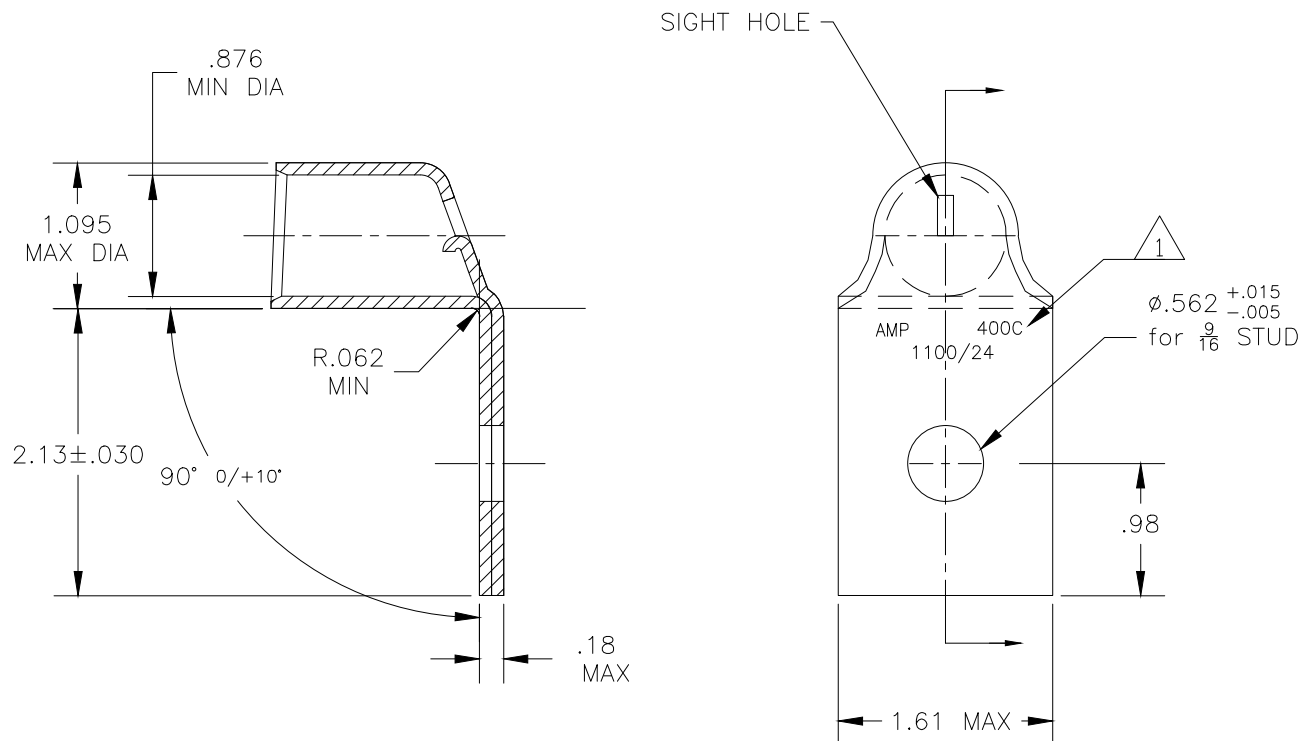

696766-1

PART NO.

AMP INCORPORATED CUSTOMER SERVICE SYSTEMS

FOR ADDITIONAL
PRODUCT INFORMATION OR
COPIES OF DRAWINGS
AND TECHNICAL DOCUMENTS

PRODUCT INFORMATION CENTER
1-800-522-6752

FOR APPLICATION

TOOLING ASSISTANCE CENTER

TOOLING INFORMATION

1-800-722-1111

FOR ORDER ENTRY

1-800-526-5142

THIS DRAWING IS A CONTROLLED DOCUMENT FOR
AMP INCORPORATED. IT IS SUBJECT TO CHANGE
AND THE CONTROLLING ENGINEERING ORGANIZATION
SHOULD BE CONTACTED FOR THE LATEST REVISION.

MAX RECOMMENDED OPERATING
TEMPERATURE:

170°C MAX

VOLTAGE RATING:
N/A

CIRCULAR MIL AREA:
375,000-450,000
STRANDED

THIS DRAWING IS A CONTROLLED DOCUMENT.

DIMENSIONS:
INCHES

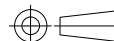

MATERIAL

2

TOLERANCES UNLESS
OTHERWISE SPECIFIED:

0 PLC ± -
1 PLC ± -
2 PLC ± .02
3 PLC ± .008
4 PLC ± -
ANGLES ± -

FINISH

3

DWN jr ruth 16FEB05

CHK MJ SPICER 16FEB05

APVD MJ SPICER 16FEB05

PRODUCT SPEC

APPLICATION SPEC

WEIGHT

CUSTOMER DRAWING



TE Connectivity

NAME

TERMINAL, AMPPOWER
WIRE SIZE: 400 MCM

SIZE

CAGE CODE

DRAWING NO

RESTRICTED TO

A3

00779

C=696766

SCALE 1:1

SHEET 1 OF 1

REV B