



Chipsmall Limited consists of a professional team with an average of over 10 year of expertise in the distribution of electronic components. Based in Hongkong, we have already established firm and mutual-benefit business relationships with customers from,Europe,America and south Asia,supplying obsolete and hard-to-find components to meet their specific needs.

With the principle of “Quality Parts,Customers Priority,Honest Operation,and Considerate Service”,our business mainly focus on the distribution of electronic components. Line cards we deal with include Microchip,ALPS,ROHM,Xilinx,Pulse,ON,Everlight and Freescale. Main products comprise IC,Modules,Potentiometer,IC Socket,Relay,Connector.Our parts cover such applications as commercial,industrial, and automotives areas.

We are looking forward to setting up business relationship with you and hope to provide you with the best service and solution. Let us make a better world for our industry!



## Contact us

Tel: +86-755-8981 8866 Fax: +86-755-8427 6832

Email & Skype: info@chipsmall.com Web: www.chipsmall.com

Address: A1208, Overseas Decoration Building, #122 Zhenhua RD., Futian, Shenzhen, China



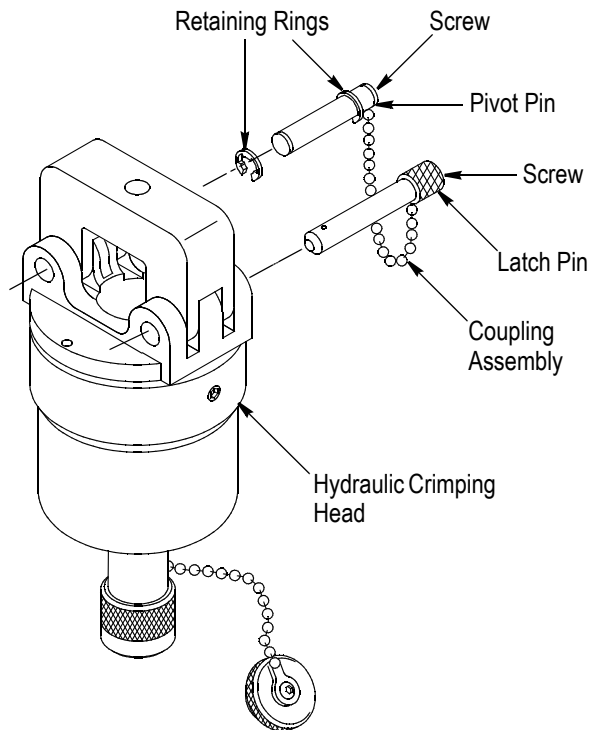

PIN ASSESSORY ASSEMBLY	HYDRAULIC CRIMPING HEAD	
	PART NUMBER	INSTRUCTION SHEET
69709	69051	408-2450
69709-2	69065	408-2452
69709-3	69067	408-2453

Figure 1

## 1. INTRODUCTION

These pin accessory assemblies are designed to be used with the hydraulic crimping heads listed in Figure 1 to eliminate the possibility of misplacing the latch pin. Refer to the instruction sheet for the crimping head for operating procedure and safety information.

Reasons for reissue of this instruction sheet are provided in Section 5, REVISION SUMMARY.

## 2. DESCRIPTION

Each pin accessory assembly consists of a pivot pin with screw and retaining rings, latch pin with screw, and a coupling assembly (chain).

## 3. INSTALLATION

1. Remove the existing retaining rings, pivot pin, and latch pin from the crimping head.
2. Assemble the pivot pin and latch pin onto the crimping head as shown in Figure 1.



**CAUTION** To avoid personal injury or damage to the crimping head, make sure that the crimping head is fully closed and the pins are fully inserted before actuating the crimping head.

## 4. REPLACEMENT PARTS

Refer to Figure 2 for a list of replacements parts for each pin accessory assembly.

DECIPTION	PART NUMBER FOR PIN ACCESSORY ASSEMBLY		
	69709	69709-2	60709-3
Pivot Pin	306771-1	306771-3	306771-4
Latch Pin	306772-1	306772-3	306772-4
Retaining Ring	21048-7	1-21048-3	1-21048-3
Screw	1-21017-4	1-21017-4	1-21017-4
Coupling Assembly (Chain)	306770-2	306770-2	306770-2

Figure 2

## 5. REVISION SUMMARY

Revisions to this instruction sheet include:

- Updated instruction sheet to corporate requirements
- Removed obsolete part numbers