



Chipsmall Limited consists of a professional team with an average of over 10 year of expertise in the distribution of electronic components. Based in Hongkong, we have already established firm and mutual-benefit business relationships with customers from,Europe,America and south Asia,supplying obsolete and hard-to-find components to meet their specific needs.

With the principle of “Quality Parts,Customers Priority,Honest Operation,and Considerate Service”,our business mainly focus on the distribution of electronic components. Line cards we deal with include Microchip,ALPS,ROHM,Xilinx,Pulse,ON,Everlight and Freescale. Main products comprise IC,Modules,Potentiometer,IC Socket,Relay,Connector.Our parts cover such applications as commercial,industrial, and automotives areas.

We are looking forward to setting up business relationship with you and hope to provide you with the best service and solution. Let us make a better world for our industry!



## Contact us

Tel: +86-755-8981 8866 Fax: +86-755-8427 6832

Email & Skype: info@chipsmall.com Web: www.chipsmall.com

Address: A1208, Overseas Decoration Building, #122 Zhenhua RD., Futian, Shenzhen, China





Designers' Choice

# PLUGS & JACKS

## PANEL MOUNT PHONO JACKS

- Mats with 1/8" diameter pin
- Mounts to panel in .296 Dia. Hole
- Color coded for ease of identification
- Complete with nut and soldering lug

**MATERIAL:** Brass, Nickel Plate

### ROUND BASE

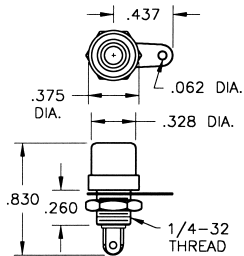

**CAT. NO. 580 (RED INSULATOR)**  
**CAT. NO. 574 (BLACK INSULATOR)**

### HEX BASE

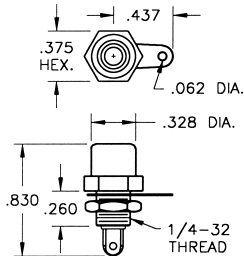

**CAT. NO. 576 (BLACK INSULATOR)**

## RIVET TYPE PHOTO JACKS

- Mates with 1/8" diameter pin
- Rivet type-mounts in .296 Dia. Hole
- Available for 1/16" 3/32" 1/8" thick

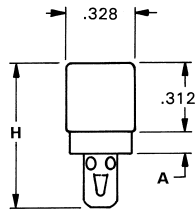

**MATERIAL**  
**Shell:** Steel  
**Contract:** Brass  
**Plating:** Tin

CAT. NO.	A	H	INSULATOR THICKNESS
568	.078	.656	1/16"
569	.109	.812	3/32"
570	.140	.812	1/8"

## BNC TO DUAL BANANA PLUGS

### BNC MALE TO DUAL BANANA PLUGS

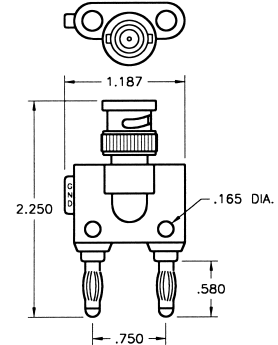

**MATERIAL**  
**Body:** Molded Plastic  
**Connector:** Brass, Nickel Plate  
**Center Contract:** Brass, Gold Plate  
**Banana Plug:** Beryllium Copper, Nickel Plate

**CAT. NO. 7020**

### BNC FEMALE TO DUAL BANANA PLUGS

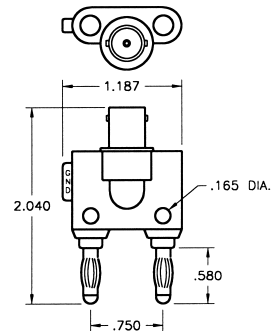
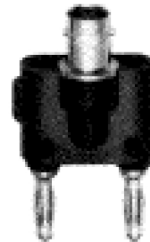

**MATERIAL**  
**Body:** Molded Plastic  
**Connector:** Brass, Nickel Plate  
**Center Contract:** Brass, Gold Plate  
**Banana Plug:** Beryllium Copper, Nickel Plate

**CAT. NO. 7021**

### BNC MALE TO DUAL BINDING POSTS (BLACK & RED)

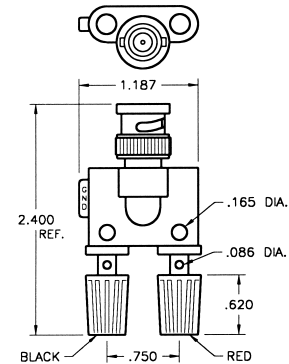

**MATERIAL**  
**Body:** Molded Plastic  
**Connector:** Brass, Nickel Plate  
**Center Contract:** Brass, Gold Plate  
**Banana Plug:** Brass, Nickel Plate

**CAT. NO. 7022**

## PHONO PLUGS

Mates with 1/8" diameter jacks

**MATERIAL:** Shell: Steel, Tin Plate Pins: Brass, Nickel Plate

### Longer Skirt for Better Grip

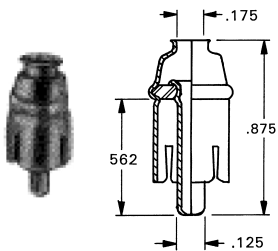

**CAT. NO. 566**

### Strain Relief Lug Crimps to Wire Insulation

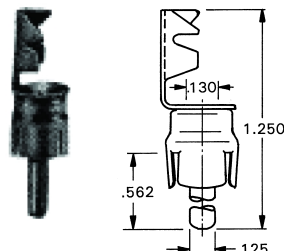

**CAT. NO. 565**

### Conventional Type

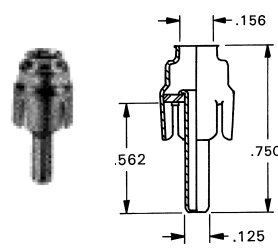

**CAT. NO. 561**

### Crimp or Solder Type Extra Long Handle

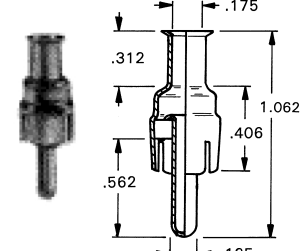

**CAT. NO. 567**