



Chipsmall Limited consists of a professional team with an average of over 10 year of expertise in the distribution of electronic components. Based in Hongkong, we have already established firm and mutual-benefit business relationships with customers from,Europe,America and south Asia,supplying obsolete and hard-to-find components to meet their specific needs.

With the principle of “Quality Parts,Customers Priority,Honest Operation,and Considerate Service”,our business mainly focus on the distribution of electronic components. Line cards we deal with include Microchip,ALPS,ROHM,Xilinx,Pulse,ON,Everlight and Freescale. Main products comprise IC,Modules,Potentiometer,IC Socket,Relay,Connector.Our parts cover such applications as commercial,industrial, and automotives areas.

We are looking forward to setting up business relationship with you and hope to provide you with the best service and solution. Let us make a better world for our industry!



Contact us

Tel: +86-755-8981 8866 Fax: +86-755-8427 6832

Email & Skype: info@chipsmall.com Web: www.chipsmall.com

Address: A1208, Overseas Decoration Building, #122 Zhenhua RD., Futian, Shenzhen, China



PRODUCT NUMBER
70419-001
70419-001LF

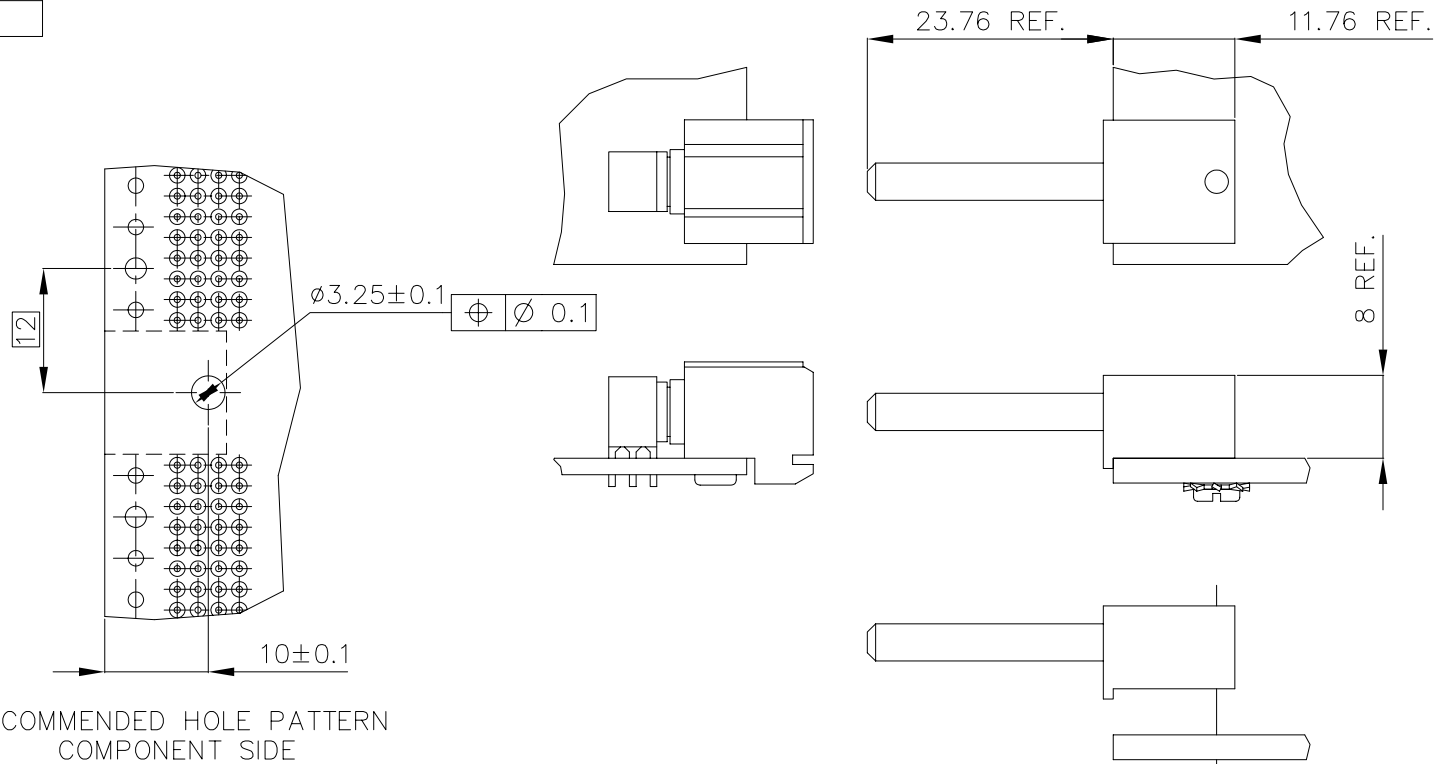

RECOMMENDED HOLE PATTERN
COMPONENT SIDE

NOTES:

1. RECEPTACLE HOUSING/CONTACT SHOWN FOR CLARITY ONLY AND DOES NOT COME WITH ASSEMBLY
2. 70419-001 MUST BE USED WITH THE METRAL(tm) PASS-THRU-GROUND RECEPTACLE, P.N. 91877-003
3. R/A GUIDE BLOCK/PIN MATERIAL: BRASS
PLATING: SnPb
LEAD FREE PLATING: Sn
4. USE #10 TORX® DRIVE TOOL
5. PART NUMBERS WIT "LF" SUFFIX AT THE END ARE LEAD FREE OPTION.
6. IF "LF" P/N THE PRODUCT MEETS EUROPEAN UNION DIRECTIVES AND OTHER COUNTRY REGULATION AS DESCRIBED IN GS-22-008.

#4-40 UNC TORX® STAINLESS
STEEL PANHEAD SCREW
SEE NOTE 4

mat'l. code		surface		tolerance		projection		product family	
SEE NOTES		ISO 1302 ✓		ISO 406 ISO 1101		mm		METRAL ACC	
ltr	ecn no	dr	date	tolerances unless otherwise specified		mm		title	
A	v60188	SCS	2/02/96	angles	linear	xx ±.01/.3		R/A GUIDE/GROUND PIN ASSEMBLY	
B	v60425	SCS	2/13/96	σ±z'		xxx ±.005/.13			
C	v12643	EPK	11/12/01			xxxx ±.0020/.050		scale 1:1	
D	M06-0055	MHT	2/01/06	dr	STU STONER	1/25/96		dwg no	
E	M06-0286	MNR	7/27/06	enr	R. DOUTRICH	1/25/96		sheet 1 of 1 size	
				chr	STU STONER	1/25/96		70419 A3	
				appd	STU STONER	1/25/96		type Product Customer Drawing	
sheet index	revision sheet	E	1						

FCJ
FCJconnect.com

Copyright FCJ