



Chipsmall Limited consists of a professional team with an average of over 10 year of expertise in the distribution of electronic components. Based in Hongkong, we have already established firm and mutual-benefit business relationships with customers from,Europe,America and south Asia,supplying obsolete and hard-to-find components to meet their specific needs.

With the principle of “Quality Parts,Customers Priority,Honest Operation,and Considerate Service”,our business mainly focus on the distribution of electronic components. Line cards we deal with include Microchip,ALPS,ROHM,Xilinx,Pulse,ON,Everlight and Freescale. Main products comprise IC,Modules,Potentiometer,IC Socket,Relay,Connector.Our parts cover such applications as commercial,industrial, and automotives areas.

We are looking forward to setting up business relationship with you and hope to provide you with the best service and solution. Let us make a better world for our industry!



## Contact us

Tel: +86-755-8981 8866 Fax: +86-755-8427 6832

Email & Skype: info@chipsmall.com Web: www.chipsmall.com

Address: A1208, Overseas Decoration Building, #122 Zhenhua RD., Futian, Shenzhen, China



# INSTRUMENTATION HANDLES

Designers' Choice



## ROUND INSTRUMENTATION HANDLES

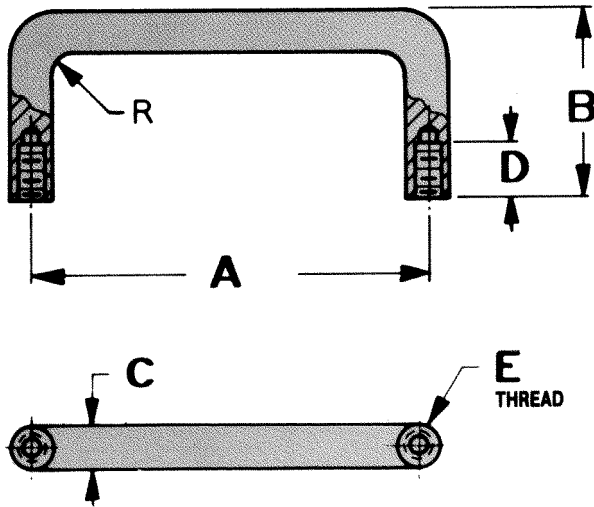

BRASS CAT. NO.	ALUMINUM CAT. NO.	A Mtg. Ctrs.	B Height	E Thread	D Depth	R Radius	C Diameter
7140	7170	1.250	1.000	4-40	.375	.156	<b>.156</b>
7141	7171	2.000	1.000	4-40	.375	.156	
7142	7172	3.000	1.000	4-40	.375	.156	
9100	9110	1.250	.625	4-40	.156	.187	<b>.187</b>
9101	9111	1.500	.625	4-40	.156	.187	
9104	9114	1.500	.750	4-40	.156	.187	
9102	9112	1.750	.625	4-40	.156	.187	
9105	9115	1.750	.750	4-40	.156	.187	
9103	9113	2.000	.625	4-40	.156	.187	
9106	9116	1.250	1.000	6-32	.250	.187	
9107	9117	1.500	1.000	6-32	.250	.187	
9108	9118	2.000	1.000	6-32	.250	.187	
9109	9119	3.000	1.000	6-32	.250	.187	
7143	7173	3.000	1.500	8-32	.562	.250	<b>.250</b>
485	515	3.000	1.750	8-32	.562	.250	
480	510	3.500	1.500	8-32	.562	.250	
7144	7174	4.000	1.500	8-32	.562	.250	
486	516	4.000	1.750	8-32	.562	.250	
481	511	4.500	1.500	8-32	.562	.250	
487	517	4.500	1.750	8-32	.562	.250	
482	512	5.000	1.500	8-32	.562	.250	
488	518	5.000	1.750	8-32	.562	.250	
483	513	5.500	1.500	8-32	.562	.250	
484	514	6.000	1.500	8-32	.562	.250	
489	519	6.000	1.750	8-32	.562	.250	
7145	7175	3.000	1.500	10-32	.562	.312	<b>.312</b>
7146	7176	4.000	1.500	10-32	.562	.312	
493	523	4.000	1.750	10-32	.562	.312	
490	520	4.500	1.500	10-32	.562	.312	
494	524	4.500	1.750	10-32	.562	.312	
7147	7177	4.562	1.500	10-32	.562	.312	
491	521	5.000	1.500	10-32	.562	.312	
495	525	5.000	1.750	10-32	.562	.312	
492	522	5.500	1.500	10-32	.562	.312	
7148	7178	6.000	1.500	10-32	.562	.312	
496	526	6.000	1.750	10-32	.562	.312	
7149	7179	6.437	1.750	10-32	.562	.312	
7150	7180	4.000	1.375	10-32	.375	.375	<b>.375</b>
7151	7181	6.000	1.375	10-32	.375	.375	

### FERRULES FOR ROUND HANDLES

- To protect and support panel surface



BRASS CAT. NO.	ALUMINUM CAT. NO.	FOR DIA./THREAD	A	B	C	D	E	F
7162	7192	.156/4-40	.250	.120	.047	.125	.200	.161
9120	9122	.187/4-40	.312	.120	.062	.125	.265	.203
9121	9123	.187/6-32	.312	.144	.062	.125	.265	.203
7163	7193	.250/8-32	.375	.170	.062	.187	.320	.260
7164	7194	.312/10-32	.562	.196	.062	.250	.406	.320

## OVAL INSTRUMENTATION HANDLES (.625 x .281)

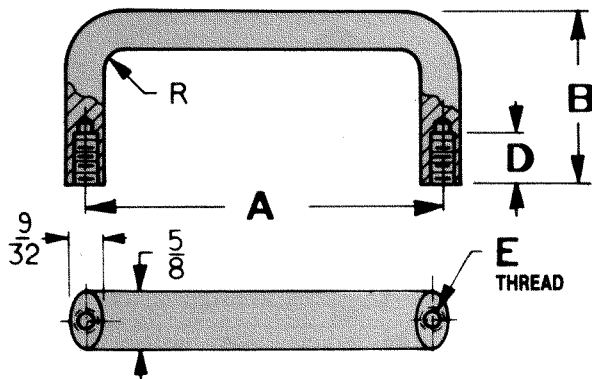

BRASS CAT. NO.	ALUMINUM CAT. NO.	A Mtg. Ctrs.	B Height	E Thread	D Depth	R Radius
7156	7186	4.000	1.750	10-32	.500	.500
534	544	4.000	2.000	10-32	.500	.500
530	540	4.500	1.750	10-32	.500	.500
535	545	4.500	2.000	10-32	.500	.500
531	541	5.000	1.750	10-32	.500	.500
536	546	5.000	2.000	10-32	.500	.500
532	542	5.500	1.750	10-32	.500	.500
537	547	5.500	2.000	10-32	.500	.500
7157	7187	6.000	1.375	10-32	.375	.500
533	543	6.000	1.750	10-32	.500	.500
538	548	6.000	2.000	10-32	.500	.500
7158	7188	6.437	1.750	10-32	.500	.500