



Chipsmall Limited consists of a professional team with an average of over 10 year of expertise in the distribution of electronic components. Based in Hongkong, we have already established firm and mutual-benefit business relationships with customers from,Europe,America and south Asia,supplying obsolete and hard-to-find components to meet their specific needs.

With the principle of “Quality Parts,Customers Priority,Honest Operation,and Considerate Service”,our business mainly focus on the distribution of electronic components. Line cards we deal with include Microchip,ALPS,ROHM,Xilinx,Pulse,ON,Everlight and Freescale. Main products comprise IC,Modules,Potentiometer,IC Socket,Relay,Connector.Our parts cover such applications as commercial,industrial, and automotives areas.

We are looking forward to setting up business relationship with you and hope to provide you with the best service and solution. Let us make a better world for our industry!



Contact us

Tel: +86-755-8981 8866 Fax: +86-755-8427 6832

Email & Skype: info@chipsmall.com Web: www.chipsmall.com

Address: A1208, Overseas Decoration Building, #122 Zhenhua RD., Futian, Shenzhen, China



PRODUCT NUMBER

71600-YXXXLF

- LEAD FREE, SEE NOTE 6
- COLOR OPTION, SEE NOTE 1
- TOTAL NB OF POSITION 04 TO 64 SEE SHEET 2
- OPTIONAL STRAIN RELIEF SEE SHEET 2

TRIANGLE INDICATES POSITION 1
NOTE 5

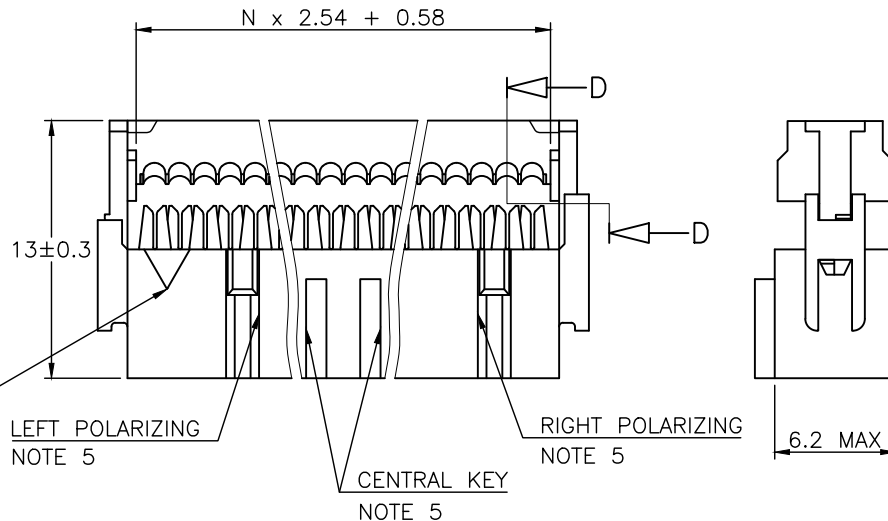

NOTES:

- 1 - HOUSING MATERIAL : GLASS FILLED THERMOPLASTIC. UL94V-0 COLOR: GREY
 = STANDARD COLOR GREY
 B = OPTION COLOR BLACK
- 2 - PIN MATERIAL : PHOSPHOR BRONZE
- 3 - PRODUCT PACKAGED IN TUBES.
- 4 - TO DETERMINE DIMENSIONS :
 N = NUMBER OF POSITIONS PER ROW
 EXAMPLE : 8 POS $N \times 2.54 = 20.32\text{mm}$
- 5 - 2x5, 2x6, 2x7 HAVE NO LEFT POLARIZING SLOT.
 - 2x2, 2x3 WITH CENTRAL KEY HAVE NO TRIANGLE, NO LEFT AND RIGHT POLARIZING SLOT.
 - 2x2 WITHOUT CENTRAL KEY HAS NO LEFT AND RIGHT POLARIZING SLOT.
 - 2x3, 2x4 WITHOUT CENTRAL KEY HAVE NO LEFT POLARIZING SLOT
 - 2x4 WITH CENTRAL KEY HAVE NO LEFT AND RIGHT POLARIZING SLOT
- 6 - THIS PRODUCT MEETS EUROPEAN UNION DIRECTIVES AND OTHER COUNTRY REGULATIONS AS PER GS-22-008. PACKAGING SPECIFICATION AS PER GS-14-920.

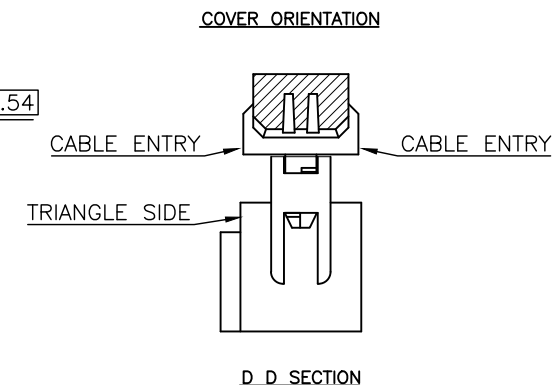
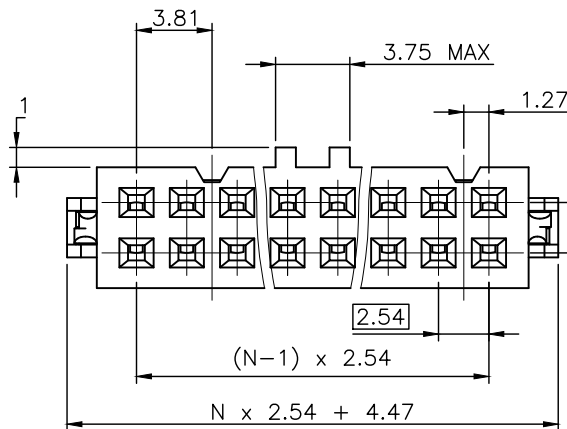

mat'l. code SEE NOTES		surface ISO 1302 ✓ ISO 406 ISO 1101		tolerance ISO 406 ISO 1101		projection mm		product family 2.54MM IDC	
lfr ecn no dr date		tolerances unless otherwise specified		angles		linear		title QUICKIE III FEM 0.76µm Au	
AP F12-0046 LMU 12.04.25		X.X ±0.3		X.XX ±0.13		X.XXX ±0.05		scale 5:1	
AR B-17851 LMU 14.06.05		D.LE 01.01.24		P.NZ 01.01.24		P.NZ 01.01.24		dwg no 71600	
AS F-26816 LMU 17.06.06		enr 01.01.24		chr 01.01.24		appd 01.01.24		sheet 1 of 2 size A3	
AL F06-0270 LMU 06.09.12		P.NZ 01.01.24		P.NZ 01.01.24		P.NZ 01.01.24		type CUSTOMER Drawing	
AM F06-0274 LMU 06.09.25		P.NZ 01.01.24		P.NZ 01.01.24		P.NZ 01.01.24			
AN F09-0233 LMU 09.12.15		P.NZ 01.01.24		P.NZ 01.01.24		P.NZ 01.01.24			
sheet index		revision AS AG							
1 2									

STRAIN RELIEF OPTION AVAILABILITY	Nbr OF POSITIONS
1/6	04
0/1/2/3/6	06
0/1/2/3/6	08
0/1/2/3/6	10
0/1/2/3/6	14
0/1/2/3/6	16
0/1/2/3/6	18
0/1/2/3/6	20
0/1/3	24
0/1/2/3/6	26
0/1/2/3/6	30
0/1/2/3/6	34
0/1/2/3/6	40
0/1/2/3/6	50
0/1/2/3/6	60
0/1/2/3/6	64

624
304
204 / 224
004

DASHES NOT AVAILABLE

PLATING
 0.76µm GOLD ON CONTACT AREA
 1.27 µm Ni REMAINDER OF PRODUCT

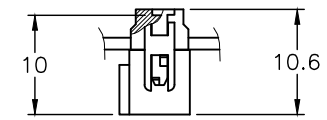

WITHOUT STRAIN RELIEF

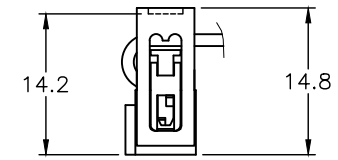

WITH LOW PROFILE STRAIN RELIEF

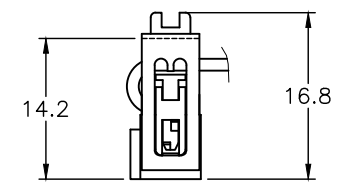

WITH STANDARD STRAIN RELIEF

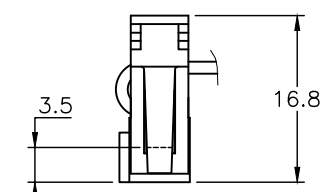

WITH LATCHING STRAIN RELIEF

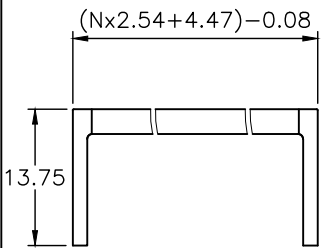

LOW PROFILE STRAIN RELIEF

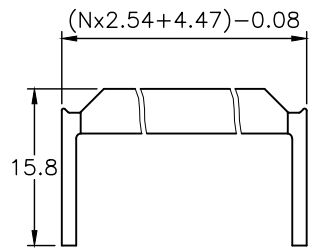

STANDARD STRAIN RELIEF

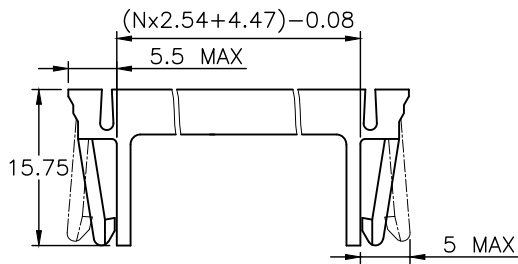

LATCHING STRAIN RELIEF FOR SLIM HEADER

71600-6YY(B)LF	●					●
71600-3YY(B)LF		●	●			
71600-2YY(B)LF	●			●		
71600-1YY(B)LF	●			●		
71600-0YY(B)LF	●		●			
PRODUCT NUMBER	WITH CENTRAL KEY	WITHOUT CENTRAL KEY	STANDARD STRAIN RELIEF	WITHOUT STRAIN RELIEF	LOW PROFILE STRAIN RELIEF	LATCHING STRAIN RELIEF

mat'l. code		surface		tolerance		projection		product family	
		ISO 1302 ✓		ISO 406 ISO 1101				QUICKIE	
ltr ecn no dr date		tolerances unless otherwise specified		angles linear		mm		title	
AF B-17851 LMU 14.06.05						← mm →		IDC RECEPT DR	
AG F-26816 LMU 17.06.06						scale N/A		sheet 2 of - size	
AB F03019 DLE 03.01.23		dr		D.LE		01.01.24		71600 A3	
AC F05-0180 LMU 05.04.22		enr		P.NZ		01.01.24		CUSTOMER Drawing	
AD F06-0270 LMU 06.09.12		chr		JF.N		01.01.24			
AE F06-0274 LMU 06.09.25		appd		P.NZ		01.01.24			
sheet index		revision sheet							



Copyright FCI