



Chipsmall Limited consists of a professional team with an average of over 10 year of expertise in the distribution of electronic components. Based in Hongkong, we have already established firm and mutual-benefit business relationships with customers from,Europe,America and south Asia,supplying obsolete and hard-to-find components to meet their specific needs.

With the principle of “Quality Parts,Customers Priority,Honest Operation,and Considerate Service”,our business mainly focus on the distribution of electronic components. Line cards we deal with include Microchip,ALPS,ROHM,Xilinx,Pulse,ON,Everlight and Freescale. Main products comprise IC,Modules,Potentiometer,IC Socket,Relay,Connector.Our parts cover such applications as commercial,industrial, and automotives areas.

We are looking forward to setting up business relationship with you and hope to provide you with the best service and solution. Let us make a better world for our industry!



Contact us

Tel: +86-755-8981 8866 Fax: +86-755-8427 6832

Email & Skype: info@chipsmall.com Web: www.chipsmall.com

Address: A1208, Overseas Decoration Building, #122 Zhenhua RD., Futian, Shenzhen, China



4

3

2

1

THIS DRAWING IS UNPUBLISHED.
 VERTRAULICHE UNVERÖFFENTLICHTE ZEICHNUNG
 © COPYRIGHT 19- BY AMP INCORPORATED. ALL RIGHTS RESERVED.
 FREI FÜR VERÖFFENTLICHUNG
 ,19-
 ALLE RECHTE VORBEHALTEN

MATED WITH:
 PASSEND ZU:
 DIN 46247

LOC	DIST	REVISIONS ÄNDERUNGEN					
		P	LTR	DESCRIPTION BESCHREIBUNG	DATE	DWN	APVD
AI	-		A	DIM. 3.8 WAS 4.3, 6.2 WAS 6.3, 5 ADDED	28JAN86	STOLZ	-
			B	NEW CAD-DRAWING	29JUN97	STOLZ	FELDMETER
			B1	"CENTER PUNCH MARK ADMISSIBLE" WAS "CENTER PUNCH MARK"	17AUG98	STOLZ	FELDMETER

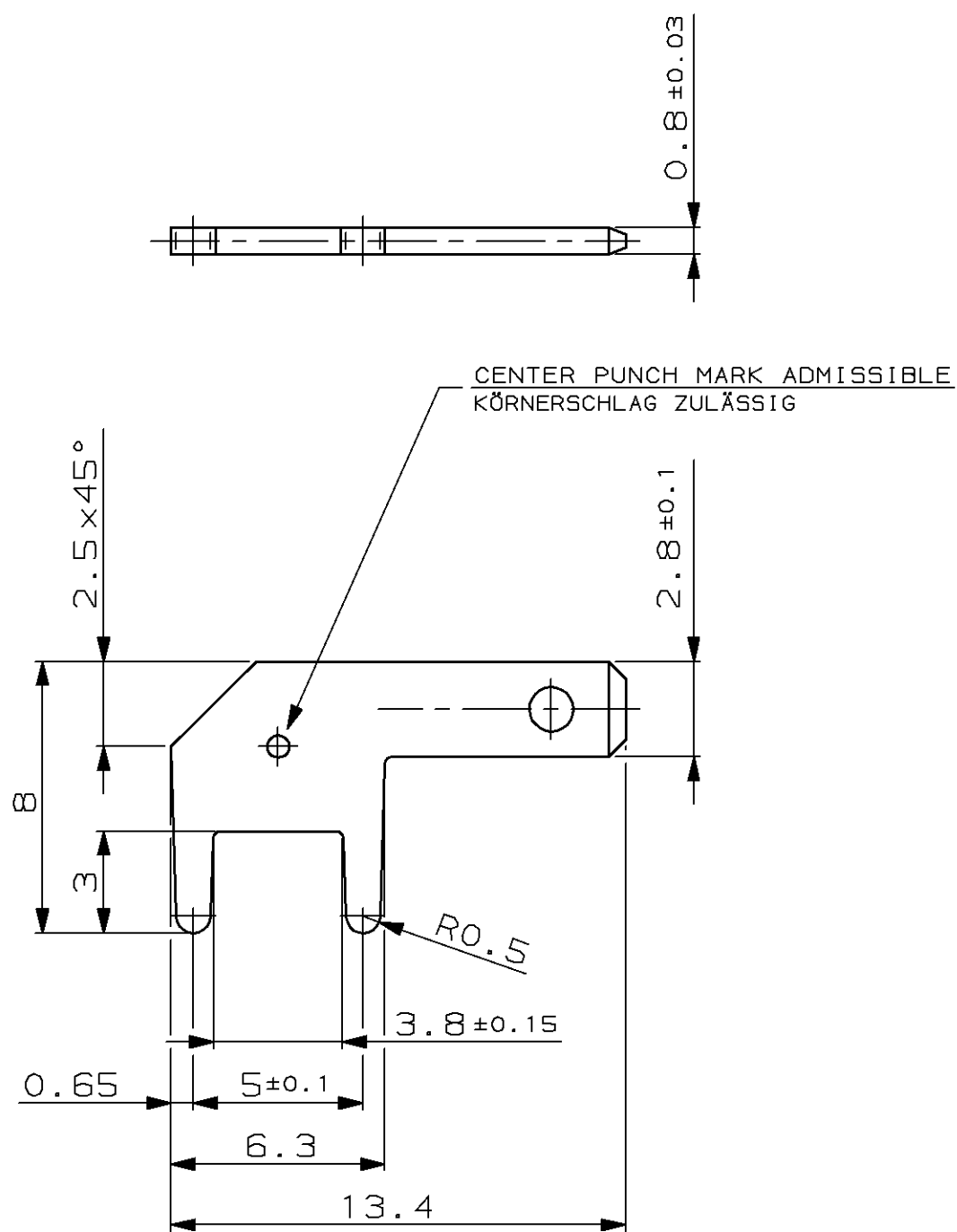

- ① MIN. 4.5 µm Sn OVER MIN. 1.5 µm Cu
 - ② PACKING: MAX. 3000 PIECES
PACKED INTO CARDBOARD BOX
 - ③ RECOMMENDED DIA. FOR PCB: $\phi 1.4 -0.1$
-
- ① MIN. 4.5 µm Sn ÜBER MIN. 1.5 µm Cu
 - ② VERPACKUNG: MAX. 3000 TEILE
IN KARTON VERPACKT
 - ③ EMPFOHLENE LEITERPLATTENBOHRUNG: $\phi 1.4 -0.1$

725963-2	①	CuZn
-	-	-
AMP ORDER NO. BESTELL-NR.	SURFACE OBERFLAECHE COLOUR/FARBE	MATERIAL

THIS DRAWING IS A CONTROLLED DOCUMENT FOR AMP INCORPORATED. IT IS SUBJECT TO CHANGE AND THE CONTROLLING ENGINEERING ORGANIZATION SHOULD BE CONTACTED FOR THE LATEST REVISION. DIESES ZEICHNUNGSDOKUMENT WIRD DURCH AMP INCORPORATED KONTROLLIERT. ÄNDERUNGEN, DIE DEN TECHNISCHEN FORTSCHRITT DIENEN, SIND VORBEHALTEN. DEN JEMEILS LETZTGÜLTIGEN ÄNDERUNGSSTAND ERFAHREN SIE AUF ANFRAGE.		DWN 18-MAR-75 NICOLAUS	AMP Deutschland GmbH D - 63225 Langen	
DIMENSIONS, DIMENSIONEN: mm		CHK 18-MAR-75 NICOLAUS	AMP	
TOLERANCES UNLESS OTHERWISE SPECIFIED: ALLGEMEINTOLERANZEN n. Tolerierung ISO 8015		APVD -	FASTON TAB 2.8 x 0.8 FLACHSTECKER 2.8 x 0.8	
±0.2		PRODUCT SPEC PRODUKTSPEZ. ACCORDING TO DIN 46244	SIZE A3	CAGE CODE 00779
ANGLES /WINKEL ± FINISH /OBERFLAECHE/FARBE		APPLICATION SPEC VERARBEITUNGSSPEZ. -	DRAWING NO ZEICHNUNGS-NR. C-725963	RESTRICTED TO NUR FÜR -
MATERIAL SEE TABLE SIEHE TABELLE		WEIGHT GEWICHT -	SCALE MAßSTAB 5:1	SHEET BLATT 1 OF 1
SEE TABLE SIEHE TABELLE		CUSTOMER DRAWING /KUNDENZEICHNUNG		REV B1