



Chipsmall Limited consists of a professional team with an average of over 10 year of expertise in the distribution of electronic components. Based in Hongkong, we have already established firm and mutual-benefit business relationships with customers from,Europe,America and south Asia,supplying obsolete and hard-to-find components to meet their specific needs.

With the principle of "Quality Parts,Customers Priority,Honest Operation,and Considerate Service",our business mainly focus on the distribution of electronic components. Line cards we deal with include Microchip,ALPS,ROHM,Xilinx,Pulse,ON,Everlight and Freescale. Main products comprise IC,Modules,Potentiometer,IC Socket,Relay,Connector.Our parts cover such applications as commercial,industrial, and automotives areas.

We are looking forward to setting up business relationship with you and hope to provide you with the best service and solution. Let us make a better world for our industry!



Contact us

Tel: +86-755-8981 8866 Fax: +86-755-8427 6832

Email & Skype: info@chipsmall.com Web: www.chipsmall.com

Address: A1208, Overseas Decoration Building, #122 Zhenhua RD., Futian, Shenzhen, China



MATERIALS AND FINISHES

BODY: BRASS
PLATED NICKEL

CENTER CONTACT: PHOSPHOR BRONZE
PLATED GOLD

INSULATOR: TEFLON

PRESS RING: BRASS
PLATED NICKEL

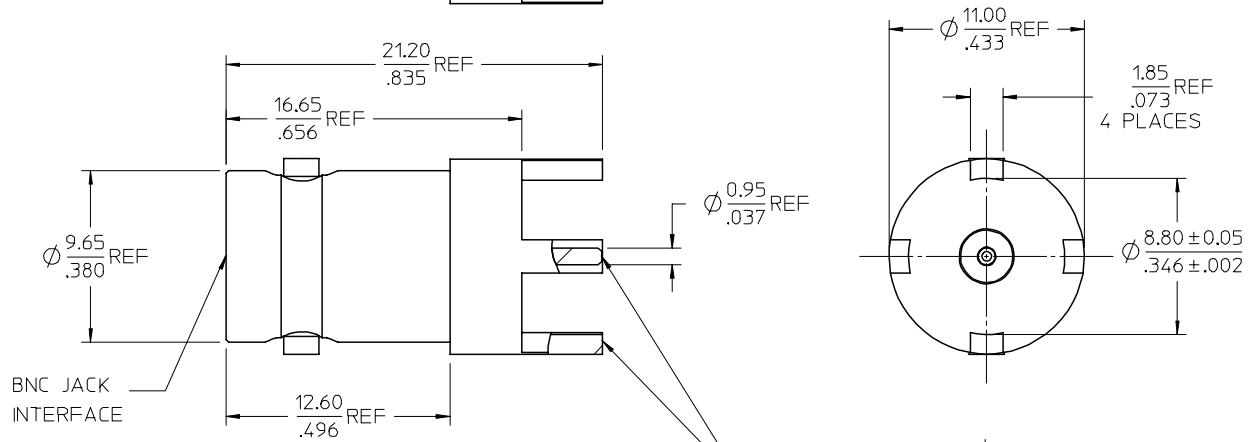
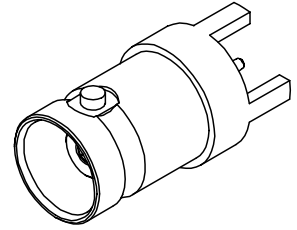
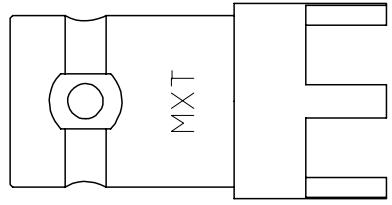

THE TIP OF THE CENTER CONTACT IS REFERENCED FLUSH TO THE LEGS

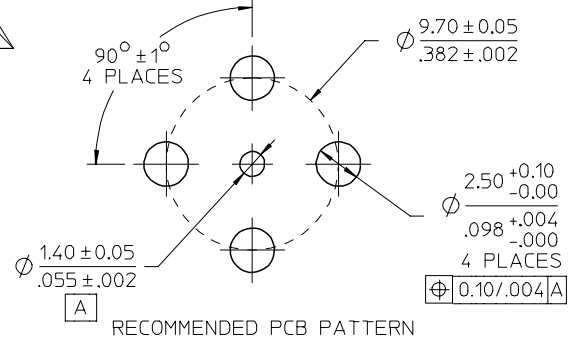

PS-73598-0061	ELECTRO/MECH PERFORM
SPECIFICATION	DESCRIPTION

73171-3050	73100-0153, ONE PER BAG
73100-0153	BULK PACK WITH PLASTIC BAG
PART NO.	PACKAGING

CHG: UPDATED TO SHOW USE OF PRESS RING.
 EC NO: URF2007-0403
 DRAWN: ARROBERTSON 2007/04/09
 CHKD: 2007/04/09
 APPR: JIM ENEER 2007/04/09
 REVISION DESCRIPTION

QUALITY SYMBOLS	GENERAL TOLERANCES (UNLESS SPECIFIED)	DIMENSION STYLE	SCALE	DESIGN UNITS	THIRD ANGLE PROJECTION
▽=0 ▽=0	mm INCH	MM/IN	METRIC	METRIC	
	4 PLACES ± --- ± ---	DRAWN BY DATE	BNC JACK, VERTICAL PCB		
	3 PLACES ± --- ± ---	FIELDS 1994/08/29	50 OHMS		
	2 PLACES ± --- ± ---	CHECKED BY DATE	BNC-J/PCB		
	1 PLACE ± --- ± ---	APPROVED BY DATE	MOLEX INCORPORATED		
	ANGULAR ± 2 °	MATERIAL NO.	DOCUMENT NO.	SHEET NO.	
	DRAFT WHERE APPLICABLE MUST REMAIN WITHIN DIMENSIONS	SEE TABLE	SD-73100-0153	1 OF 1	
		SIZE C	THIS DRAWING CONTAINS INFORMATION THAT IS PROPRIETARY TO MOLEX INCORPORATED AND SHOULD NOT BE USED WITHOUT WRITTEN PERMISSION		