

Chipsmall Limited consists of a professional team with an average of over 10 year of expertise in the distribution of electronic components. Based in Hongkong, we have already established firm and mutual-benefit business relationships with customers from,Europe,America and south Asia,supplying obsolete and hard-to-find components to meet their specific needs.

With the principle of “Quality Parts,Customers Priority,Honest Operation,and Considerate Service”,our business mainly focus on the distribution of electronic components. Line cards we deal with include Microchip,ALPS,ROHM,Xilinx,Pulse,ON,Everlight and Freescale. Main products comprise IC,Modules,Potentiometer,IC Socket,Relay,Connector.Our parts cover such applications as commercial,industrial, and automotives areas.

We are looking forward to setting up business relationship with you and hope to provide you with the best service and solution. Let us make a better world for our industry!



Contact us

Tel: +86-755-8981 8866 Fax: +86-755-8427 6832

Email & Skype: info@chipsmall.com Web: www.chipsmall.com

Address: A1208, Overseas Decoration Building, #122 Zhenhua RD., Futian, Shenzhen, China

		0,2	0,35	0,5	1,0	
		0,5	0,75	1,0	1,5	

DO NOT SCALE
DIMENSIONS IN mm

METRIC

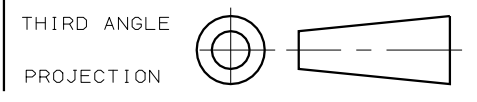

NOTE: INCL. LOCATOR PN.734290-1

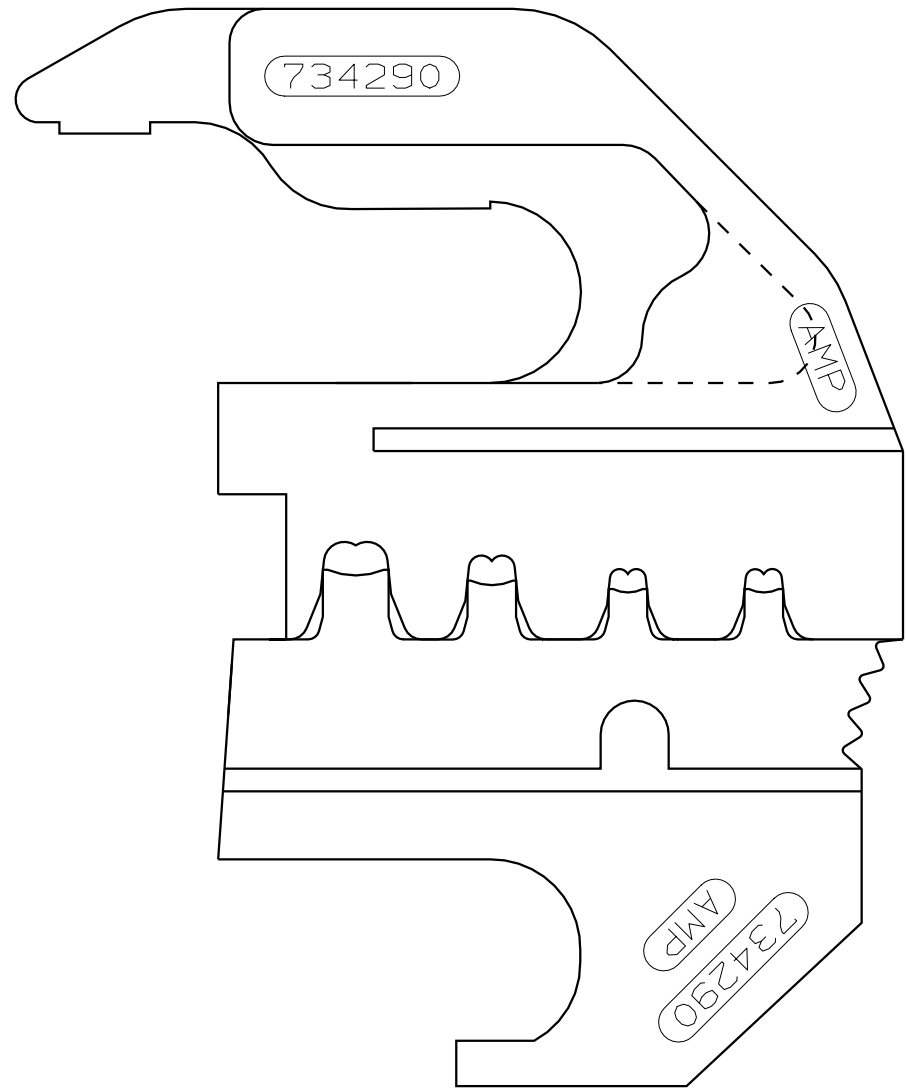
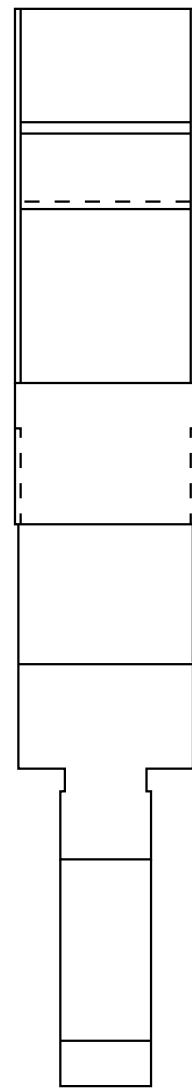
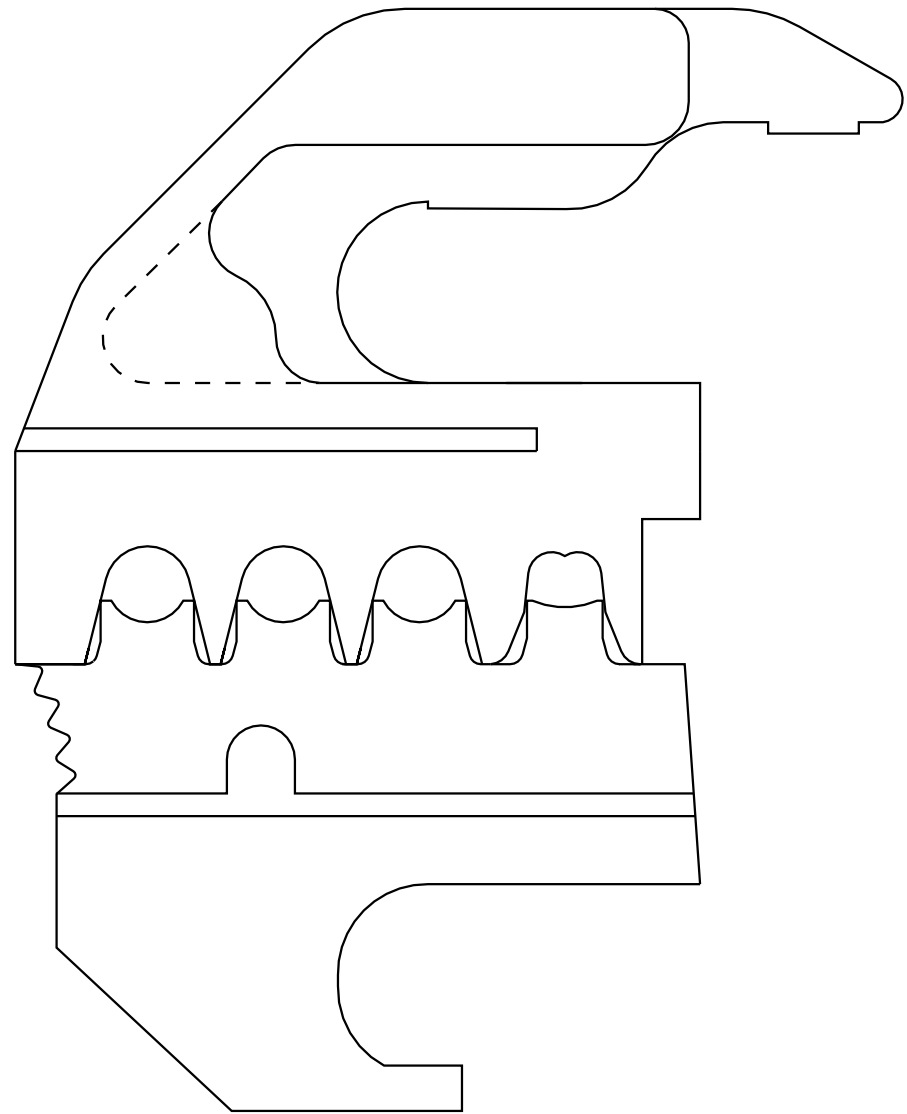

DIE SET	CONT PN	WIRE RANGE	INSUL RANGE
734290-0	929951	0,2-0,5	ø1,6 MAX
	929927	0,35-0,75	ø1,9 MAX
	929953	0,5-1,0	ø2,0 MAX
	929955	1,0-1,5	ø2,3 MAX

	BLACK FINISH	STEEL MATERIAL	734290-0 PARTNUMBER
CUSTOMER DRAWING FOR REFERENCE ONLY WILL NOT BE UPDATED	AMP		AMP-HOLLAND B.V. 's-Hertogenbosch, The Netherlands.
	THIS DRAWING IS UNPUBLISHED RELEASED FOR PUBLICATION 1989		
© COPYRIGHT 1989 BY AMP-HOLLAND B.V. ALL INTERNATIONAL RIGHTS RESERVED. AMP PRODUCTS MAY BE COVERED BY U.S. AND FOREIGN PATENTS AND/OR PATENTS PENDING.			
DR. P. BEIJNON	DATE 11-05-89	WIRE RANGE -	NAME DIE SET FOR MICRO TIMER
CHK. R. VOS	DATE -	INSUL. RANGE -	REV. DATE 11 05 89
APP. L.V. SOEST	DATE -	SIZE A3	SHEET 1 OF 1
		DWG. No. 734290	REV. LTR. 0

8 7 6 5 4 3 2 1

F
E
D
C
B
A