



Chipsmall Limited consists of a professional team with an average of over 10 year of expertise in the distribution of electronic components. Based in Hongkong, we have already established firm and mutual-benefit business relationships with customers from,Europe,America and south Asia,supplying obsolete and hard-to-find components to meet their specific needs.

With the principle of "Quality Parts,Customers Priority,Honest Operation,and Considerate Service",our business mainly focus on the distribution of electronic components. Line cards we deal with include Microchip,ALPS,ROHM,Xilinx,Pulse,ON,Everlight and Freescale. Main products comprise IC,Modules,Potentiometer,IC Socket,Relay,Connector.Our parts cover such applications as commercial,industrial, and automotives areas.

We are looking forward to setting up business relationship with you and hope to provide you with the best service and solution. Let us make a better world for our industry!



## Contact us

Tel: +86-755-8981 8866 Fax: +86-755-8427 6832

Email & Skype: info@chipsmall.com Web: www.chipsmall.com

Address: A1208, Overseas Decoration Building, #122 Zhenhua RD., Futian, Shenzhen, China



PART NUMBER	LF VERSION
7361E0515S08	7361E0515S08LF

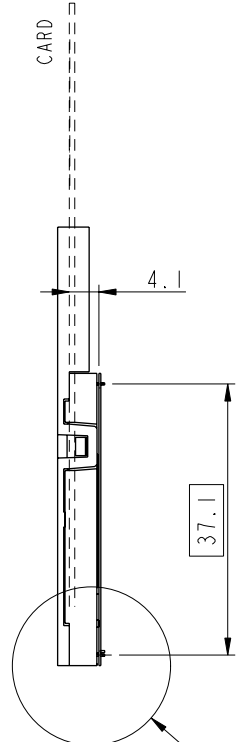
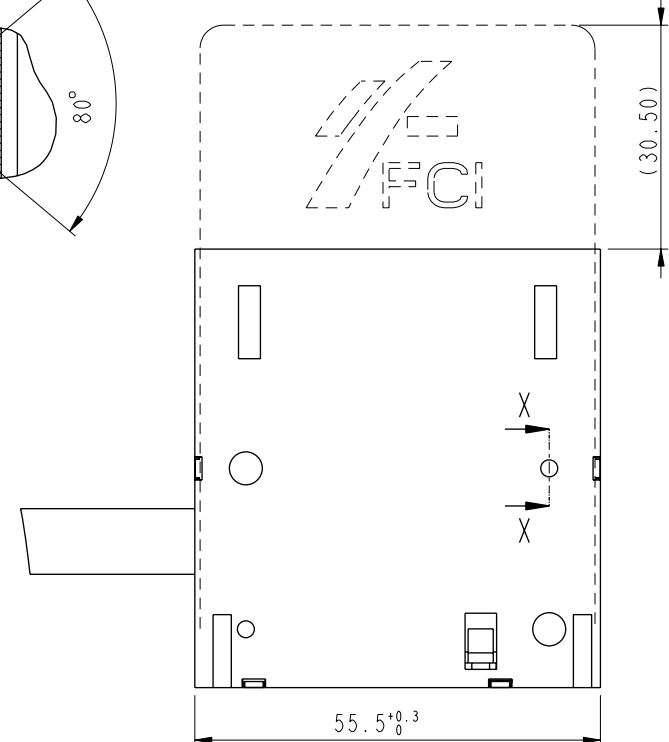
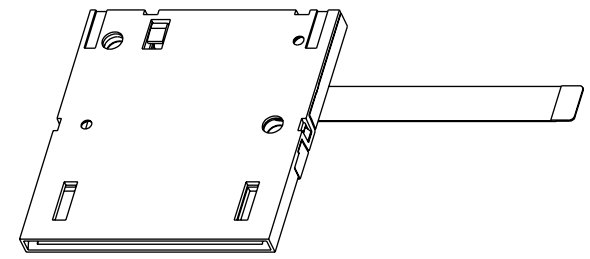
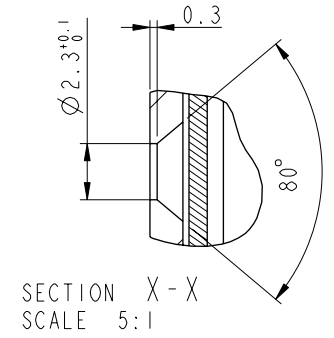

**GENERAL :**  
 High cycle life duration smart card connector with landing type contacts mechanism. The landing type connector also provides the feature of recessed contacts when card is not inserted which protects them against vandalism.  
 Smart card for reference purposes only.

**ELECTRICAL PROPERTIES:**  
 Insulation resistance : > 1000MΩ  
 Dielectric withstanding voltage : >750 Vrms  
 Current carrying capacity : Min 10μA, Max 1A  
 Contact resistance : < 100mΩ

**MECHANICAL PROPERTIES :**  
 Operating force : Insertion : F < 10N  
 Withdrawal : 1 < F < 10N  
 Contact Normal force : 0.2 < F < 0.3 for 0.6mm of deflection  
 Durability : 200 000 mating cycles

**MATERIAL :**  
 Head reader : PA4/6, Colour Black, Rated UL94V0  
 Cover : PEI, Colour Black, Rated UL94V0  
 Contacts : Copper alloy,  
 Plating : 2.5μm Nickel min. all over  
 2μm Gold min. on contact area  
 3μm SnPb(60/40) min. on solder tails (for leaded version)  
 3μm matte tin min. on solder tails (for leaded version)

**ENVIRONMENT :**  
 Operating temperature : -40°C / +90°C  
 Climatic conditions : UTE 93-421

**PACKAGING :**  
 Plastic cavity tray

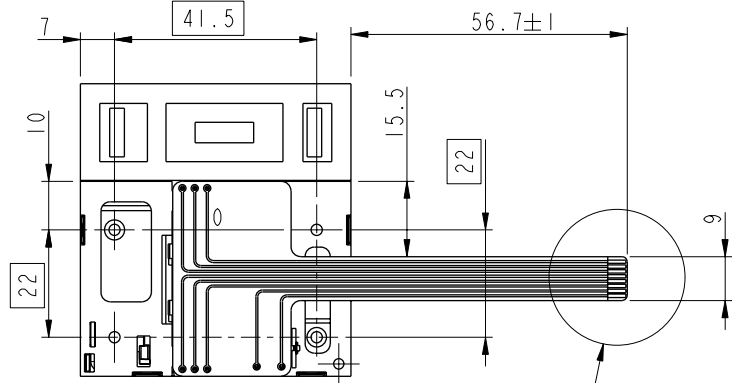

SEE DETAIL AA

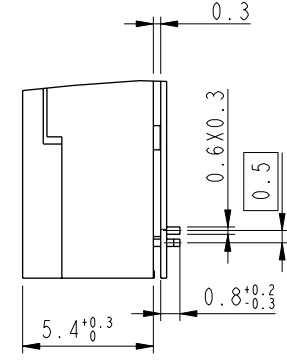
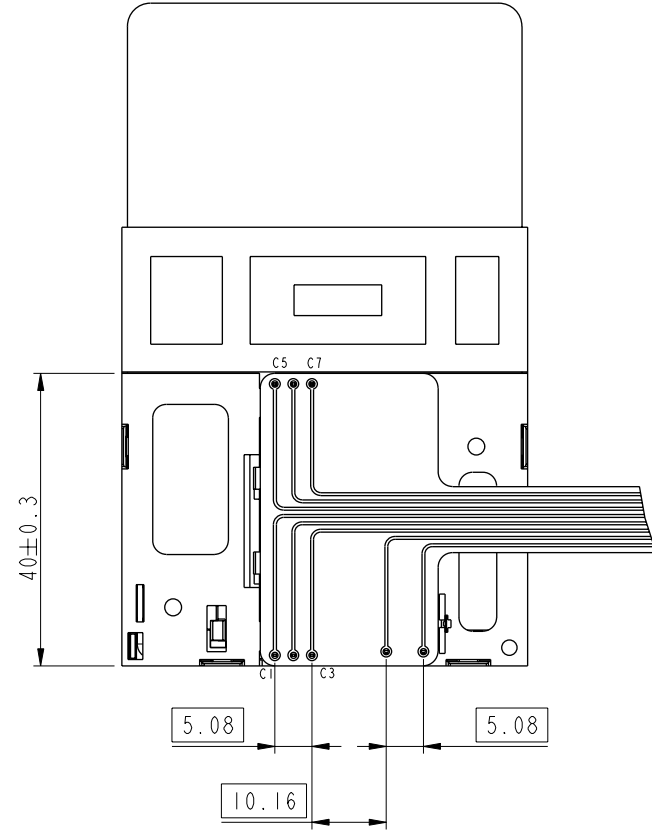

DETAIL B  
SCALE 5:1

DETAIL AA  
SCALE 5:1

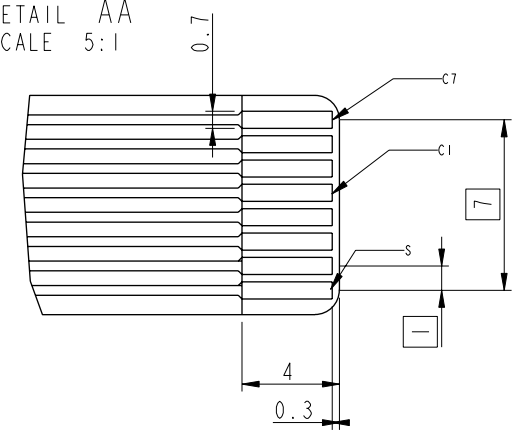

LEAD FREE VERSION:  
 "This product meets European Union Directives and other country regulations as described in GS-22-008"

Copyright FCI.

lfr	ecn no	dr	date
A	F20307	DLE	2002/04/29
B	F20341	DLE	2002/06/04
C	LS3088	JTA	2003/11/28
D	104-0051	DTK	2004/07/17
E	105-0181	NT	2005/10/04
F	106-0057	SSC	2006/05/27
G	108-0123	SSC	2008/09/22

General Tolerances	
0 to 10mm:	±0.1mm
10 to 30mm:	±0.15mm
30 to 60mm:	±0.2mm
60 and more:	±0.3mm

www.fciconnect.com		surface	--	tolerance std	ISO 1302	ISO 406	ISO 1101	projection	mm
Dr	D LEGRAND	2002/04/29	ANGULAR	LINEAR	0.x	±	size	A2	Scale
Eng	F TISSERAND	2002/04/29	0°	±°	0.xx	±	ECN	108-0123	3:2
Chr	S.S.CHERIAN	2008/09/22	Product family		0.xxx	±	MOBILE I/O		Spec ref
Appr	S.S.CHERIAN	2008/09/22	Product family				MOBILE I/O		Spec ref
FCI		E05-SIDE-FLEX 6 CTS		dwg no		VJW54523		Rev.	
SMART CARD READER VXX 27787		catalog no		See Table		CUSTOMER COPY		sheet 1 of 1	