



Chipsmall Limited consists of a professional team with an average of over 10 year of expertise in the distribution of electronic components. Based in Hongkong, we have already established firm and mutual-benefit business relationships with customers from,Europe,America and south Asia,supplying obsolete and hard-to-find components to meet their specific needs.

With the principle of "Quality Parts,Customers Priority,Honest Operation,and Considerate Service",our business mainly focus on the distribution of electronic components. Line cards we deal with include Microchip,ALPS,ROHM,Xilinx,Pulse,ON,Everlight and Freescale. Main products comprise IC,Modules,Potentiometer,IC Socket,Relay,Connector.Our parts cover such applications as commercial,industrial, and automotives areas.

We are looking forward to setting up business relationship with you and hope to provide you with the best service and solution. Let us make a better world for our industry!



Contact us

Tel: +86-755-8981 8866 Fax: +86-755-8427 6832

Email & Skype: info@chipsmall.com Web: www.chipsmall.com

Address: A1208, Overseas Decoration Building, #122 Zhenhua RD., Futian, Shenzhen, China





Copyright FCI.

CATALOGUE NUMBER
7434L0825S01
7434L0825S01LF *

*- LEAD FREE version

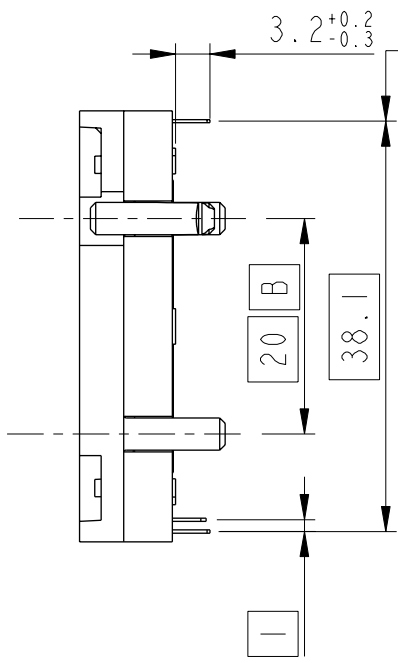
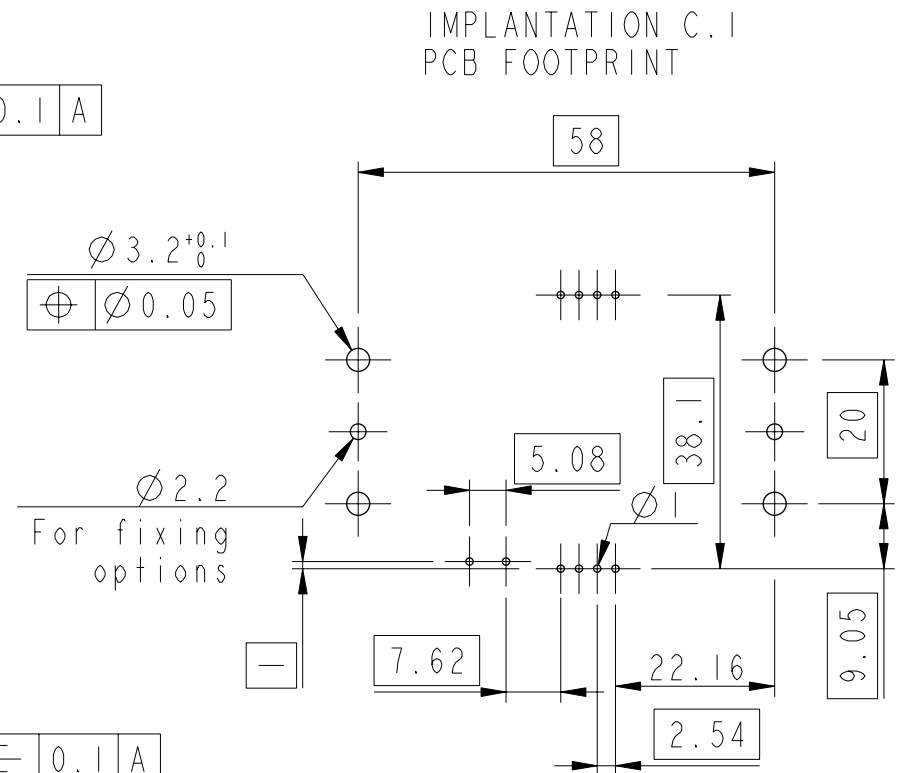
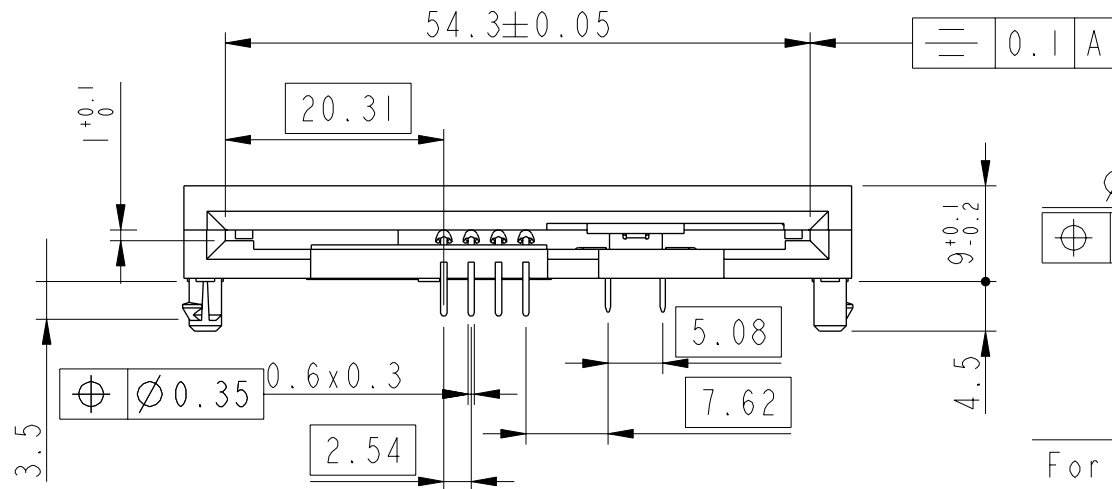

Crimping part to use with a thickness PCB of 1.6
holes $\phi = 3.2^{+0.1}_0$

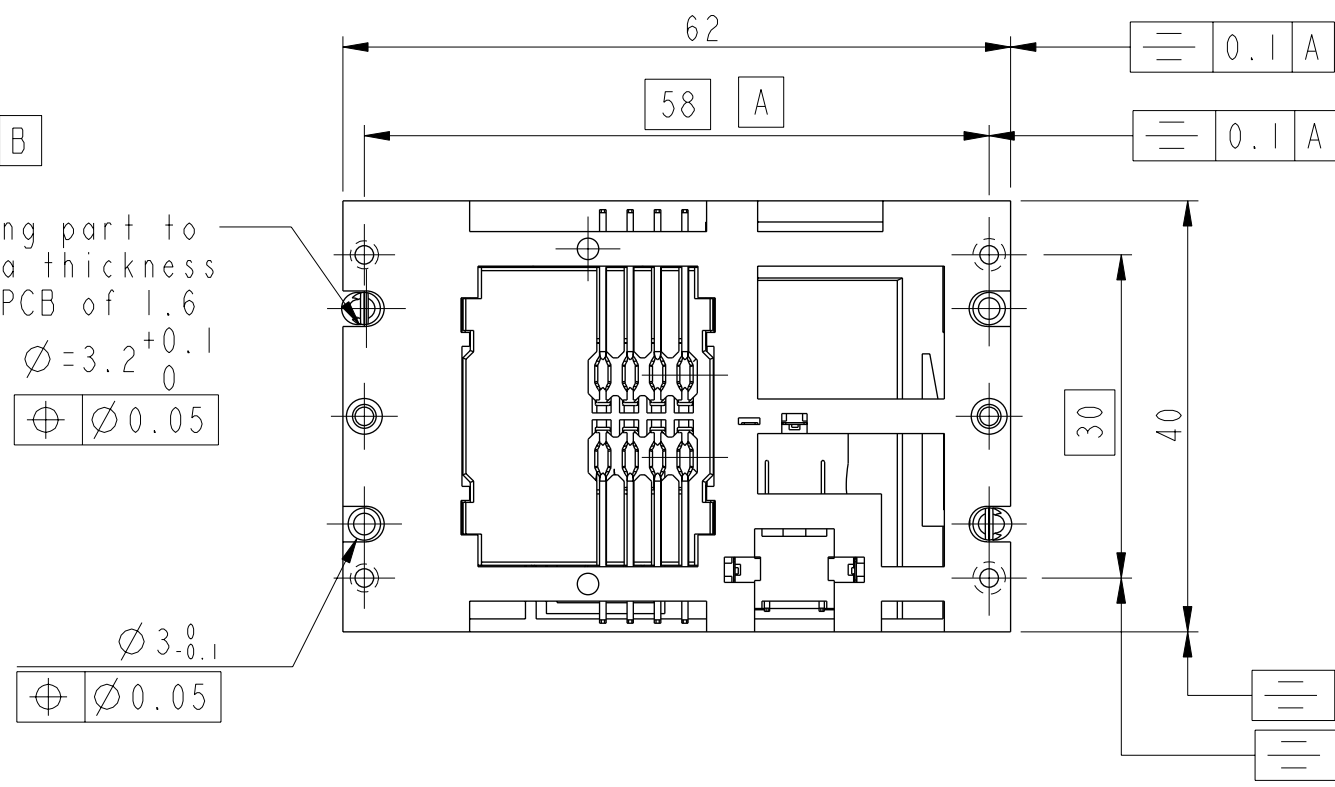

Tol Gen: 0mm to 10mm ± 0.1 mm
10mm to 30mm ± 0.15 mm
30mm to 60mm ± 0.2 mm
60mm and above ± 0.3 mm

LEAD FREE VERSION:

"This product meets European Union Directives and other country regulations as described in GS-22-008"

The housing will withstand exposure to 260°C peak temperature for 10seconds in a wave solder application with a 1.6mm minimum thick circuit board

rev	ecn no	dr	date
A	F20307	DLE	2002/04/29
B	105-0181	DTK	2005/07/20
C	106-0084	SSC	2006/06/21
D	108-0080	SSC	2008/06/28

www.fciconnect.com		surface - <input checked="" type="checkbox"/> ISO:1302	tolerance std ISO:406 ISO:1101	projection	MM
TOLERANCES UNLESS OTHERWISE SPECIFIED					
Dr	D.LEGRAND	2002/04/29	ANGULAR	0.x ±	size A3
Eng	F.TISSERAND	2002/04/29	LINEAR	0.xx ±	Scale 3:2
Chr	S.S.CHERIAN	2008/06/28	0° ±°	0.xxx ±	ECN 108-0080
Appr	S.S.CHERIAN	2008/06/28	Product family SMARTCARD	Spec ref -	
FCI logo		title SMARTCARD ASSEMBLY		dwg no VJW12132	Rev. D
		L08-16 CONTACTS - 8 CONTACTS			
catalog no		SEE TABLE	CUSTOMER	sheet 1 of 1	