



Chipsmall Limited consists of a professional team with an average of over 10 year of expertise in the distribution of electronic components. Based in Hongkong, we have already established firm and mutual-benefit business relationships with customers from,Europe,America and south Asia,supplying obsolete and hard-to-find components to meet their specific needs.

With the principle of “Quality Parts,Customers Priority,Honest Operation,and Considerate Service”,our business mainly focus on the distribution of electronic components. Line cards we deal with include Microchip,ALPS,ROHM,Xilinx,Pulse,ON,Everlight and Freescale. Main products comprise IC,Modules,Potentiometer,IC Socket,Relay,Connector.Our parts cover such applications as commercial,industrial, and automotives areas.

We are looking forward to setting up business relationship with you and hope to provide you with the best service and solution. Let us make a better world for our industry!



Contact us

Tel: +86-755-8981 8866 Fax: +86-755-8427 6832

Email & Skype: info@chipsmall.com Web: www.chipsmall.com

Address: A1208, Overseas Decoration Building, #122 Zhenhua RD., Futian, Shenzhen, China



4

3

2

1

THIS DRAWING IS UNPUBLISHED. RELEASED FOR PUBLICATION ,19 .
 © COPYRIGHT 19 BY AMP INCORPORATED. ALL RIGHTS RESERVED.

LOC	DIST	REVISIONS					
		P	LTR	DESCRIPTION	DATE	DWN	APVD
BD	48		A	REDRAWN W/O CHANGE PER EC 0G40-324-98	20 JAN 99	-	-

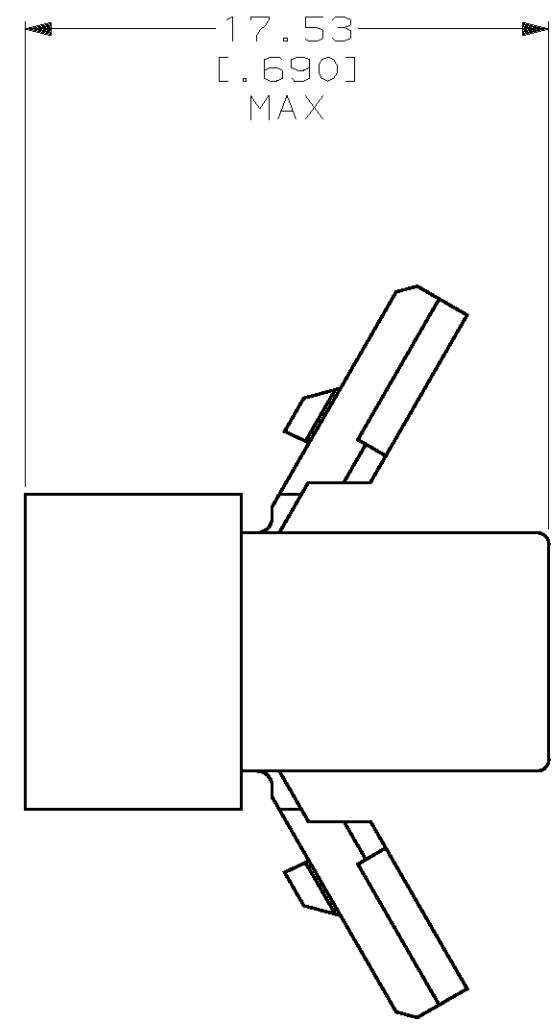
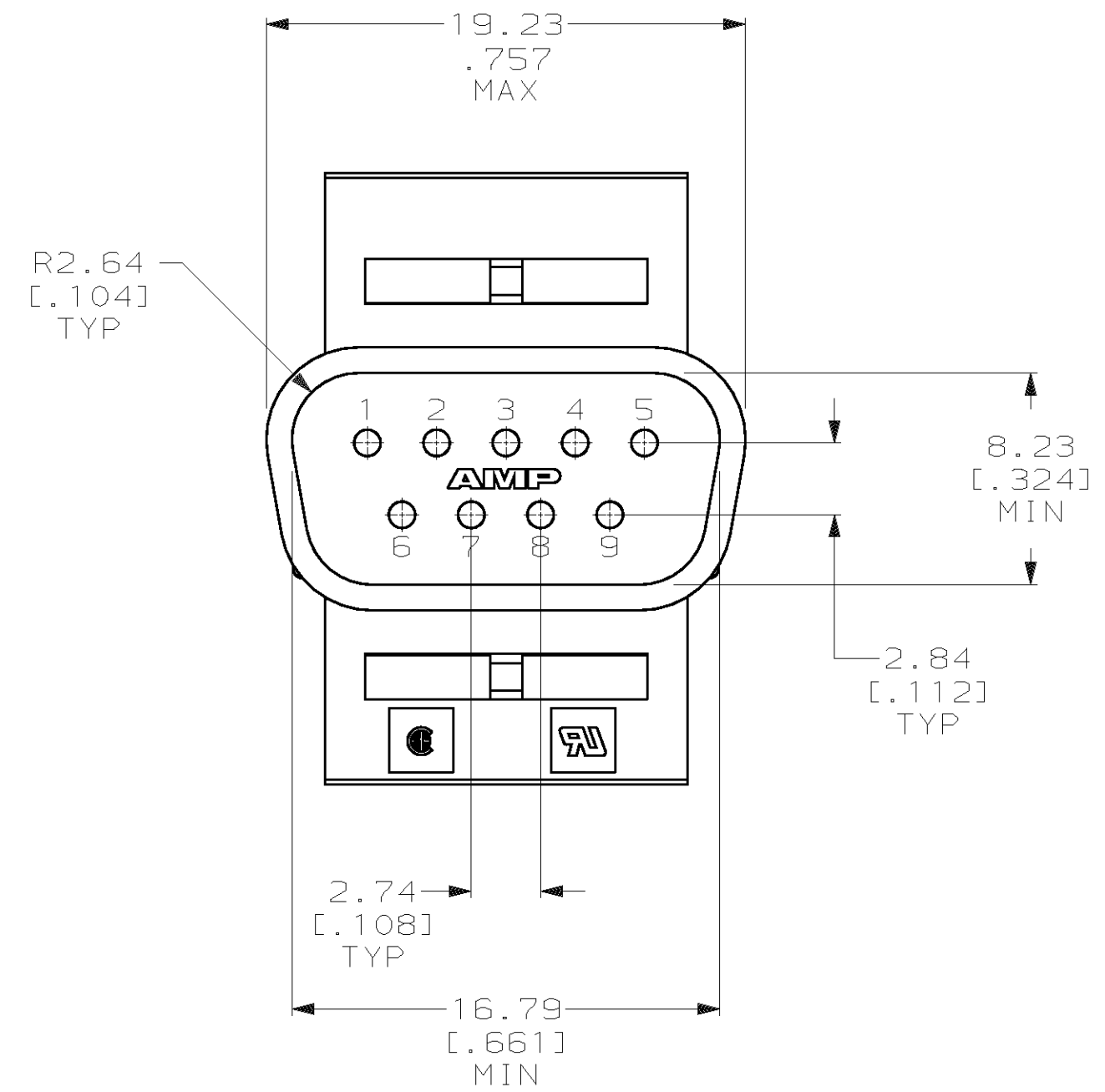

745032-1
 PART NUMBER

THIS DRAWING IS A CONTROLLED DOCUMENT.		DWN	B. CARBO	20 JAN 99	AMP AMP Incorporated Harrisburg, PA 17105-3608
DIMENSIONS: mm [INCHES]		CHK	C. OBERMAN	22 JAN 99	
TOLERANCES UNLESS OTHERWISE SPECIFIED:		APVD	R. TAYLOR	25 JAN 99	NAME
0 PLC ±-		PRODUCT SPEC		PLUG HOUSING, 9 POSITION, AMPLIMITE™	
1 PLC ±-		APPLICATION SPEC		SIZE	
2 PLC ±0.13 [.005]		WEIGHT		CAGE CODE	
3 PLC ±-		CUSTOMER DRAWING		DRAWING NO	
4 PLC ±-		SCALE		SHEET	
ANGLES ±-		4:1		1 OF 1	
FINISH -		RESTRICTED TO		REV	
MATERIAL THERMOPLASTIC, BLACK, UL 94V-2 RATED		A300779		C- 745032	
		A		A	