



Chipsmall Limited consists of a professional team with an average of over 10 year of expertise in the distribution of electronic components. Based in Hongkong, we have already established firm and mutual-benefit business relationships with customers from,Europe,America and south Asia,supplying obsolete and hard-to-find components to meet their specific needs.

With the principle of “Quality Parts,Customers Priority,Honest Operation,and Considerate Service”,our business mainly focus on the distribution of electronic components. Line cards we deal with include Microchip,ALPS,ROHM,Xilinx,Pulse,ON,Everlight and Freescale. Main products comprise IC,Modules,Potentiometer,IC Socket,Relay,Connector.Our parts cover such applications as commercial,industrial, and automotives areas.

We are looking forward to setting up business relationship with you and hope to provide you with the best service and solution. Let us make a better world for our industry!



## Contact us

Tel: +86-755-8981 8866 Fax: +86-755-8427 6832

Email & Skype: info@chipsmall.com Web: www.chipsmall.com

Address: A1208, Overseas Decoration Building, #122 Zhenhua RD., Futian, Shenzhen, China



THIS DRAWING IS UNPUBLISHED. RELEASED FOR PUBLICATION  
 © COPYRIGHT - By - ALL RIGHTS RESERVED.

LOC		DIST		REVISIONS			
P	LTR	DESCRIPTION		DATE	DWN	APVD	
		C1		REVISED PER ECO-11-004835	11MAR11	RK HMR	

COVER  
 (1) REQUIRED PER ASSEMBLY  
 AMP LOGO ON THIS COVER

ASSORTED CABLE SUPPORT GATE LATCHES  
 (FOR VARIETY OF CABLE SIZES)  
 SUPPLIED WITH CABLE CLAMP ASSEMBLIES.

CLAMP ACCOMODATES JACKETED CABLE  
 UP TO .330 INCH DIAMETER

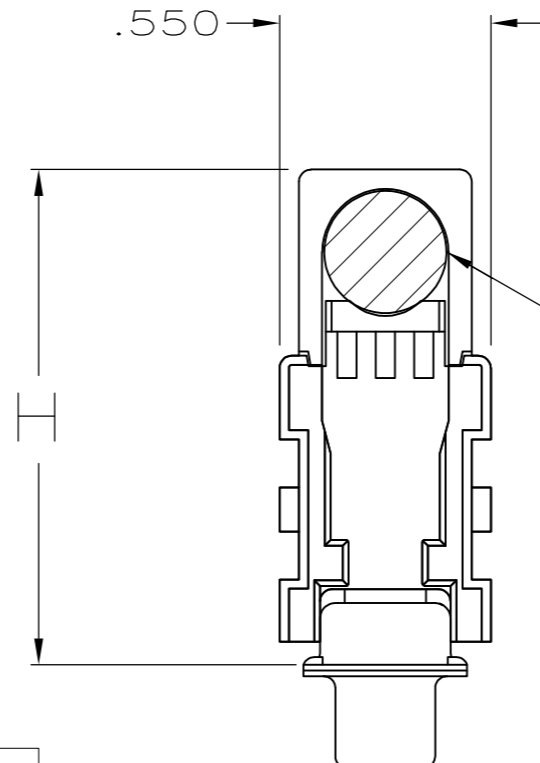
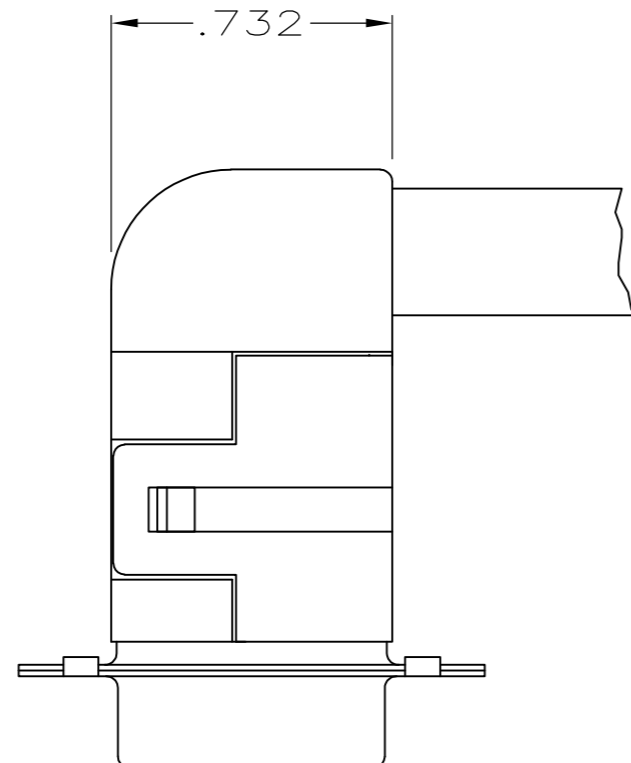

	H
PLUG	1.290
RECEPTACLE	1.241

- 1 ALL PARTS ARE PACKAGED UNASSEMBLED.
- 2 COVERS FIT HDE -20 TYPE CONNECTORS, BOTH PLASTIC & METAL SHELL ASSEMBLIES.
- 3 SIZE NUMBER MOLDED ON ALL PARTS.
- 4 PARTS ASSEMBLE WITHOUT HARDWARE.
- 5 KIT CONSISTS OF 1 COVER & 1 GATE LATCH ASSORTMENT.
- 6 SAME AS -1 EXCEPT, EACH PART IS INDIVIDUALLY BULK PACKED FOR MULTIPLE KIT ORDERS.

OBSOLETE		745550-2
		745550-1
PACKAGING		PART NUMBER

THIS DRAWING IS A CONTROLLED DOCUMENT.		DWN	A.STAUB BG	5/7/90	TE Connectivity		
DIMENSIONS: INCHES		CHK	B. LENKER	6-15-90			
TOLERANCES UNLESS OTHERWISE SPECIFIED:		APVD	J.E. WESTMAN	7-9-90	NAME		
0 PLC ± -		PRODUCT SPEC		KIT, LOW PROFILE, 90DEG CABLE CLAMP, SIZE 1, 9 POSITION, AMPLIMITE HDE-20			
1 PLC ± -		APPLICATION SPEC		SIZE			
2 PLC ± -		WEIGHT		CAGE CODE			
3 PLC ± .015		MATERIAL		DRAWING NO			
4 PLC ± -		BLACK THERMOPLASTIC		A2 00779 C=745550			
ANGLES ± -		FINISH		RESTRICTED TO			
-		CUSTOMER DRAWING		SCALE 2:1 SHEET 1 of 1 REV C1			