



Chipsmall Limited consists of a professional team with an average of over 10 year of expertise in the distribution of electronic components. Based in Hongkong, we have already established firm and mutual-benefit business relationships with customers from,Europe,America and south Asia,supplying obsolete and hard-to-find components to meet their specific needs.

With the principle of “Quality Parts,Customers Priority,Honest Operation,and Considerate Service”,our business mainly focus on the distribution of electronic components. Line cards we deal with include Microchip,ALPS,ROHM,Xilinx,Pulse,ON,Everlight and Freescale. Main products comprise IC,Modules,Potentiometer,IC Socket,Relay,Connector.Our parts cover such applications as commercial,industrial, and automotives areas.

We are looking forward to setting up business relationship with you and hope to provide you with the best service and solution. Let us make a better world for our industry!



Contact us

Tel: +86-755-8981 8866 Fax: +86-755-8427 6832

Email & Skype: info@chipsmall.com Web: www.chipsmall.com

Address: A1208, Overseas Decoration Building, #122 Zhenhua RD., Futian, Shenzhen, China



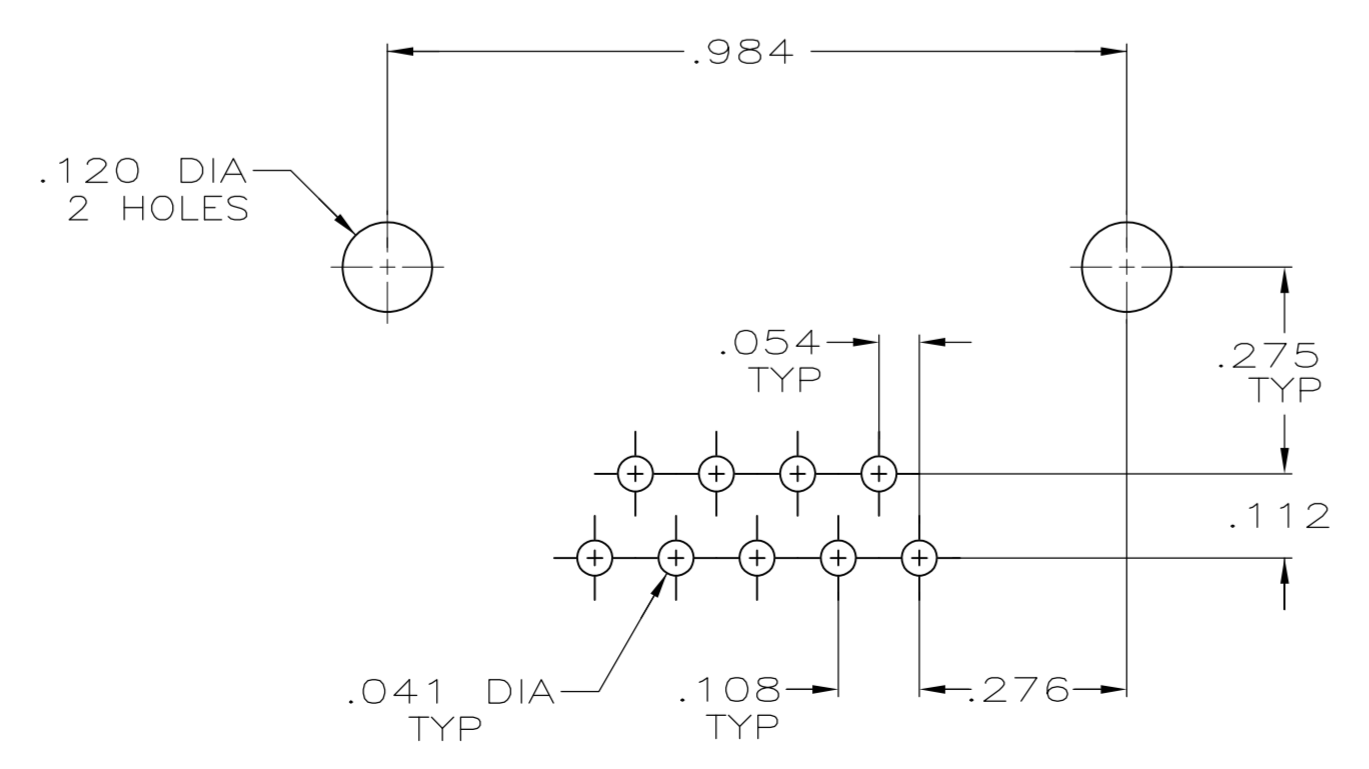
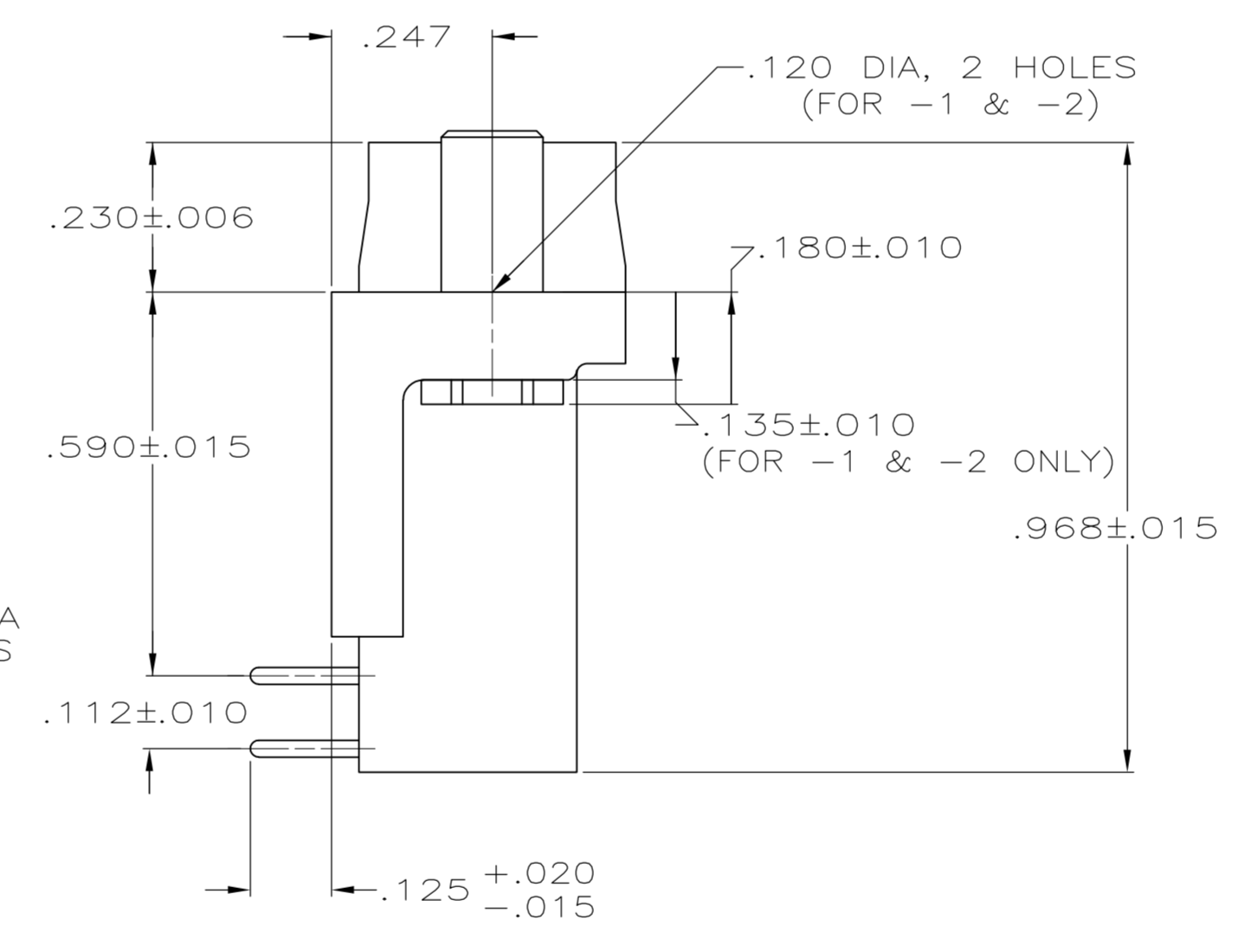
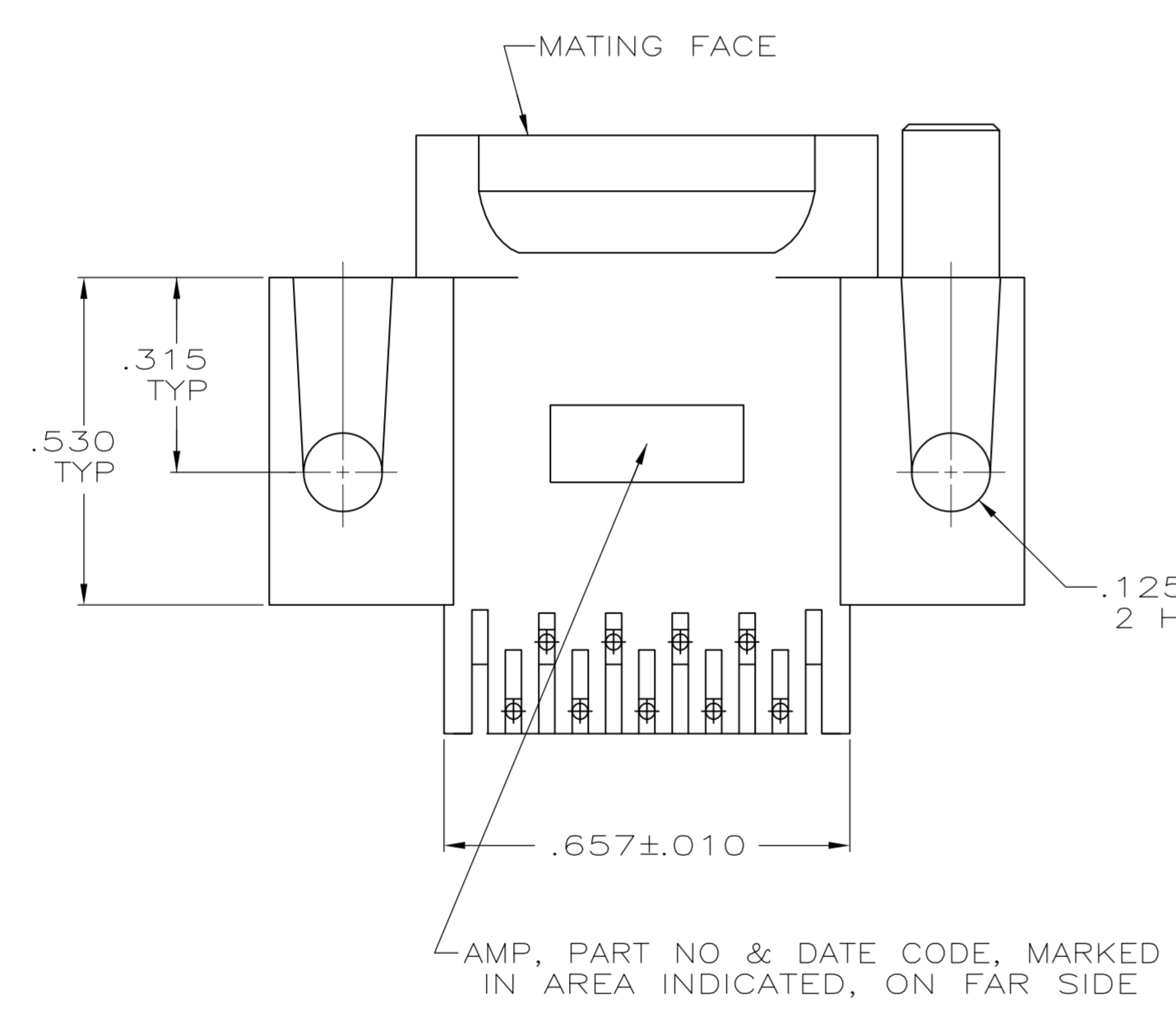
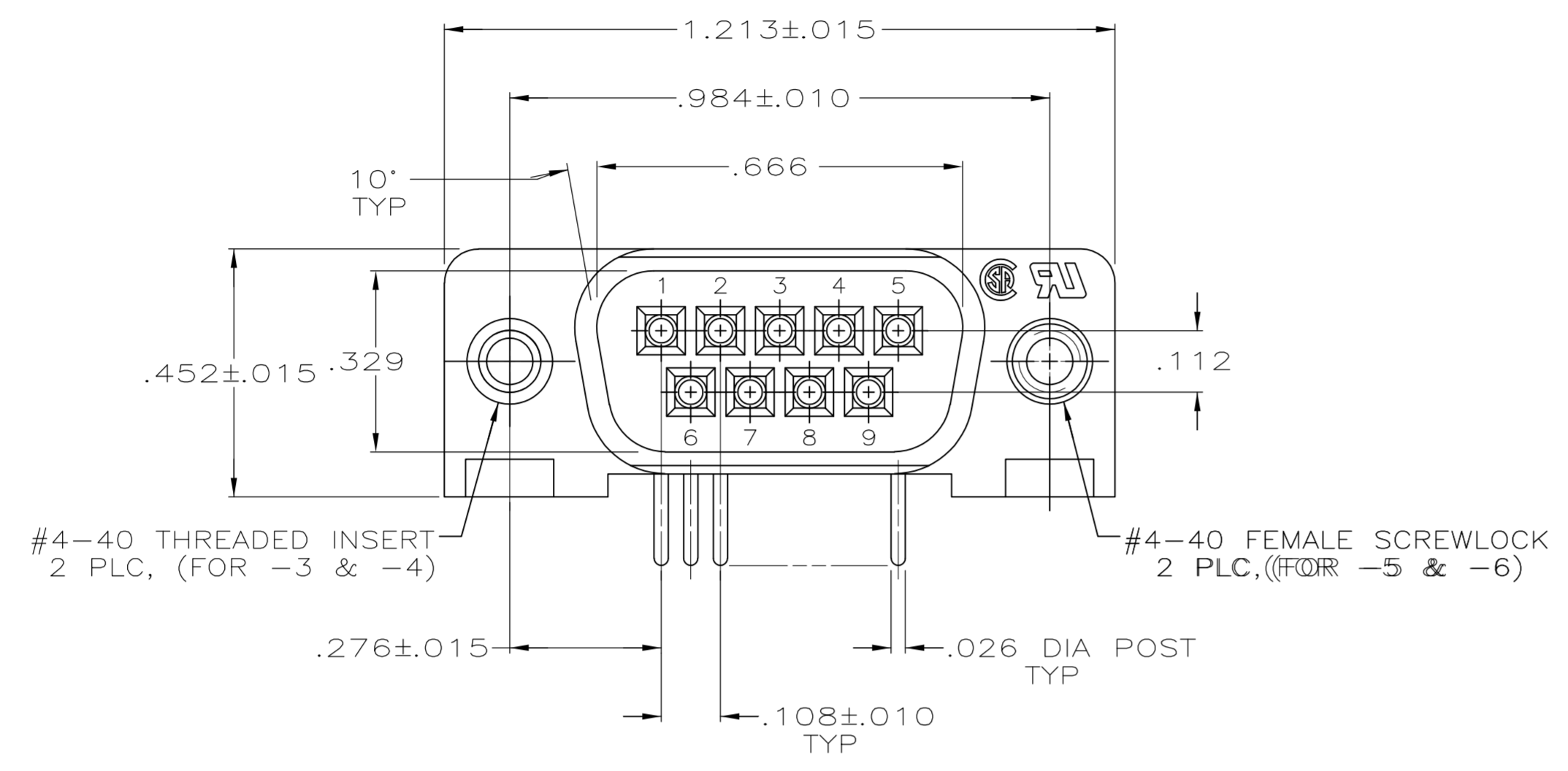

- 1 MOLDED PARTS: FLAME RETARDANT, 94V-0 RATED, GLASS FILLED NYLON OR POLYESTER, BLACK
 CONTACTS: BRASS
 HARDWARE: ZINC
- 2 CONTACTS: SEE TABLE
 HARDWARE: CLEAR CHROMATE
- 3 GOLD FLASH ON THE MATING SURFACES, .000100 MIN TIN OR TIN-LEAD PLATE ON THE SOLDER END, .000050 MIN NICKEL UNDERPLATE ON THE ENTIRE CONTACT.
- 4 .000030 MIN GOLD PLATE ON THE MATING SURFACES, .000100 MIN TIN OR TIN-LEAD PLATE ON THE SOLDER END, .000050 MIN NICKEL UNDERPLATE ON THE ENTIRE CONTACT.
 -OR-
 GOLD FLASH OVER PALLADIUM-NICKEL PLATE, .000030 MIN TOTAL ON THE MATING SURFACES, .000100 MIN TIN OR TIN-LEAD PLATE ON THE SOLDER END, .000050 MIN NICKEL UNDERPLATE ON THE ENTIRE CONTACT.
- 5 REFER TO APPLICATION SPEC FOR RECOMMENDED P.C. BOARD MOUNTING DIMENSIONS FOR AUTOMATIC INSERTION.

SUPSD BY 747467-4	WITH SCREWLOCKS	4	747467-6
OBSOLETE	WITH SCREWLOCKS	3	747467-5
	WITH INSERTS	4	747467-4
SUPSD BY 747467-4	WITH INSERTS	3	747467-3
	WITH .120 DIA HOLE	4	747467-2
	WITH .120 DIA HOLE	3	747467-1
REMARKS		FINISH	PART NUMBER

THIS DRAWING IS A CONTROLLED DOCUMENT.

DIMENSIONS: INCHES	TOLERANCES UNLESS OTHERWISE SPECIFIED:	DIN C RICHARD 7-29-87	7-29-87
		CHK S WELDON 8-3-87	8-3-87
		APVD B TAYLOR 8-3-87	8-3-87
		NAME	PLUG ASSY, SIZE 1, 9 POSN. RIGHT ANGLE, .590 SERIES, .026 DIA POSTS, AMPLIMITE® HD-20
		PRODUCT SPEC	108-40005
		APPLICATION SPEC	114-40015
		SIZE	A1
		WEIGHT	000779
		CAGE CODE	747467
		RESTRICTED TO	
		CUSTOMER DRAWING	SCALE 4:1 SHEET 1 OF 1 REV H