



Chipsmall Limited consists of a professional team with an average of over 10 year of expertise in the distribution of electronic components. Based in Hongkong, we have already established firm and mutual-benefit business relationships with customers from,Europe,America and south Asia,supplying obsolete and hard-to-find components to meet their specific needs.

With the principle of “Quality Parts,Customers Priority,Honest Operation,and Considerate Service”,our business mainly focus on the distribution of electronic components. Line cards we deal with include Microchip,ALPS,ROHM,Xilinx,Pulse,ON,Everlight and Freescale. Main products comprise IC,Modules,Potentiometer,IC Socket,Relay,Connector.Our parts cover such applications as commercial,industrial, and automotives areas.

We are looking forward to setting up business relationship with you and hope to provide you with the best service and solution. Let us make a better world for our industry!



Contact us

Tel: +86-755-8981 8866 Fax: +86-755-8427 6832

Email & Skype: info@chipsmall.com Web: www.chipsmall.com

Address: A1208, Overseas Decoration Building, #122 Zhenhua RD., Futian, Shenzhen, China



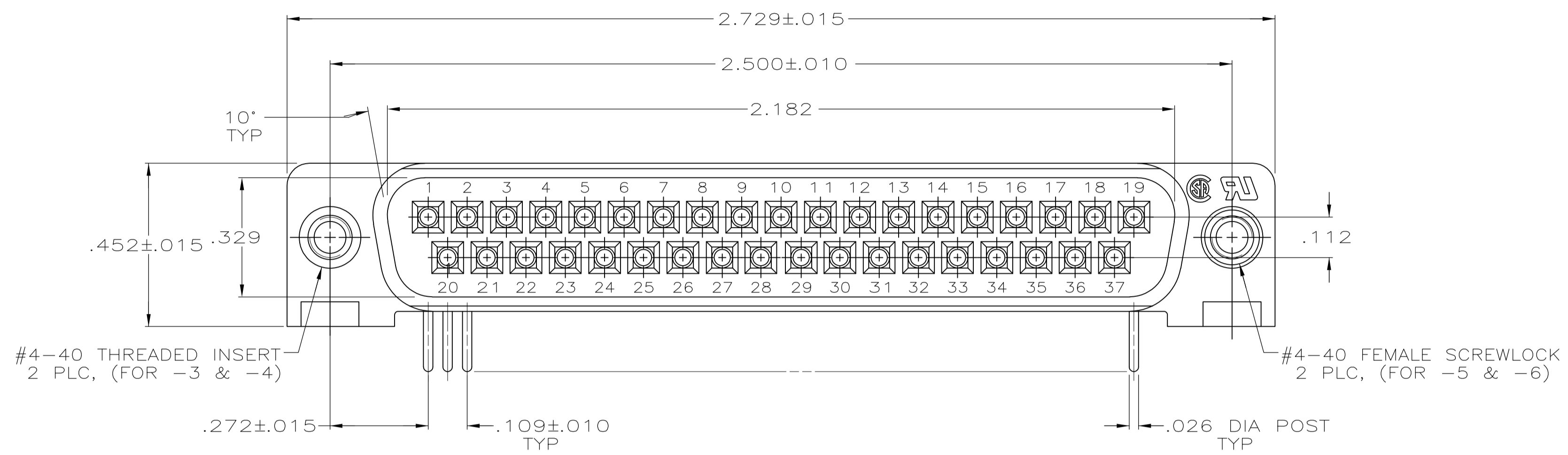

- 1 MOLDDED PARTS: FLAME RETARDANT, 94V-0 RATED, GLASS FILLED NYLON OR POLYESTER, BLACK
CONTACTS: BRASS
HARDWARE: BRASS
- 2 CONTACTS: SEE TABLE
INSERTS: UNPLATED
SCREWLOCKS: NICKEL PLATED
- 3 REFER TO APPLICATION SPEC FOR RECOMMENDED P.C. BOARD MOUNTING DIMENSIONS FOR AUTOMATIC INSERTION.
- 4 GOLD FLASH ON THE MATING SURFACES, .000100 MIN TIN OR TIN-LEAD PLATE ON THE SOLDER END, .000050 MIN NICKEL UNDERPLATE ON THE ENTIRE CONTACT.
- 5 .000030 MIN GOLD PLATE ON THE MATING SURFACES, .000100 MIN TIN OR TIN-LEAD PLATE ON THE SOLDER END, .000050 MIN NICKEL UNDERPLATE ON THE ENTIRE CONTACT.
-OR-
GOLD FLASH OVER PALLADIUM- NICKEL PLATE, .000030 MIN TOTAL ON THE MATING SURFACES, .000100 MIN TIN OR TIN-LEAD PLATE ON THE SOLDER END, .000050 MIN NICKEL UNDERPLATE ON THE ENTIRE CONTACT.

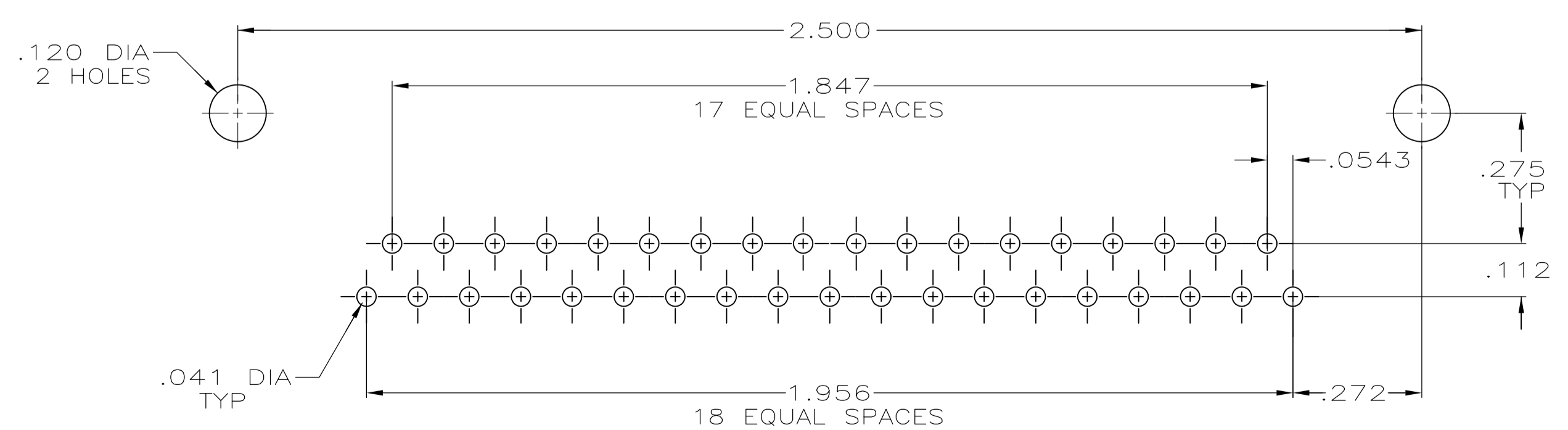
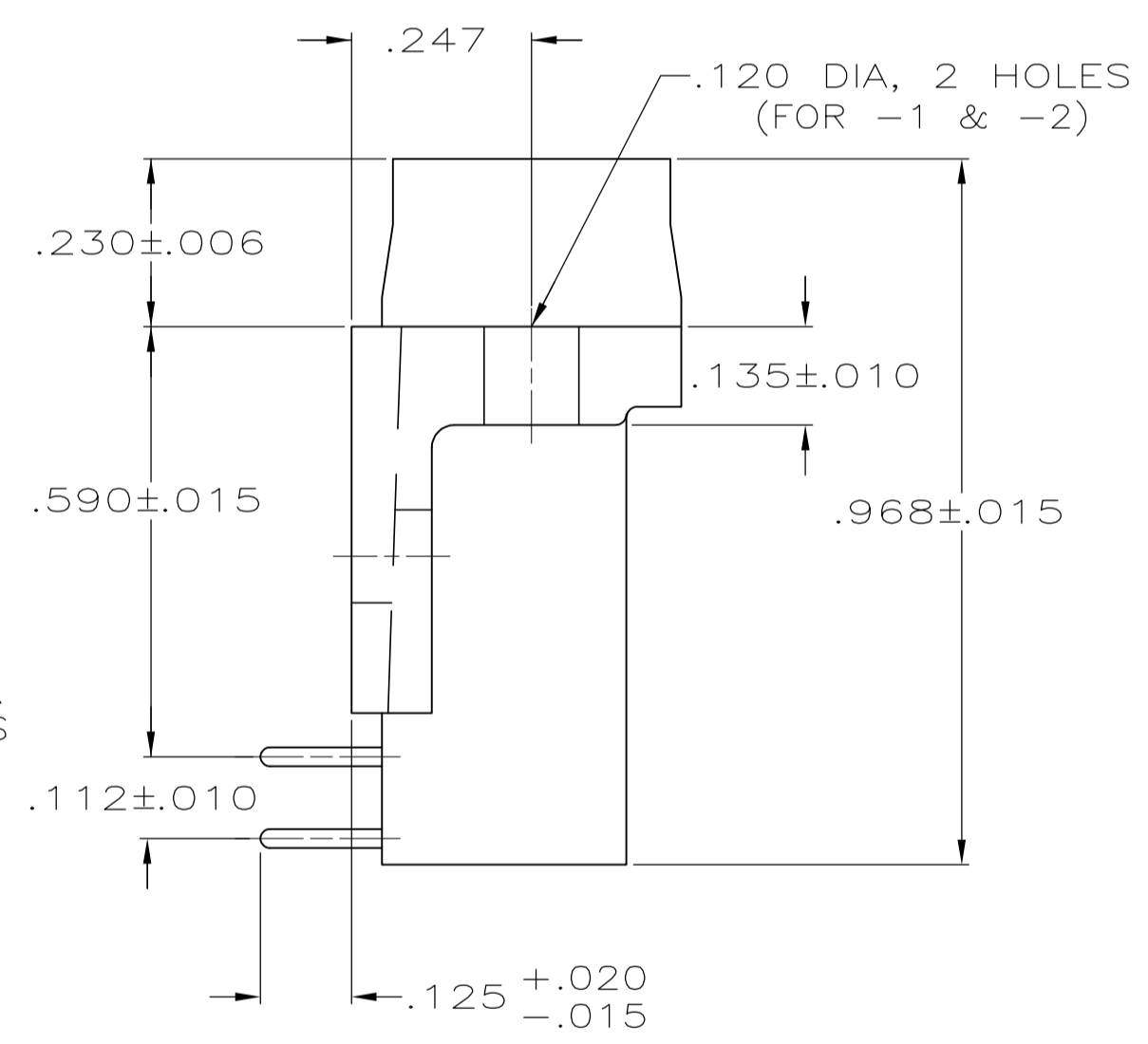
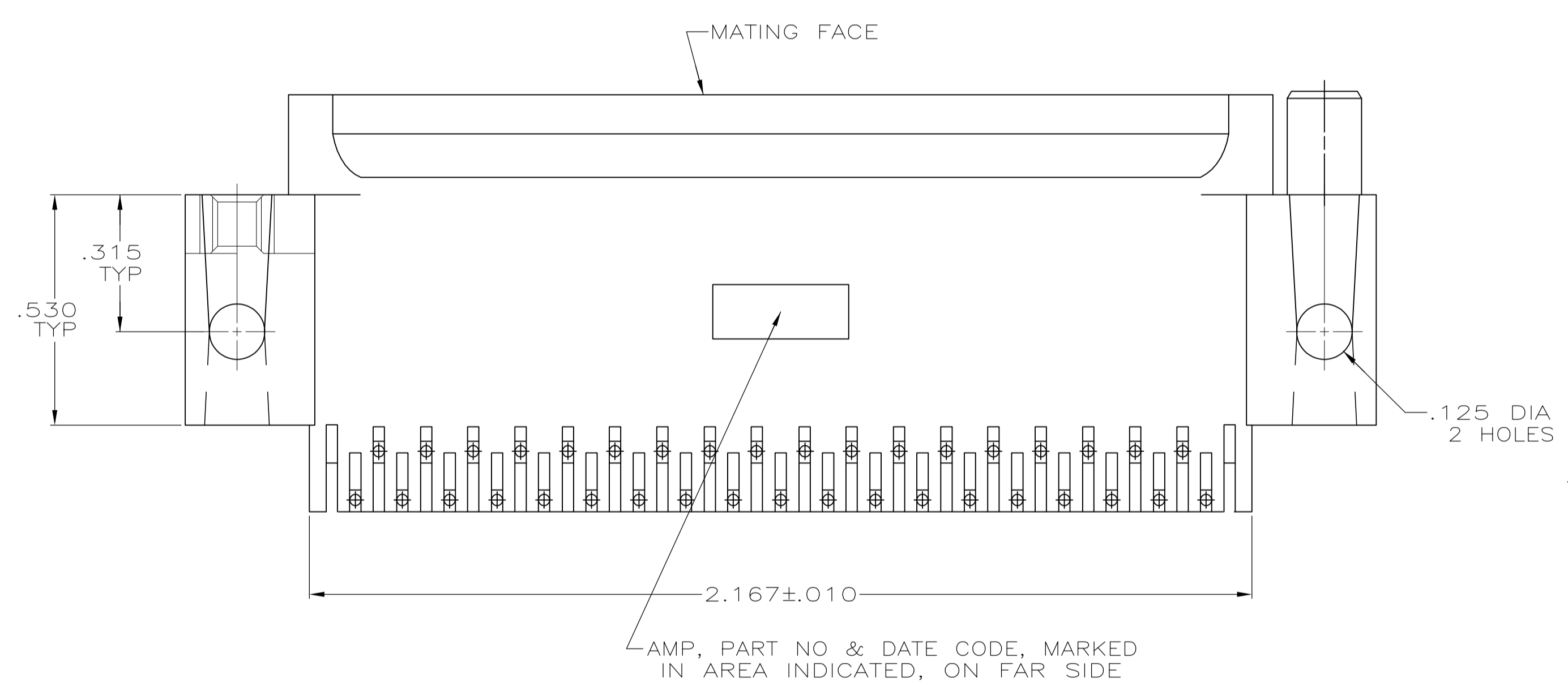

OBSELETE	WITH SCREWLOCKS	5	747470 -6
OBSELETE	WITH SCREWLOCKS	4	747470 -5
OBSELETE	WITH INSERTS	5	747470 -4
OBSELETE	WITH INSERTS	4	747470 -3
	WITH .120 DIA HOLE	5	747470 -2
SUPSD BY 747470-2	WITH .120 DIA HOLE	4	747470 -1
	REMARKS	FINISH	PART NUMBER

THIS DRAWING IS A CONTROLLED DOCUMENT.		DIN C RICHARD 7-29-87	STE TE Connectivity	
DIMENSIONS: INCHES		CHK S WELDON 8-3-87	NAME	
TOLERANCES UNLESS OTHERWISE SPECIFIED:		APVD B TAYLOR 8-3-87	PRODUCT SPEC	
0 PLC ± -	1 PLC ± -	108-40005		
2 PLC ± -	3 PLC ± .005	APPLICATION SPEC		
4 PLC ± -	ANGLES ± ± °	SIZE	CAGE CODE	DRAWING NO
MATERIAL 1	FINISH 2	WEIGHT -	A1 00779	C=747470
CUSTOMER DRAWING		SCALE 4:1	SHEET 1 OF 1	REV J