



Chipsmall Limited consists of a professional team with an average of over 10 year of expertise in the distribution of electronic components. Based in Hongkong, we have already established firm and mutual-benefit business relationships with customers from,Europe,America and south Asia,supplying obsolete and hard-to-find components to meet their specific needs.

With the principle of "Quality Parts,Customers Priority,Honest Operation,and Considerate Service",our business mainly focus on the distribution of electronic components. Line cards we deal with include Microchip,ALPS,ROHM,Xilinx,Pulse,ON,Everlight and Freescale. Main products comprise IC,Modules,Potentiometer,IC Socket,Relay,Connector.Our parts cover such applications as commercial,industrial, and automotives areas.

We are looking forward to setting up business relationship with you and hope to provide you with the best service and solution. Let us make a better world for our industry!



## Contact us

Tel: +86-755-8981 8866 Fax: +86-755-8427 6832

Email & Skype: info@chipsmall.com Web: www.chipsmall.com

Address: A1208, Overseas Decoration Building, #122 Zhenhua RD., Futian, Shenzhen, China



COPYRIGHT © 2012 DIGI INTERNATIONAL,  
UNPUBLISHED WORK - ALL RIGHTS RESERVED.

BALLOON DESIGNATION SYMBOL



THIS DOCUMENT CONTAINS PROPRIETARY INFORMATION AND, EXCEPT WITH WRITTEN PERMISSION OF DIGI, SUCH INFORMATION SHALL NOT BE PUBLISHED OR DISCLOSED TO OTHERS, OR USED FOR ANY PURPOSE AND THE DOCUMENT SHALL NOT BE COPIED IN WHOLE OR IN PART

NOTES: UNLESS OTHERWISE SPECIFIED

1. MATERIAL: .063" 5052-H32 ALUMINUM, BRUSHED FINISH.
2. CHEM-FILM PER AMS 2473 CLEAR.
3. DELETED.
4. REMOVE BURRS AND SHARP EDGES PER INDUSTRY PRACTICE.
5. DIMENSIONS OF FORM AND LOCATION APPLY TO PART IN THE UNRESTRAINED CONDITION.
6. ALL BENDS R.063 MIN. ALL BENDS ARE 90° UNLESS OTHERWISE NOTED.
7. STAMP, ETCH, OR ENGRAVE PART NUMBER, REVISION AND DATE CODE (YYWW) WITH .125" MINIMUM TALL CHARACTERS. LOCATE APPROXIMATELY AS SHOWN. PART MARKING SHALL BE PERFORMED PRIOR TO APPLYING FINISH AND SHALL BE CLEARLY VISIBLE AFTER FINISHING.
8. FINISHED PART SHALL BE ROHS COMPLIANT PER 2002/95/EC. THE FACILITY PERFORMING THIS WORK SHALL PERFORM TESTS OR OBTAIN TESTING INFORMATION THAT CONFIRMS COMPLIANCE. TEST RECORDS SHALL BE MADE AVAILABLE UPON REQUEST.
9. VENDOR INFORMATION: PENN ENGINEERING  
DANBORO, PA 18916  
CAGE CODE: 46384

REVISION HISTORY				
REV	ECO	DESCRIPTION	DATE	DRW/CHK
A		INITIAL RELEASE - NPRO 2534	8/13/12	MJL/TJM
B	3928	REMOVED BOTTOM FLANGE	9/14/12	MJL/TJM

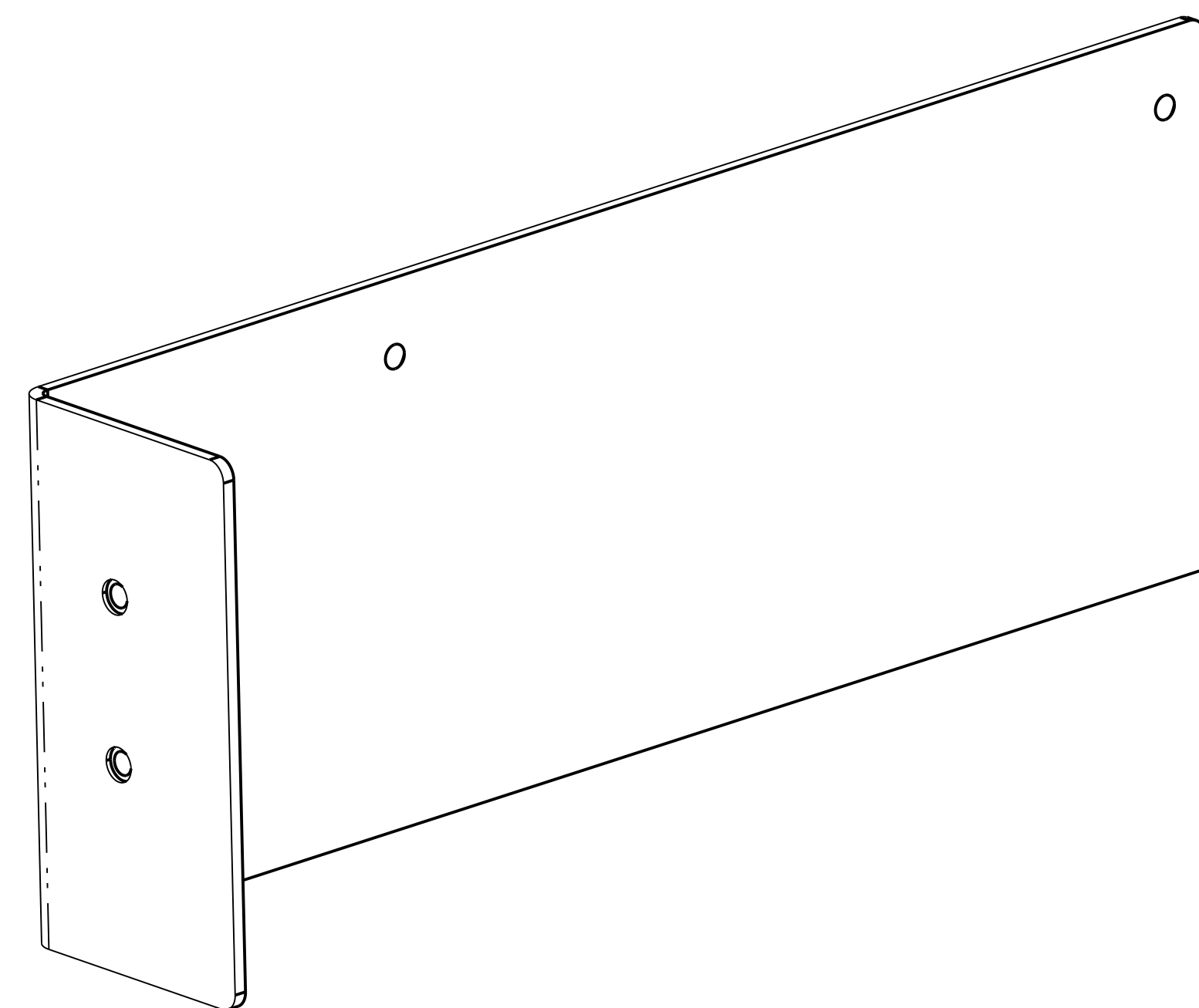

ISOMETRIC VIEW  
FOR REFERENCE ONLY

QTY	CAGE CODE	PART OR IDENTIFYING NO	NOMENCLATURE OR DESCRIPTION	FIND NO
2		CLS-440-1	CLINCH NUT	2
1		60001337-01	BRACKET, WR21 DIN RAIL EDGE MOUNT	1
-01				

PARTS LIST				
DESIGNER/ENGINEER:	M. LARSEN	DATE:	15-Jun-12	<b>Digi INTERNATIONAL</b> 11001 BREN ROAD EAST, MINNETONKA, MN 55343 TITLE <b>BRACKET, WR21 DIN RAIL            EDGE MOUNT</b>
HW ENGINEER:		DATE:	15-Jun-12	
MFG/OPS:		DATE:		
DRAFTER:	R. OLSEN	DATE:	15-Jun-12	
PRODUCT MANAGER:	M. LARSEN	DATE:	15-Jun-12	
	J. HARTZLER	DATE:	15-Jun-12	

SIZE	CAGE CODE	DWG NO	REV
D	08TP3	60001337-XX	B

SCALE	DO NOT SCALE DRAWING	SHEET
2:1		1 OF 2

- PROJENIEER GENERATED DRAWING -

(NOTES ON SHEET 1)

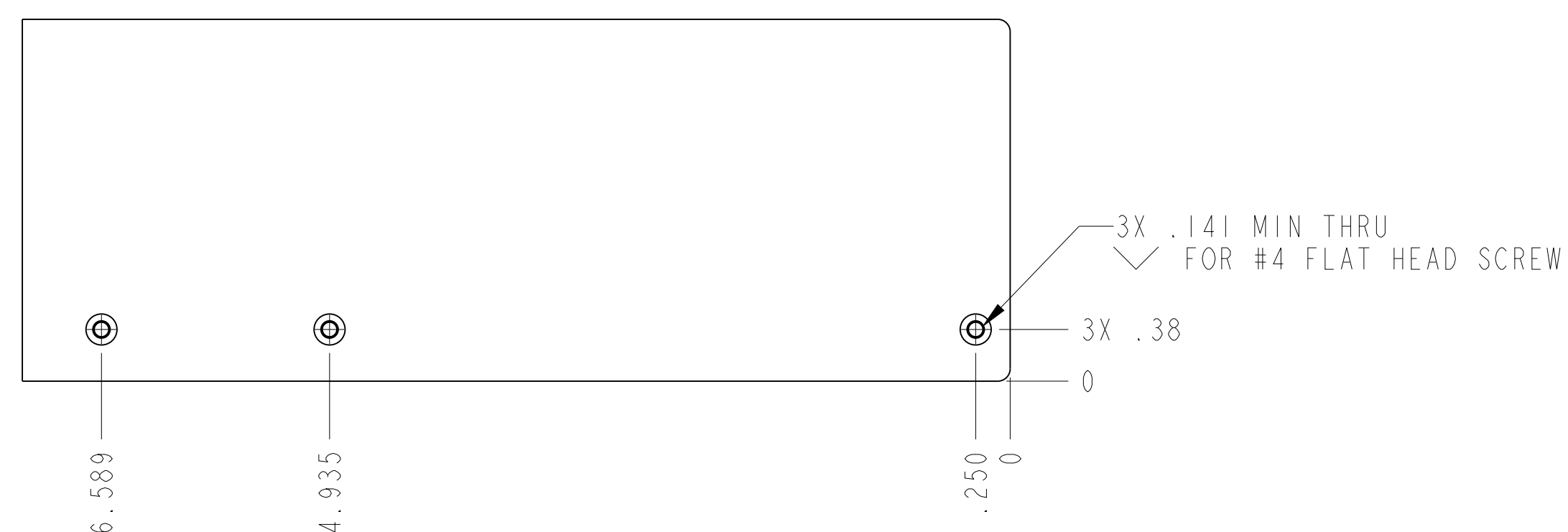
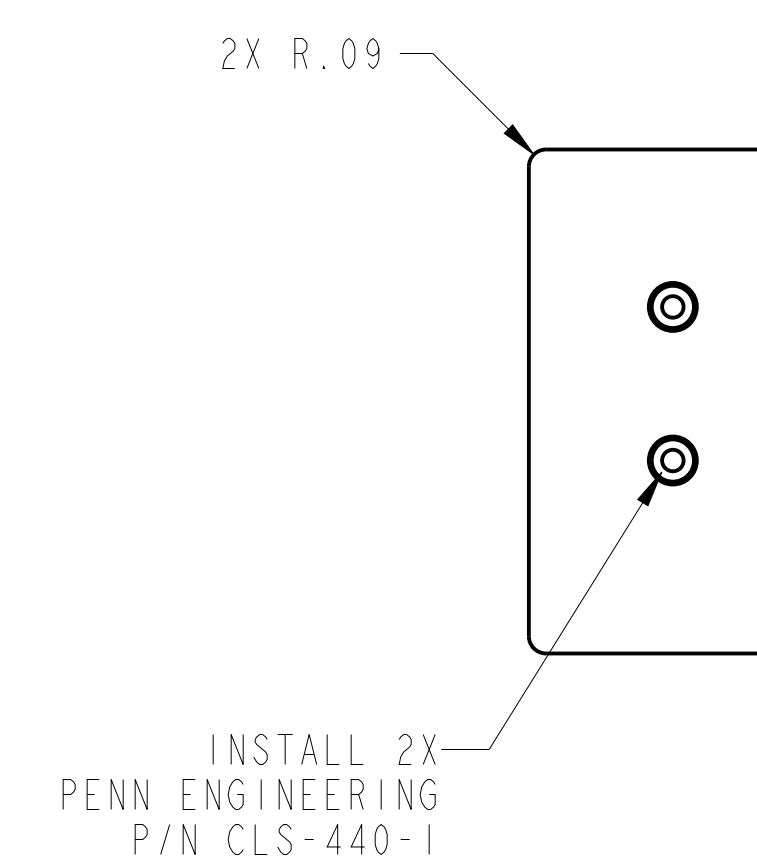
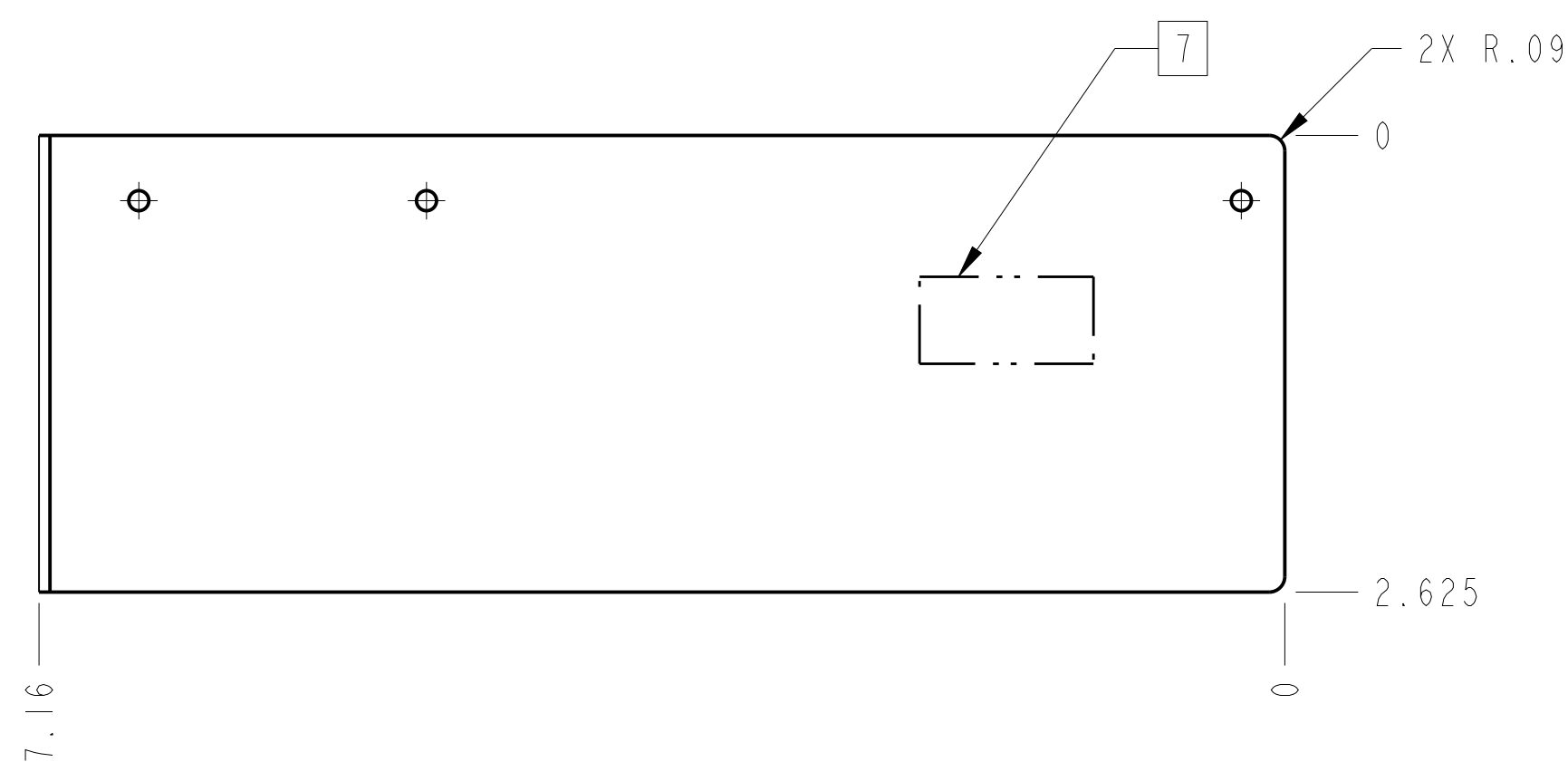
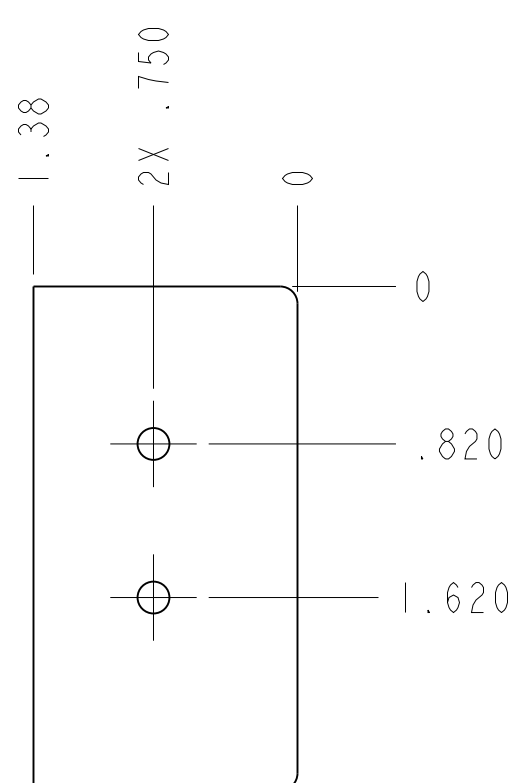

60001337-01

<b>DIGI INTERNATIONAL</b> 11001 BREN ROAD EAST, MINNETONKA, MN 55343			
TITLE <b>BRACKET, WR21 DIN RAIL          EDGE MOUNT</b>			
SIZE	CAGE CODE	DWG NO	REV
D	08TP3	60001337-XX	B
SCALE		SHEET	
1:1		DO NOT SCALE DRAWING	
			2 OF 2