



Chipsmall Limited consists of a professional team with an average of over 10 year of expertise in the distribution of electronic components. Based in Hongkong, we have already established firm and mutual-benefit business relationships with customers from,Europe,America and south Asia,supplying obsolete and hard-to-find components to meet their specific needs.

With the principle of “Quality Parts,Customers Priority,Honest Operation,and Considerate Service”,our business mainly focus on the distribution of electronic components. Line cards we deal with include Microchip,ALPS,ROHM,Xilinx,Pulse,ON,Everlight and Freescale. Main products comprise IC,Modules,Potentiometer,IC Socket,Relay,Connector.Our parts cover such applications as commercial,industrial, and automotives areas.

We are looking forward to setting up business relationship with you and hope to provide you with the best service and solution. Let us make a better world for our industry!



## Contact us

Tel: +86-755-8981 8866 Fax: +86-755-8427 6832

Email & Skype: info@chipsmall.com Web: www.chipsmall.com

Address: A1208, Overseas Decoration Building, #122 Zhenhua RD., Futian, Shenzhen, China



# Calibration Unit for Combo Tester Installation, Operation and Maintenance



Made in the  
United States of America



Figure 1. SCS 770033 Calibration Unit

## Description

The SCS [770033](#) Calibration Unit is designed to verify whether a tester is operating within specifications. This product can be used as one of the tools to fulfill the ANSI/ESD S20.20 paragraph 6.1.3.2 “Compliance Verification Plan.” The [770033](#) Calibration Unit is a passive device and requires no power source. The Calibration Unit is manufactured with industry accepted test ranges for both wrist straps and foot grounders. The wrist strap pass range is set at 750K - 10M, while the foot ground test range is set at 750K - 100M. The SCS Calibration Unit is calibrated to NIST traceable standards.

The SCS [770033](#) Calibration Unit is to be used with the following items:

Item	Description
<a href="#">770030</a>	Combo Tester
<a href="#">770031</a>	Combo Tester with Stand and Foot Plate

## Packaging

- 1 Calibration Unit
- 2 Test Leads with Banana Plug Terminals
- 1 Certificate of Calibration

## Operation

### Testing the Wrist Strap Circuit

1. Plug one of the included test leads into the black banana jack labeled “E” on the Calibration Unit. Connect the opposite end of the test lead into the yellow banana jack labeled “WRIST STRAP” on the Combo Wrist Strap / Footwear Tester. Toggle the switch to the “WRIST STRAP” position.

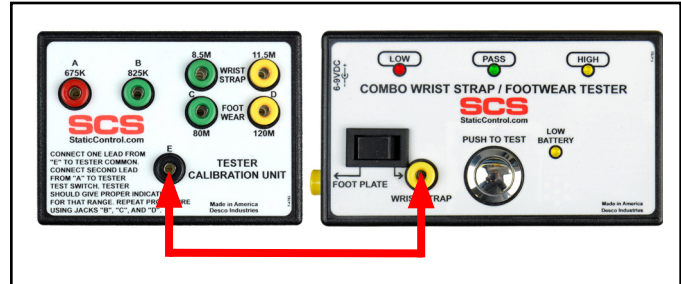

Figure 2. Connecting the test lead from banana jack “E” on the Calibration Unit to the WRIST STRAP banana jack on the Combo Tester

2. Connect the second test lead to the red 675K banana jack labeled “A” on the Calibration Unit. Touch the opposite end of the test lead to test plate on the Combo Tester and press down to activate the test. Be sure not to touch the banana plug or test plate with your skin.
3. Observe the response from the Combo Tester. The alarm should sound, and the LOW LED should illuminate red.
4. Repeat the procedure for test points B (825K), C (8.5M) and D (11.5M). The expected test results can be found in the following table:

Test Point	Resistance Value	Test Output
A	675K	FAIL LOW
B	825K	PASS
C	8.5M	PASS
D	11.5M	FAIL HIGH

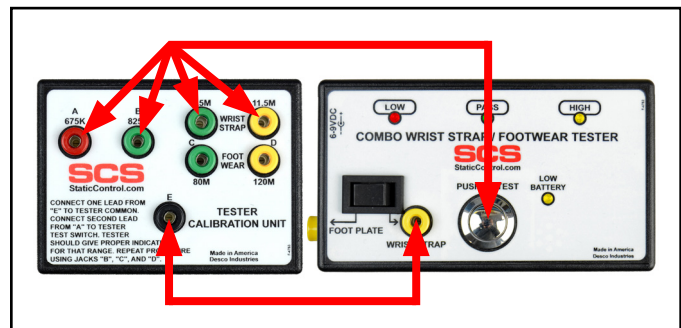

Figure 3. Verifying the calibration of the wrist strap circuit in the Combo Tester

## Testing the Footwear Circuit

1. Plug one of the included test leads into the black banana jack labeled “E” on the Calibration Unit. Connect the opposite end of the test lead into the yellow banana jack labeled “FOOT PLATE” on the Combo Wrist Strap / Footwear Tester. Toggle the switch to the “FOOT PLATE” position.

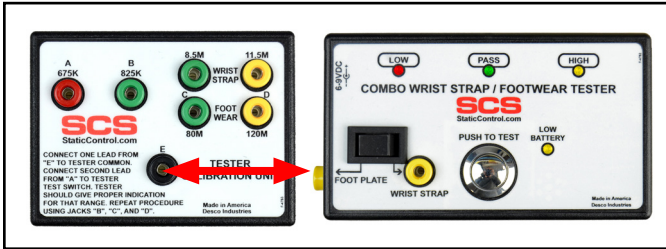

Figure 4. Connecting the test lead from banana jack “E” on the Calibration Unit to the FOOT PLATE banana jack on the Combo Tester

2. Connect the second test lead to the red 675K banana jack labeled “A” on the Calibration Unit. Touch the opposite end of the test lead to test plate on the Combo Tester and press down to activate the test. Be sure not to touch the banana plug or test plate with your skin.
3. Observe the response from the Combo Tester. The alarm should sound, and the LOW LED should illuminate red.
4. Repeat the procedure for test points B (825K), C (80M) and D (120M). The expected test results can be found in the following table:

Test Point	Resistance Value	Test Output
A	675K	FAIL LOW
B	825K	PASS
C	80M	PASS
D	120M	FAIL HIGH

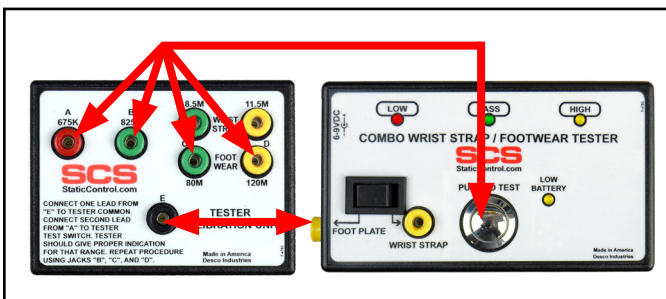

Figure 5. Verifying the calibration of the footwear circuit in the Combo Tester

## Specifications

### Accuracy:

±5%

### Dimensions:

3.2" L x 4.4" W x .9" H  
(8.1 cm x 11.2 cm x 2.3 cm)

### Weight:

4 oz (.1 kg)

### Limited Warranty, Warranty Exclusions, Limit of Liability and RMA Request Instructions

See the SCS Warranty -

<http://staticcontrol.descoindustries.com/Limited-Warranty.aspx>