



Chipsmall Limited consists of a professional team with an average of over 10 year of expertise in the distribution of electronic components. Based in Hongkong, we have already established firm and mutual-benefit business relationships with customers from,Europe,America and south Asia,supplying obsolete and hard-to-find components to meet their specific needs.

With the principle of “Quality Parts,Customers Priority,Honest Operation,and Considerate Service”,our business mainly focus on the distribution of electronic components. Line cards we deal with include Microchip,ALPS,ROHM,Xilinx,Pulse,ON,Everlight and Freescale. Main products comprise IC,Modules,Potentiometer,IC Socket,Relay,Connector.Our parts cover such applications as commercial,industrial, and automotives areas.

We are looking forward to setting up business relationship with you and hope to provide you with the best service and solution. Let us make a better world for our industry!



Contact us

Tel: +86-755-8981 8866 Fax: +86-755-8427 6832

Email & Skype: info@chipsmall.com Web: www.chipsmall.com

Address: A1208, Overseas Decoration Building, #122 Zhenhua RD., Futian, Shenzhen, China



THIS DRAWING IS UNPUBLISHED. RELEASED FOR PUBLICATION 20
 © COPYRIGHT 20 BY - ALL RIGHTS RESERVED.

REVISIONS				
P	LTR	DESCRIPTION	DATE	APVD
A1		REVISED PER ECO-12-010330	04JUN2012	DD RB
B		REVISED PER ECO-15-004568	23MAR2015	JM RB

- INSTRUCTION SHEET FOR ASSEMBLY AND DISASSEMBLY OF AMPSEAL 16 CONNECTORS: 408-8623.

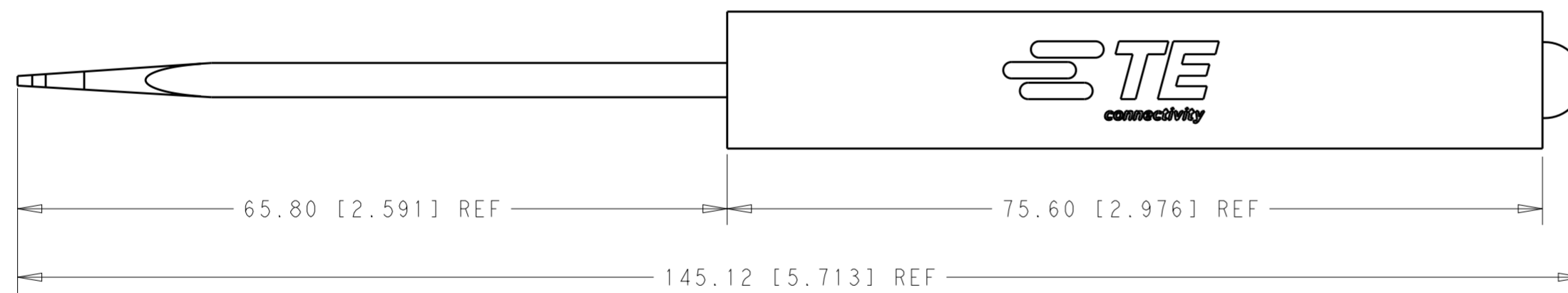
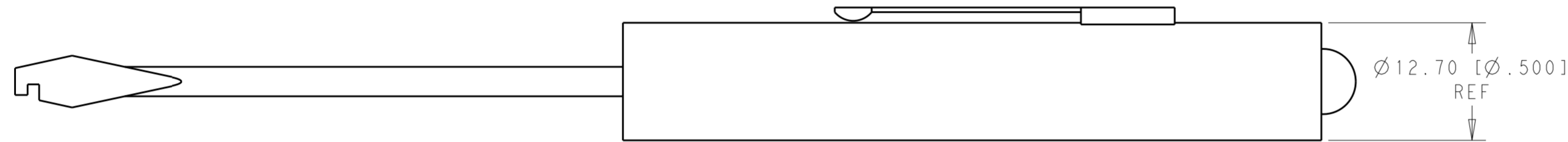

776441-1 SHOWN

776441-1
TE PART NUMBER

THIS DRAWING IS A CONTROLLED DOCUMENT.		DWN R. COLE	15JAN2002	STE TE Connectivity	
DIMENSIONS: mm [INCHES]		CHK M. TRULL	15JAN2002		
TOLERANCES UNLESS OTHERWISE SPECIFIED:		APVD M. TRULL	15JAN2002	NAME EXTRACTION TOOL, TPA AND CONTACT, AMPSEAL 16	
0 PLC ±	1 PLC ±	PRODUCT SPEC	108-2184	SIZE	CAGE CODE
2 PLC ±	3 PLC ±	APPLICATION SPEC	114-13065	DRAWING NO	RESTRICTED TO
4 PLC ±	ANGLES ±	FINISH	15.6g	A200779	C-776441
MATERIAL	-	WEIGHT	15.6g	SCALE	2:1
	-	CUSTOMER DRAWING		SHEET	1 OF 1
				REV	B