



Chipsmall Limited consists of a professional team with an average of over 10 year of expertise in the distribution of electronic components. Based in Hongkong, we have already established firm and mutual-benefit business relationships with customers from,Europe,America and south Asia,supplying obsolete and hard-to-find components to meet their specific needs.

With the principle of “Quality Parts,Customers Priority,Honest Operation,and Considerate Service”,our business mainly focus on the distribution of electronic components. Line cards we deal with include Microchip,ALPS,ROHM,Xilinx,Pulse,ON,Everlight and Freescale. Main products comprise IC,Modules,Potentiometer,IC Socket,Relay,Connector.Our parts cover such applications as commercial,industrial, and automotives areas.

We are looking forward to setting up business relationship with you and hope to provide you with the best service and solution. Let us make a better world for our industry!



Contact us

Tel: +86-755-8981 8866 Fax: +86-755-8427 6832

Email & Skype: info@chipsmall.com Web: www.chipsmall.com

Address: A1208, Overseas Decoration Building, #122 Zhenhua RD., Futian, Shenzhen, China



THIS DRAWING IS UNPUBLISHED. RELEASED FOR PUBLICATION
 © COPYRIGHT BY TYCO ELECTRONICS CORPORATION. ALL RIGHTS RESERVED.

LOC	DIST	REVISIONS			
P	LTR	DESCRIPTION	DATE	DWN	APVD
GP	00	C	REVISED PER OS1C-0120-01	23MAY01	AH CC

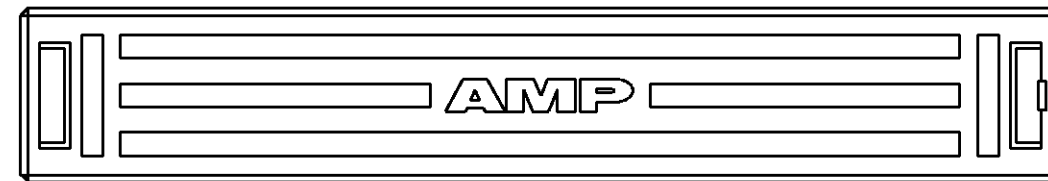
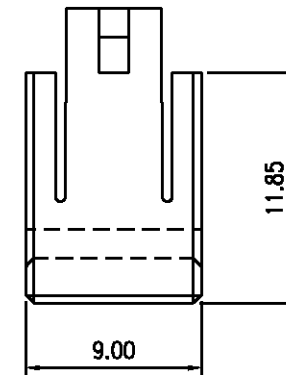
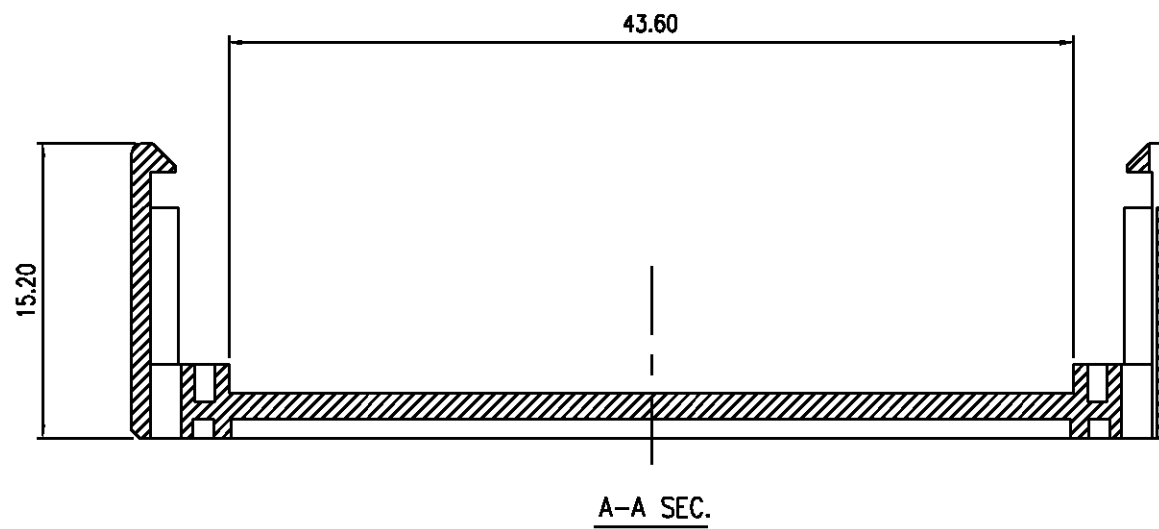
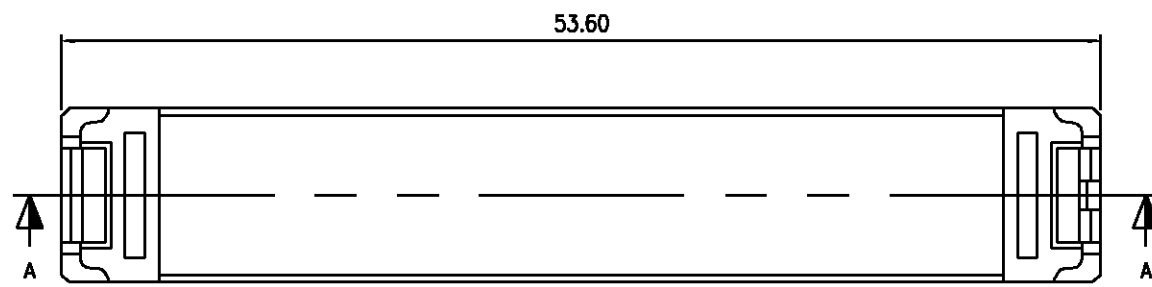

1. MATERIAL : P.B.T.+30% GLASS REINFORCED, UL94 V-0.
2. BURRS 0.03 mm. MAXIMUM ALLOWED.

68	787043-7
NO OF POSN	PART NUMBER

THIS DRAWING IS A CONTROLLED DOCUMENT.		DWN	A.HOLT	23MAY01	Tyco Electronics Corporation Harrisburg, PA 17105
DIMENSIONS:		CHK	C.CASH	23MAY01	
TOLERANCES UNLESS OTHERWISE SPECIFIED:		APVD	C.CASH	23MAY01	
MM 		PRODUCT SPEC	NAME		
MATERIAL		APPLICATION SPEC	STRAIN RELIEF, .025 INCH CENTERLINE, .050 SERIES AMPLIMITE		RESTRICTED TO
FINISH		WEIGHT	SIZE		CAGE CODE
-		-	A3		00779
		CUSTOMER DRAWING		DRAWING NO	
				C-787043	
		SCALE		SHEET	
		3:1		1 OF 1	
				REV	
				C	