



Chipsmall Limited consists of a professional team with an average of over 10 year of expertise in the distribution of electronic components. Based in Hongkong, we have already established firm and mutual-benefit business relationships with customers from,Europe,America and south Asia,supplying obsolete and hard-to-find components to meet their specific needs.

With the principle of “Quality Parts,Customers Priority,Honest Operation,and Considerate Service”,our business mainly focus on the distribution of electronic components. Line cards we deal with include Microchip,ALPS,ROHM,Xilinx,Pulse,ON,Everlight and Freescale. Main products comprise IC,Modules,Potentiometer,IC Socket,Relay,Connector.Our parts cover such applications as commercial,industrial, and automotives areas.

We are looking forward to setting up business relationship with you and hope to provide you with the best service and solution. Let us make a better world for our industry!



## Contact us

Tel: +86-755-8981 8866 Fax: +86-755-8427 6832

Email & Skype: info@chipsmall.com Web: www.chipsmall.com

Address: A1208, Overseas Decoration Building, #122 Zhenhua RD., Futian, Shenzhen, China



LOC		DIST		REVISIONS			
GP	00	F	LTR	DESCRIPTION	DATE	DWN	APVD
N		REVISED PER	ECO-12-012349		21MAR13	BL	AC

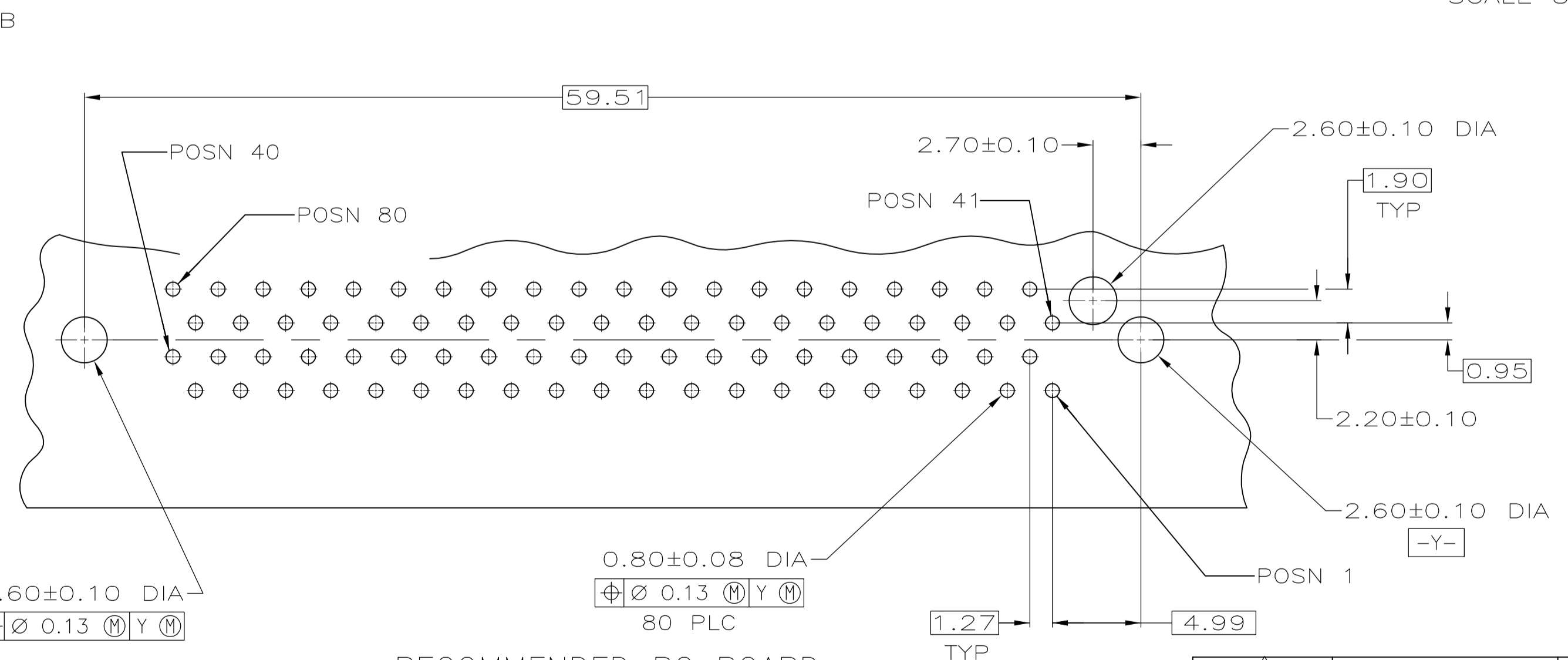
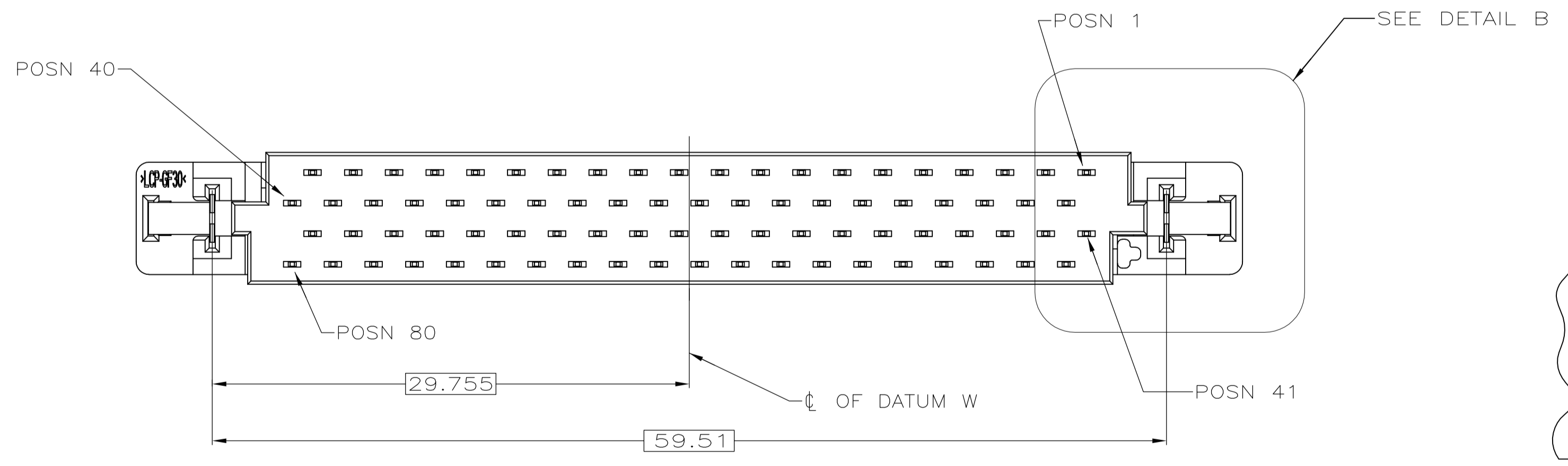
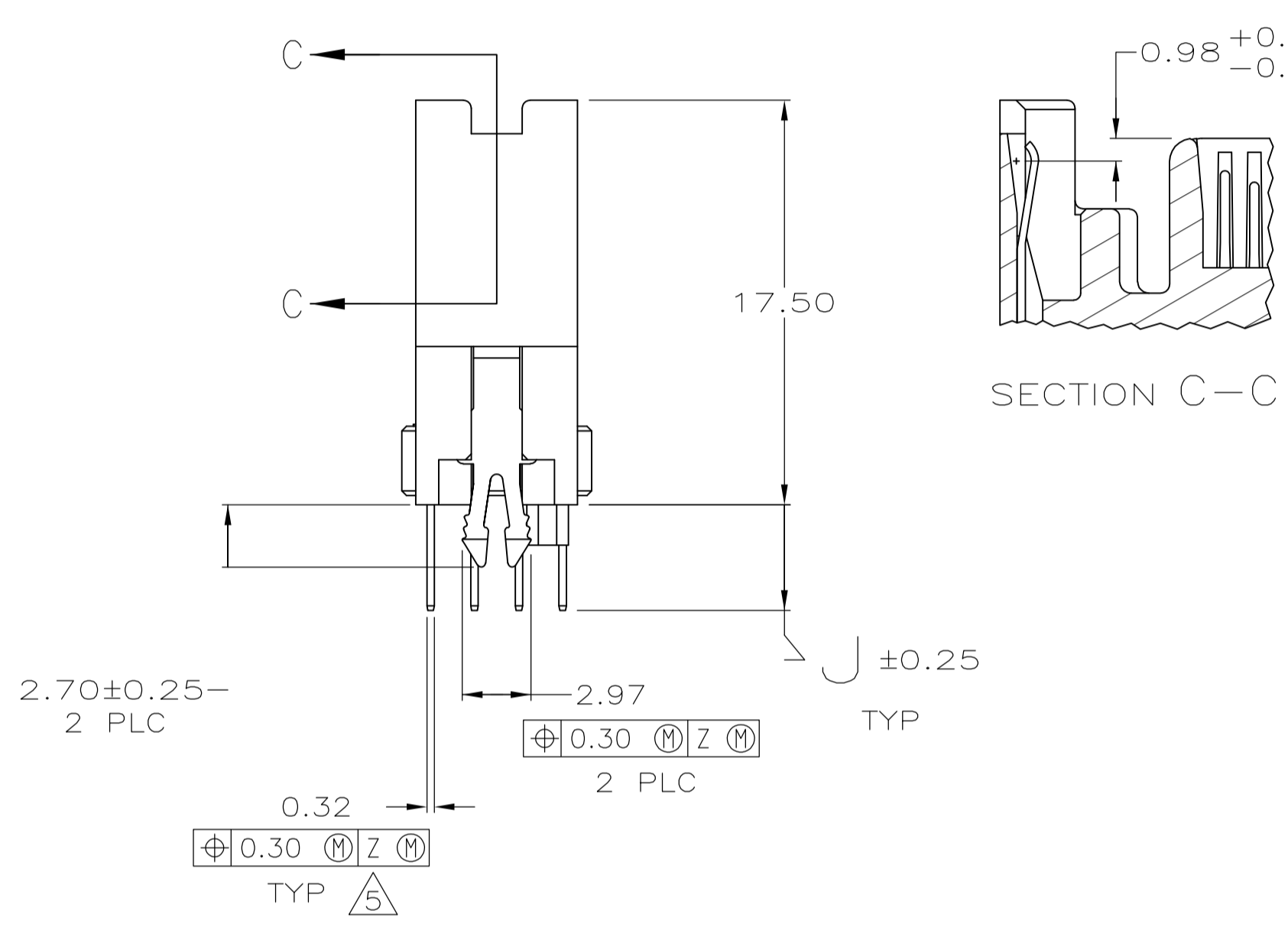
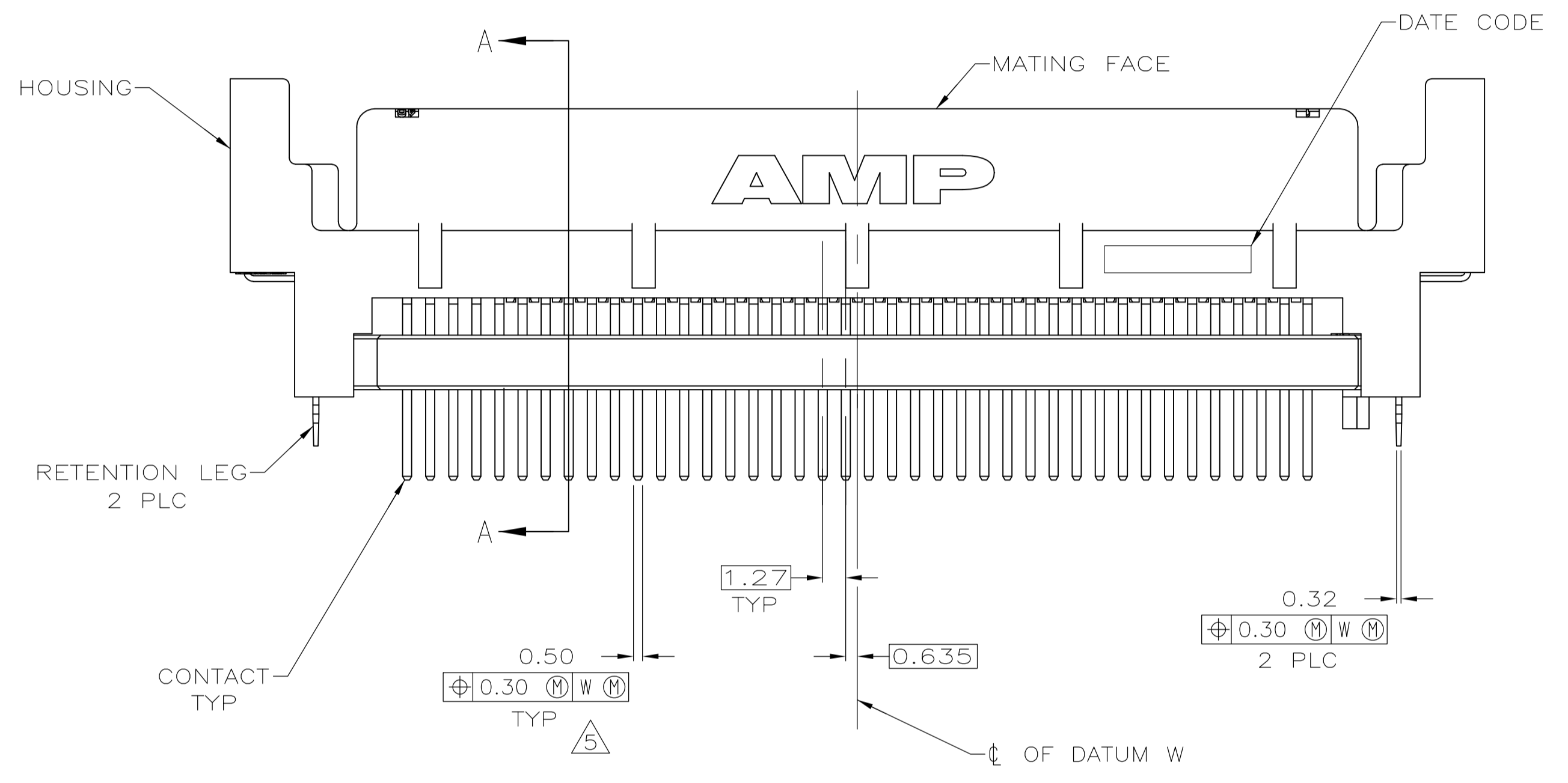
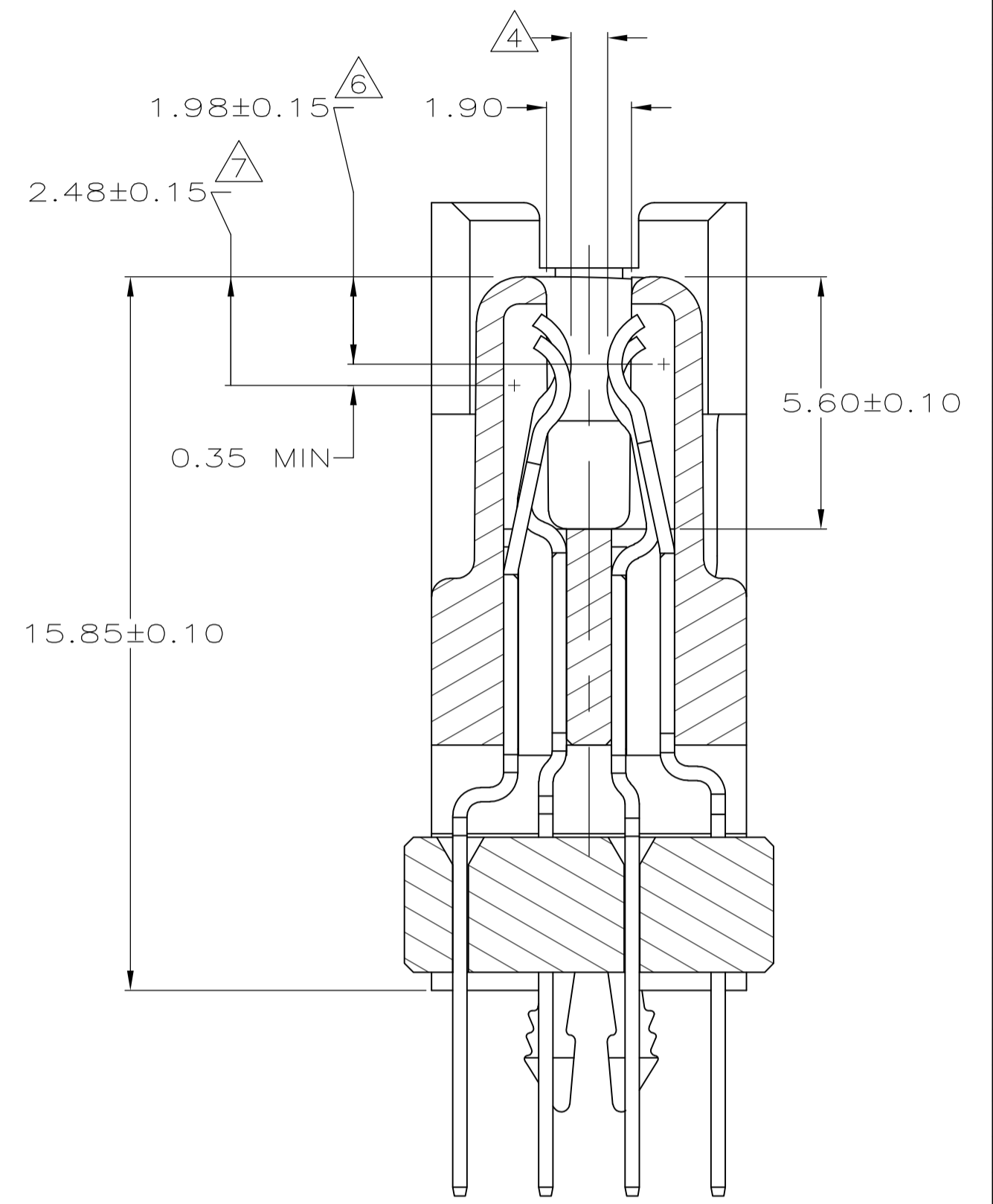
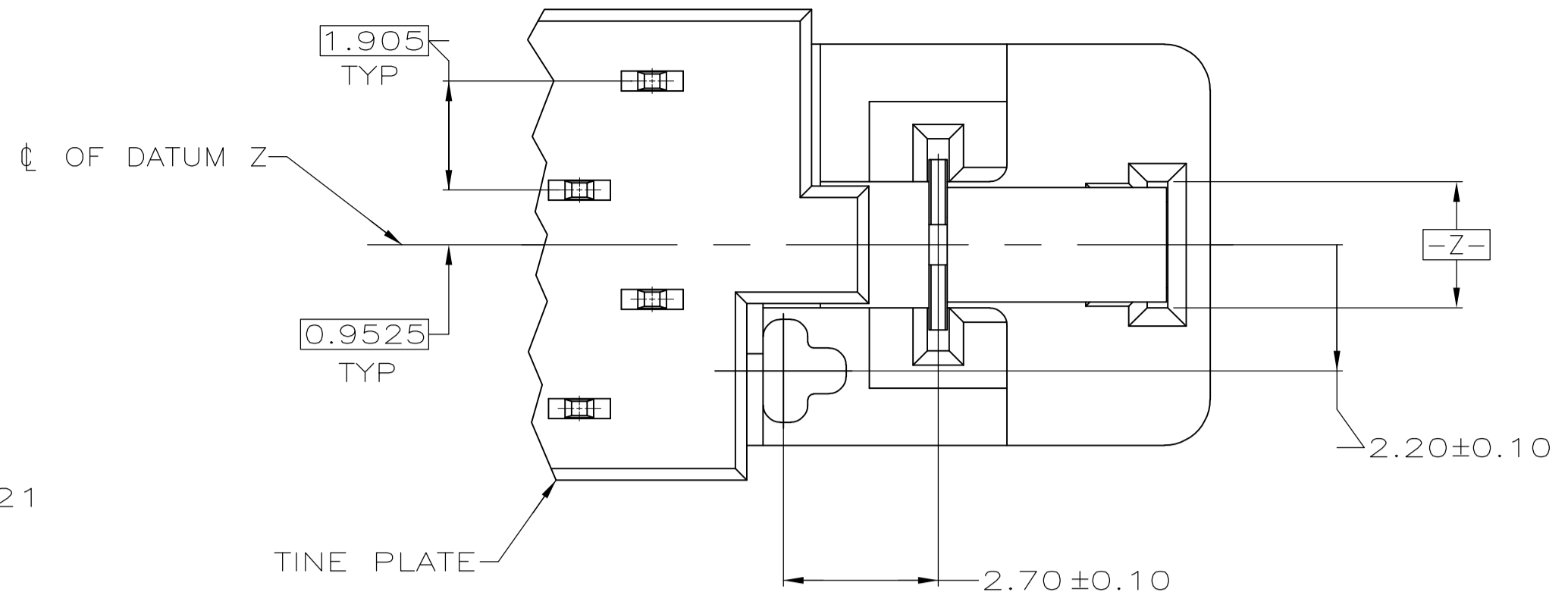
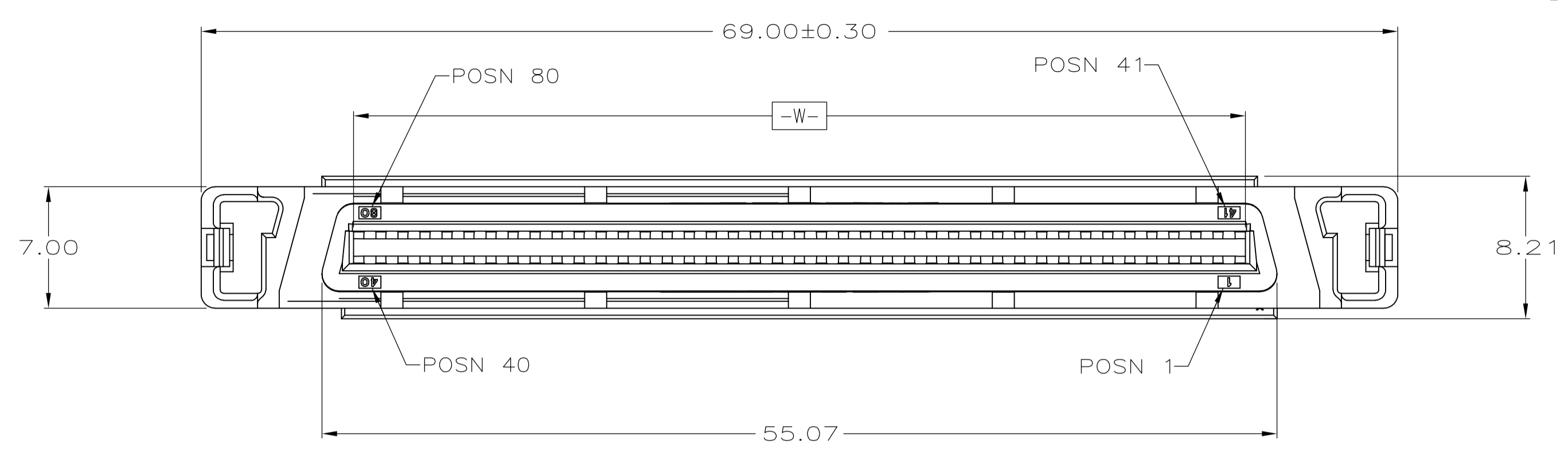

- △ HOUSING & TINE PLATE: POLYESTER, UL 94V-0 RATED, BLACK. CONTACTS: PHOSPHOR BRONZE. RETENTION LEGS: BRASS.
- △ CONTACTS: 0.76 μm MIN GOLD FOR A LENGTH 1.20 MIN STARTING 0.50 MAX FROM MATING END, 3.81 μm MIN TIN-LEAD ON SOLDER TINES, BOTH OVER 1.27 μm MIN NICKEL. RETENTION LEGS: 3.81 μm MIN TIN-LEAD OVER 1.27 μm MIN NICKEL.
- △ CONNECTOR WILL ACCOMMODATE PRINTED CIRCUIT BOARD THICKNESS OF 1.77 TO 4.06.
- △ CONNECTOR WILL ACCOMMODATE MATING PRINTED CIRCUIT BOARD OF 1.60±0.07 THICKNESS.
- △ POSITION TOLERANCE APPLIES AT CONTACT TIP ONLY.
- △ CONTACTS 1, 36 THRU 43, 45 THRU 46 & 75 THRU 80 ARE POSITIONED TOWARD THE MATING FACE. (LONG)
- △ CONTACTS 2 THRU 35, 44 & 47 THRU 74 ARE POSITIONED AWAY FROM THE MATING FACE. (SHORT)
- △ CONTACTS: 0.76 μm MIN GOLD FOR A LENGTH 1.20 MIN STARTING 0.50 MAX FROM MATING END, 3.81 μm MIN MATTE TIN ON SOLDER TINES, BOTH OVER 1.27 μm MIN NICKEL. RETENTION LEGS: 3.81 μm MIN HALT TIN.

△	3.18	787596-5
△	4.57	787596-4
△	3.18	787596-3
△	2.79	787596-2
△	4.57	787596-1
FINISH		J
OBSOLETE		
OBSOLETE		
PART NUMBER		

THIS DRAWING IS A CONTROLLED DOCUMENT.

DIMENSIONS: mm	TOLERANCES UNLESS OTHERWISE SPECIFIED:	DIN C. OBERMAN 27 SEP 95	APVD R. STONE 28 SEP 95	NAME	TE Connectivity
0 PLC ± -	1 PLC ± -	2 PLC ± 0.13	3 PLC ± -	4 PLC ± -	ANGLES ± -
MATERIAL	FINISH	SIZE	CODE	DRAWING NO	RESTRICTED TO
	SEE TABLE	A1	00779	787596	
CUSTOMER DRAWING		SCALE	4:1	SHEET	1 OF 1

RECEPTACLE ASSEMBLY, VERTICAL, EXTENDED HEIGHT, 80 POSN, SERIES I, CHAMP BLINDMATE