



Chipsmall Limited consists of a professional team with an average of over 10 year of expertise in the distribution of electronic components. Based in Hongkong, we have already established firm and mutual-benefit business relationships with customers from,Europe,America and south Asia,supplying obsolete and hard-to-find components to meet their specific needs.

With the principle of “Quality Parts,Customers Priority,Honest Operation,and Considerate Service”,our business mainly focus on the distribution of electronic components. Line cards we deal with include Microchip,ALPS,ROHM,Xilinx,Pulse,ON,Everlight and Freescale. Main products comprise IC,Modules,Potentiometer,IC Socket,Relay,Connector.Our parts cover such applications as commercial,industrial, and automotives areas.

We are looking forward to setting up business relationship with you and hope to provide you with the best service and solution. Let us make a better world for our industry!



## Contact us

Tel: +86-755-8981 8866 Fax: +86-755-8427 6832

Email & Skype: info@chipsmall.com Web: www.chipsmall.com

Address: A1208, Overseas Decoration Building, #122 Zhenhua RD., Futian, Shenzhen, China



# Miniature Limit Switches Series 83 800

**Degree of protection :** IP 55 or IP 65 - Nema 4, 12, 13

**Version :** SPDT - double break

**Function :** Four terminal double break contact element (form Za). The contacts must be of the same polarity.

**Layout :**

A - For 83 803



B - Other types



## Electrical characteristics :

Assigned insulation voltage (Ui): 250 V

Current Rating

Assigned working currents (Ie): 5 A

## Operating curve :

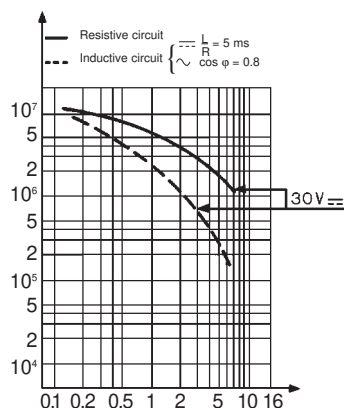

## Connections :

- Plug in : Screw terminals - max. wire section 2.5 mm<sup>2</sup>
- Non Plug in : Solder tags (able to accept 2.8 x 0.5 mm clips).  
Contact Crouzet for part # and availability

## Connection :

- For N° 9 sealing gland, 15.2 dia., 1.411 pitch
- 25356113 - metal
- 25356109 - plastic

**Approvals:** UL cUL

## Type

**Plug in version**

## Features

- Top mounted plunger
- Top mounted plunger with threaded barrel
- Top mounted roller plunger with threaded barrel
- Side rotary head - momentary
- Top mounted roller plunger
- Flexible metal spring
- Fiberglass Rod

## Mechanical Characteristics

Operating force	N (oz)
Total travel force - min.	N (oz)
Operating Travel - min	mm (in)
Movement differential	mm (in)
Total travel - max	mm (in)
Mechanical life	operation
Operating temp.	C° (F°)
Degree of protection	
Weight	grams (oz)

## Accessories for 83 803 - Sold separately

\* Lever settings or positions dictated by direction in which block is fitted

Adjustable in 6° steps

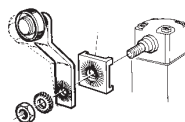

Adjustable in 90° steps

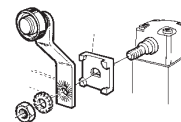

## Dimensions

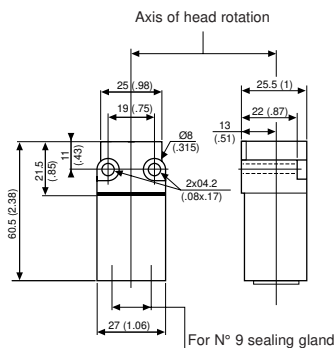

mm(in)

## Other information

For other accessories and special contacts, or special modes of operation, please contact factory.  
Low temperature version available.

Products and specifications subject to change without notice.

Order/Technical Support – Tel: (800) 677-5311 / FAX: (800) 677-3865 / www.crouzet-usa.com



83800151	83801051	83802051	83803051	83805051	83806051	83807051
.	.	.	.	.	.	.
10 (35.3)	10 (35.3)	10 (35.3)	7 NcM 10 in.oz.	10 (35.3)	1.2 (4.23)	.8 (2.8)
22 (77.6)	22 (77.6)	22 (77.6)	18 NcM 25 in.oz.	22 (77.6)	2.5 (8.8)	2 (7.05)
1.5 (.06)	1.5 (.06)	1.5 (.06)	15°	1.5 (.06)	8°	8°
0.4 (.016)	0.4 (.016)	0.4 (.016)	6°	0.6 (.24)	2°	2°
5 (.2)	5 (.2)	5 (.2)	60°	5 (.2)	10°	10°
10°	10°	10°	10°	10°	10°	10°
-10 to 70 (-14 to 158)	-20 to 70 (-4 to 158)	-20 to 70 (-4 to 158)	-20 to 70 (-4 to 158)	-10 to 70 (-14 to 158)	-10 to 70 (14 to 158)	-10 to 70 (14 to 158)
IP 55	IP 55	IP 55	IP 55	IP 65	IP65	IP65
50 (1.8)	57 (2)	57 (2)	60 (2.1)	50 (1.8)	50 (2.65)	60 (2.1)

### Accessories for 83 803 - Sold separately

Galvanized, passivated steel roller arm. Thermoplastic roller.  
Lever supplied with nut, washer and locating block (loose).\*

#### 79 210 997

Bent roller lever R: 1 1/8" (30mm)



#### 79 210 998

Straight roller lever R: 11/8" (30mm)



#### 79 215 332

Adjustable  
Straight roller lever  
1 3/16" → 2 7/8"  
(28 → 72mm)



### Dimensions

#### 83 800

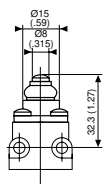

#### 83 801

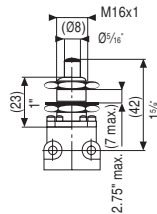

#### 83 802

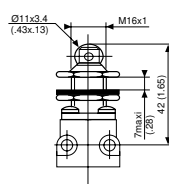

#### 83 803

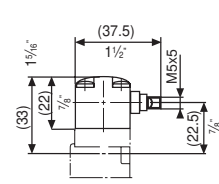

#### 83 805

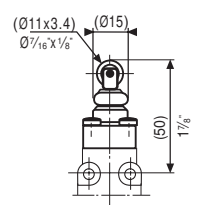

#### 79 210 997

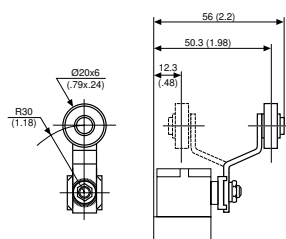

#### 79 210 998

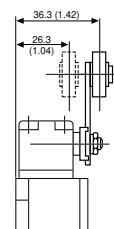

#### 79 215 332

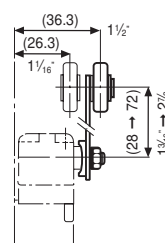

#### 83 806



#### 83 807

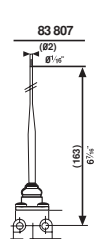

mm(in)

To order, specify:

	Standard products	<b>1</b> Part number	Example: 83 800 151
	Standard products, not stocked	<b>1</b> Part number <b>2</b> Accessory	Example: 83 803 0 - Actuator 79 210 997

Products and specifications subject to change without notice.

Order/Technical Support – Tel: (800) 677-5311 / FAX: (800) 677-3865 / www.crouzet-usa.com